

REVISIONS				
P	LTR	DESCRIPTION	DATE	APP'D
A2		REVISED PER ECN-21-119406	11OCT2021	MLU SH

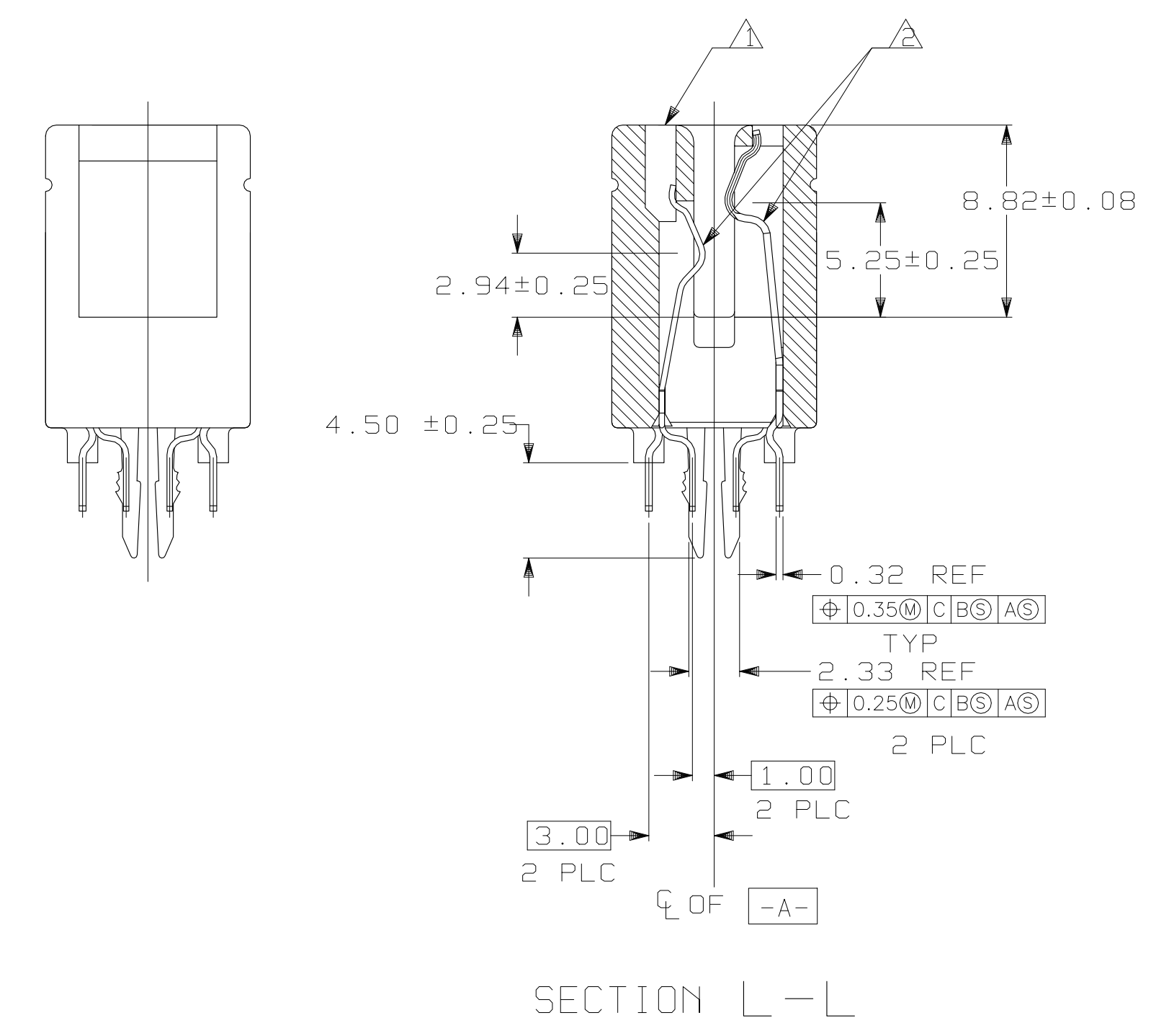

- △ MATERIAL: HOUSING, THERMOPLASTIC, COLOR: BROWN. CONTACTS, PHOSPHOR BRONZE. HOLD-DOWNS, BRASS.
- △ FINISH: CONTACTS, 1.27 MIN. MICROMETERS NICKEL ALL OVER, 0.38 MIN. MICROMETERS GOLD OVER NICKEL IN CONTACT AREA, 2.54 MIN MICROMETERS TIN OVER NICKEL ON SOLDER TAILS.
- △ REFER TO INTEL ACCELERATED GRAPHICS PORT INTERFACE SPECIFICATION FOR RECOMMENDED MATING PAD PATTERNS FOR AGP 1X, 2X AND 4X BOARDS.
- △ SHADED CONTACT LOCATIONS ARE AT RISK OF DAMAGE DURING MATING AND UNMATING WITH AGP-1X AND AGP-2X/4X CIRCUITS.
- △ FINISH: CONTACTS, 1.27 MIN. MICROMETERS NICKEL ALL OVER, 0.0254-0.0762 MICROMETERS GOLD OVER NICKEL IN CONTACT AREA. 2.54 MIN. MICROMETERS TIN OVER NICKEL ON SOLDER TAILS.
- △ OBSOLETE PARTS: OBSOLETE CIS STREAMLINING PER D.RENAUD/D.SINISI

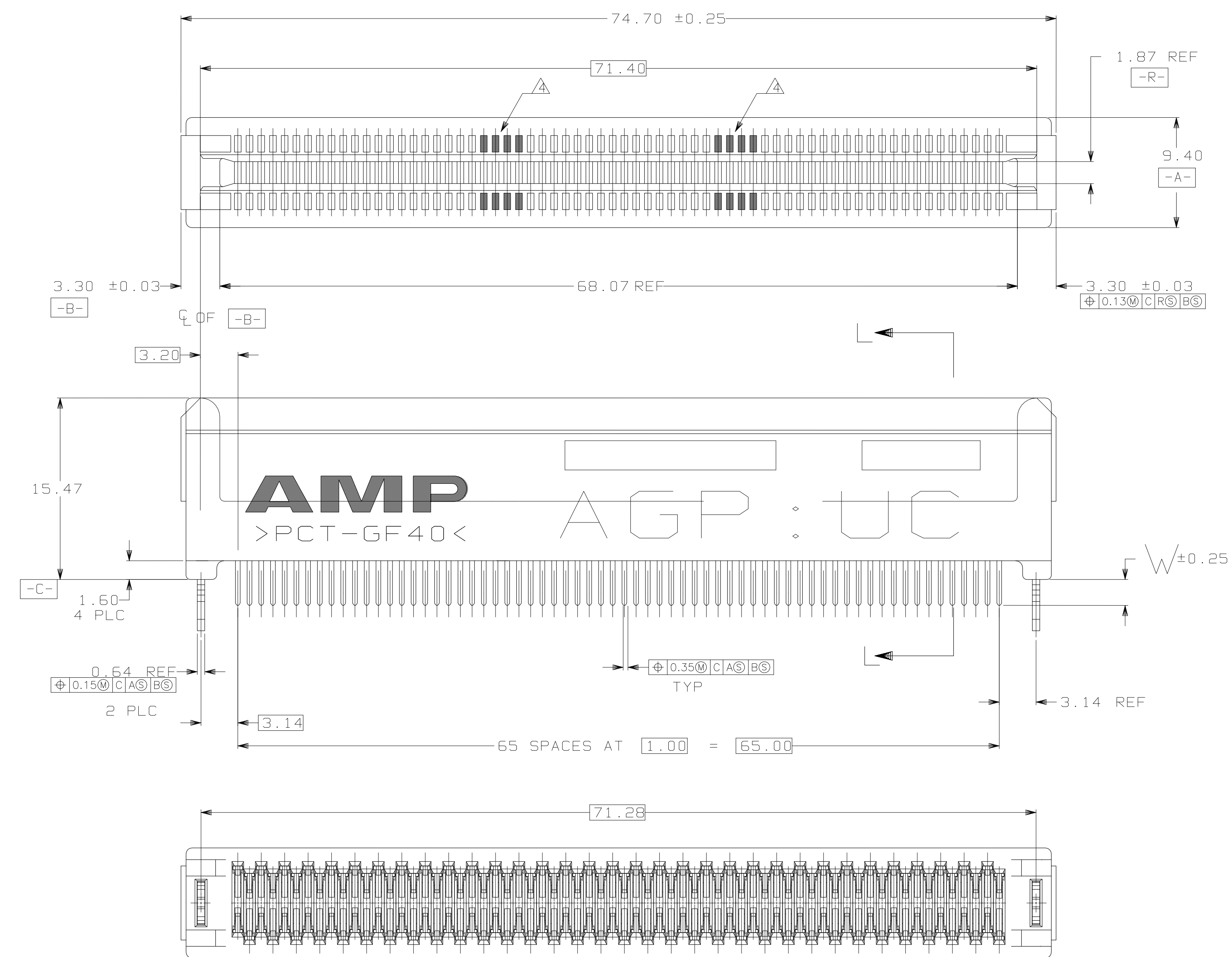
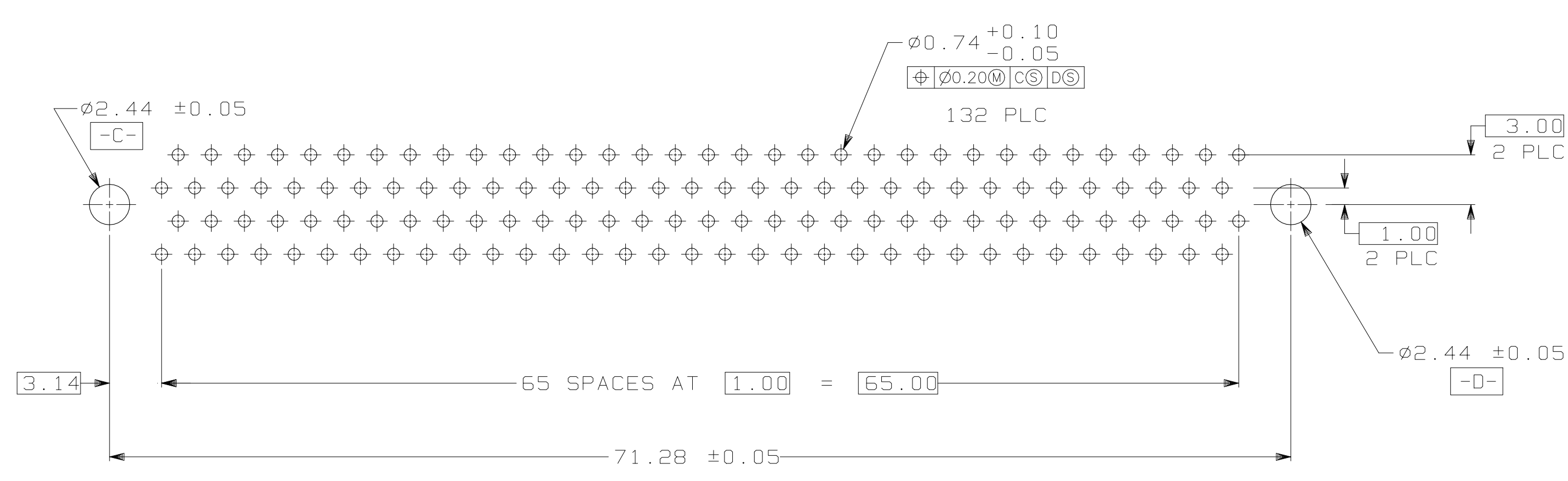

RECOMMENDED CONNECTOR MOUNTING HOLE PATTERN (CONNECTOR SIDE SHOWN)

6	△	3.18	5145376-6
OBSOLETE	△	2.54	5145376-5
	△	3.18	5145376-3
	△	2.54	5145376-2
OBSOLETE	△	2.16	5145376-1
	PLATING	W	PART NO

THIS DRAWING IS A CONTROLLED DOCUMENT.

DIMENSIONS:	TOLERANCES UNLESS OTHERWISE SPECIFIED:	DIN	23MAR05
mm	0 PLC ± -	CAVIN ZHANG	23MAR05
	1 PLC ± -	CHIK	23MAR05
	2 PLC ± 0.13	STEVEN YAO	
	3 PLC ± -	ENOMOTO	23MAR05
	4 PLC ± -	PRODUCT SPEC	
	ANGLES ± 2	APPLICATION SPEC	
MATERIAL	FINISH	SIZE	CAGE CODE
△	△△	A1	-
		WEIGHT	DRAWING NO
		-	5145376
		CUSTOMER DRAWING	RESTRICTED TO
		SCALE 1:1	SHEET 1 of 1
			REV A2

STE TE Connectivity

ASSEMBLY, 132 POSITION
1mm, CARD EDGE CONNECTOR

单击下面可查看定价，库存，交付和生命周期等信息

[>>TE Connectivity\(泰科\)](#)