

- 1 MOLDED PARTS: FLAME RETARDANT, 94V-0 RATED, GLASS FILLED NYLON OR POLYESTER, BLACK  
CONTACTS: BRASS  
HARDWARE: BRASS
- 2 CONTACTS: SEE TABLE  
INSERTS: UNPLATED  
SCREWLOCKS: NICKEL PLATED
- 3 REFER TO APPLICATION SPEC FOR RECOMMENDED P.C. BOARD MOUNTING DIMENSIONS FOR AUTOMATIC INSERTION.
- 4 GOLD FLASH ON THE MATING SURFACES, .000100 MIN TIN OR TIN-LEAD PLATE ON THE SOLDER END, .000050 MIN NICKEL UNDERPLATE ON THE ENTIRE CONTACT.
- 5 .000030 MIN GOLD PLATE ON THE MATING SURFACES, .000100 MIN TIN OR TIN-LEAD PLATE ON THE SOLDER END, .000050 MIN NICKEL UNDERPLATE ON THE ENTIRE CONTACT.  
-OR-  
GOLD FLASH OVER PALLADIUM- NICKEL PLATE, .000030 MIN TOTAL ON THE MATING SURFACES, .000100 MIN TIN OR TIN-LEAD PLATE ON THE SOLDER END, .000050 MIN NICKEL UNDERPLATE ON THE ENTIRE CONTACT.

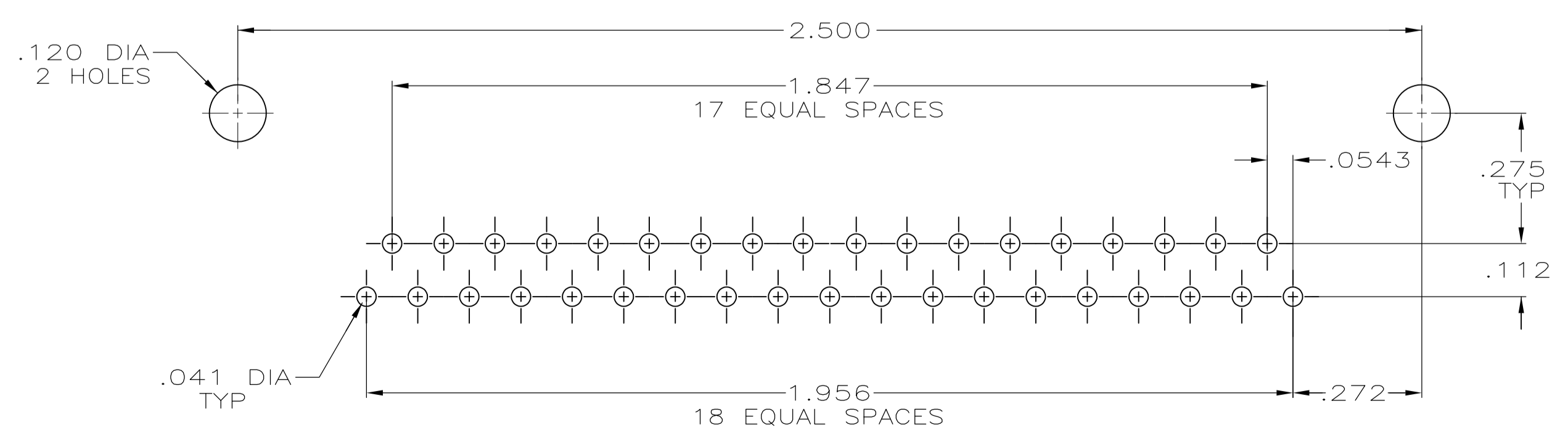
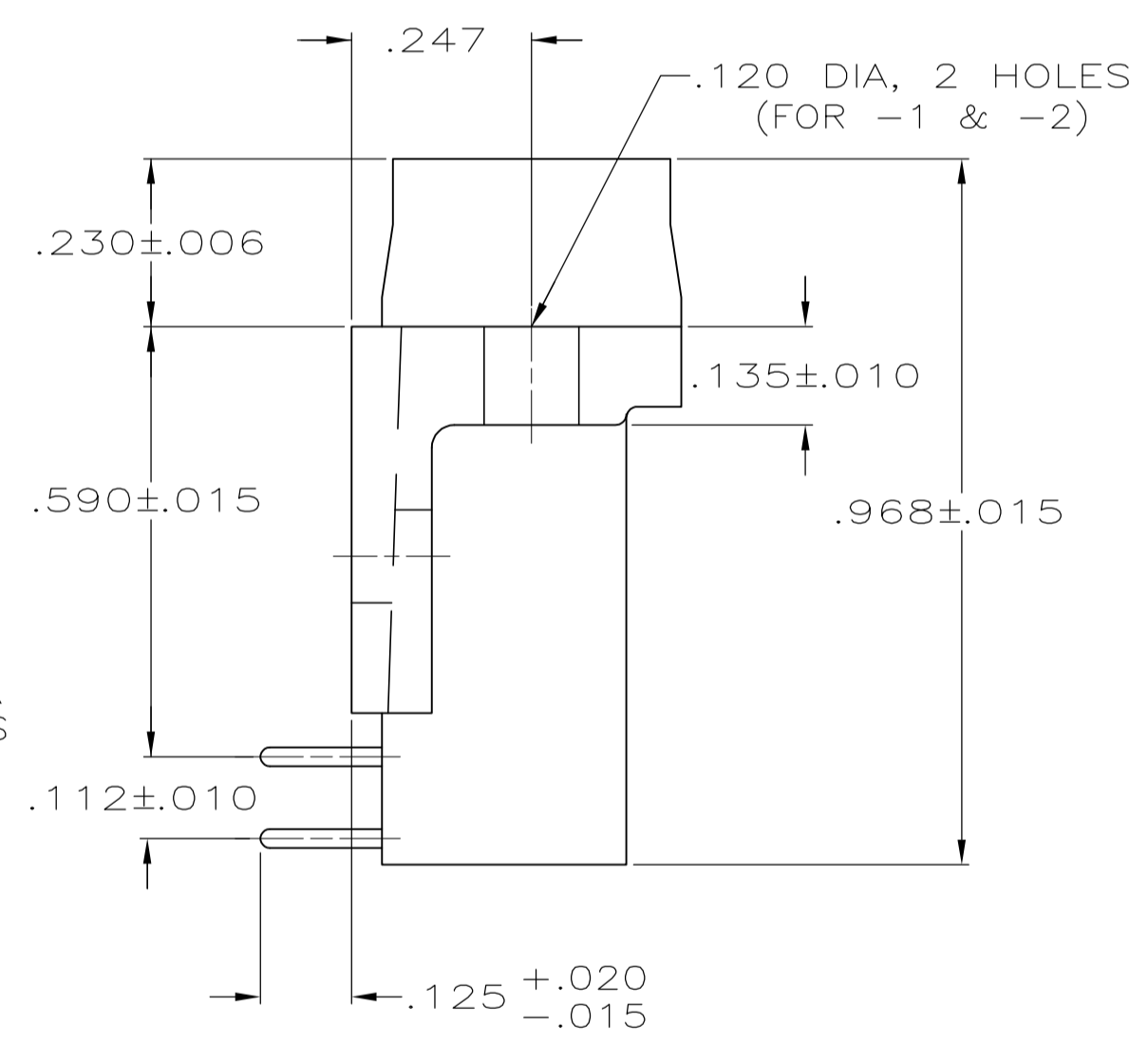
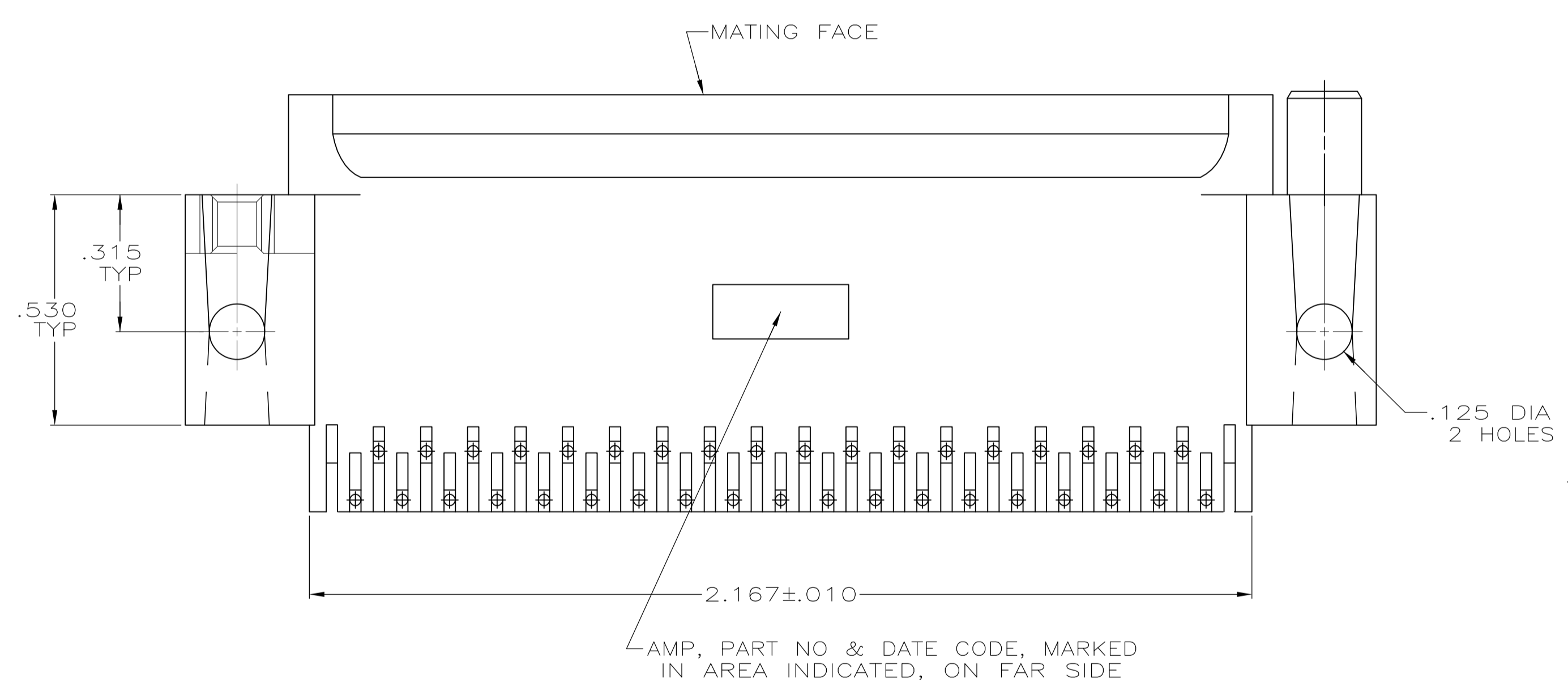

OBSELETE	WITH SCREWLOCKS	5	747470 -6
OBSELETE	WITH SCREWLOCKS	4	747470 -5
OBSELETE	WITH INSERTS	5	747470 -4
OBSELETE	WITH INSERTS	4	747470 -3
	WITH .120 DIA HOLE	5	747470 -2
SUPSD BY 747470-2	WITH .120 DIA HOLE	4	747470 -1
	REMARKS	FINISH	PART NUMBER

THIS DRAWING IS A CONTROLLED DOCUMENT.		DIN	C RICHARD	7-29-87
DIMENSIONS: INCHES		CHK	S WELDON	8-3-87
TOLERANCES UNLESS OTHERWISE SPECIFIED:		APVD	B TAYLOR	8-3-87
0 PLC ± -		NAME	PLUG ASSY, SIZE 4, 37 POSN, RIGHT ANGLE, .590 SERIES, .026 DIA POSTS, AMPLIMITE® HD-20	
1 PLC ± -		PRODUCT SPEC	108-40005	
2 PLC ± -		APPLICATION SPEC	114-40015	
3 PLC ± .005		SIZE	A1	00779
4 PLC ± .005		WEIGHT	747470	
ANGLES ± ± °		CUSTOMER DRAWING	SCALE	4:1
MATERIAL		SHEET		1 OF 1
FINISH		REV		J

单击下面可查看定价，库存，交付和生命周期等信息

[>>TE Connectivity\(泰科\)](#)