

THIS DRAWING IS UNPUBLISHED. RELEASED FOR PUBLICATION, 19  
 © COPYRIGHT 19 BY AMP INCORPORATED, HARRISBURG, PA. ALL INTERNATIONAL RIGHTS RESERVED. AMP PRODUCTS MAY BE COVERED BY U.S. AND FOREIGN PATENTS AND/OR PATENTS PENDING.

REVISIONS						
P	F	ZONE	LTR	DESCRIPTION	DATE	APPROVED
			O	RLSD -1 PER PR CM 88-7 REVISED PER CM 1583	2/23/88	TB /RS
			A	REV PER 0710-0427-95	24/SEP/85	PMF

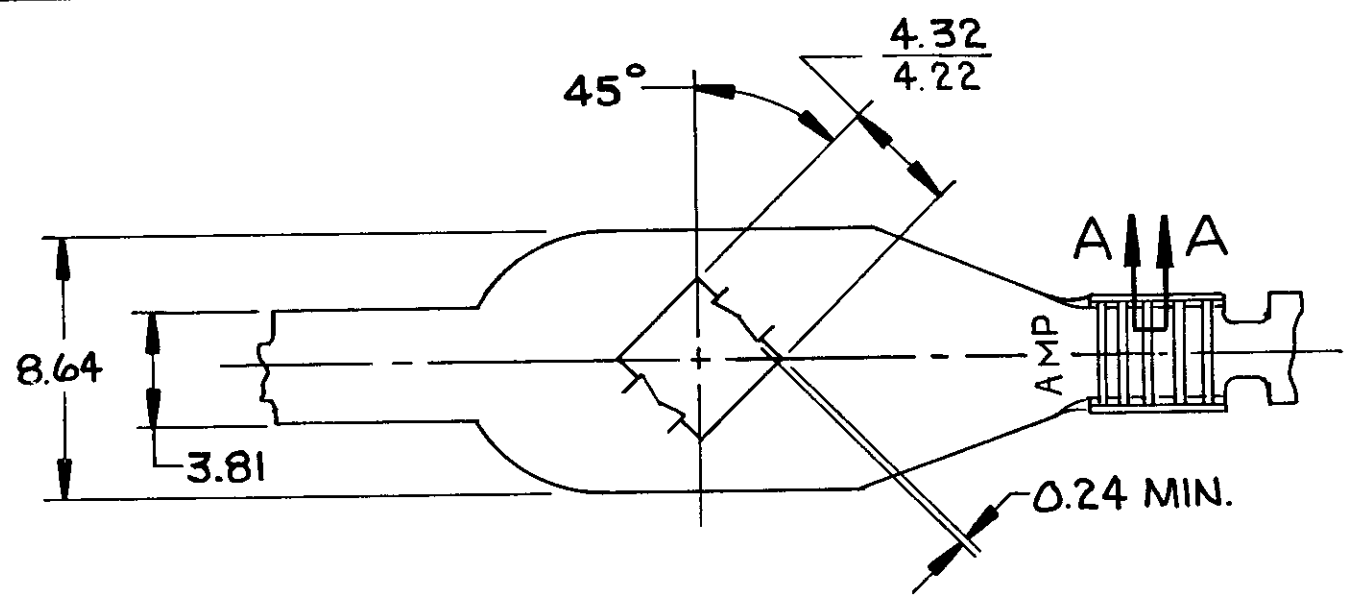

1. WIRE RANGE: 2600-4900 CMA.

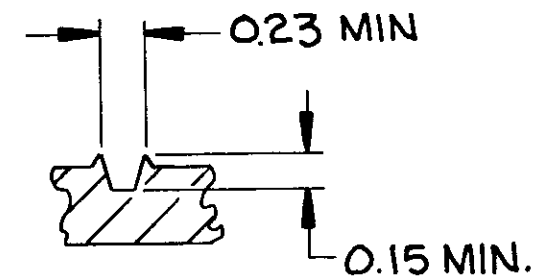
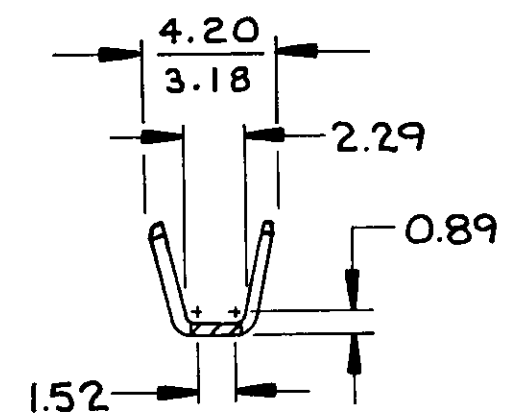
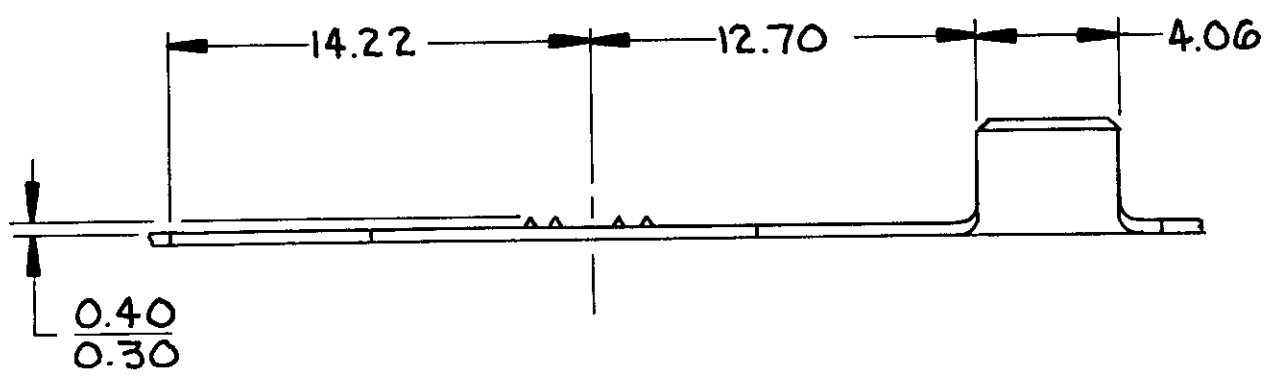

SECTION A-A  
TYP. SERRATION

**METRIC**

770392-1  
PART NO

UNLESS OTHERWISE SPECIFIED DIMENSIONS ARE IN INCHES. <b>MM</b> TOLERANCES ON: DECIMALS ± 0.40 ANGLES ± 1°	CONTRACT NO	AMP   AMP INCORPORATED Harrisburg, Pa.	
	DR <i>Whitaker 1-17-86</i>	NAME TERMINAL, STUD RETAINING, AMPLIVAR™	
MATERIAL <b>0.50 BRASS</b>	CHK <i>The Spring 1-17-86</i>	SIZE <b>B</b>	FSCM NO <b>00779</b>
FINISH	APPD <i>Don Crane 17 Jan. 86</i>	DRAWING NO <b>770392</b>	DRAWING NO <b>770392</b>
	DSGN APPD	SCALE <b>4:1</b>	SHEET <b>1 OF 1</b>
	OTHER APPD		

单击下面可查看定价，库存，交付和生命周期等信息

[>>TE Connectivity\(泰科\)](#)