

| LOC | | DIST | | REVISIONS | | | |
|-----|----|------|-----|-------------------------|-----------|-----|------|
| GP | 00 | P | LTN | DESCRIPTION | DATE | DWN | APVD |
| | | C1 | | REV PER ECR-11-022334 | 03NOV2011 | CZ | SZ |
| | | C3 | | REVISED 1-8 | 16JAN2014 | CZ | SZ |
| | | C5 | | ADDING NOTE FOR 1-8 | 10SEP2015 | CZ | SZ |
| | | C6 | | REVISED 1-0 BY CUSTOMER | 05MAY2016 | CZ | SZ |

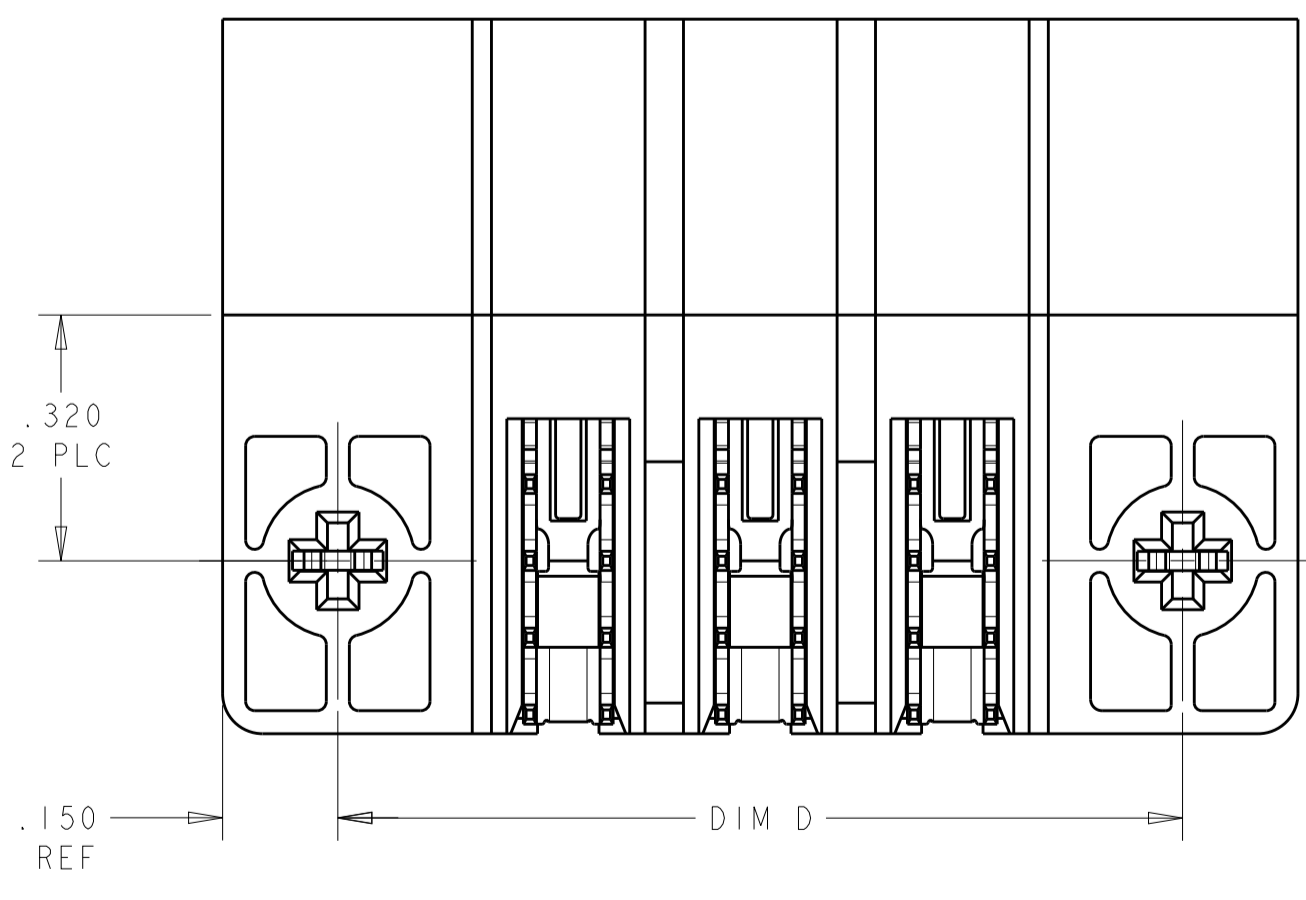
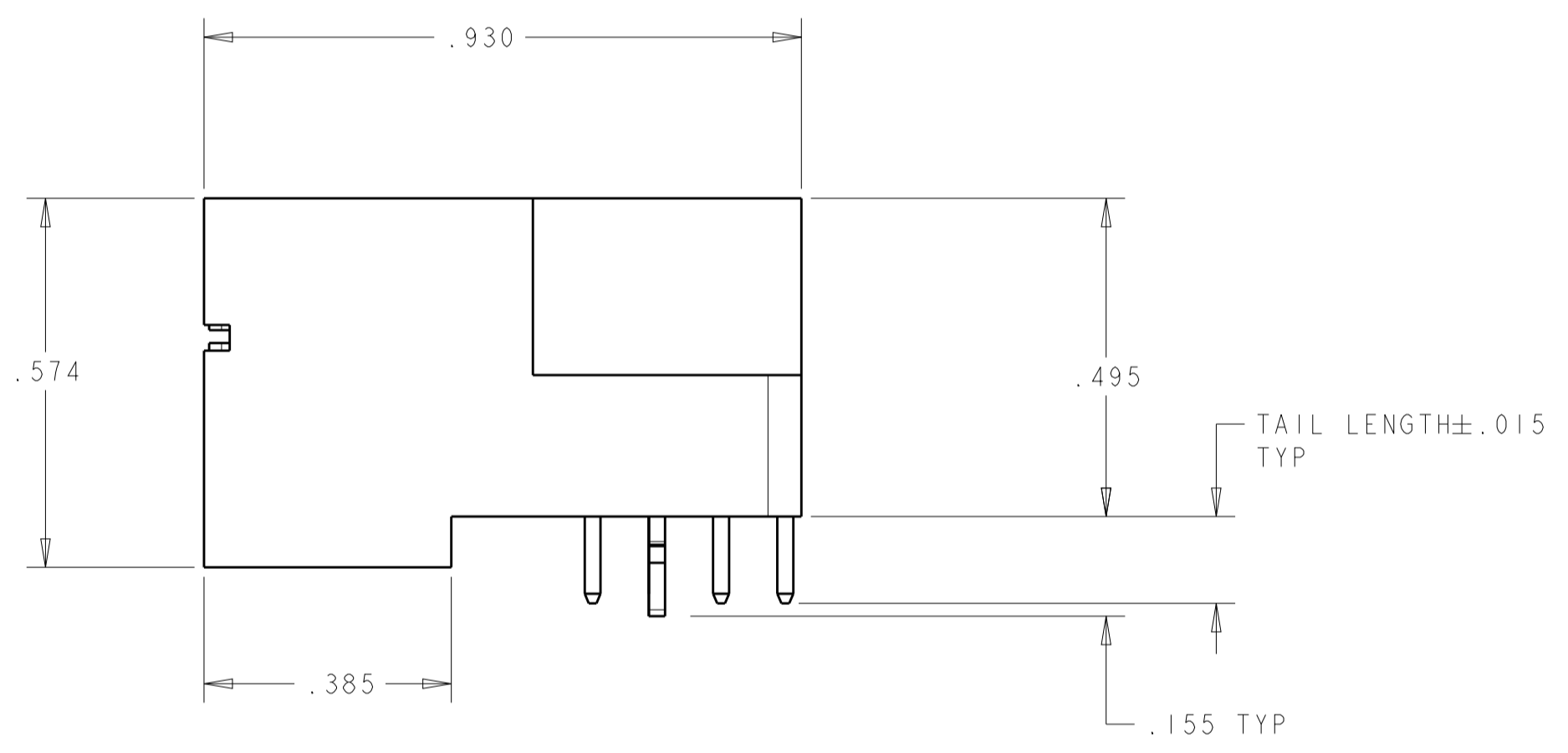
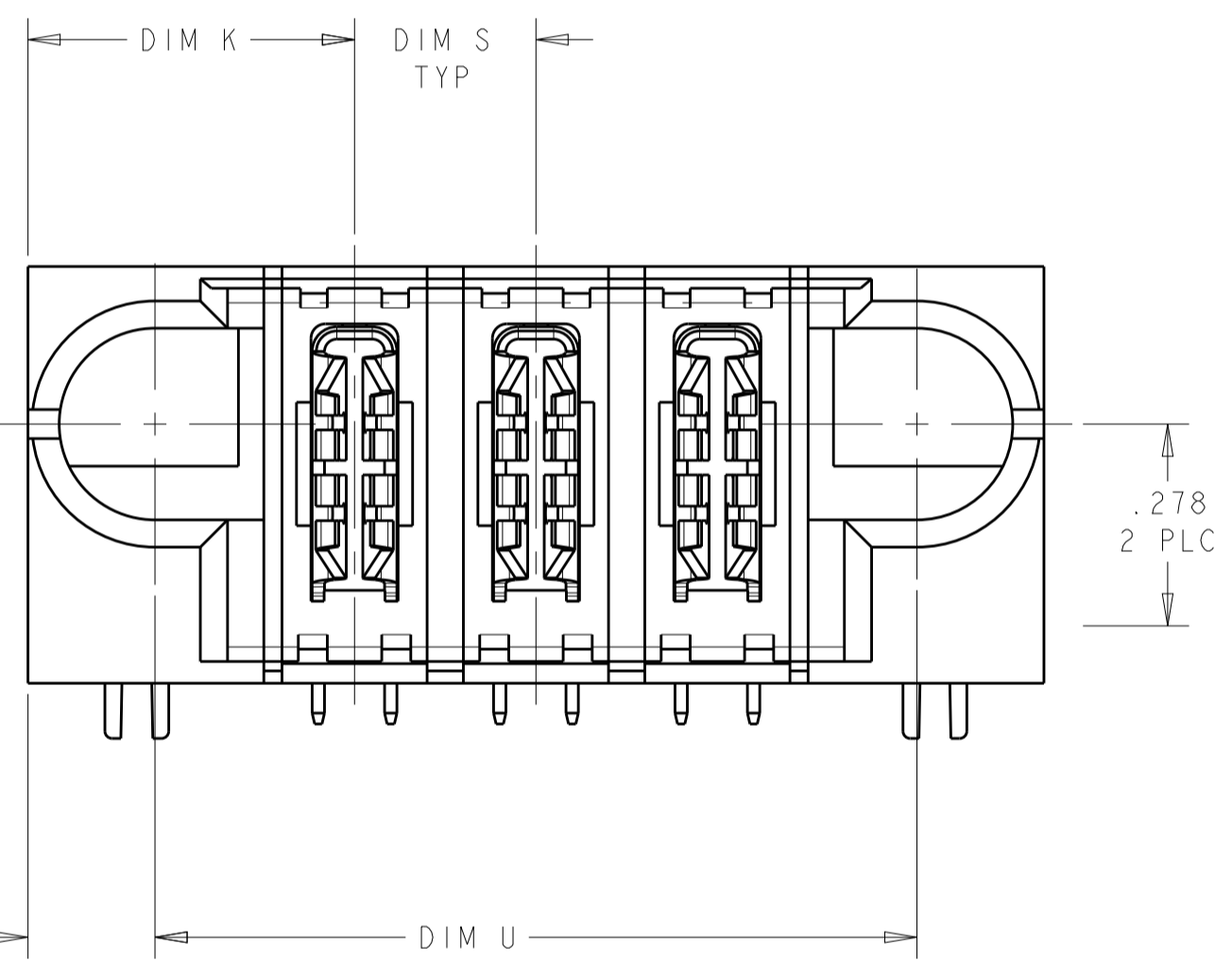
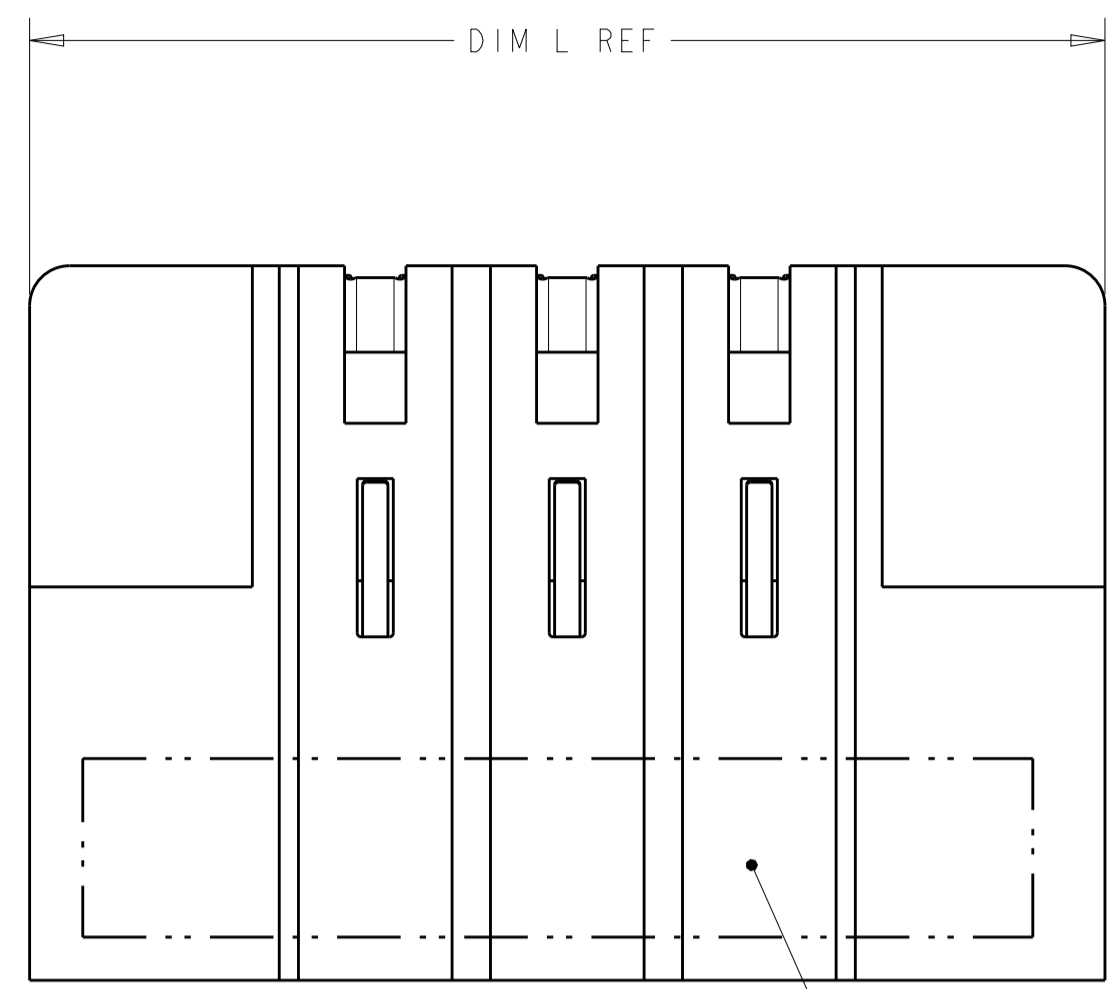

- 1 "AMP", PART NUMBER, AND DATE CODE TO BE MARKED IN AREA SHOWN.
- 2 MATERIAL: HOUSING - GLASS FILLED HIGH TEMP THERMO PLASTIC, UL94 V-0
POWER CONTACT - HIGH CONDUCTIVITY COPPER ALLOY
- 3 CONTACT PLATING: NOBLE METAL PLATING ON CONTACT FUNCTIONAL AREA OF POWER AND SIGNAL CONTACTS
- 4 MECHANICAL CONNECTOR KEEP OUT ZONE.
- 5 DATUM AND BASIC DIMENSIONS ESTABLISHED BY CUSTOMER.
- 6 PCB- ALL HOLE DIAMETERS ARE FINISHED HOLE SIZES.
- 7 PCB - .0453±.0010 DRILLED HOLES WITH .0003 MIN Sn OVER .001 TO .003 Cu PLATING TO ACHIEVE A .040±.003 DIA HOLE.
- 8 VARIABLE DIMENSIONS SHOWN ON VIEW (SHEET 3)
- 9 FOR DETAIL DIMENSION PLEASE REFER TO TABLE

| | | | | | | |
|-------|-------|-------|-------|-------|-------------|-------------|
| 3.750 | .200 | 3.800 | .450 | 4.100 | 17P | 1-6450123-8 |
| 1.150 | .300 | 1.200 | .450 | 1.500 | 3ACP | 1-6450123-6 |
| 1.725 | .375 | 1.775 | .475 | 2.075 | 4P | 1-6450123-5 |
| 2.700 | .300 | 2.750 | .475 | 3.050 | 8ACP | 1-6450123-4 |
| 1.300 | .200 | 1.350 | .425 | 1.650 | 5HDP | 1-6450123-2 |
| 5.550 | .200 | 5.600 | .450 | 5.900 | 26P | 1-6450123-1 |
| 1.750 | .200 | 1.800 | .450 | 2.100 | 7HDP | 1-6450123-0 |
| 2.300 | .250 | 2.350 | .450 | 2.650 | 8P | 6450123-8 |
| 1.700 | 8 | 1.750 | .425 | 2.050 | 6P | 6450123-7 |
| 1.550 | .250 | 1.600 | .450 | 1.900 | 5P | 6450123-6 |
| 2.050 | .250 | 2.100 | .450 | 2.400 | 7P | 6450123-5 |
| .800 | .250 | .850 | .450 | 1.150 | 2P | 6450123-4 |
| 1.200 | .300 | 1.250 | .475 | 1.550 | 3ACP | 6450123-3 |
| 1.300 | .250 | 1.350 | .450 | 1.650 | 4P | 6450123-2 |
| 1.050 | .250 | 1.100 | .450 | 1.400 | 3P | 6450123-1 |
| DIM U | DIM S | DIM D | DIM K | DIM L | DESCRIPTION | PART NUMBER |

THIS DRAWING IS A CONTROLLED DOCUMENT. DWN: R. GRZYBOWSKI, CHK: M. PERCHERKE, APVD: M. PERCHERKE

DIMENSIONS: INCHES. TOLERANCES UNLESS OTHERWISE SPECIFIED: 0 PLC ±.01, 1 PLC ±.01, 2 PLC ±.01, 3 PLC ±.005, 4 PLC ±.002, ANGLES ±.2°

MATERIAL: 2. FINISH: 3.

THIS DRAWING IS A CONTROLLED DOCUMENT. DWN: R. GRZYBOWSKI, CHK: M. PERCHERKE, APVD: M. PERCHERKE

PRODUCT SPEC: 108-1973

APPLICATION SPEC: 114-13038

WEIGHT: -

CUSTOMER DRAWING

SCALE: 4:1

SHEET 1 OF 8

REV: C6

STE TE Connectivity

RIGHT ANGLE HEADER ASSEMBLY W/GUIDES MULTI-BEAM XL

SIZE: A100779 C=6450123

| PART NUMBER | ROWS | POWER | | |
|-------------|------------------|-------|----|----|
| | | P1 | P2 | P3 |
| 6450123-1 | D C B A | PM | PM | PM |
| 3P | | HD | | HD |

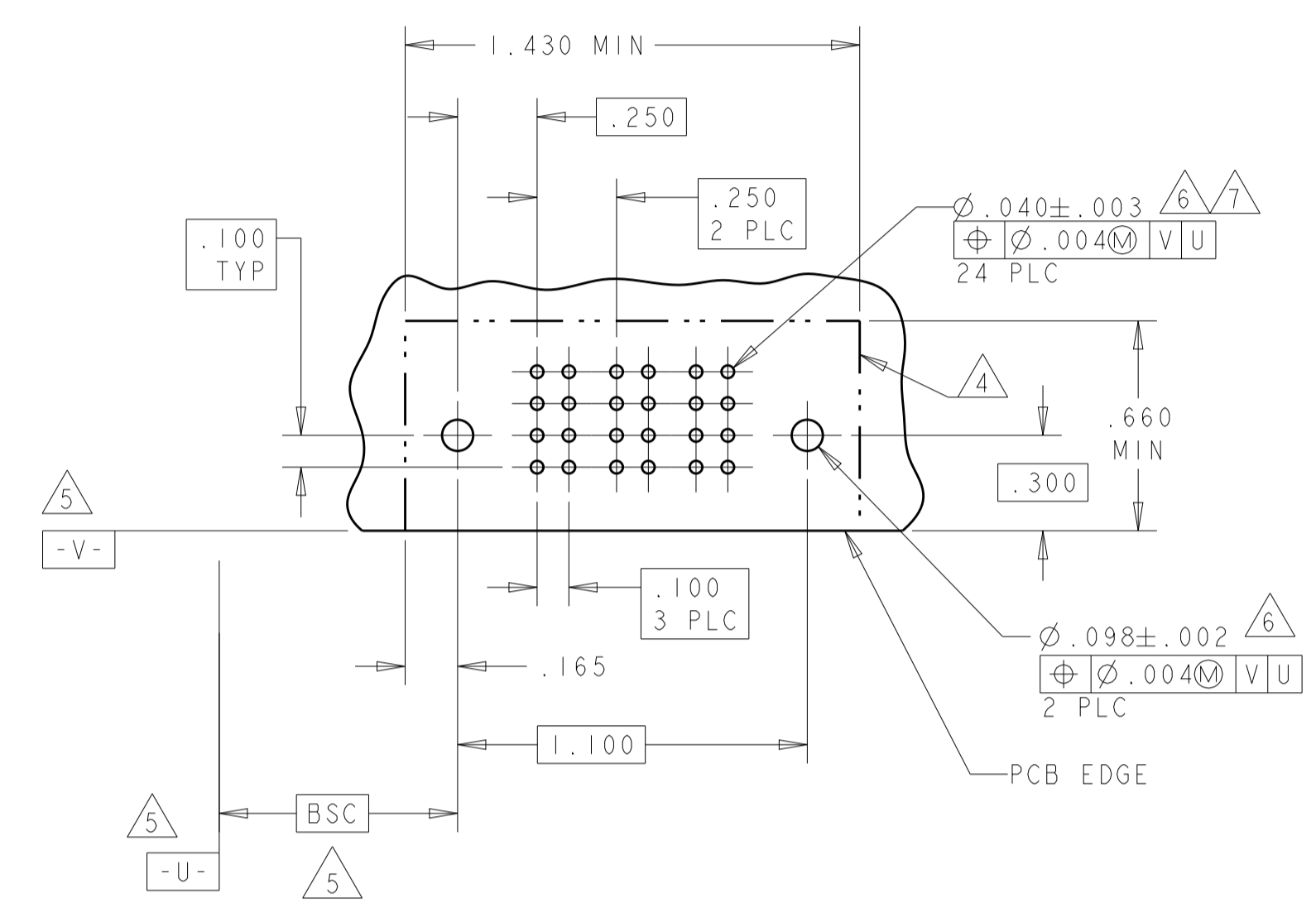

| PART NUMBER | ROWS | POWER | | |
|-------------|------------------|-------|----|----|
| | | P1 | P2 | P3 |
| 6450123-3 | D C B A | PM | PM | PM |
| 3ACP | | HD | | HD |

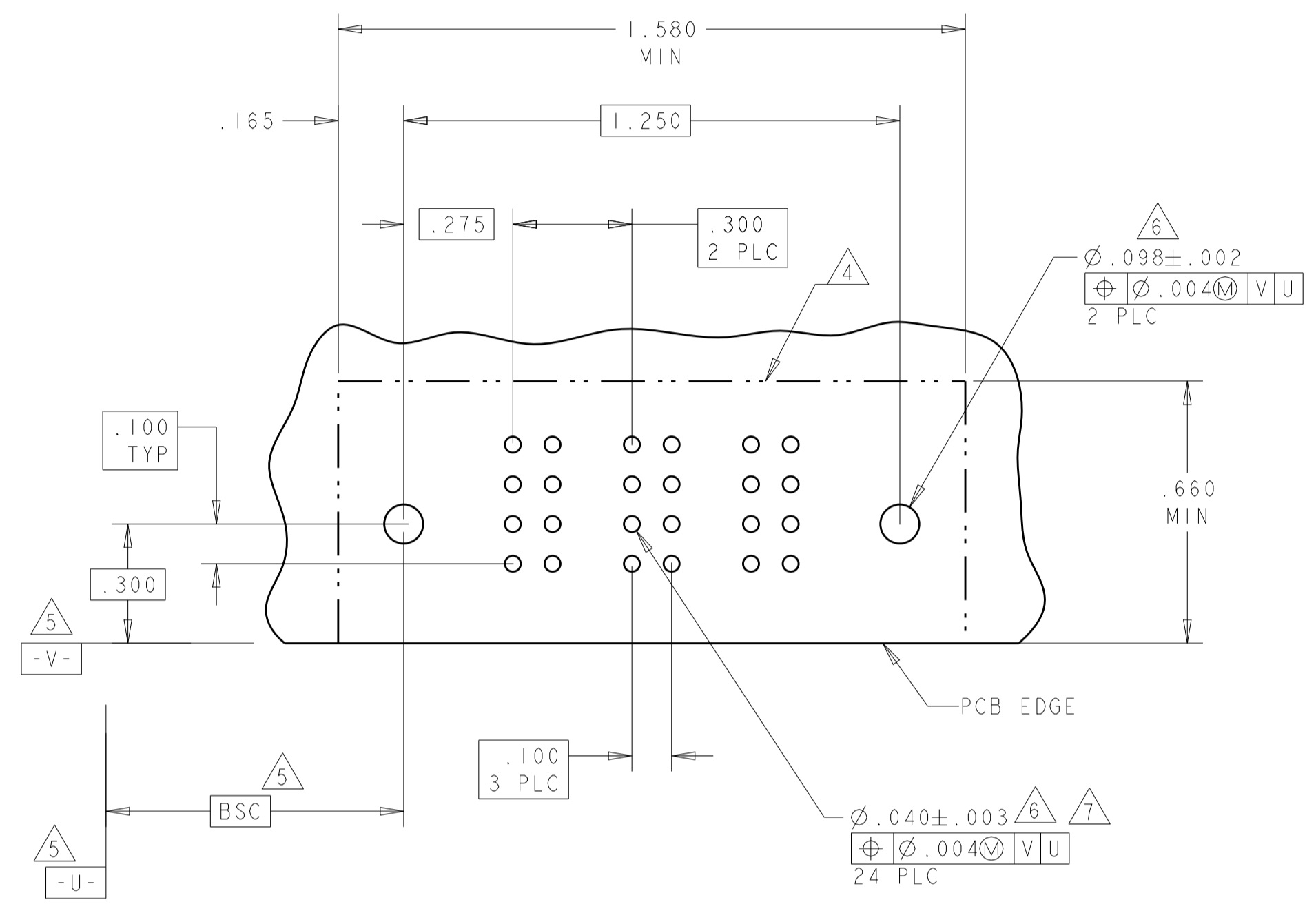

| PART NUMBER | ROWS | POWER | | | |
|-------------|------------------|-------|----|----|----|
| | | P1 | P2 | P3 | P4 |
| 6450123-2 | D C B A | PM | PM | PM | PM |
| 4P | | HD | | | HD |

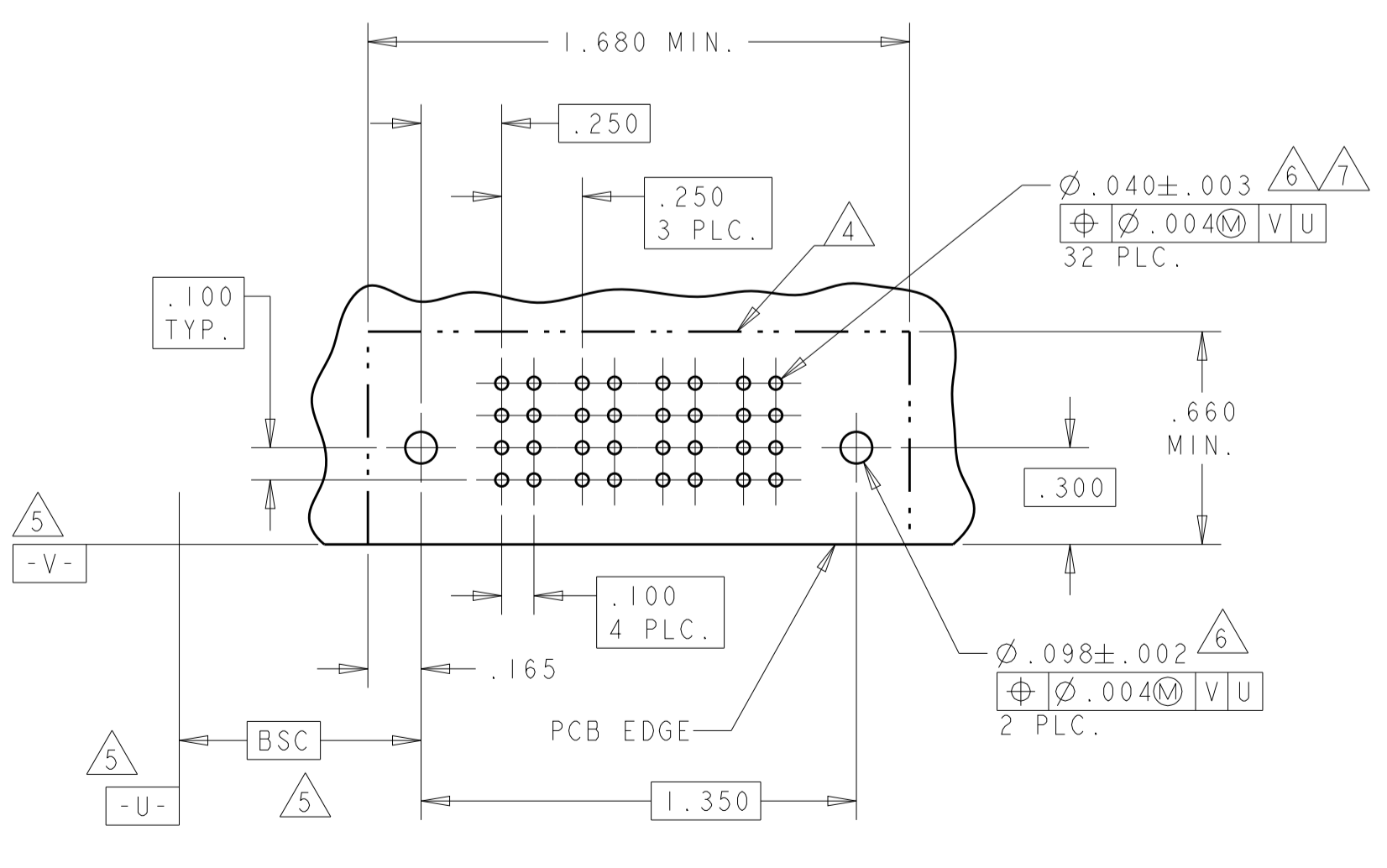

| PART NUMBER | ROWS | POWER | |
|-------------|------------------|-------|----|
| | | P1 | P2 |
| 6450123-4 | D C B A | PM | PM |
| 2P | | HD | HD |

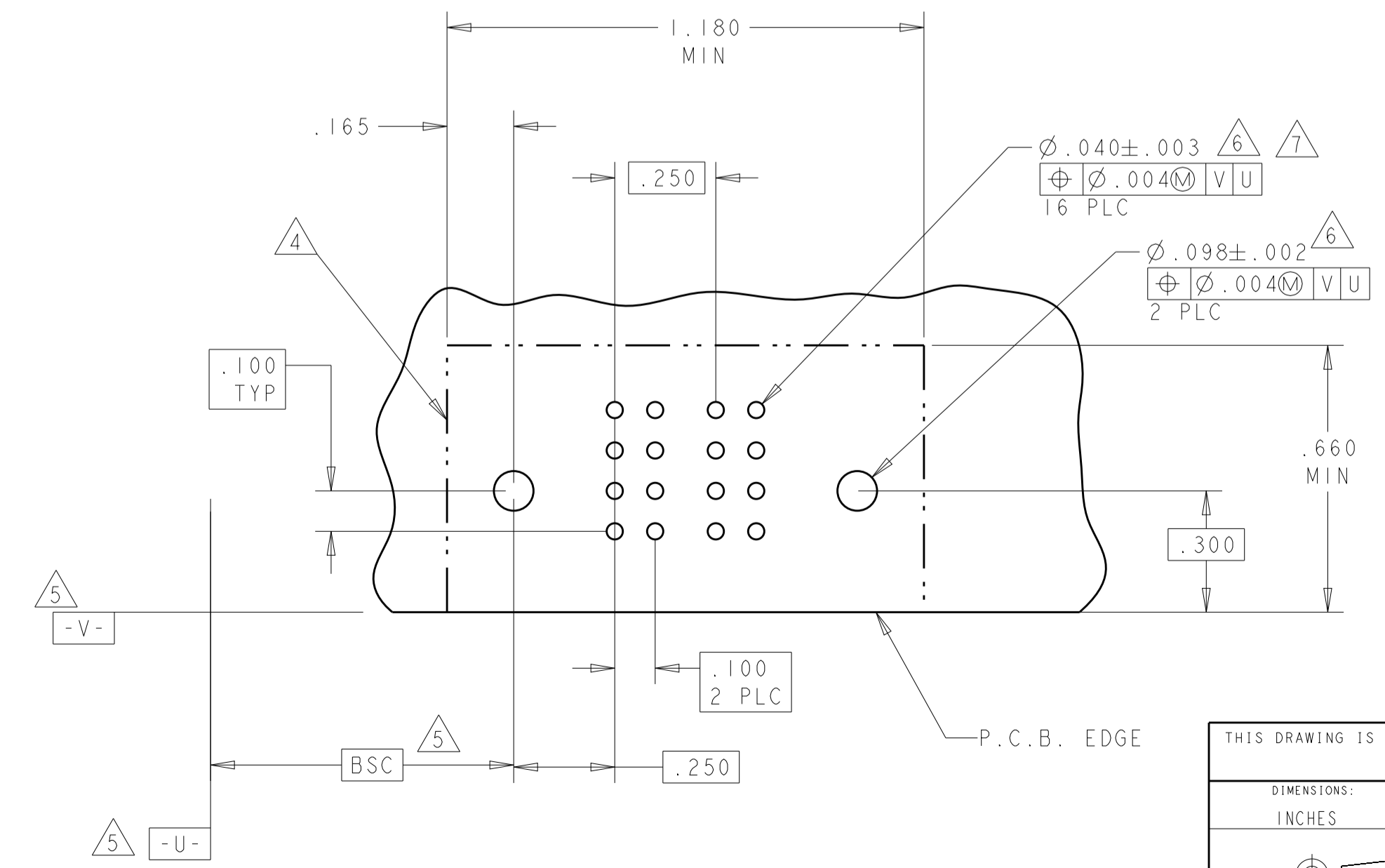

| | |
|---------------|-------------|
| PA | .090 |
| PM | .135 |
| CODE | TAIL LENGTH |
| POWER CONTACT | |

THIS DRAWING IS A CONTROLLED DOCUMENT.

| | | | |
|------------------|--|--|------------------|
| DIMENSIONS: | TOLERANCES UNLESS OTHERWISE SPECIFIED: | DWN: R. GRZYBOWSKI | TOFEB05 |
| INCHES | 0 PLC ±.01 | CHK: M. PERCHERKE | TOFEB05 |
| | 1 PLC ±.01 | APVD: M. PERCHERKE | |
| | 2 PLC ±.01 | NAME: RIGHT ANGLE HEADER ASSEMBLY W/GUIDES | |
| | 3 PLC ±.005 | PRODUCT SPEC: 108-1973 | |
| | 4 PLC ±.002 | APPLICATION SPEC: 114-13038 | |
| | ANGLES ±.020 | SIZE: 114-13038 | |
| MATERIAL: | FINISH: | WEIGHT: | RESTRICTED TO: |
| | | | A100779C=6450123 |
| CUSTOMER DRAWING | | SCALE: 4:1 | SHEET 2 OF 8 |

STE TE Connectivity

| PART NUMBER | ROWS | POWER | | | | | | |
|-------------|------------------|-------|----|----|----|----|----|----|
| | | P1 | P2 | P3 | P4 | P5 | P6 | P7 |
| 6450123-5 | D C B A | PA | PA | PA | PA | PA | PA | PA |
| 7P | | | | | | | | |

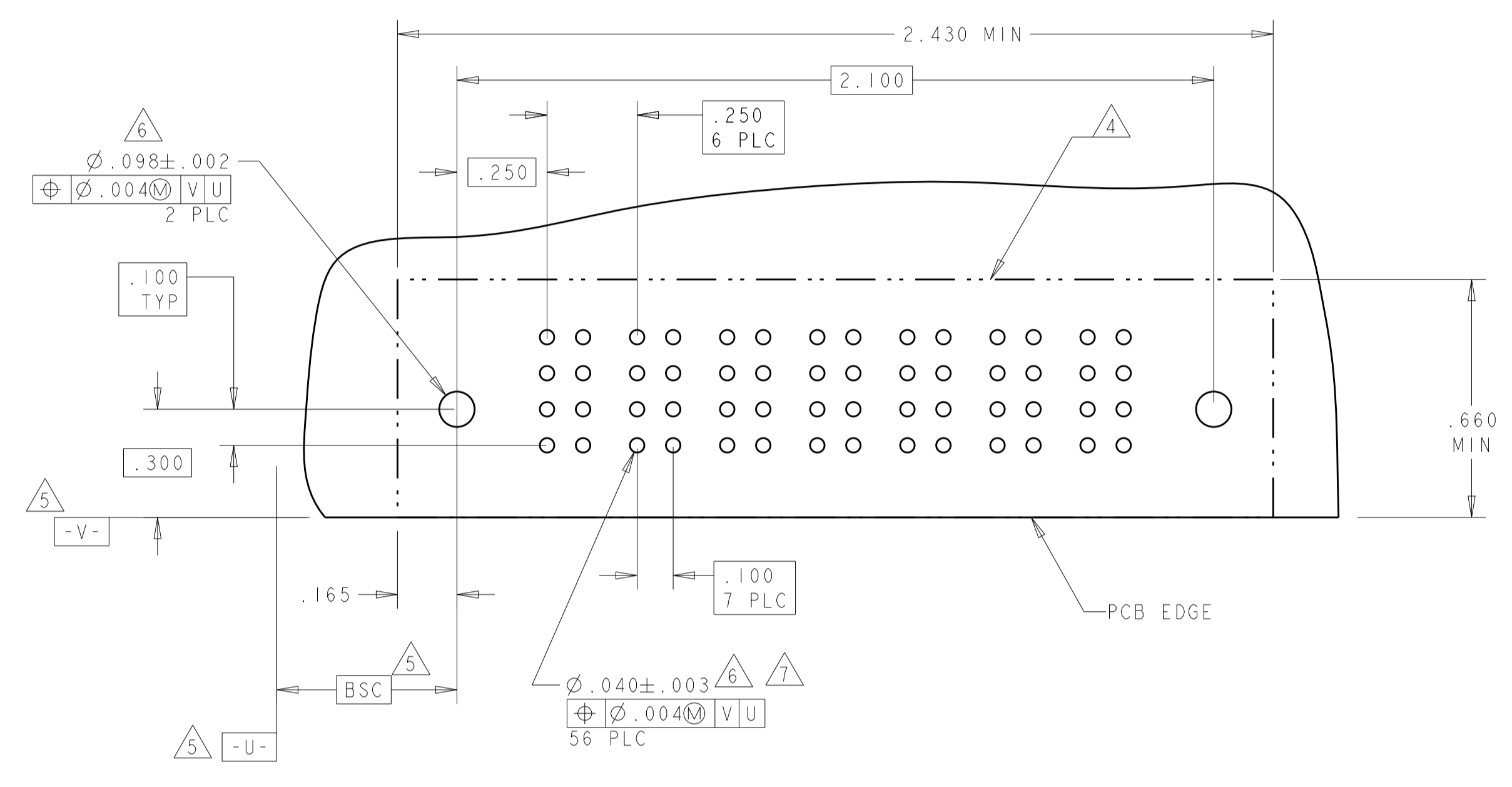

| PART NUMBER | ROWS | POWER | | | | | |
|-------------|------------------|-------|----|----|----|----|----|
| | | P1 | P2 | P3 | P4 | P5 | P6 |
| 6450123-7 | D C B A | PM | PM | PM | PM | PM | PM |
| 6P | | | | | | | |

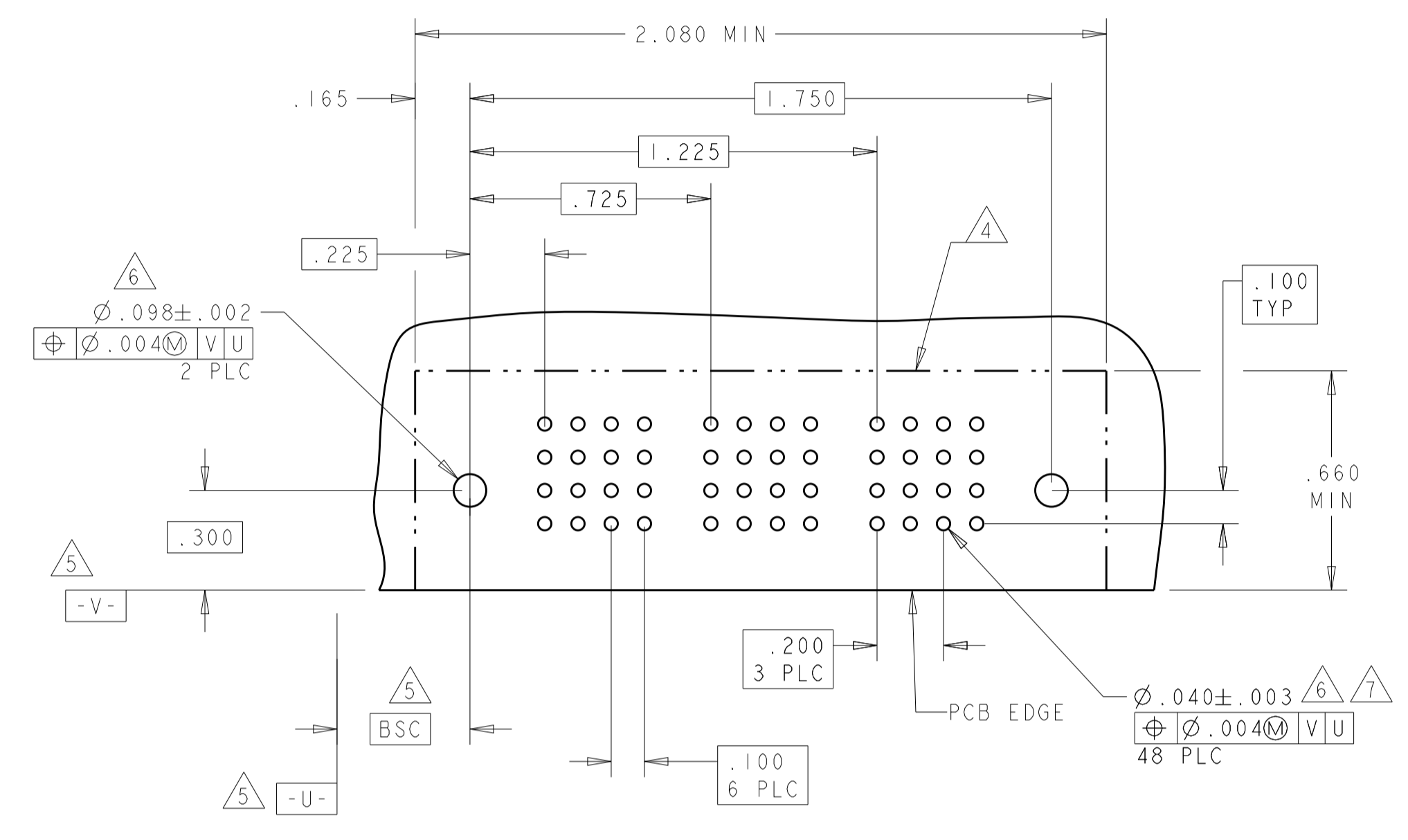

| PART NUMBER | ROWS | POWER | | | | |
|-------------|------------------|-------|----|----|----|----|
| | | P1 | P2 | P3 | P4 | P5 |
| 6450123-6 | D C B A | PM | PM | PM | PM | PM |
| 5P | | | | | | |

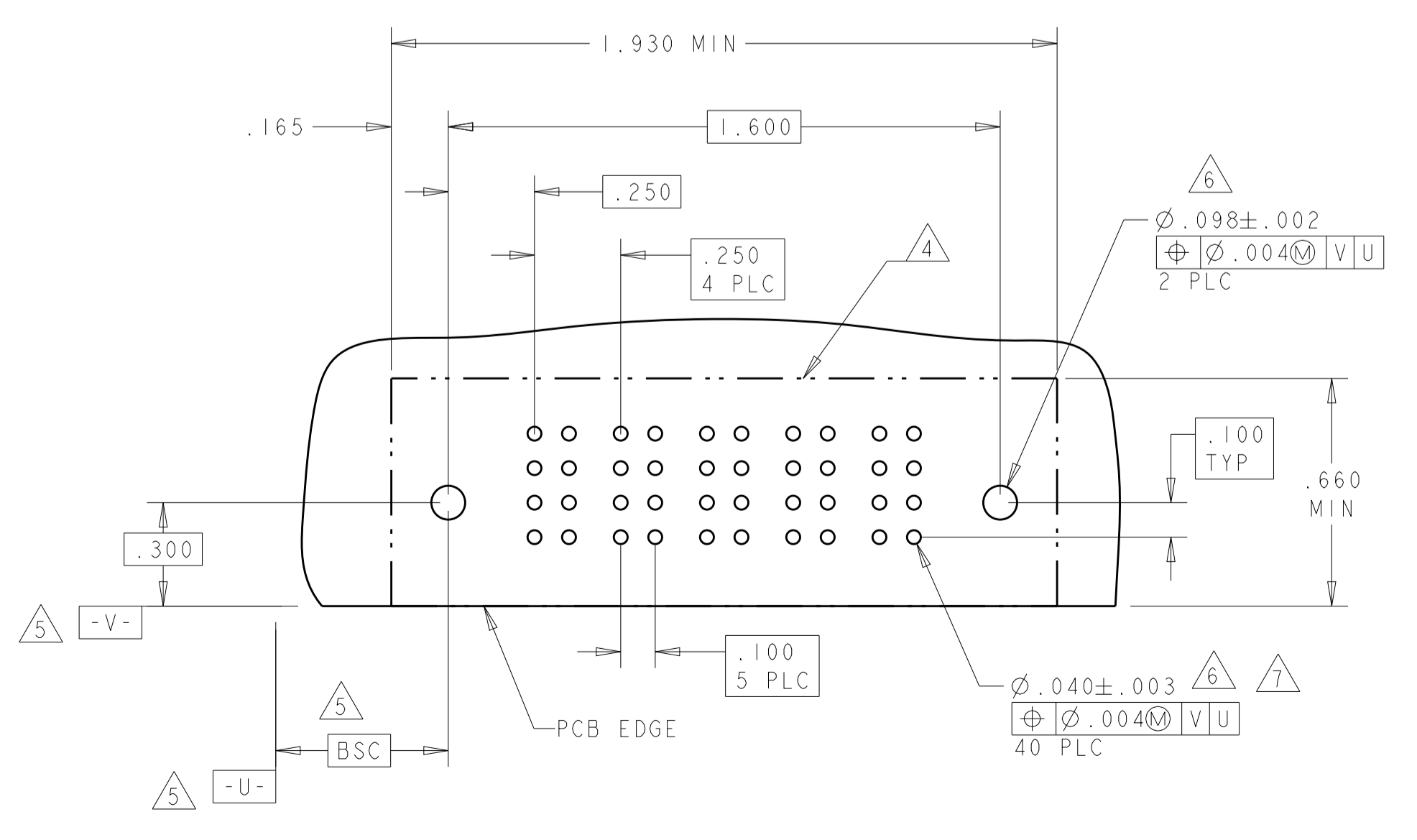

| PART NUMBER | ROWS | POWER | | | | | | | |
|-------------|------------------|-------|----|----|----|----|----|----|----|
| | | P1 | P2 | P3 | P4 | P5 | P6 | P7 | P8 |
| 6450123-8 | D C B A | PM | PM | PM | PM | PM | PM | PM | PM |
| 8P | | | | | | | | | |

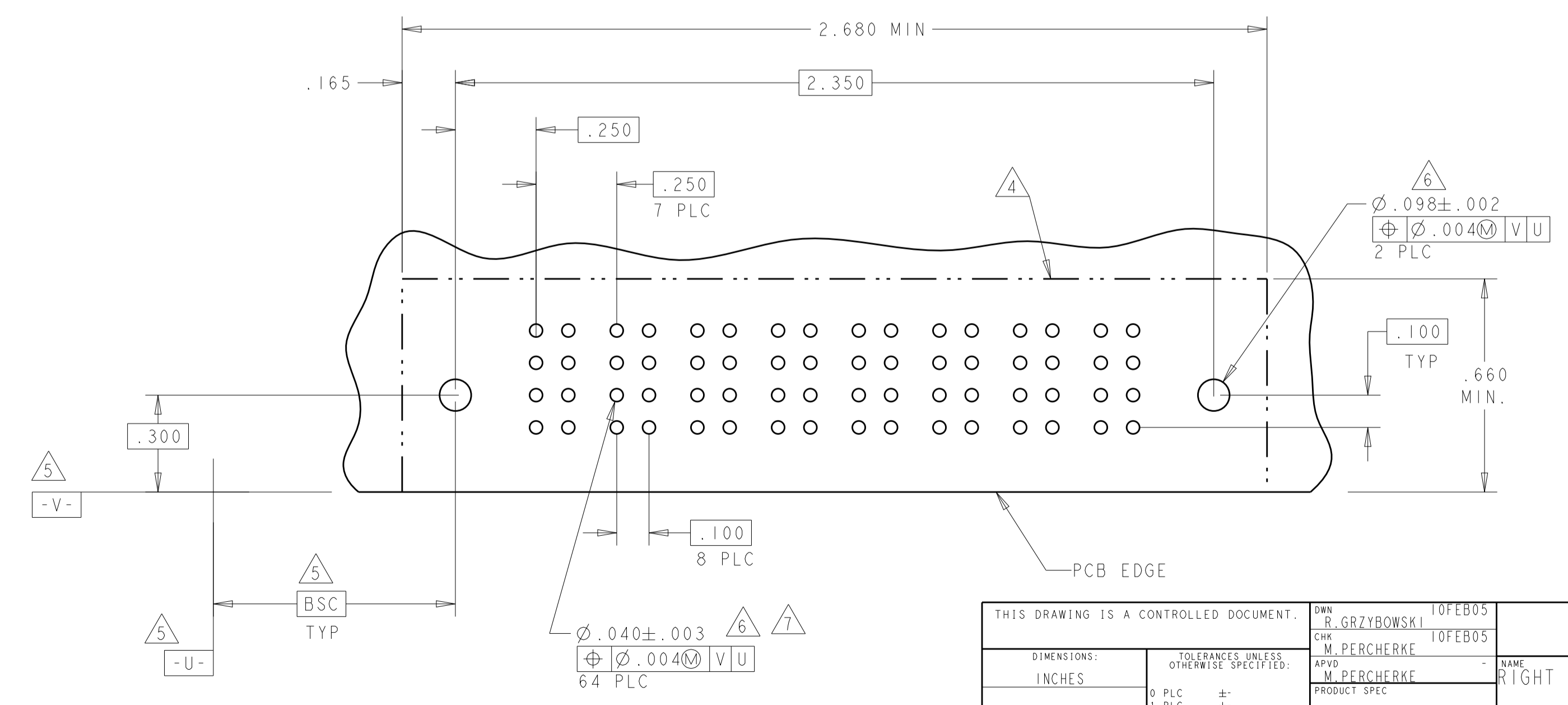

| | | | | |
|---|--|------------------------|--|---|
| THIS DRAWING IS A CONTROLLED DOCUMENT. | | OWN: R. GRZYBOWSKI | TOFEB05 | TE Connectivity |
| DIMENSIONS: INCHES | | CHK: M. PERCHERKE | TOFEB05 | |
| TOLERANCES UNLESS OTHERWISE SPECIFIED: | | APVD: M. PERCHERKE | NAME: RIGHT ANGLE HEADER ASSEMBLY W/GUIDES MULTI-BEAM XL | SIZE: CAGE CODE: DRAWING NO: A100779 SCALE: 4:1 SHEET 3 OF 8 REV: C6 |
| 0 PLC ±.01 1 PLC ±.01 2 PLC ±.01 3 PLC ±.01 4 PLC ±.01 ANGLES ±.0020 | | PRODUCT SPEC: 108-1973 | APPLICATION SPEC: 114-13038 | |
| MATERIAL: FINISH: | | WEIGHT: 114-13038 | | CUSTOMER DRAWING |

| LOC | DIST | REVISIONS | | | | | |
|-----|------|-----------|-----|-------------|------|-----|------|
| GP | 00 | P | LTN | DESCRIPTION | DATE | DMN | APVD |
| | | - | | SEE SHEET 1 | | | |

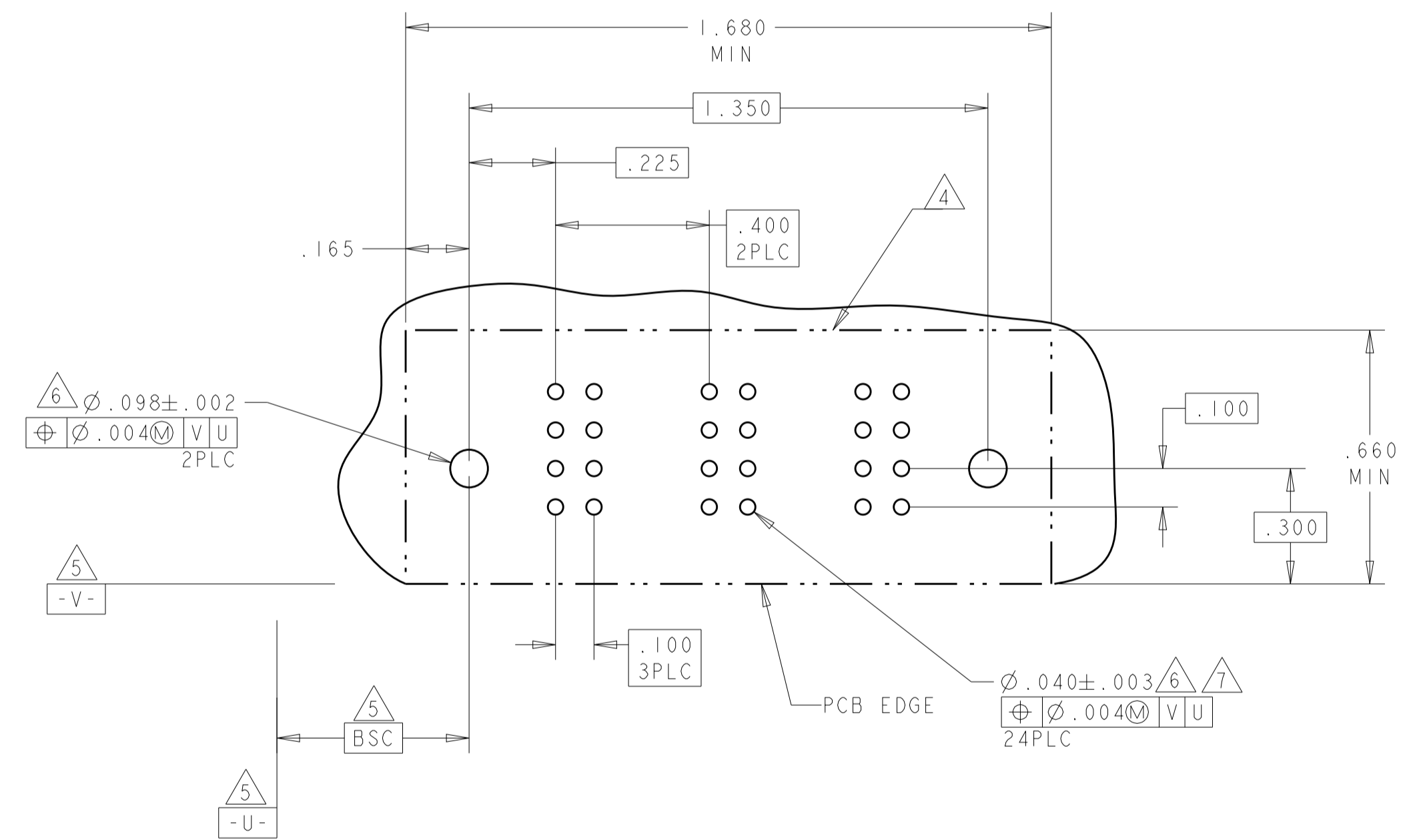
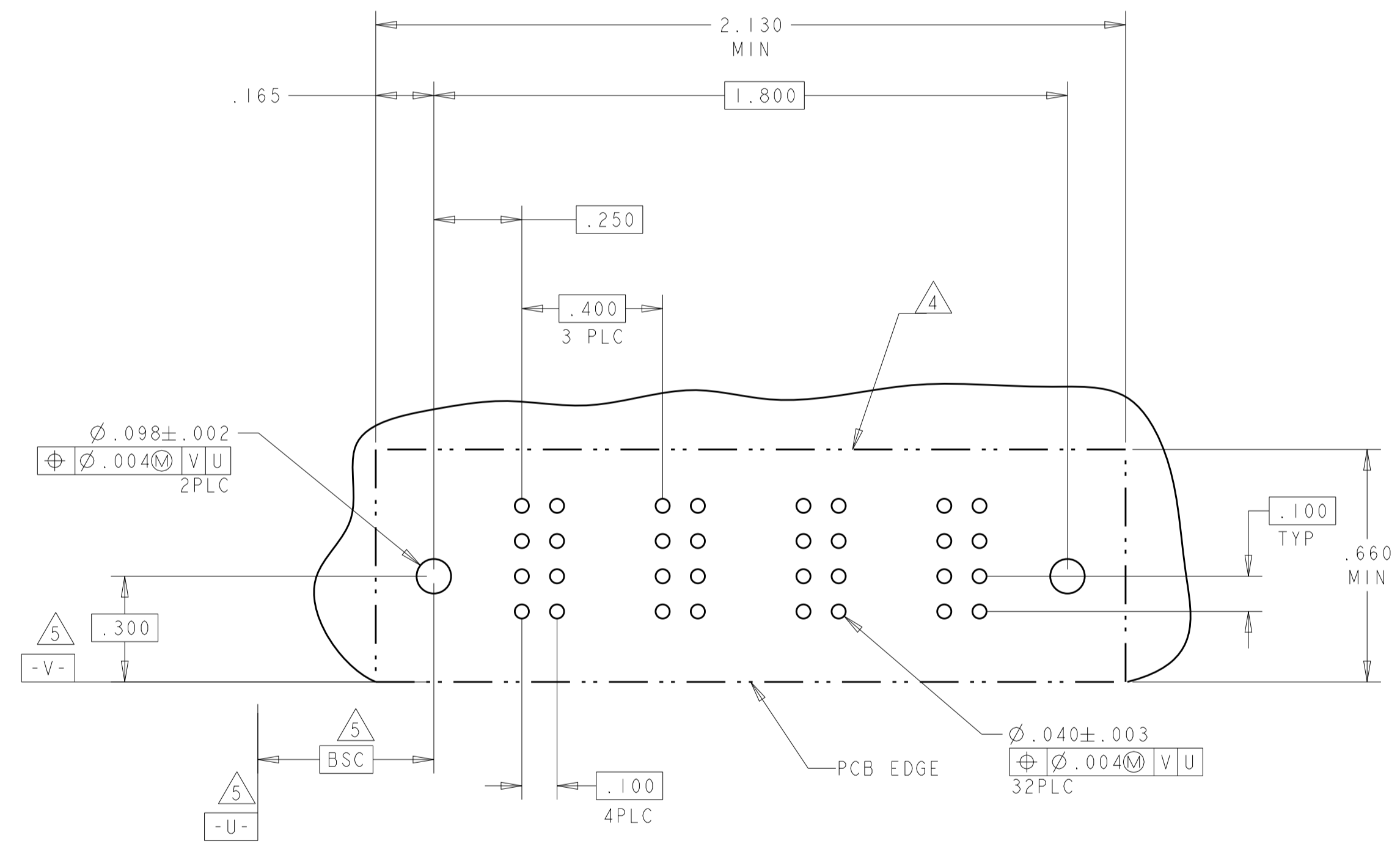
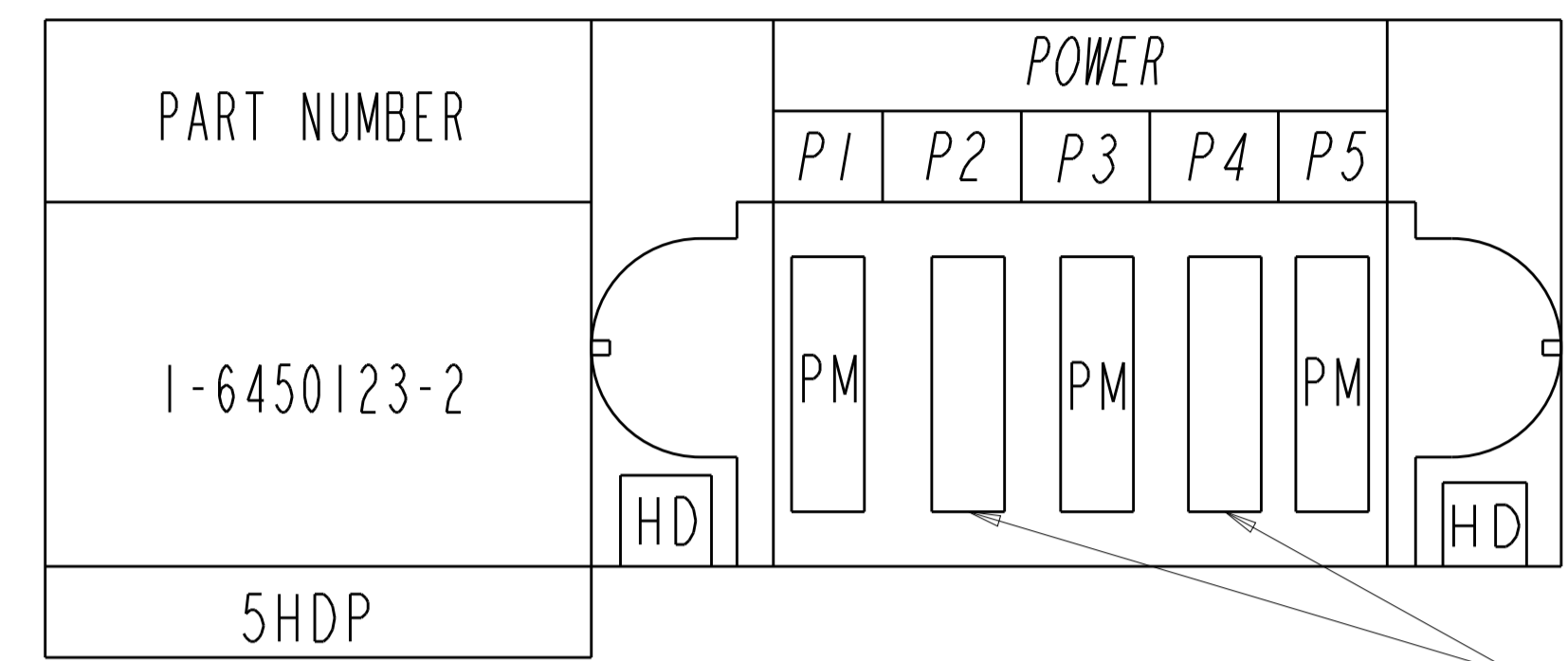
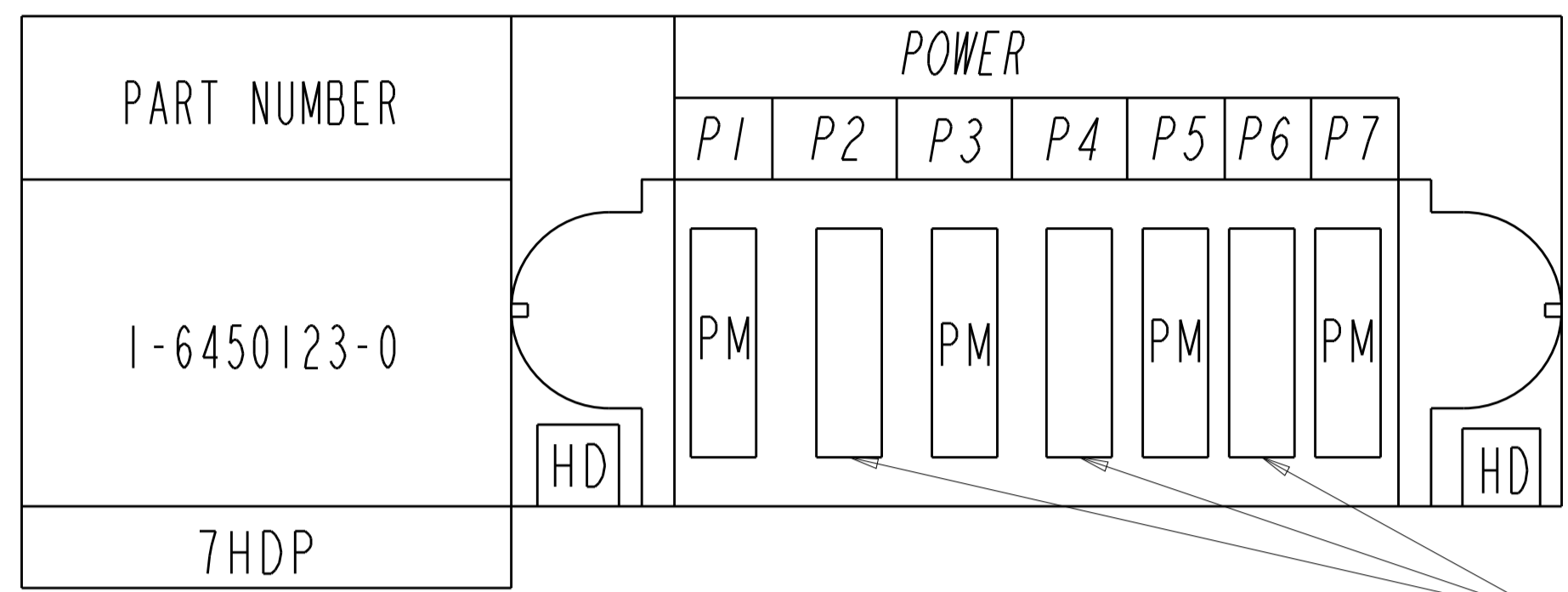

| | | | | |
|---|--|--|---------|--|
| THIS DRAWING IS A CONTROLLED DOCUMENT. | | DMN: R. GRZYBOWSKI | TOFEB05 | TE Connectivity |
| DIMENSIONS: INCHES | | CHK: M. PERCHERKE | TOFEB05 | |
| DIMENSIONS: INCHES 0 PLC ± 1 PLC ±.01 2 PLC ±.01 3 PLC ±.005 4 PLC ±.0020 ANGLES ±.2° | | TOLERANCES UNLESS OTHERWISE SPECIFIED: APVD: M. PERCHERKE PRODUCT SPEC: 108-1973 APPLICATION SPEC: 114-13038 WEIGHT: - | | NAME: RIGHT ANGLE HEADER ASSEMBLY W/GUIDES MULTI-BEAM XL SIZE: A1 CAGE CODE: 100779 DRAWING NO: 6450123 |
| MATERIAL: - | | CUSTOMER DRAWING | | RESTRICTED TO: - SCALE: 4:1 SHEET: 4 OF 8 REV: C6 |

| LOC | DIST | REVISIONS | | | |
|-----|------|-------------|------|-----|------|
| P | LTN | DESCRIPTION | DATE | DWN | APVD |
| - | - | SEE SHEET 1 | - | - | - |
| | | | | | |
| | | | | | |

| PART NUMBER | ROWS | POWER | | | | | | | | | | | | | | | | | | | | | | | | | |
|-------------|------------------|-------|----|----|----|----|----|----|----|----|-----|-----|-----|-----|-----|-----|-----|-----|-----|-----|-----|-----|-----|-----|-----|-----|-----|
| | | P1 | P2 | P3 | P4 | P5 | P6 | P7 | P8 | P9 | P10 | P11 | P12 | P13 | P14 | P15 | P16 | P17 | P18 | P19 | P20 | P21 | P22 | P23 | P24 | P25 | P26 |
| 1-6450123-1 | D C B A | PM | PM | PM | PM | PM | PM | PM | PM | PM | PM | PM | PM | PM | PM | PM | PM | PM | PM | PM | PM | PM | PM | PM | PM | PM | PM |
| 26P | | | | | | | | | | | | | | | | | | | | | | | | | | | |

NO CONTACTS LOADED

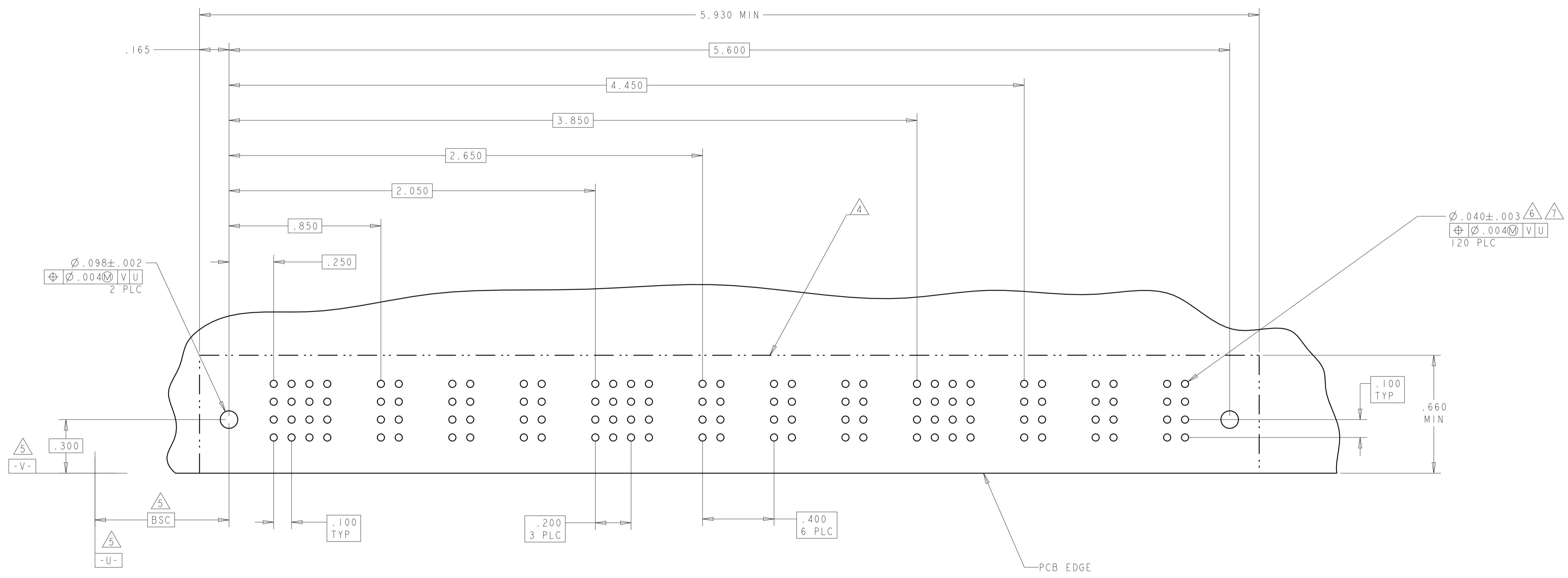

THIS DRAWING IS A CONTROLLED DOCUMENT.

| | | | | | |
|-----------------------|--|---|--------------------------------|---------------------|--|
| DIMENSIONS: INCHES | TOLERANCES UNLESS OTHERWISE SPECIFIED: 0 PLC ±. 1 PLC ±.01 2 PLC ±.01 3 PLC ±.005 4 PLC ±.0020 ANGLES ±.7° | DWN: R. GRZYBOWSKI CHK: M. PERCHERKE APVD: M. PERCHERKE | 10FEB05 10FEB05 | TE Connectivity | NAME: RIGHT ANGLE HEADER ASSEMBLY W/GUIDES MULTI-BEAM XL |
| MATERIAL: | FINISH: | PRODUCT SPEC: 108-1973 | APPLICATION SPEC: 114-13038 | | SIZE: A1 CAGE CODE: 00779 DRAWING NO: C=6450123 |

CUSTOMER DRAWING SCALE: 4:1 SHEET 5 OF 8 REV: C6

| LOC | DIST | REVISIONS | | | |
|-----|------|-------------|------|-----|------|
| P | LTN | DESCRIPTION | DATE | DMN | APVD |
| - | - | SEE SHEET 1 | - | - | - |
| | | | | | |
| | | | | | |

| PART NUMBER | ROWS | POWER | | | | | | | |
|-------------|------------------|-------|----|----|----|----|----|----|----|
| | | P1 | P2 | P3 | P4 | P5 | P6 | P7 | P8 |
| 1-6450123-4 | D C B A | PM | PM | PM | PM | PM | PM | PM | PM |
| 8P | | HD | | | | | | | HD |

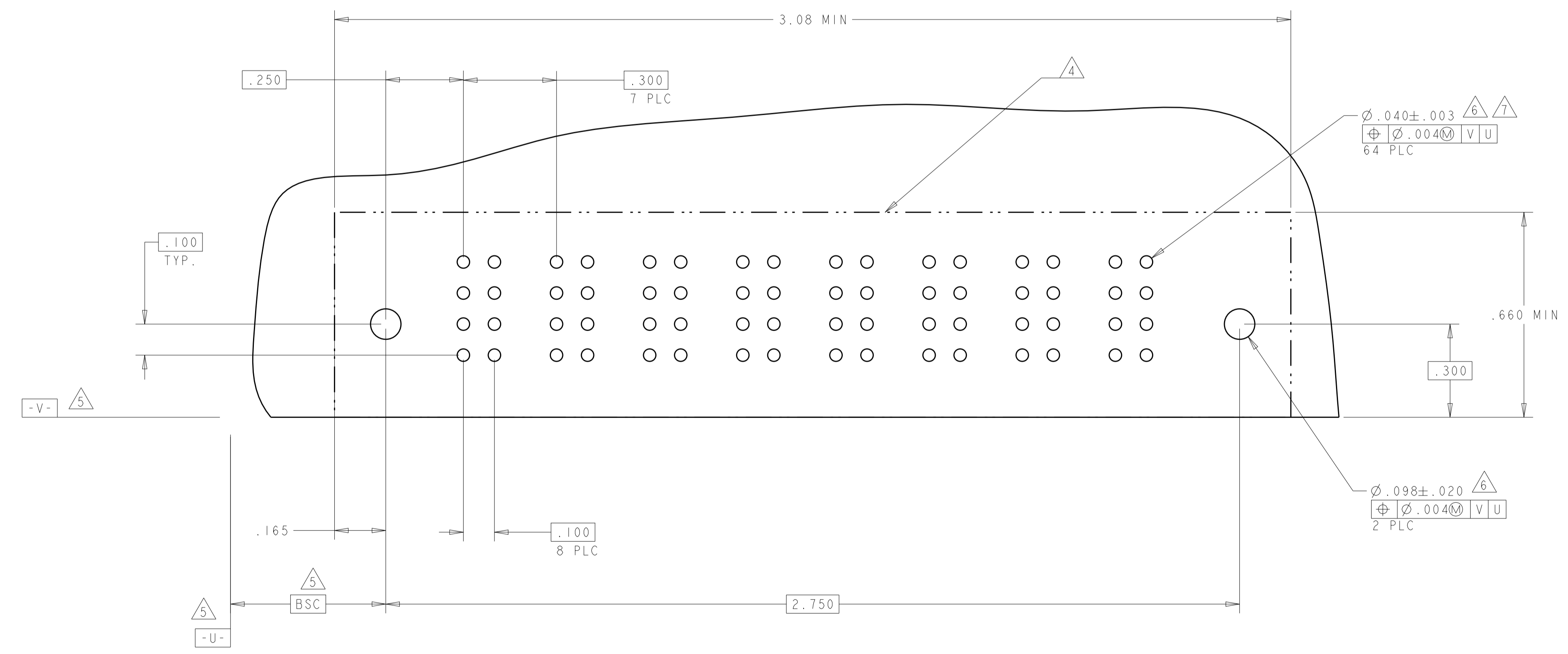

| | | | | |
|--|--|------------------------|--|-----------------|
| THIS DRAWING IS A CONTROLLED DOCUMENT. | | DMN: R. GRZYBOWSKI | 10FEB05 | TE Connectivity |
| DIMENSIONS: INCHES | | CHK: M. PERCHERKE | 10FEB05 | |
| TOLERANCES UNLESS OTHERWISE SPECIFIED: 0 PLC ±. 1 PLC ±.01 2 PLC ±.01 3 PLC ±.005 4 PLC ±.0020 ANGLES ±.2° | | APVD: M. PERCHERKE | NAME: RIGHT ANGLE HEADER ASSEMBLY W/GUIDES MULTI-BEAM XL | RESTRICTED TO: |
| MATERIAL: - | | PRODUCT SPEC: 108-1973 | APPLICATION SPEC: 114-13038 | SIZE: A1 |
| FINISH: - | | WEIGHT: - | SCALE: 4:1 | SHEET 6 OF 8 |
| CUSTOMER DRAWING | | DRAWING NO: 6450123 | | REV: C6 |

| LOC | DIST | REVISIONS | | | |
|-----|------|-------------|------|-----|------|
| P | LTN | DESCRIPTION | DATE | DMN | APVD |
| GP | 00 | SEE SHEET 1 | - | - | - |

| PART NUMBER | ROWS | POWER | | | |
|-------------|------------------|-------|----|----|----|
| | | P1 | P2 | P3 | P4 |
| 1-6450123-5 | D C B A | PM | PM | PM | PM |
| 4P | | HD | | | HD |

| PART NUMBER | ROWS | POWER | | |
|-------------|------------------|-------|----|----|
| | | P1 | P2 | P3 |
| 1-6450123-6 | D C B A | PM | PM | PM |
| 3ACP | | HD | | HD |

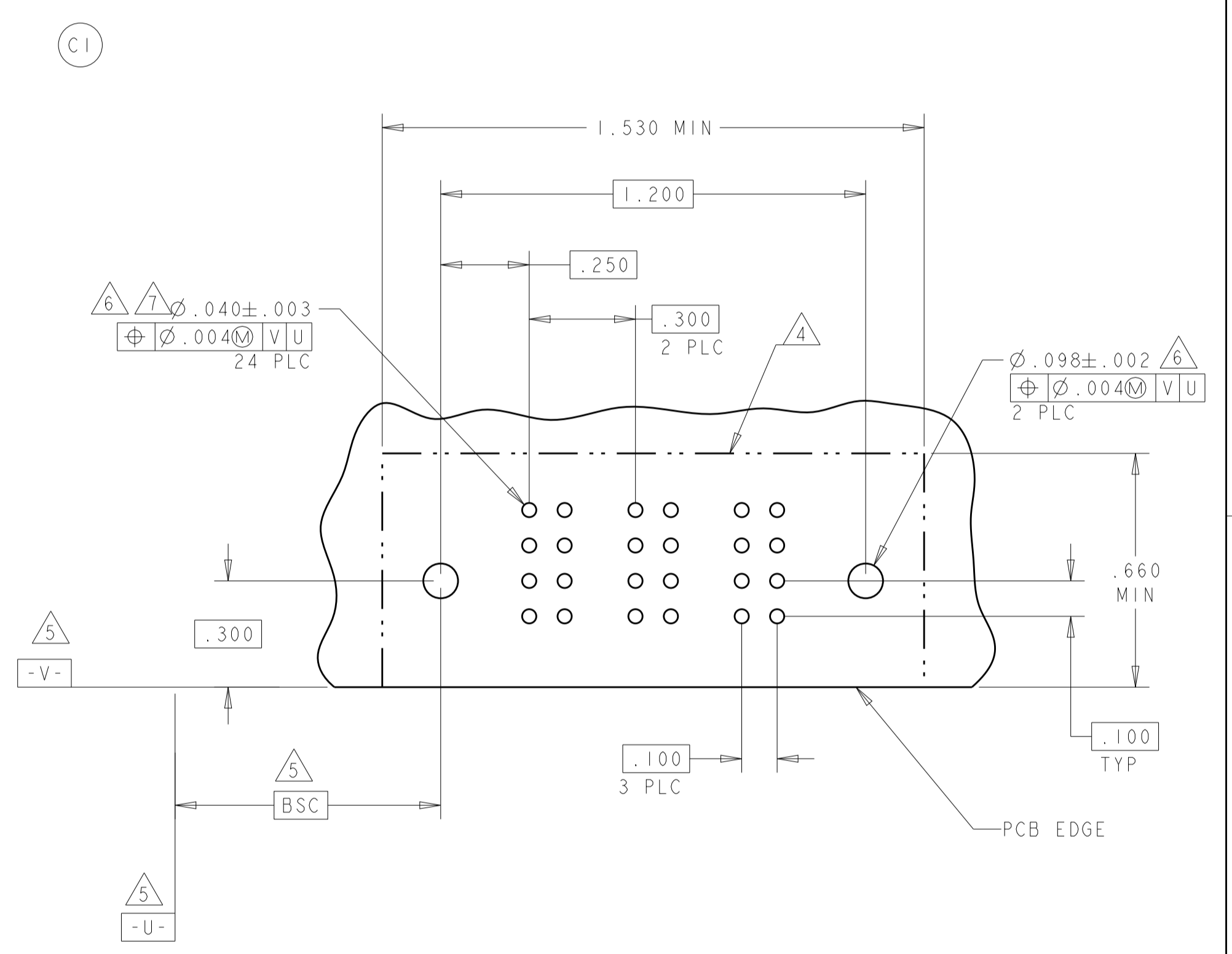
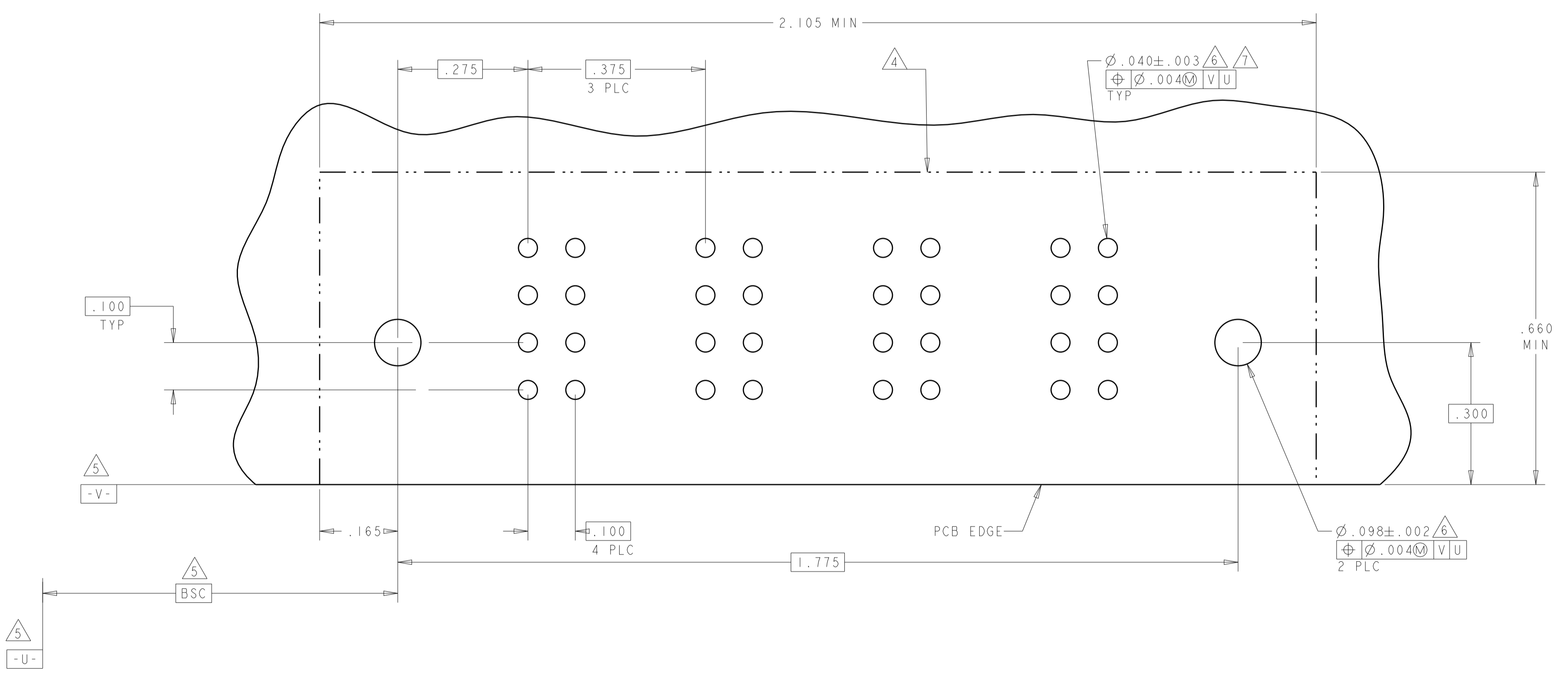

| | | | | |
|--|--|-----------------------------|--|----------------------------|
| THIS DRAWING IS A CONTROLLED DOCUMENT. | | DMN: R. GRZYBOWSKI | TOFEB05 | STE TE Connectivity |
| DIMENSIONS: INCHES | | CHK: M. PERCHERKE | TOFEB05 | |
| TOLERANCES UNLESS OTHERWISE SPECIFIED: | | APVD: M. PERCHERKE | NAME: RIGHT ANGLE HEADER ASSEMBLY W/GUIDES MULTI-BEAM XL | RESTRICTED TO |
| 0 PLC ± .01 | | PRODUCT SPEC: 108-1973 | SIZE: CAGE CODE: DRAWING NO: A100779C=6450123 | |
| 1 PLC ± .01 | | APPLICATION SPEC: 114-13038 | SCALE: 4:1 | SHEET 7 OF 8 |
| 2 PLC ± .01 | | WEIGHT: - | REV: C6 | |
| 3 PLC ± .005 | | CUSTOMER DRAWING | | |
| 4 PLC ± .0020 | | | | |
| ANGLES ± .2° | | | | |
| FINISH: - | | | | |

| LOC | DIST | REVISIONS | | | |
|-----|------|-------------|------|-----|------|
| P | LTN | DESCRIPTION | DATE | DMN | APVD |
| - | - | SEE SHEET 1 | - | - | - |

| PART NUMBER | ROWS | POWER | | | | | | | | | | | | | | | | |
|-------------|------------------|-------|----|----|----|----|----|----|----|----|-----|-----|-----|-----|-----|-----|-----|-----|
| | | P1 | P2 | P3 | P4 | P5 | P6 | P7 | P8 | P9 | P10 | P11 | P12 | P13 | P14 | P15 | P16 | P17 |
| I-6450123-8 | D C B A | PM | | | | | | | | | | | | | | | | |
| | | HD | | | | | | | | | | | | | | | | |
| 17P | | | | | | | | | | | | | | | | | | |

FOR PART I-6450123-8 MAX OPERATING VOLTAGE: 480VAC AND WITHSTAND HOT PLUG WITH 480VAC 0.1A

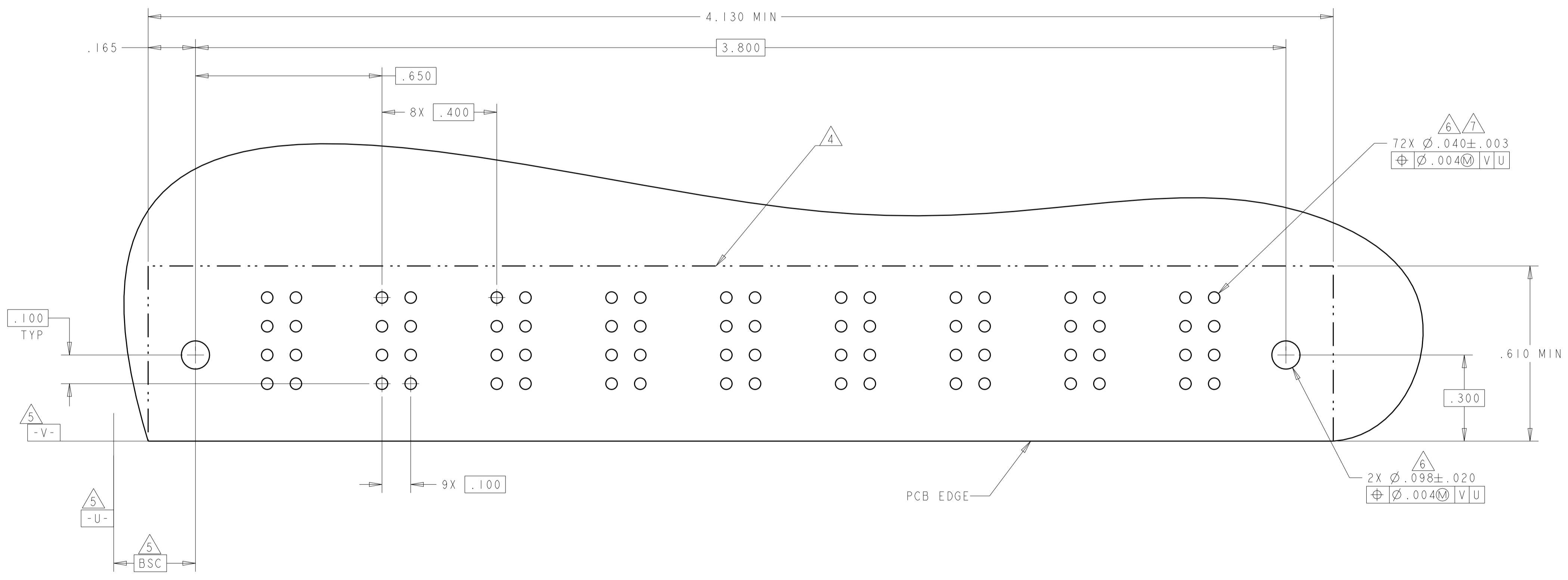
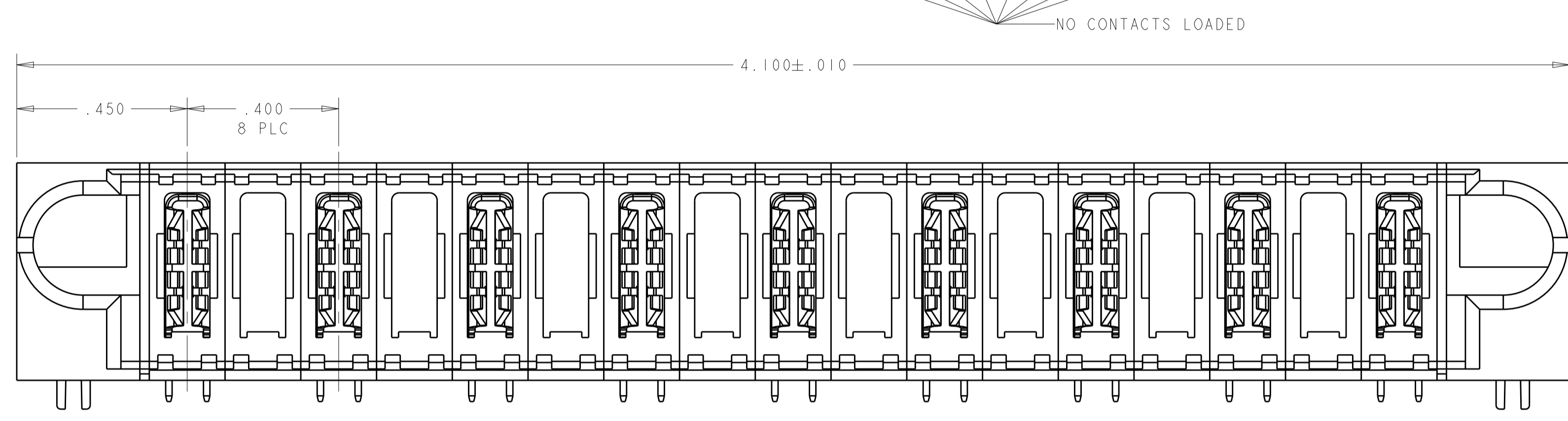

| | | | | |
|--|--|--------------------------|---|--|
| THIS DRAWING IS A CONTROLLED DOCUMENT. | | DMN R. GRZYBOWSKI | 10FEB05 | TE Connectivity |
| DIMENSIONS: INCHES | | CHK M. PERCHERKE | 10FEB05 | |
| TOLERANCES UNLESS OTHERWISE SPECIFIED: 0 PLC ±. 1 PLC ±.01 2 PLC ±.01 3 PLC ±.005 4 PLC ±.0020 ANGLES ±.0° | | APVD M. PERCHERKE | NAME RIGHT ANGLE HEADER ASSEMBLY W/GUIDES MULTI-BEAM XL | SIZE CAGE CODE DRAWING NO A100779 C=6450123 |
| MATERIAL | | PRODUCT SPEC 108-1973 | APPLICATION SPEC 114-13038 | |
| FINISH | | WEIGHT | CUSTOMER DRAWING | SCALE 4:1 SHEET 8 OF 8 REV C6 |

单击下面可查看定价，库存，交付和生命周期等信息

[>>TE Connectivity\(泰科\)](#)