

THIS DRAWING IS UNPUBLISHED. RELEASED FOR PUBLICATION
 © COPYRIGHT - By - ALL RIGHTS RESERVED.

LOC	DIST	REVISIONS			
P	LTR	DESCRIPTION	DATE	DWN	APVD
DF	X5	B	REVISED PER ECO-15-008253	24JUN2015	RS CT

COMPONENT	MATERIAL	FINISH
HOUSING	BRASS PER ASTM-B-16	GOLD PLATED PER ASTM-B-488 OVER NICKEL PER SAE AMS QQ-N-290
SHRINK TUBING	HEAT SHRINKABLE POLYOLEFIN COMPOUND PER MIL-I-23053/4	-
CENTER CONTACT	BERYLLIUM COPPER PER ASTM-B-196	GOLD PLATED PER ASTM-B-488 OVER NICKEL PER SAE AMS QQ-N-290

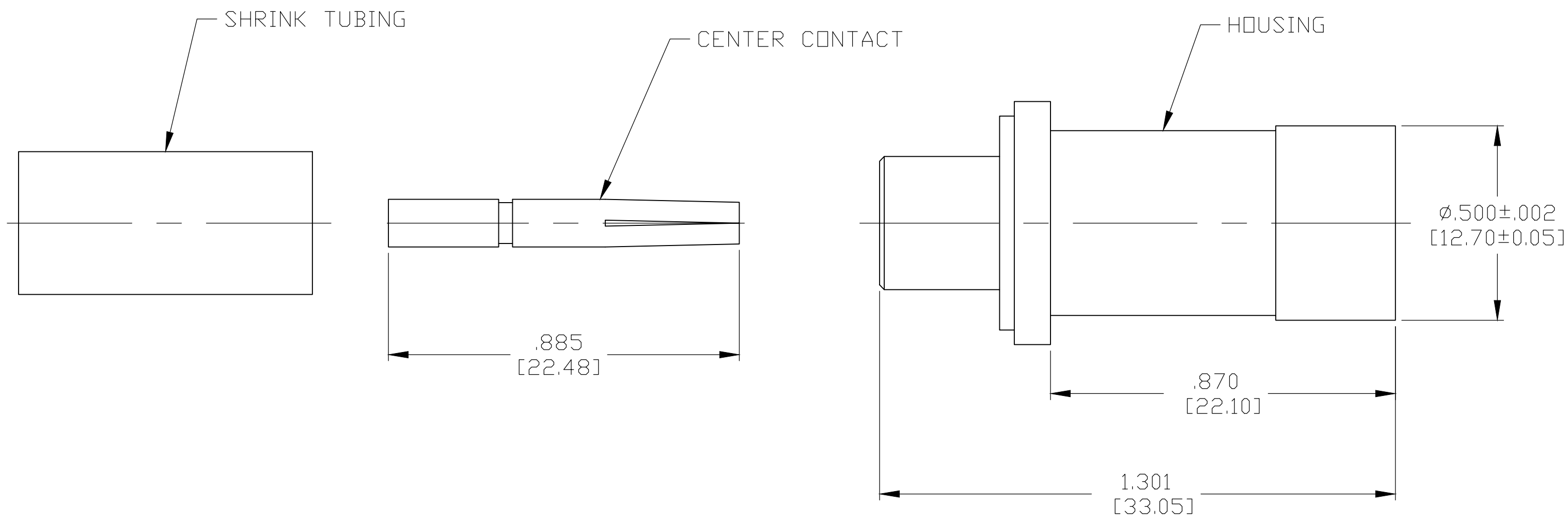

1757492-1
 PART NUMBER

DESIGNED FOR USE WITH TFLX 402 CABLE	THIS DRAWING IS A CONTROLLED DOCUMENT.		DWN 24JUN2015 RAGHAV SATISH	TE Connectivity SIZE 1 ARINC SOCKET CONTACT
CABLE ENTRY DIAMETER MIN	DIMENSIONS: INCHES [mm]	TOLERANCES UNLESS OTHERWISE SPECIFIED:	CHK 24JUN2015 CHARLES THOMAS	
HOUSING: .144 [3.66]		0 PLC ± -	APVD 24JUN2015 CHARLES THOMAS	
CONTACT: .040 [1.02]		1 PLC ± -	PRODUCT SPEC -	
	MATERIAL SEE TABLE	FINISH SEE TABLE	APPLICATION SPEC -	WEIGHT -
			CUSTOMER DRAWING	SCALE 4:1 SHEET 1 OF 1 REV B

单击下面可查看定价，库存，交付和生命周期等信息

[>>TE Connectivity\(泰科\)](#)