

THIS DRAWING IS UNPUBLISHED.

RELEASED FOR PUBLICATION

ALL RIGHTS RESERVED.

© COPYRIGHT - By -

REVISIONS

P	LTR	DESCRIPTION	DATE	DWN	APVD
	H	REVISED PER ECR-21-100133	10FEB2021	BDA	DH

- 1 SPLICE FREE, FOR AMP_D_MATOR.
- 2 BRIGHT PRE_TIN PLATED.
- 3 REELED WITH PAPER LAYER.
- 4 OBSOLETE PARTS: OBSOLETE CIS STREAMLINING PER D.RENAUD/D.SINISI
- 5 OBSOLETE.

CHAMFER

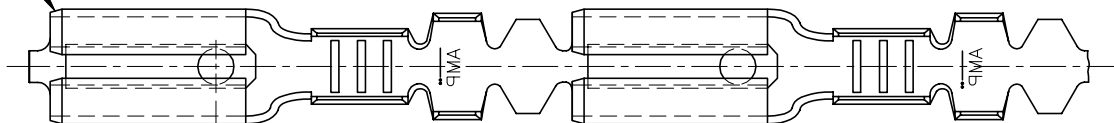

5.3
[.210]

2.2
[.086]

0.3
[.010]

6.3
[.250]

1.02 [.045] REF

0.5
[.020]
MAX

0.5
[.020]
MAX

14.0
[.550]

3.7
[.146]

0.8
[.032]

4	NONE	PHOSPH. BRONZE	3	6-160303-5
	TIN	BRASS	3	6-160303-4
4	2	PHOSPH. BRONZE		6-160303-3
	TIN-LEAD	PHOSPH. BRONZE		6-160303-2
4	TIN-LEAD	BRASS		6-160303-1
4	PRE-TIN	PHOSPH. BRONZE		6-160303-0
	PRE-TIN	BRASS		5-160303-9
4	TIN	BRASS	1	5-160303-8
	NONE	BRASS	1	5-160303-7
5	TIN	PHOSPH. BRONZE		5-160303-6
4	NONE	PHOSPH. BRONZE		5-160303-5
4	GOLD	BRASS		5-160303-4
	SILVER	BRASS		5-160303-3
	TIN	BRASS		5-160303-2
	NONE	BRASS		5-160303-1
	PLATING	MATERIAL		PART NUMBER

THIS DRAWING IS A CONTROLLED DOCUMENT.

DWN 6-3-1978

CHK -

APVD 7-3-1978

PRODUCT SPEC -

APPLICATION SPEC -

WEIGHT -

CUSTOMER DRAWING

STE TE Connectivity

NAME .110 SRS FASTON RECEPTACLE FOR 0.8mm TAB

SIZE A3 CAGE CODE 00779 DRAWING NO C=160303 RESTRICTED TO -

SCALE 6:1 SHEET 1 OF 1 REV H

DIMENSIONS:
mm [INCHES]

TOLERANCES UNLESS OTHERWISE SPECIFIED:

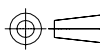

- 0 PLC ± -
- 1 PLC ± -
- 2 PLC ± -
- 3 PLC ± -
- 4 PLC ± -
- ANGLES ± -

WIRE RANGE : 0.3-0.56mm² (22-20 AWG)

INSUL-RANGE : ø 1.3-2.0mm (.050-.080)

MATERIAL -

FINISH -

单击下面可查看定价，库存，交付和生命周期等信息

[>>TE Connectivity\(泰科\)](#)