

THIS DRAWING IS UNPUBLISHED. RELEASED FOR PUBLICATION
 © COPYRIGHT - By - ALL RIGHTS RESERVED.

REVISIONS					
P	LTR	DESCRIPTION	DATE	DWN	APVD
V3		REVISED PER ECO-14-008433	05JUN2014	NK	MZ
W		REVISED PER ECR-16-016563	07DEC2016	RS	MZ

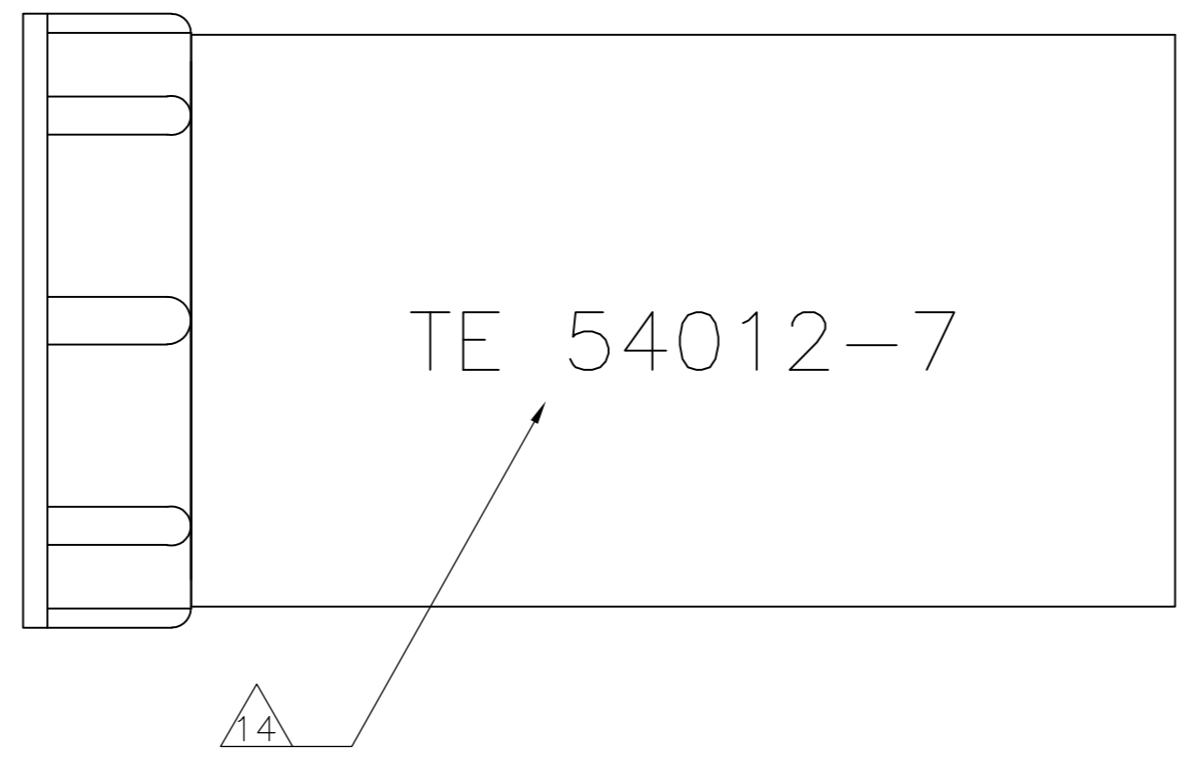
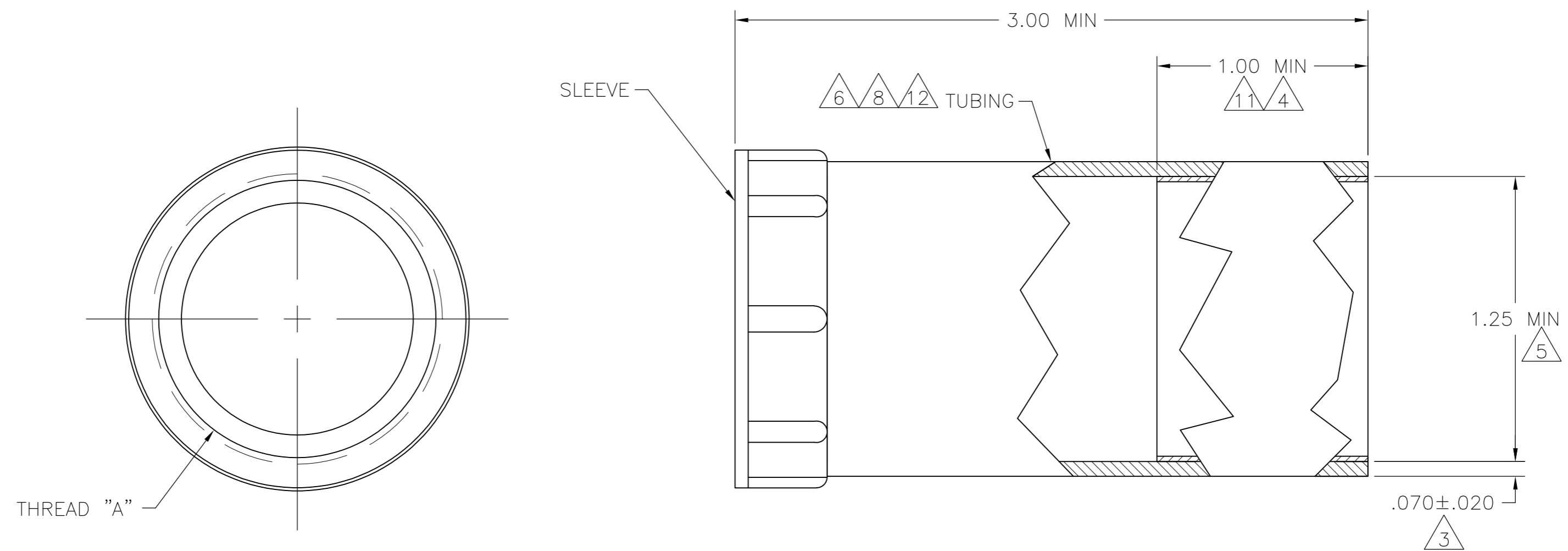

- 1 POLYOLEFIN, BLACK.
- 2 NYLON, BLACK.
- 3 NOMINAL WALL THICKNESS, EXPANDED.
- 4 LENGTH OF SEALANT.
- 5 EXPANDED INSIDE DIAMETER.
- 6 12.70[.500] MAXIMUM RECOVERED INSIDE DIAMETER.
- 7 ASSEMBLY WILL PASS 0.0703 KG PER SQ CENTIMETER [ONE POUND PER SQ IN.] WATER PRESSURE TEST.
- 8 121°C [250°F] SHRINK TEMPERATURE.
- 9 -55°C TO 110°C [-67°F TO 230°F] OPERATING TEMPERATURE.
- 10 THIS PART WILL ACCOMODATE $\phi 13.97 - \phi 31.75$ [$\phi .550 - \phi 1.250$] CABLE RANGE.
- 11 NO SEALANT APPLIED.
- 12 ACTUAL SHAPE MAY VARY DUE TO PROCESS VARIANCE.
- 13 OBSOLETE PARTS.
- 14 SEE P/N CHART FOR MARKING. WHITE CHARACTERS .15 MIN HIGH AND LOCATED ON THE OUTSIDE SURFACE OF THE TUBING.
- 15 PRELIMINARY PART - NOT FOR PRODUCTION

MARKING	THREAD "A"	PART NUMBER
13	1 3/8-18 UNEF-2B	54012-7
11 13	1 7/16-18 UNEF-2B	54012-6
11 13	1 3/8-18 UNEF-2B	54012-5
	1 7/16-18 UNEF-2B	54012-4
13	1 3/16-18 UNEF-2B	54012-3
	1 3/8-18 UNEF-2B	54012-1

THIS DRAWING IS A CONTROLLED DOCUMENT.		DWN C.REIFSNYDER 10 APR 96	TE TE Connectivity	
DIMENSIONS: INCHES		CHK R.STONE 15 APR 95		
TOLERANCES UNLESS OTHERWISE SPECIFIED:		APVD T.A.WETZEL 03 MAY 96	NAME	
0 PLC ± -		PRODUCT SPEC	STRAIN RELIEF ASSY, SHELL SIZE 23, CPC	
1 PLC ± -		APPLICATION SPEC	SIZE	CAGE CODE
2 PLC ± -		FINISH	A2	00779
3 PLC ± -		WEIGHT	C=54012	
4 PLC ± -		CUSTOMER DRAWING	SCALE	SHEET
ANGLES ± -			2:1	1 of 1
FINISH			REV	W
MATERIAL				
TUBING: 1				
SLEEVE: 2				

单击下面可查看定价，库存，交付和生命周期等信息

[>>TE Connectivity\(泰科\)](#)