

REVISIONS					
P	LTR	DESCRIPTION	DATE	DWN	APVD
F		REVISED PER ECO-19-016188	31OCT2019	JMS	WW

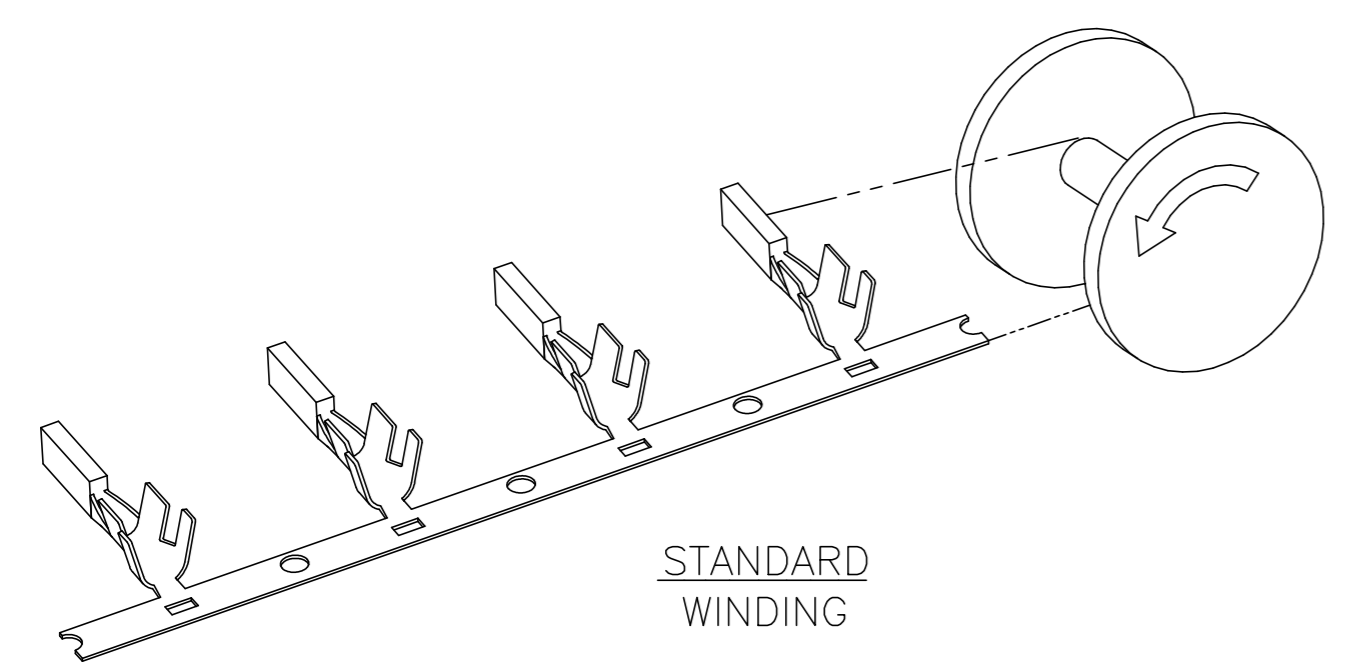
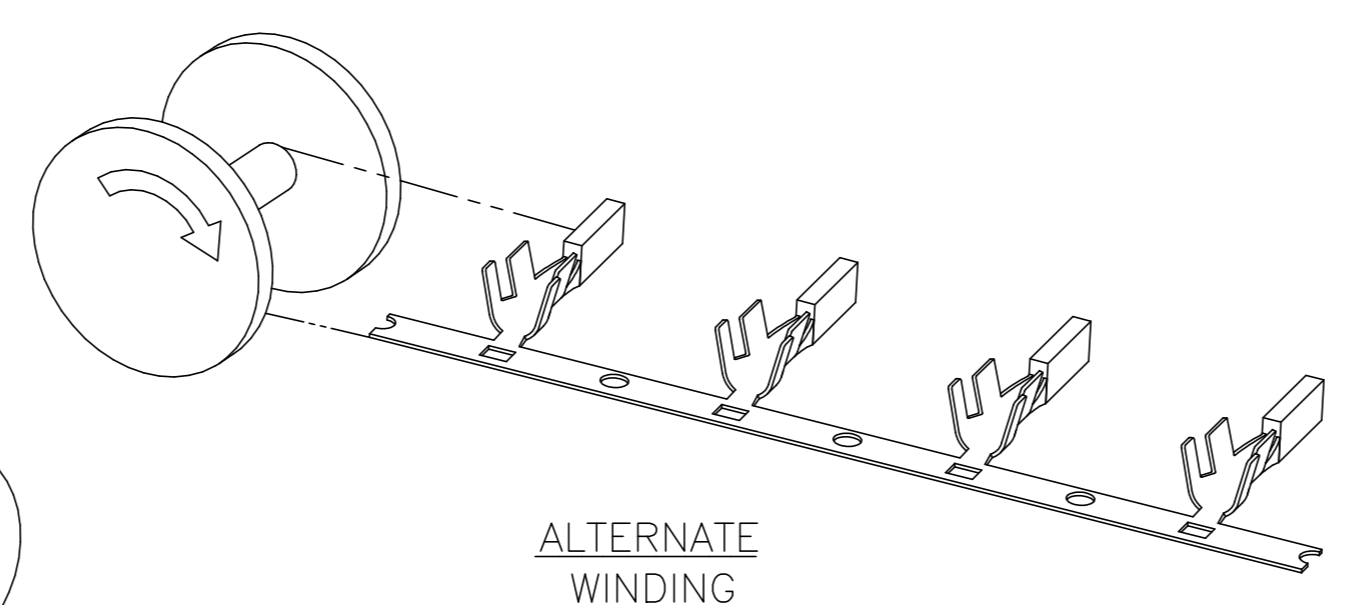
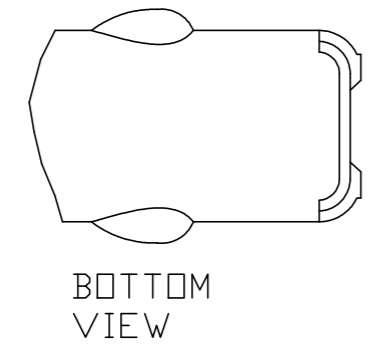
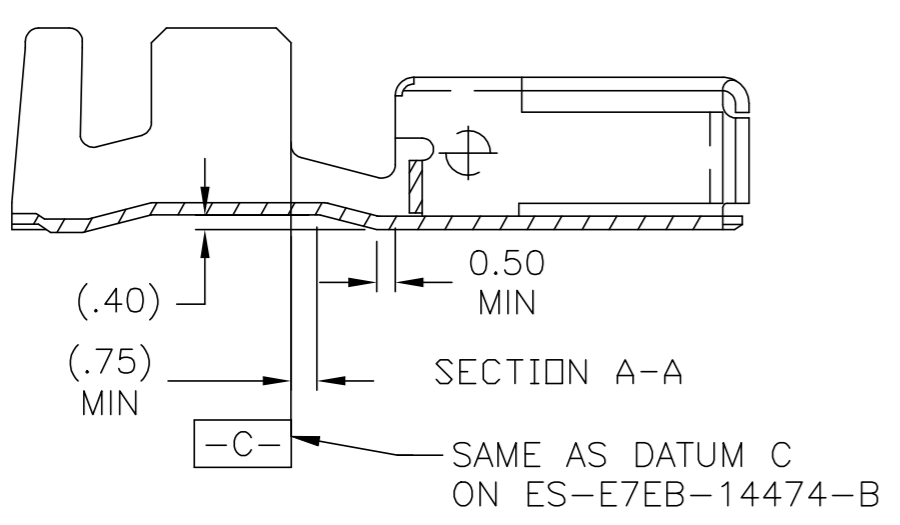
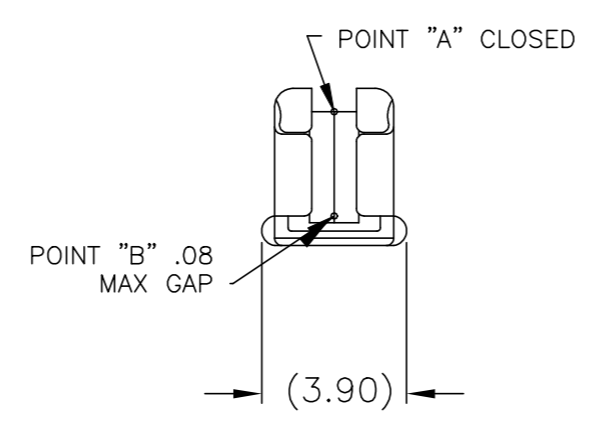
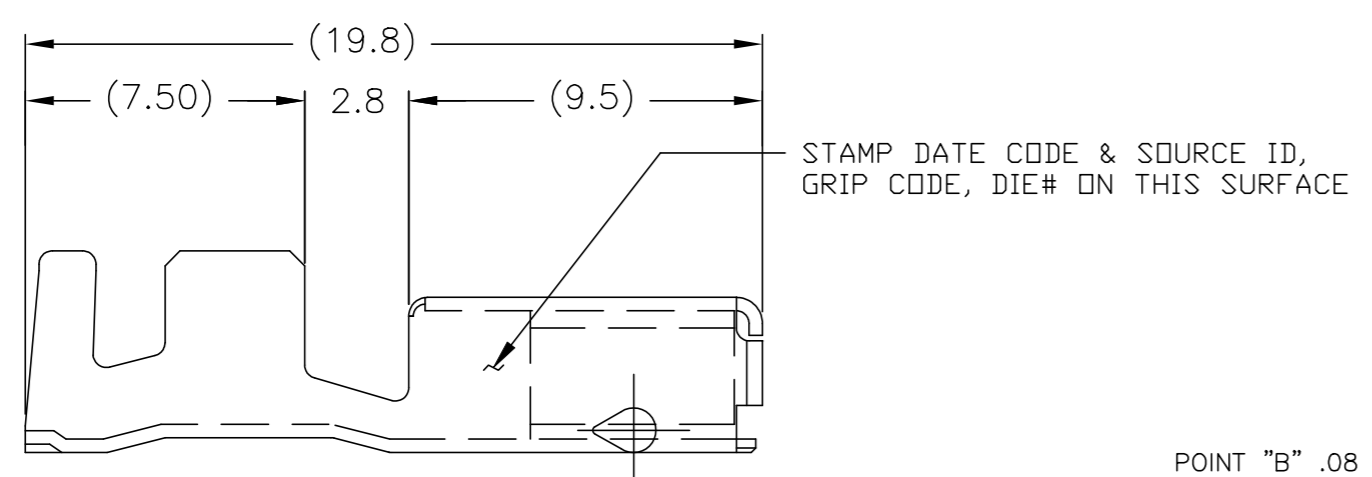
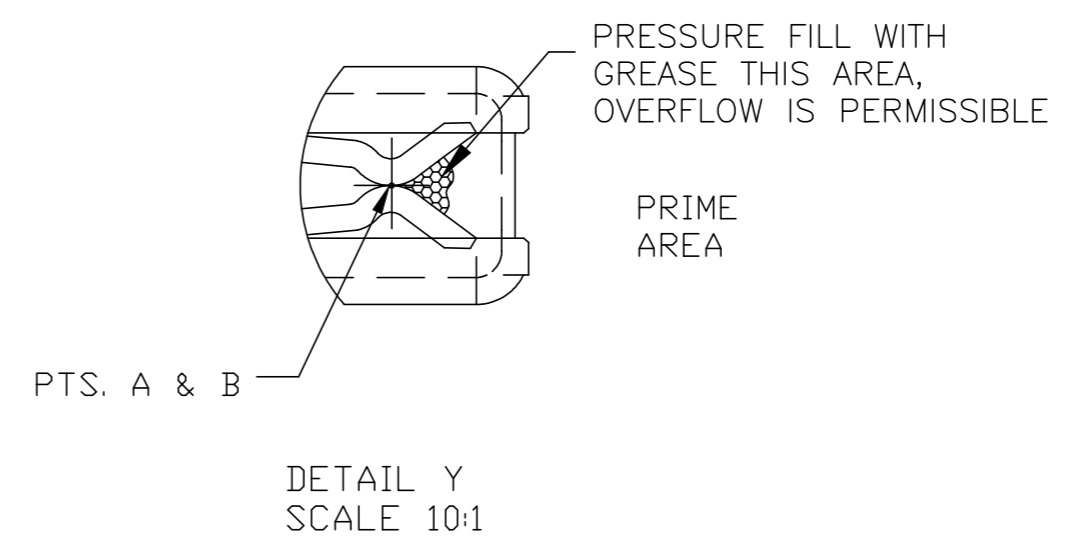
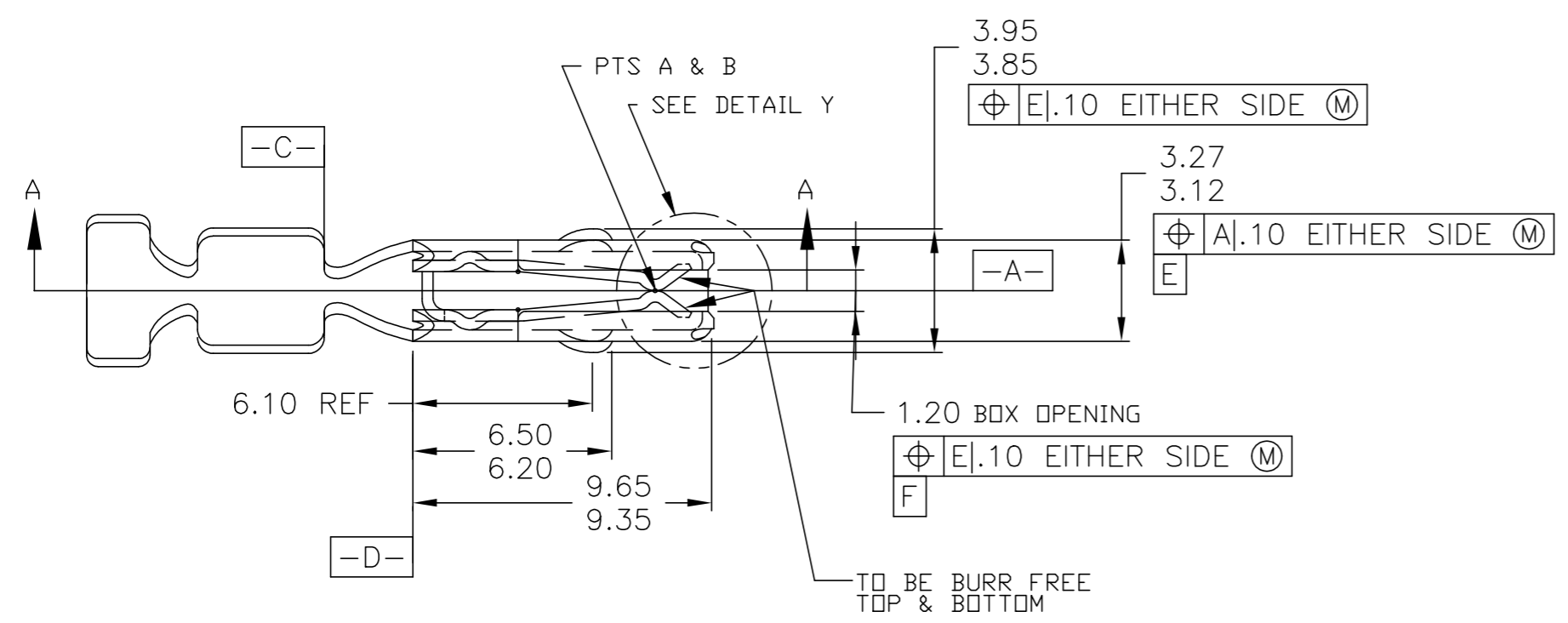

NOTES: UNLESS OTHERWISE SPECIFIED

- GENERAL TOLERANCES:
 ± .3 ALL ONE PLACE DIMENSIONS
 ± .15 ALL TWO PLACE DIMENSIONS
 ± 1.00° ALL ANGULAR DIMENSIONS
- * CRIMPING OF TERMINALS TO WIRE MUST MEET ALL REQUIREMENTS OF ES-E7E8-14474-A
- FOR WIRE INSULATION DEFORMATION SPECIFICATIONS SEE ES-E4EB-14461-AA
- MATERIAL: UNS C19500 BRASS, 1/2 HARD (REF)
 FINISH: WSB-NIP9-B TIN PLATE - HOT DIP, PRE-TIN STRIP EXCEPT PLATING THICKNESS TO BE A MINIMUM OF .035u INCH

3-1438230-6	3-1438230-3	12	12	3.25	2.00	3.20	3.50	-	-	CCW		ICW	
										CCH	ICH	ICW	ICH
				14	2.85	1.80	3.20	2.90	3.40	3.05			
				16	2.85	1.70	3.20	2.55	3.40	3.70			
				22	1.85	1.20	2.20	2.00	2.40	2.15			
				24	1.85	1.10	2.20	1.75	2.40	1.90			
				18	2.05	1.50	2.40	2.30	2.80	2.70			
				20	2.05	1.40	2.40	2.20	2.80	2.60			
TE P/N (ALTERNATE WINDING)	TE P/N (STANDARD WINDING)	GRIP CODE	WIRE SIZE	CCW	CCH	ICW	ICH	ICW	ICH	CONDUCTOR CRIMP	INSULATION CRIMP (TW)	INSULATION CRIMP (STD)	

THIS DRAWING IS A CONTROLLED DOCUMENT.

DWN: JR BUSSARD 09 MAY 2003
 CHK: DM REVAK 09 MAY 2003
 APVD: DM REVAK 09 MAY 2003

TE Connectivity Ltd.

TERMINAL - WIRE SNAP ON FEMALE

SIZE: A2 CAGE CODE: 00779 DRAWING NO: C=1438230

SCALE: 5:1 SHEET: 1 of 1 REV: F

单击下面可查看定价，库存，交付和生命周期等信息

[>>TE Connectivity\(泰科\)](#)