

a) Part as supplied.

209W212 thru 275

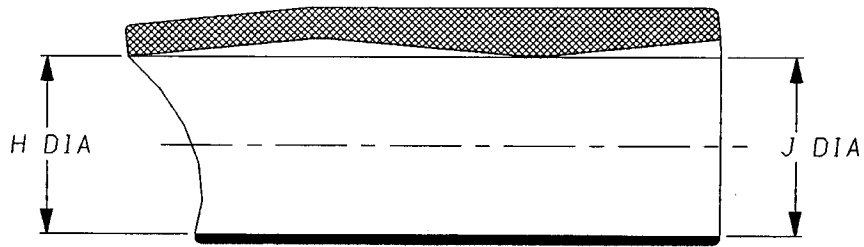

b) Part after unrestricted recovery.

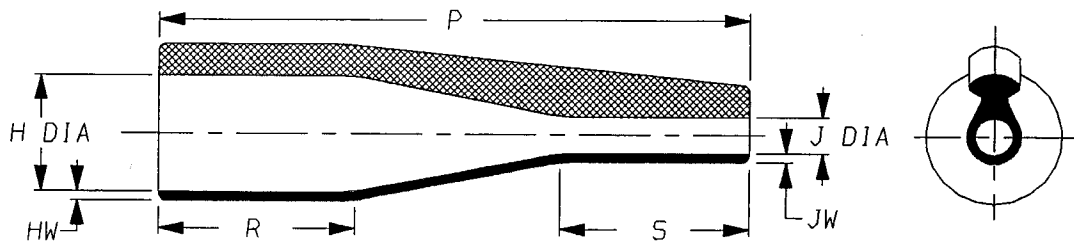

Dimensions (in millimetres).

PART NUMBER	SIZE	H		J		P ±10%	R ±10%	S ±10%	HW ±20%	JW ±20%
		MIN a	MAX b	MIN a	MAX b					
209W212	A	25	17	16	3	95	42	23	2.0	2.0
209W232	B	32	22	32	7	105	42	31	2.0	2.0
209W243	C	38	27	38	9	130	42	38	2.0	2.0
209W253	D	47	37	47	14	150	42	47	2.0	2.0
209W264	E	52	42	52	16	160	42	50	2.0	2.0
209W275	F	67	57	67	19	195	62	35	3.0	3.0

Copyright (!)

The copyright in this drawing is the property of Tyco Electronics UK Ltd. The drawing is issued on the condition that it is not copied, reproduced or disclosed to a third party, either in whole or in part without the prior written consent of Tyco Electronics UK Ltd.

Drawn A.LILLEY. Checked *[Signature]* Issue 5 Date February 2001 Conforms to ISO Recommendations

Approval Design

[Signature]

MKTG. *[Signature]* Q.A.

[Signature]

3rd Angle Projection
 Not to Scale

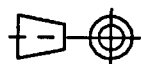

Iss.	Date	E.C.R. No.	Details of Change
2	****	****	209W243 H&J Min was 40, 209W253 H&J min was 55
2	****	****	209W264 H&J Min was 65, 209W275 H&J min was 79
3	****	****	209W212 J min was 26
4	****	****	-100 added
5	****	****	Redrawn

Ordering Information

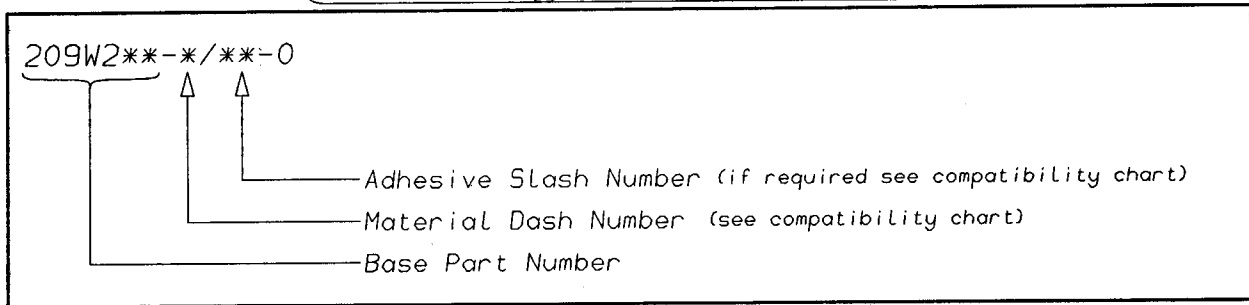

COMPATIBILITY CHART

MATERIAL DASH NUMBER	MATERIAL DESCRIPTION	COATING SLASH NUMBER
-3	POLYOLEFIN, SEMI-RIGID	/42, /86
-4	POLYOLEFIN, FLEXIBLE	/42, /86
-25	ELASTOMER, FLUID RESISTANT	/86, /225
-100	ZERO HALOGEN	/86, /180
-130	POLYOLEFIN, COMMERCIAL FLEXIBLE	/42

AS SUPPLIED DIMENSIONS ARE FOR UNCOATED PARTS,
WHEN COATING IS ADDED, ENTRY DIAMETERS WILL REDUCE BY 1.5mm MAX.

Raychem Wire & Harness
 a Division of Tyco Electronics
 Faraday Road,
 Swindon, Wiltshire, England. SN3 5JA
 Telephone: (01793) 528171 Fax: 572516

Raychem Wire & Harness
 a Division of Tyco Electronics
 300, Constitution Drive, Menlo Park,
 California 94025-1164, USA
 Telephone (650) 361-3333 Fax: (650) 361-5579

单击下面可查看定价，库存，交付和生命周期等信息

[>>TE Connectivity\(泰科\)](#)