

REVISIONS					
P	LTR	DESCRIPTION	DATE	DWN	APVD
	B2	ECO-20-014947	23OCT2020	RK	JO

MINIMUM CONTACT AREA GOLD PLATED

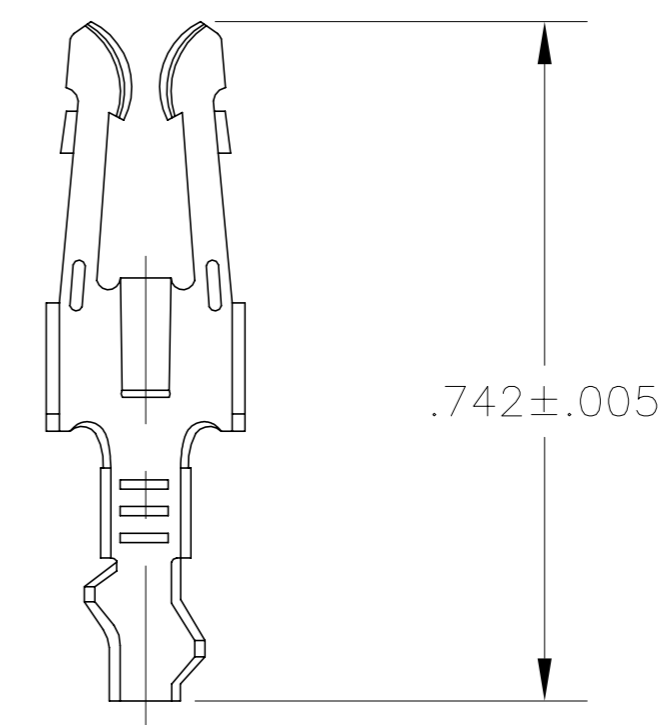
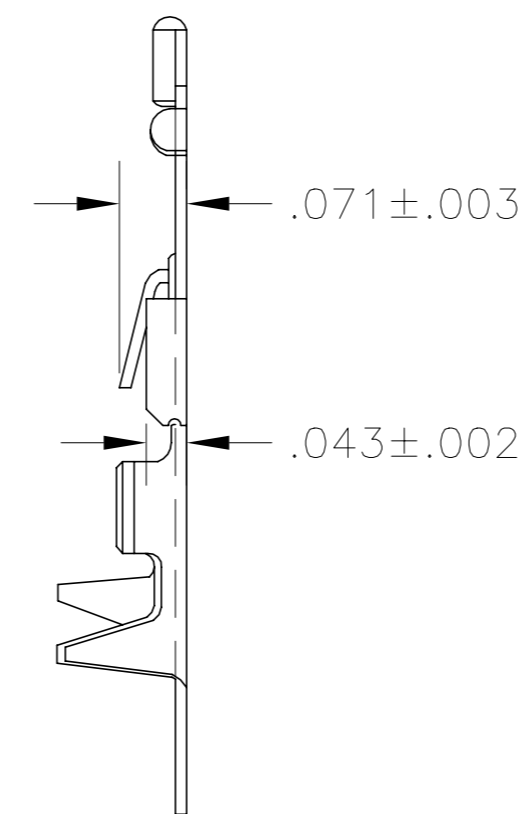
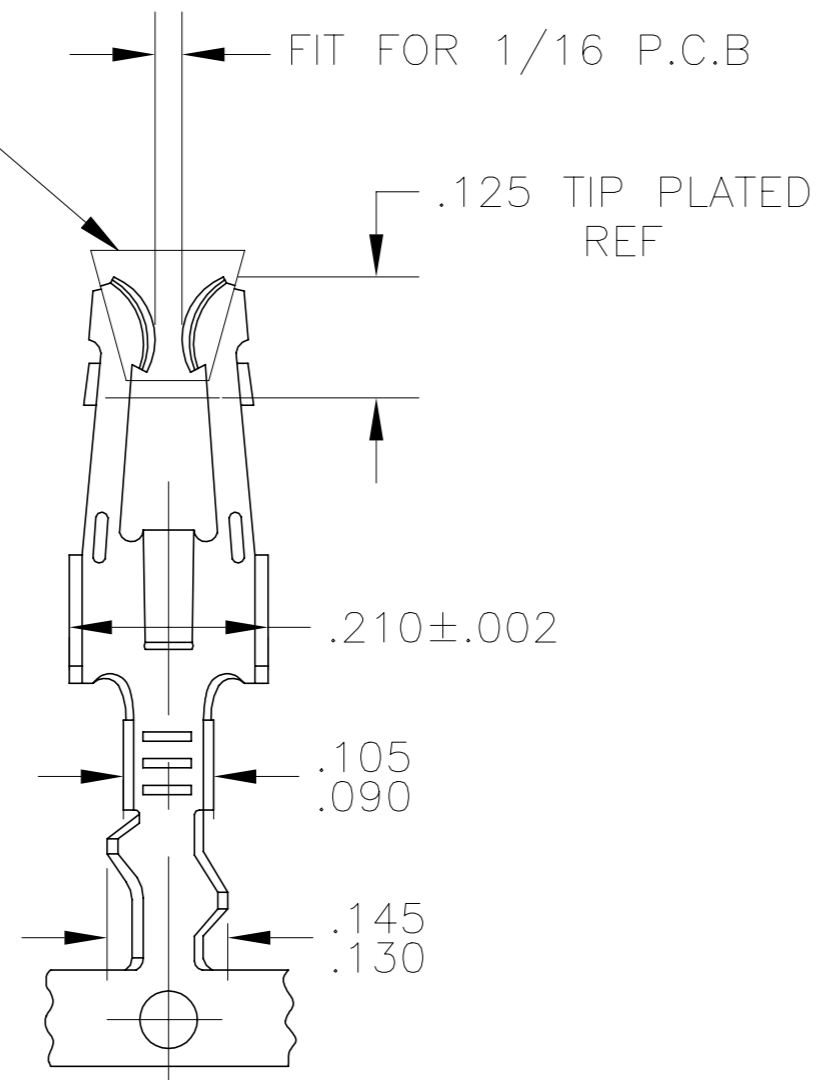

LOOSE PIECE

- 1. WIRE SIZE: #20-#18 AWG, INSULATION RANGE .070-.110 DIA.
- 2 L-R REELING FOR MINI-APPLICATOR.
- 3 MATTE TIN PLATE IN CRIMP AREA.
- 4 OBSOLETE PARTS: OBSOLETE CIS STREAMLINING PER D.RENAUD/D.SINISI

NICKEL PLATE ALL OVER, TIP PLATE .000030 THICK GOLD.	583362-4 L.P(5-583363-3)	583362-7 3
NICKEL PLATE ALL OVER, TIP PLATE .000015 THICK GOLD.	583362-3 L.P(5-583363-2)	4 583362-6 3
TIN.	583362-2 L.P(5-583363-1)	4 583362-5 3
NICKEL PLATE ALL OVER, TIP PLATE .000030 THICK GOLD, TIN-LEAD	583362-4 L.P(583363-3)	583362-4 2
NICKEL PLATE ALL OVER, TIP PLATE .000015 THICK GOLD, TIN-LEAD	583362-3 L.P(583363-2)	583362-3 2
TIN-LEAD	583362-2 L.P(583363-1)	583362-2 2
FINISH	LOOSE PIECE COMBINATION NO.	PART NO.

THIS DRAWING IS A CONTROLLED DOCUMENT.		DWN 16SEP67	TE TE Connectivity		
DIMENSIONS: INCHES		CHK -			
TOLERANCES UNLESS OTHERWISE SPECIFIED:		APVD -	NAME		
0 PLC ± -		PRODUCT SPEC			
1 PLC ± -		APPLICATION SPEC	MODIFIED FORK CONTACT		
2 PLC ± -		SCALE			
3 PLC ± -		SIZE	CAGE CODE	DRAWING NO	RESTRICTED TO
4 PLC ± -		WEIGHT	A2	00779	C=583362
ANGLES ± -		CUSTOMER DRAWING	SCALE 4:1	SHEET 1 of 1	REV B2
MATERIAL	FINISH				
PHOS. BRONZE	SEE TABLE				

单击下面可查看定价，库存，交付和生命周期等信息

[>>TE Connectivity\(泰科\)](#)