

Thermofit<sup>®</sup> Molded Parts  
 Specification Control Drawing  
 Limited Distribution

Part Number : 322B813-X-01  
 Description : Transition, 90° 3 Entry

- NOTES**
- All dimensions are in  $\frac{\text{inches}}{\text{[millimeters]}}$
  - Dimensions appearing in table are as follows:
    - a - As Supplied
    - b - After Unrestricted Recovery
  - Coating is optional. As supplied dimensions appearing in table are for uncoated parts. When coating is added, entry diameters will be reduced by .06 max.

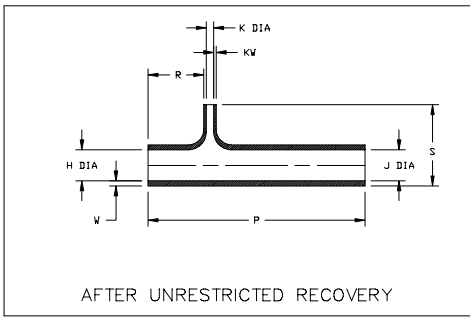
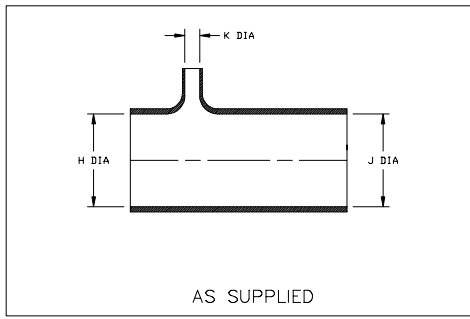

TABLE OF DIMENSIONS									
PART NUMBER	H & J		K		P	R	S	W	KW
	Min a	Max b	Min a	Max b	±10% b	±10% b	±10% b	±20% b	±20% b
322B813-X-01	1.50 [38,1]	.50 [12,7]	.24 [6,1]	.12 [3,05]	3.49 [88,6]	.90 [22,8]	1.31 [33,3]	.08 [2,0]	.04 [1,01]



RAYCHEM CORPORATION  
 300 CONSTITUTION DRIVE  
 MENLO PARK, CALIFORNIA 94025

Revision : A  
 Date : 7/9/97

Part Number : 322B813-X-01  
 Description : Transition, 90° 3 Entry

Thermofit<sup>®</sup> Molded Parts  
 Specification Control Drawing  
 Limited Distribution

Part Number : 322B813-X-01  
 Description : Transition, 90° 3 Entry

COMPATABILITY CHART					
MATERIAL DASH NO.	MATERIAL DESCRIPTION	RT SPEC	COATING SLASH NO.	COATING S NO.	COATING DESCRIPTION
-3	Polyolefin, Semi-rigid	RT-301	N/A		
-4	Polyolefin, Flexible	RT-1304	N/A		

ORDERING INFORMATION

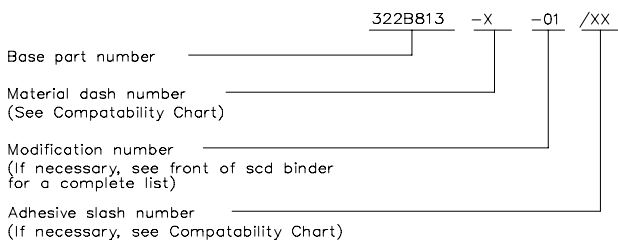

THIS DRAWING IS SUBJECT TO CHANGE WITHOUT NOTICE; CONSULT YOUR NEAREST FIELD REPRESENTATIVE FOR CURRENT REVISION

If this document is printed it becomes uncontrolled.  
 Check for the latest revision.



RAYCHEM CORPORATION  
 300 CONSTITUTION DRIVE  
 MENLO PARK, CALIFORNIA 94025

Revision : A  
 Date : 7/9/97

Part Number : 322B813-X-01  
 Description : Transition, 90° 3 Entry

单击下面可查看定价，库存，交付和生命周期等信息

[>>TE Connectivity\(泰科\)](#)