

RECOMMENDED PANEL CUTOUT
SCALE 4:1

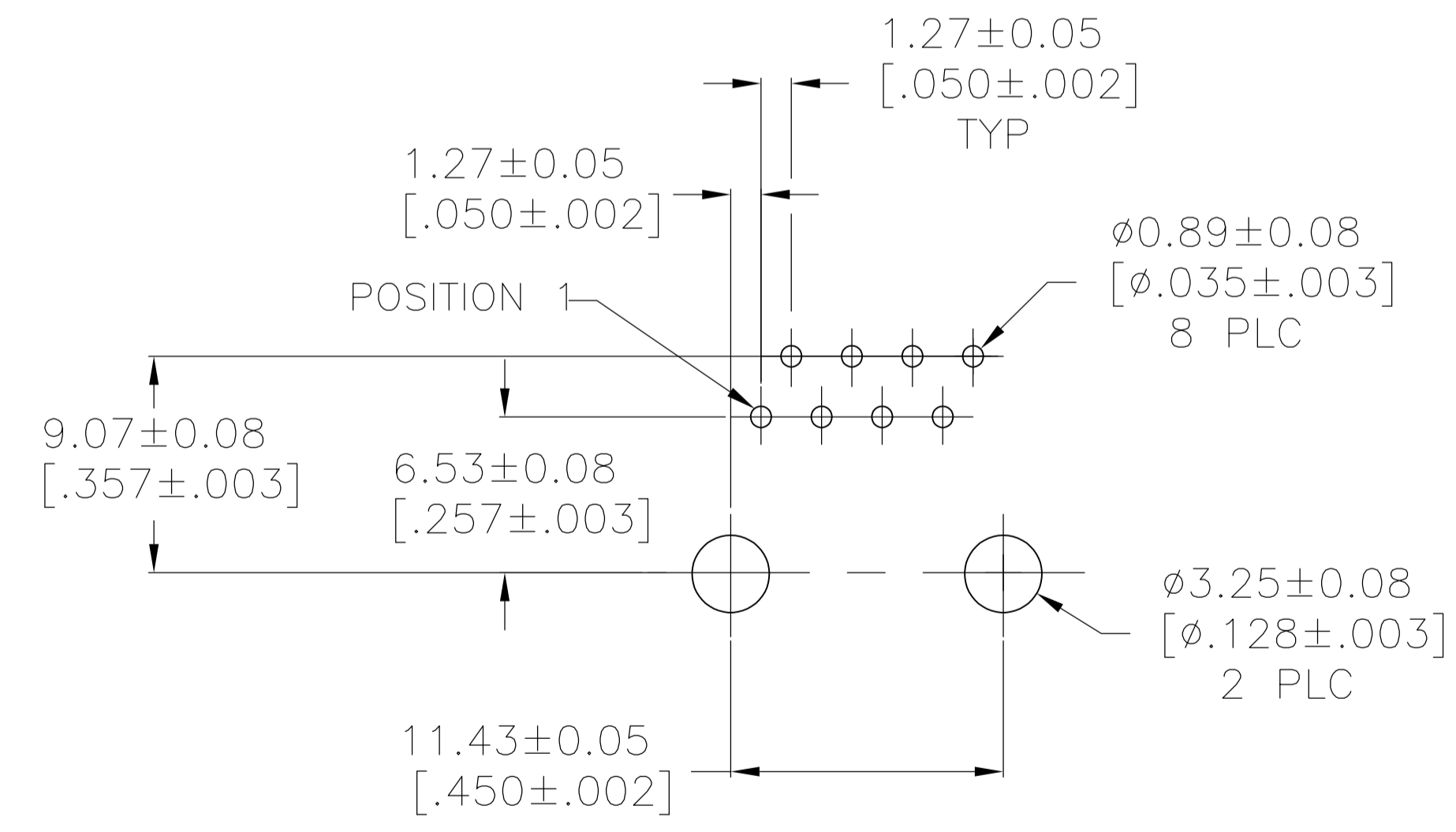
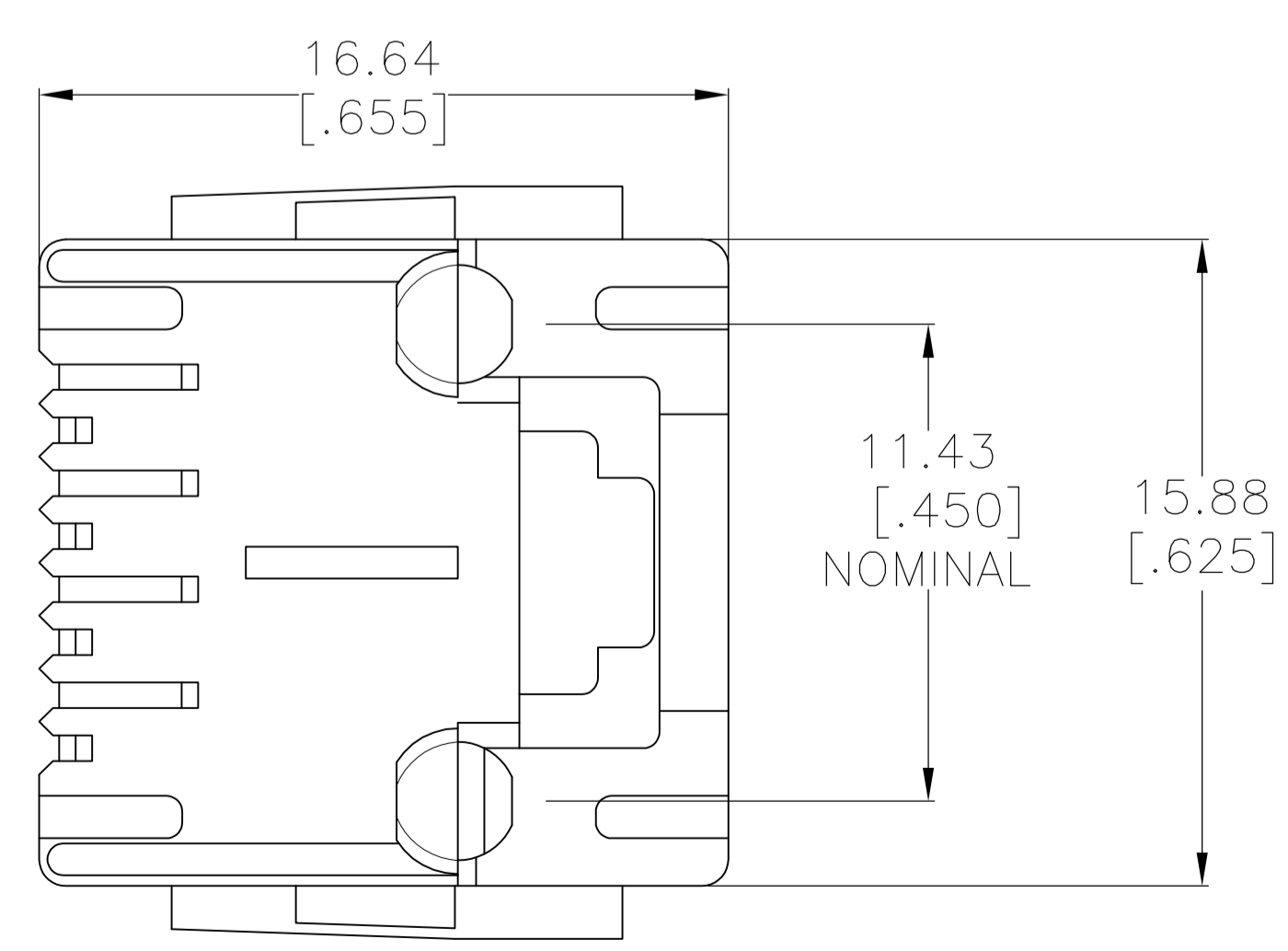

RECOMMENDED PRINTED CIRCUIT BOARD LAYOUT
COMPONENT SIDE
SCALE 4:1

- MATERIAL: HOUSING: PBT POLYESTER, COLOR: BLACK
TERMINAL: 0.36[.014] THICK PHOS BRONZE PLATED WITH 1.27µm [.000050] MIN THICK HARD GOLD IN LOCALIZED GOLD PLATE AREA AND 3.81µm [.000150] MIN THICK MATTE TIN IN SOLDER AREA OVER 1.27µm [.000050] MIN THICK NICKEL UNDERPLATE
- CAVITY CONFORMS TO FCC RULES AND REGULATIONS PART 68 REA BULLETIN 345-81, PE-76 SPECIFICATION FOR MODULAR TELEPHONE HARDWARE
- ALL DIMENSIONS SHOWN ARE MAXIMUM UNLESS OTHERWISE SPECIFIED

5520260-4
PART NUMBER

| | | | | |
|--|--|-----------------------------------|---|-----------------|
| THIS DRAWING IS A CONTROLLED DOCUMENT. | | DIN G. ATTADIA - 06/JUN/2005 | STE TE Connectivity | |
| DIMENSIONS: mm [INCHES] | | CHK J. WESTMAN | NAME MODULAR JACK ASSEMBLY, TOP ENTRY, 8 POSITION, KEYED, FLANGELESS, WITH PANEL STOPS | |
| TOLERANCES UNLESS OTHERWISE SPECIFIED: | | APVD S. FLICKINGER | PRODUCT SPEC 108-1163 | |
| 0 PLC ± - | | APPLICATION SPEC 114-2048 | | |
| 1 PLC ± - | | SIZE A1 | | |
| 2 PLC ± - | | CAGE CODE 00779 | | |
| 3 PLC ± - | | DRAWING NO 5520260 | | |
| 4 PLC ± - | | RESTRICTED TO CUSTOMER DRAWING | | |
| ANGLES ± - | | SCALE 6:1 | | |
| MATERIAL SEE NOTE 1 | | WEIGHT - | | SHEET 1 OF 1 |
| FINISH SEE NOTE 1 | | REV C1 | | |

单击下面可查看定价，库存，交付和生命周期等信息

[>>TE Connectivity\(泰科\)](#)