

THIS DRAWING IS UNPUBLISHED. RELEASED FOR PUBLICATION JAN , 1992.
 © COPYRIGHT 1992 BY TYCO ELECTRONICS CORPORATION. ALL INTERNATIONAL RIGHTS RESERVED.

| LOC | DIST | REVISIONS | | | | | |
|-----|------|-----------|-----|---------------------------|-----------|-----|------|
| | | P | LTR | DESCRIPTION | DATE | DWN | APVD |
| J | / | | D | REVISED PER ECO-15-007228 | 17JUL2015 | RG | SH |

- -; AS SHOWN

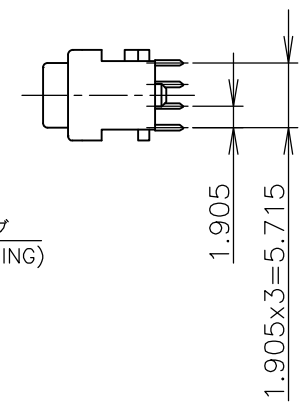
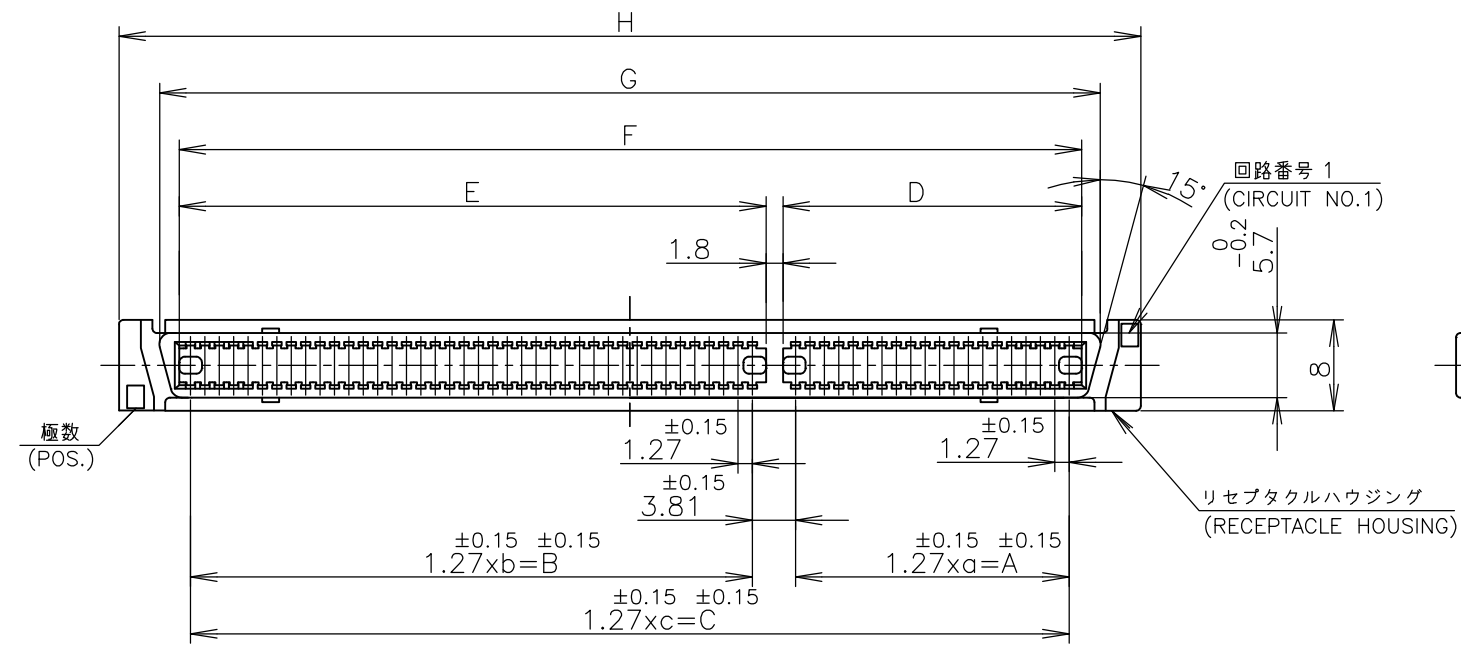

- ① MATERIAL; HOUSING: GLASS FILLED NYLON 6T (UL 94V-0) BLACK. CONTACT: PHOSPHOR-BRONZE
 - ② FINISH: GOLD PLATING ON CONTACT AREA AND TIN-LEAD PLATING ON TINE AREA OVER NICKEL PLATING. GOLD PLATING THICKNESS SHOWN TABLE.
 - ③ BOSS FOR POSITIONING: APPLY FROM 40 POSN TO 100 POSN.
- ① 材料: *ハウジング; ガラス入りナイロン 6T (UL 94V-0) 色、黒。
*コンタクト: 燐青銅。
- ② 表面仕上げ;
ニッケル下地めっきに接触部金めっき、半田付部半田めっきを施す。金めっき厚は下表参照。
- ③ ボスは40極から100極まで適用。

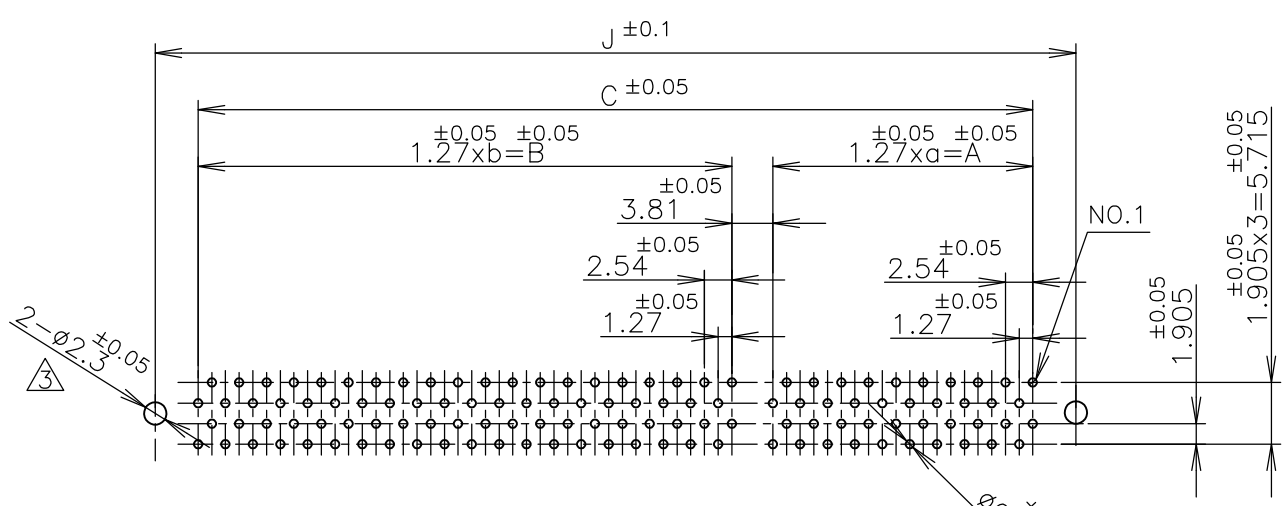
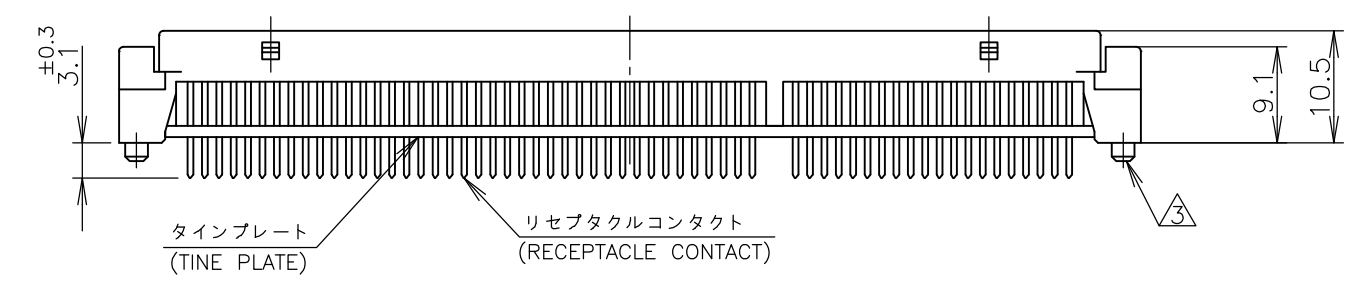

| | | | | | | | | | | | | | | | | | | | | | | |
|----------|---|---|---|---|---|---|---|---|---|---|---|-------------|------|-----|-------|-------|-------|-------|------|--------|----|------------|
| OBSOLETE | | | | | | | | | | | | | | 29 | 36.83 | 38.83 | 41.92 | 49.45 | 46.8 | 0.76μm | 60 | 2-179533-2 |
| a | A | b | B | c | C | D | E | F | G | H | J | THK OF GOLD | POS. | P/N | | | | | | | | |

THIS DRAWING IS A CONTROLLED DOCUMENT.

| | |
|--------------------------|--|
| DWN H.KODAMA 27MAY1994 | Tyco Electronics Corporation Kawasaki, Japan |
| CHK Y.FUJIURA 28MAY1994 | |
| APVD Y.FUJIURA 28MAY1994 | NAME 名称 |
| PRODUCT SPEC 製品規格 | AMP FH CONNECTOR RECEPTACLE, VERTICAL 13mm STACKING, HIGH TEMP TYPE |
| APPLICATION SPEC 取付適用規格 | SIZE A3 CAGE CODE 00779 DRAWING NO 番号 C-179533 RESTRICTED TO |
| WEIGHT | SCALE 尺度 NTS SHEET 1 OF 1 REV D |

CUSTOMER DRAWING

GENERAL TOLERANCE 一般公差

| | |
|------------|-------|
| 10 ≥ | ±0.2 |
| 30 ≥ > 10 | ±0.25 |
| 100 ≥ > 30 | ±0.3 |
| ANGLES | ±3° |

DIMENSIONS: 単位: 耗 mm

TOLERANCES UNLESS OTHERWISE SPECIFIED: 一般公差

| | |
|--------|---|
| 0 PLC | ± |
| 1 PLC | ± |
| 2 PLC | ± |
| 3 PLC | ± |
| 4 PLC | ± |
| ANGLES | ± |

MATERIAL 材料

单击下面可查看定价，库存，交付和生命周期等信息

[>>TE Connectivity\(泰科\)](#)