

## SPECIFICATION CONTROL DRAWING

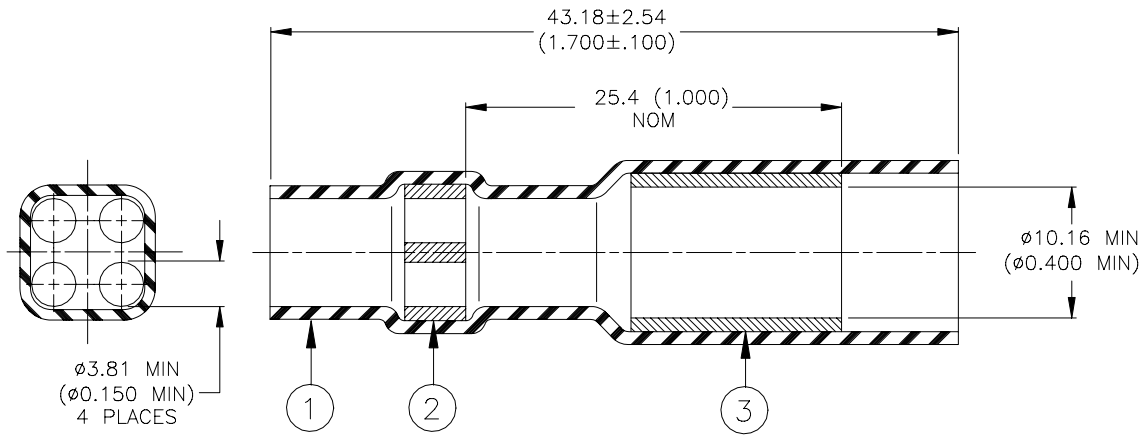

**SEALING SLEEVE**

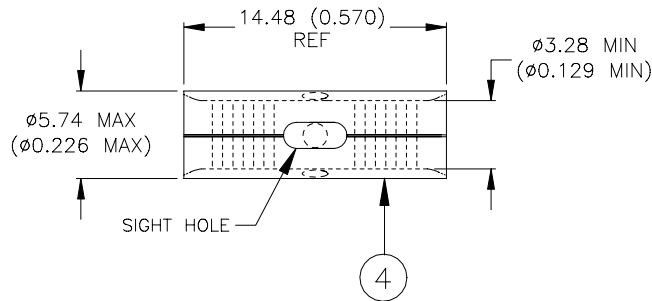

**CRIMP SPLICER**

### **MATERIALS**

1. INSULATION SLEEVE: Heat-shrinkable, transparent blue, radiation cross-linked modified polyvinylidene fluoride.
2. SEALING INSERT: Fluorocarbon-based thermoplastic, color-natural.
3. 4-HOLE INSERT: Fluorocarbon-based thermoplastic, color-yellow.
4. CRIMP SPLICER: Base Metal: Copper Alloy 110 per ASTM B-152.  
Plating: Tin plated per MIL-T-10727.  
Wire Size Range: 2.62 – 6.64mm<sup>2</sup> (5180 – 13100 CMA, 12 –10 AWG) Solid or Stranded.

### **APPLICATION**

1. This device is designed to provide immersion resistant in-line splice in wire bundles having up to 4 wires on one side and 1 wire on the other. Circular Mil Area (CMA) of wires on each end must be between 5180 and 13110.
2. Splicer to be installed with AMP 49900 (or equivalent tool). Sealing sleeve should be heated, starting with 4-hole insert, with a convection heater.
3. Strip length of wires shall be set so that when fully inserted into crimp barrel between 0.508 (0.020) and 1.52 (0.060) of conductor extends out of the barrel.

<b>tyco / Electronics / Raychem</b> 307 Constitution Drive Menlo Park, CA 94025, USA		<b>Wire and Harnessing Products</b>	TITLE: <b>IN-LINE CRIMP SPLICE, 4 TO 1, 12-10 AWG, TIN PLATED</b>				
Unless otherwise specified dimensions are in millimeters. Inches dimensions are in between brackets.			DOCUMENT NO.: <b>D-436-0182</b>				
TOLERANCES: 0.00 N/A 0.0 N/A 0 N/A	ANGLES: N/A  ROUGHNESS IN MICRON	Tyco Electronics reserves the right to amend this drawing at any time. Users should evaluate the suitability of the product for their application.	DCR NUMBER: <b>D010498</b>	REPLACES: <b>N/A</b>			
DRAWN BY: <b>M. FORONDA</b>	DATE: <b>3-Oct-01</b>	PROD. REV. <b>A</b>	DOC ISSUE: <b>0</b>	SCALE: <b>None</b>	SIZE: <b>A</b>	SHEET: <b>1 of 1</b>	

this document is printed it becomes uncontrolled. Check for the latest revision.

单击下面可查看定价，库存，交付和生命周期等信息

[>>TE Connectivity\(泰科\)](#)