

223W1XX

a. Part as supplied.

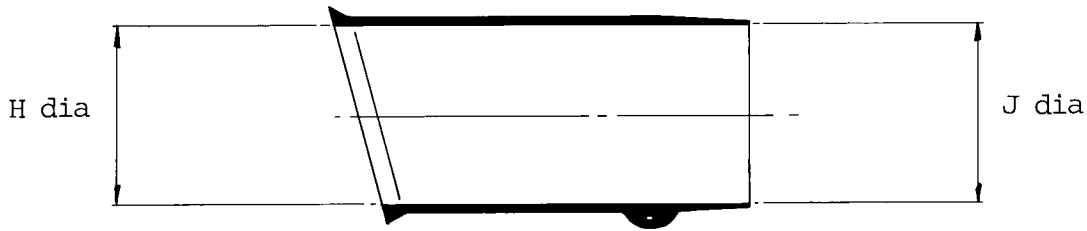

b. Part after unrestricted recovery.

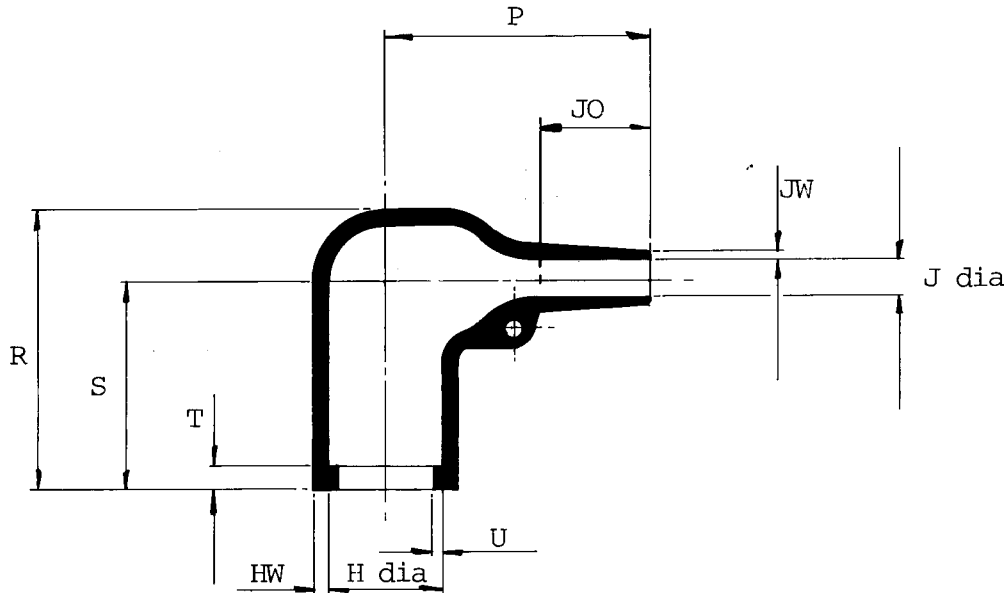

Dimensions (in millimetres)

Part No.	H		J		P	R	S	T	U	JO	HW	JW	SHELL SIZE
	min a	max b	min a	max b	+10% b	+10% b	+10% b	+10% b	+10% b	+10% b	+20% b	+20% b	
223W102	24	15	24	5,0	35	36	27	3,0	1,0	11	2,0	1,0	8 & 10
223W122	32	21	32	8,0	45	44	32	3,0	1,0	15	2,0	1,0	12 & 14
223W143	42	27	42	9,0	60	56	41	3,0	1,5	23	2,0	1,0	16 & 18
223W164	48	33	48	14,0	70	60	41	3,0	1,5	25	3,0	1,5	20 & 22
223W184	55	40	55	16,0	80	66	44	3,0	1,5	30	3,0	1,5	24

Drawn G. Evans Checked *L. Evans* Issue 3 Date April 1987.

Approval

Design *KEW*

MKTG *FR*

Q.C. *[Signature]*

Conforms to ISO Recommendations  
3rd Angle Projection  
Not to scale



## Ordering Information

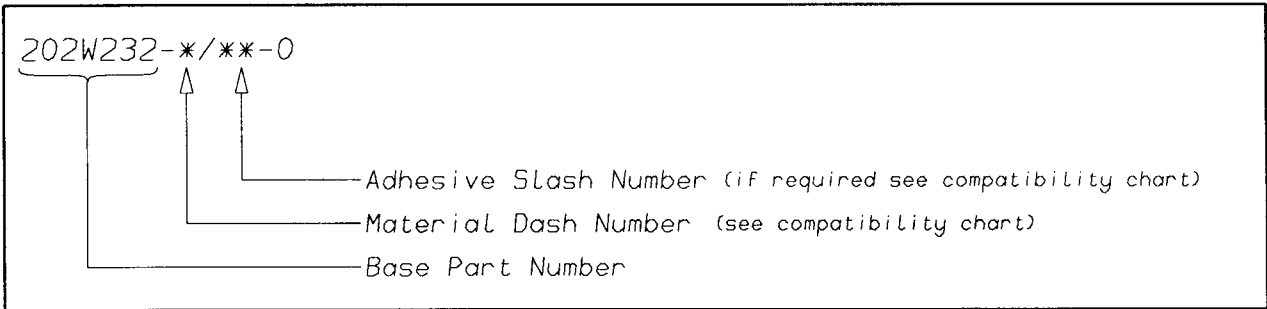

## COMPATIBILITY CHART

MATERIAL DASH NUMBER	MATERIAL DESCRIPTION	COATING SLASH NUMBER
-3	POLYOLEFIN, SEMI-RIGID	/42, /86
-4	POLYOLEFIN, FLEXIBLE	/42, /86
-25	ELASTOMER, FLUID RESISTANT	/86, /225

AS SUPPLIED DIMENSIONS ARE FOR UNCOATED PARTS,  
WHEN COATING IS ADDED, ENTRY DIAMETERS WILL REDUCE BY 1.5mm MAX.

POTTING PORTS ARE OPTIONAL  
WHEN SPECIFIED BY SUFFIX "-00"  
THEY WILL BE LOCATED AS SHOWN

Raychem  
Electronics OEM Division Europe  
Swindon, Wiltshire, England.  
Telephone: (01793) 528171 Fax: 573923

单击下面可查看定价，库存，交付和生命周期等信息

[>>TE Connectivity\(泰科\)](#)