

THIS DRAWING IS UNPUBLISHED. RELEASED FOR PUBLICATION
 © COPYRIGHT - By - ALL RIGHTS RESERVED.

RECOMMENDED PCB LAYOUT
 TOLERANCE IS ±0.05

REVISIONS				
P	LTR	DESCRIPTION	DATE	APVD
F		REVISED PER ECO-19-007626	12SEP2019	AP DG

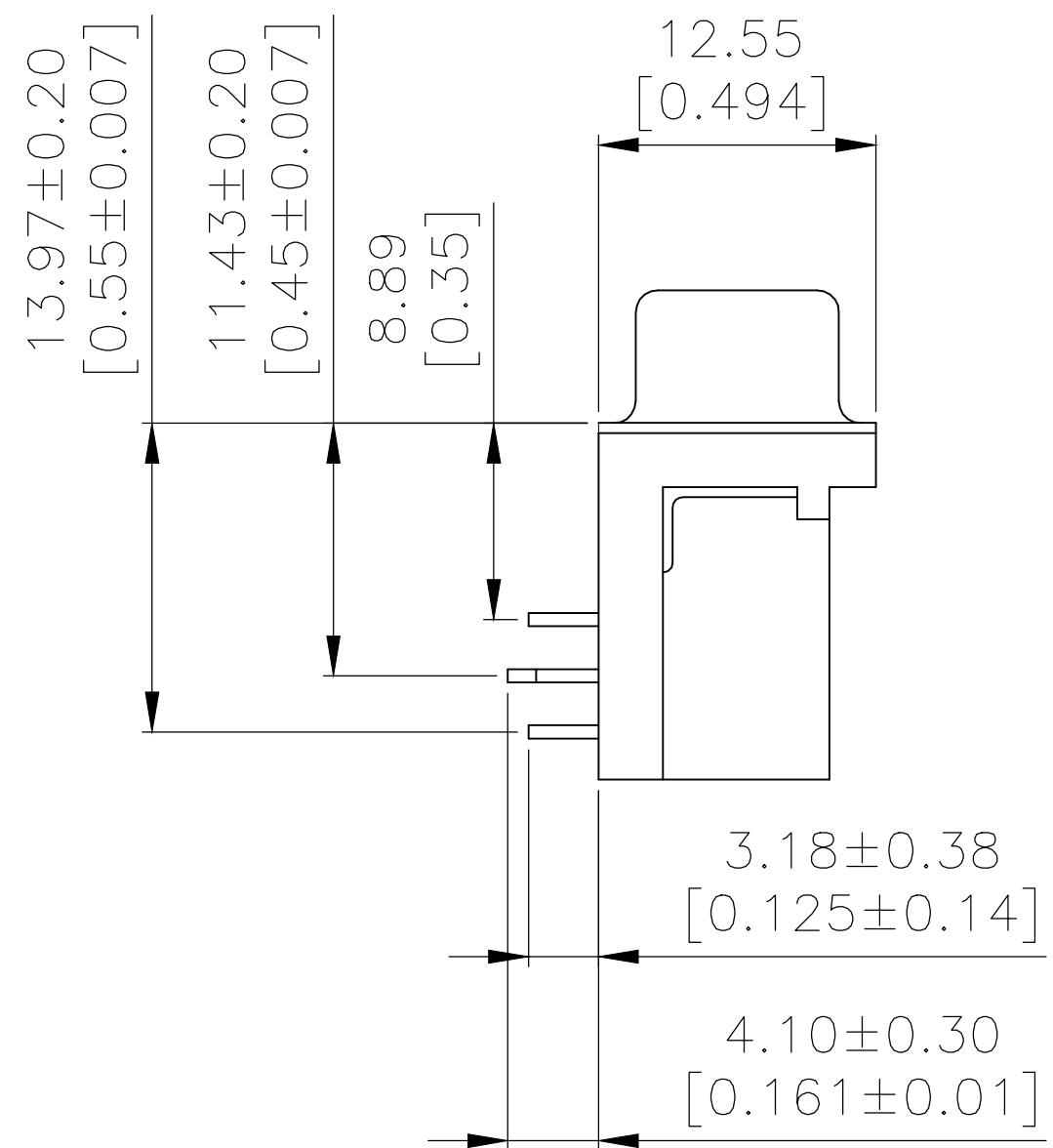
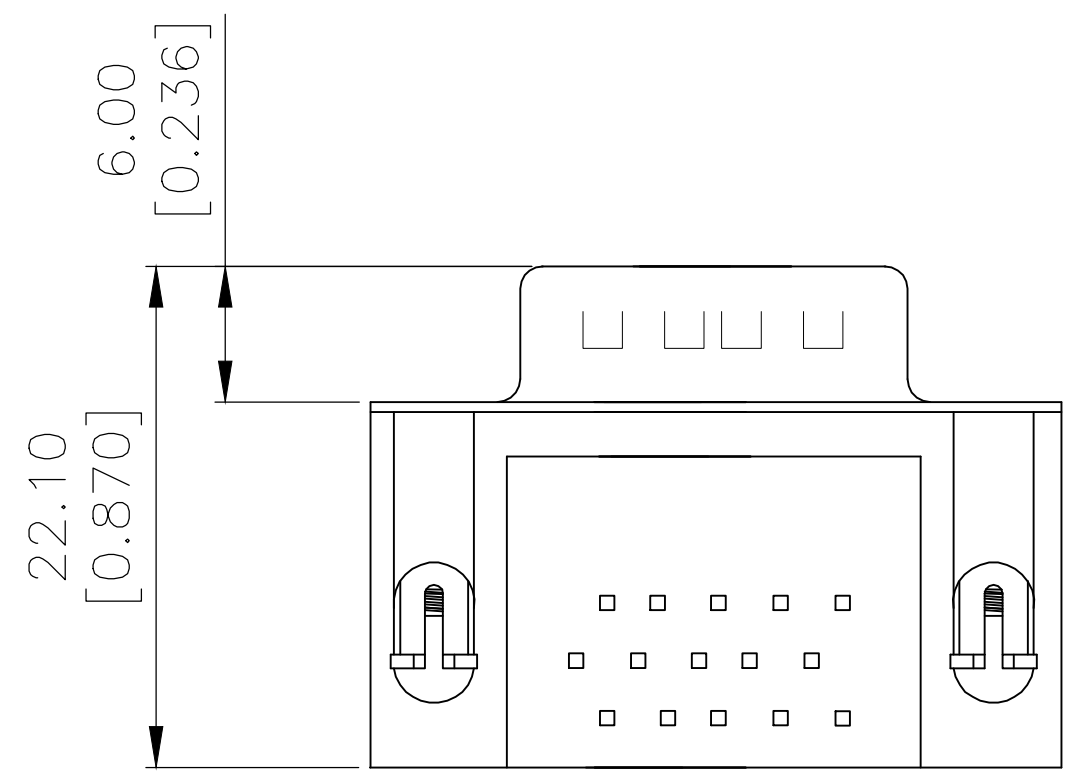
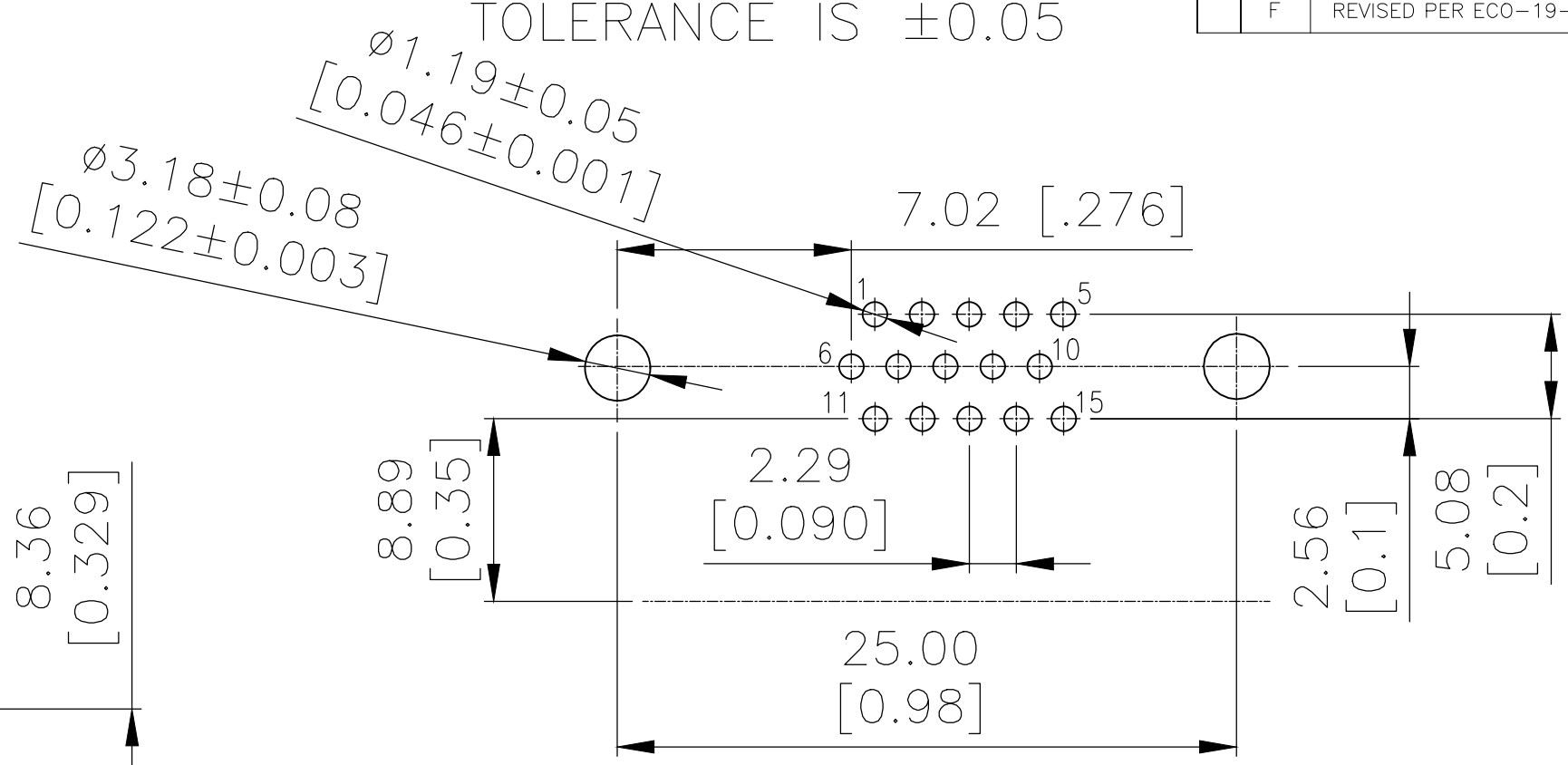
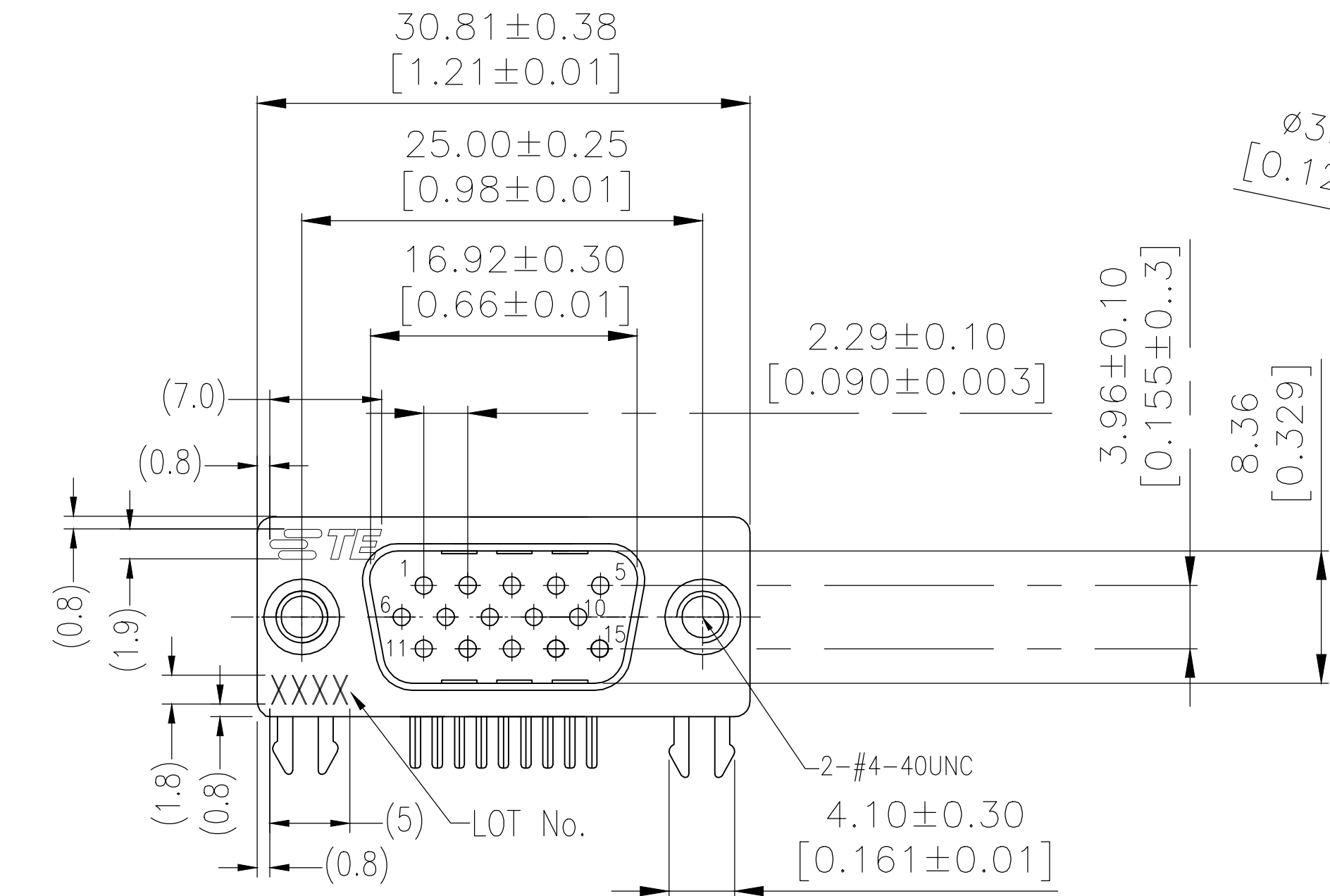

NOTES:
 Housing:PBT+30%GF(UL94V-0) BLACK
 Contact:Brass
 " GOLD PLATING ON CONTACT AREA
 100u" MATTE TIN PLATING ON SOLDER TAIL
 50u" NICKEL UNDERPLATED OVERALL
 HOLDDOWN:Brass,100u" TIN OVER 50u" NICKEL
 Shell: Cold Roller Steel, Ni Plated
 Revit: Brass, Nickel Plating
 LOT NUMBER "XXXX"
 ↳ Stands For Calendar Year
 ↳ Stands For Week Number

THREADED	30μ" Au	2311774-1
-	Contact Area	P/N
	Plating	

THIS DRAWING IS A CONTROLLED DOCUMENT.		DWN AJITH PAI 09MAR2017	STE TE Connectivity	
DIMENSIONS: mm		CHK DANIEL GORENC 09MAR2017		
TOLERANCES UNLESS OTHERWISE SPECIFIED:		APVD DANIEL GORENC 09MAR2017	NAME AMPLIMITE PLUG, HD22, RIGHT ANGLE, 15P	
0 PLC ± -		PRODUCT SPEC 108-130023	SIZE A2	
1 PLC ± -		APPLICATION SPEC	CAGE CODE 00779	
2 PLC ± 0.25			DRAWING NO C=2311774	
3 PLC ± -			RESTRICTED TO -	
4 PLC ± -			SCALE 1:1	
ANGLES ± -			SHEET 1 OF 1	
FINISH		WEIGHT	REV F	
-			CUSTOMER DRAWING	

单击下面可查看定价，库存，交付和生命周期等信息

[>>TE Connectivity\(泰科\)](#)