

LOC	DIST	REV. NO.	DESCRIPTION	DATE	DWN	APVD
A1	-	1	Zeichnung neu erstellt	09JAN02	GF	BK
		2	UPDATE NOTE 1	07AUG2003	PS	BL
		3	NOTE 2 ADDED	29SEP2008	PS	MZ
		4	TOOL DUPLICATION	11MAR2010	GS	MZ

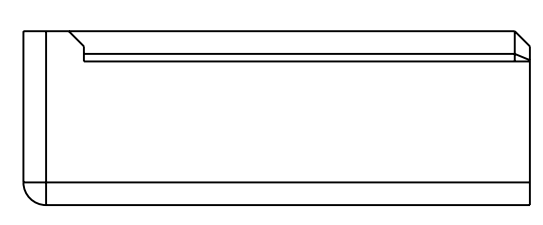
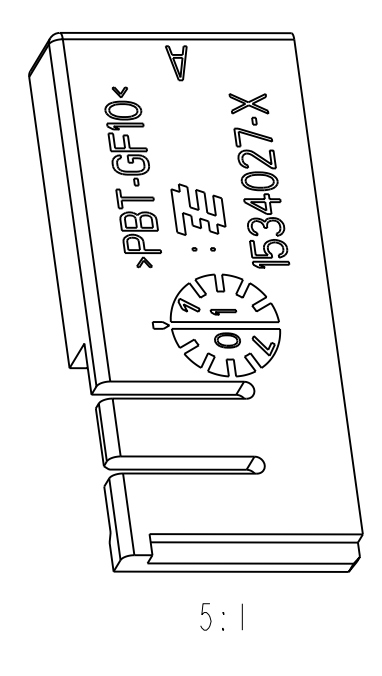
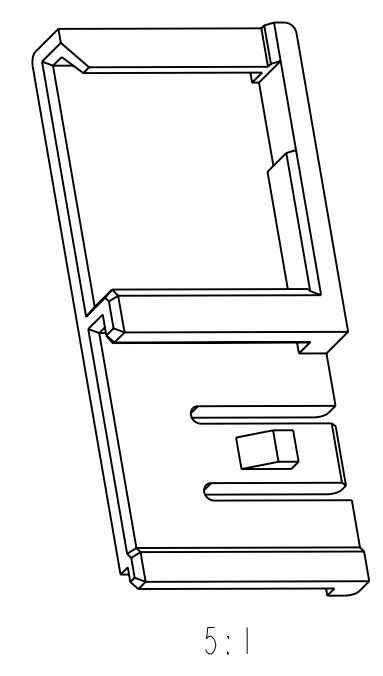
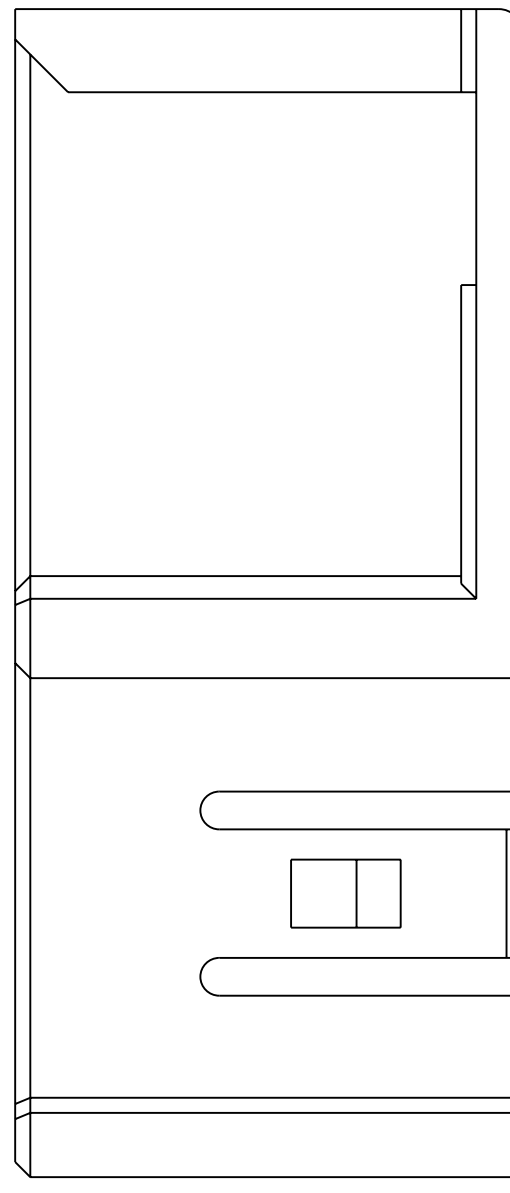
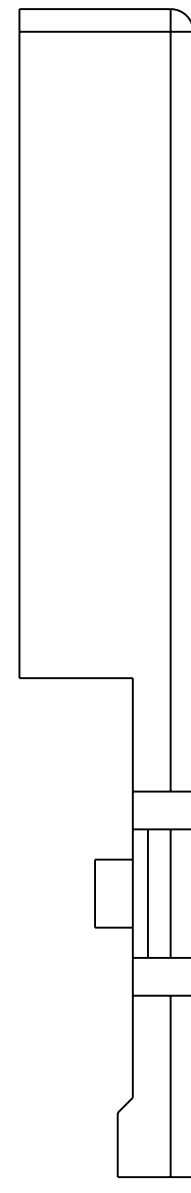
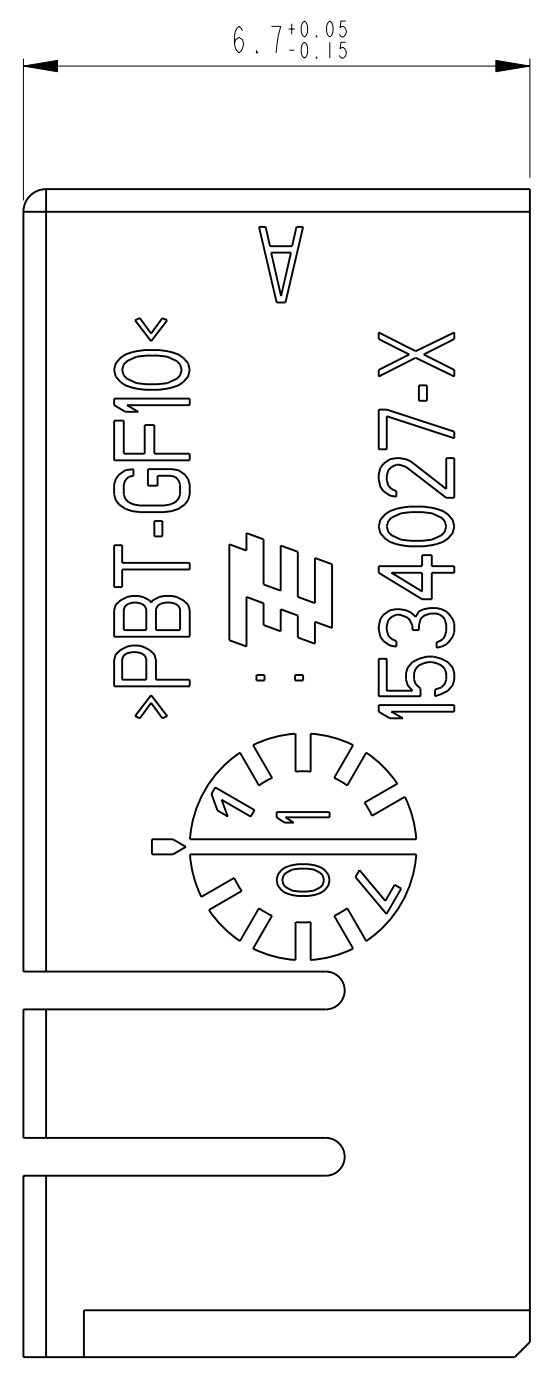
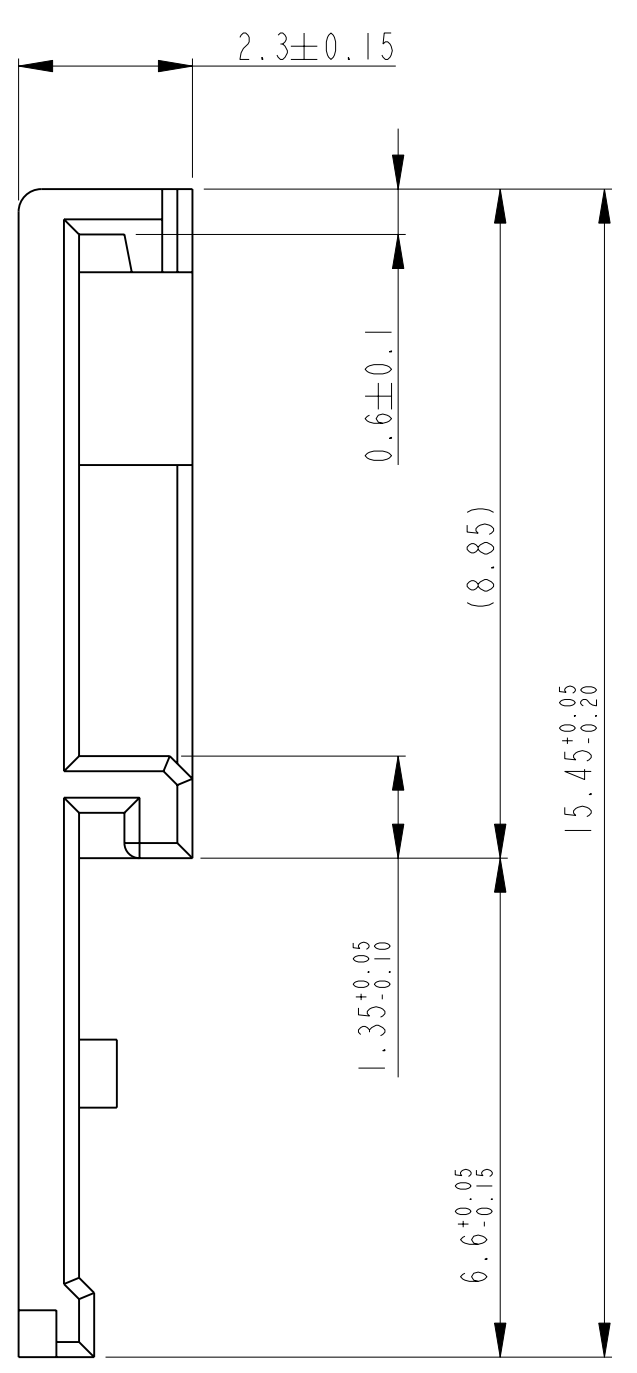

Notes

- 1 RETAINER USED WITH REC.HSG. 1534026, 1534038 ONLY FOR AUDI PIN.HSG. 1534155, 1534165 ONLY FOR AUDI
- 2 PACKAGING: LOOSE PIECE IN PE-BAG IN BOX

Bemerkungen

- 1 Verriegelung verwendet mit Buchsengehäuse 1534026, 1534038 nur für Audi Stiftgehäuse 1534155, 1534165 nur für Audi
- 2 Verpackung: Schuttgut in Polybeutel in Karton

PART NO. Teile-Nr	REV.	MATERIAL NO.	COLOUR Farbe	RAL	ITEM NO.
1534027-2	A	703652-2	BROWN/braun	1011	-
1534027-1	A	703652-3	BLACK/schwarz	9011	-

THE DRAWING IS CONTROLLED THROUGH THE ELECTRONICS CORPORATION. IT IS SUBJECT TO CHANGE WITHOUT NOTICE AND WITHOUT LIABILITY. DIESES ZEICHNUNGS-DOKUMENT WIRD DURCH AMP KONTROLLIERT. ANÄNDERUNGEN, DIE SICH TECHNISCHER FORTSCHRITT DURCH DEN WIRTSCHAFTLICHEN ANFORDERUNGSSTAND ERGEBEN, WERDEN MIT AMP ANGEKÜNDIGT.		DWN: G. Fischer CHK: B. Kirsch	09JAN02 09JAN02	Tyco Electronics Tyco Electronics AMP GmbH 0 - 64625 Bensheim
DIMENSIONS: MASSEINHEITEN: mm TOLERANCES: UNLESS OTHERWISE SPECIFIED: ALL GEOMETRIC TOLERANCES 1. PLC ±0.10 2. PRC ±0.15 3. PRC ±0.15 4. PRC ±0.15 5. PRC ±0.15 6. PRC ±0.15 7. PRC ±0.15 8. PRC ±0.15 9. PRC ±0.15 10. PRC ±0.15 11. PRC ±0.15 12. PRC ±0.15 13. PRC ±0.15 14. PRC ±0.15 15. PRC ±0.15 16. PRC ±0.15 17. PRC ±0.15 18. PRC ±0.15 19. PRC ±0.15 20. PRC ±0.15 21. PRC ±0.15 22. PRC ±0.15 23. PRC ±0.15 24. PRC ±0.15 25. PRC ±0.15 26. PRC ±0.15 27. PRC ±0.15 28. PRC ±0.15 29. PRC ±0.15 30. PRC ±0.15 31. PRC ±0.15 32. PRC ±0.15 33. PRC ±0.15 34. PRC ±0.15 35. PRC ±0.15 36. PRC ±0.15 37. PRC ±0.15 38. PRC ±0.15 39. PRC ±0.15 40. PRC ±0.15 41. PRC ±0.15 42. PRC ±0.15 43. PRC ±0.15 44. PRC ±0.15 45. PRC ±0.15 46. PRC ±0.15 47. PRC ±0.15 48. PRC ±0.15 49. PRC ±0.15 50. PRC ±0.15 51. PRC ±0.15 52. PRC ±0.15 53. PRC ±0.15 54. PRC ±0.15 55. PRC ±0.15 56. PRC ±0.15 57. PRC ±0.15 58. PRC ±0.15 59. PRC ±0.15 60. PRC ±0.15 61. PRC ±0.15 62. PRC ±0.15 63. PRC ±0.15 64. PRC ±0.15 65. PRC ±0.15 66. PRC ±0.15 67. PRC ±0.15 68. PRC ±0.15 69. PRC ±0.15 70. PRC ±0.15 71. PRC ±0.15 72. PRC ±0.15 73. PRC ±0.15 74. PRC ±0.15 75. PRC ±0.15 76. PRC ±0.15 77. PRC ±0.15 78. PRC ±0.15 79. PRC ±0.15 80. PRC ±0.15 81. PRC ±0.15 82. PRC ±0.15 83. PRC ±0.15 84. PRC ±0.15 85. PRC ±0.15 86. PRC ±0.15 87. PRC ±0.15 88. PRC ±0.15 89. PRC ±0.15 90. PRC ±0.15 91. PRC ±0.15 92. PRC ±0.15 93. PRC ±0.15 94. PRC ±0.15 95. PRC ±0.15 96. PRC ±0.15 97. PRC ±0.15 98. PRC ±0.15 99. PRC ±0.15 100. PRC ±0.15	PRODUCT SPEC: 108-18924 APPLICATION SPEC: 114-18620 VERARBEITUNGSSPEZ: 114-18620	NAME: RETAINER, 2 POSN.REC.HSG, MOS Verriegelung, 2pol.Bu.Geh., MOS SIZE: A1 CAGE CODE: 00779 DRAWING NO: 1534027 REVISIONS-NR: 1534027	RESTRICTED TO NUR FÜR: - SCALE: 10:1 SHEET: 1 OF 1 REV: A4	
MATERIAL: PBT-GF 10 MAX. 20% REG.	FINISH/OBERFLÄCHE/FARBE: -	WEIGHT: 0.27g CUSTOMER DRAWING: /KUNDENZEICHNUNG	SCALE: 10:1 SHEET: 1 OF 1 REV: A4	SCALE: 10:1 SHEET: 1 OF 1 REV: A4

单击下面可查看定价，库存，交付和生命周期等信息

[>>TE Connectivity\(泰科\)](#)