

NUMBER C-172129

METRIC

PRINT DIST

ALL DIMENSIONS IN MM. DO NOT SCALE PRINT

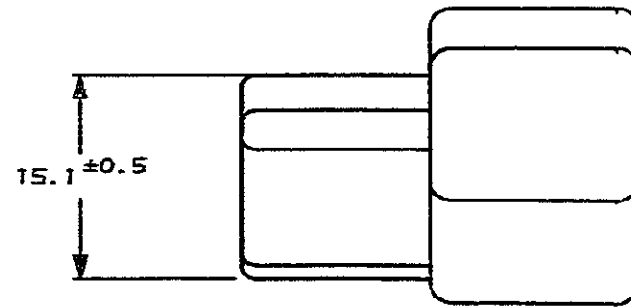
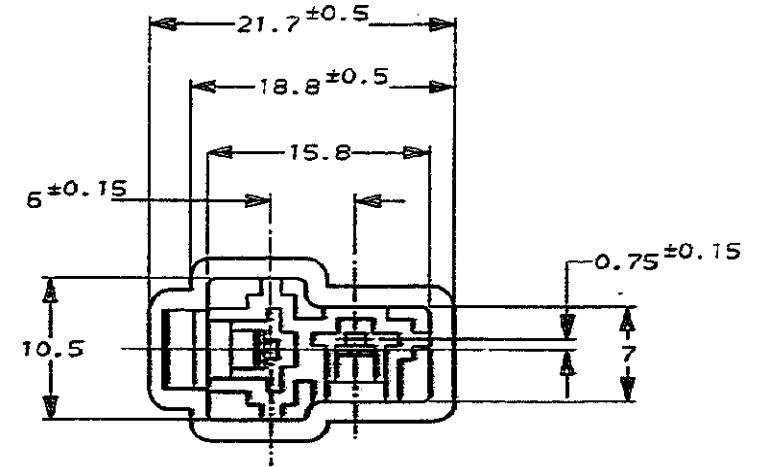
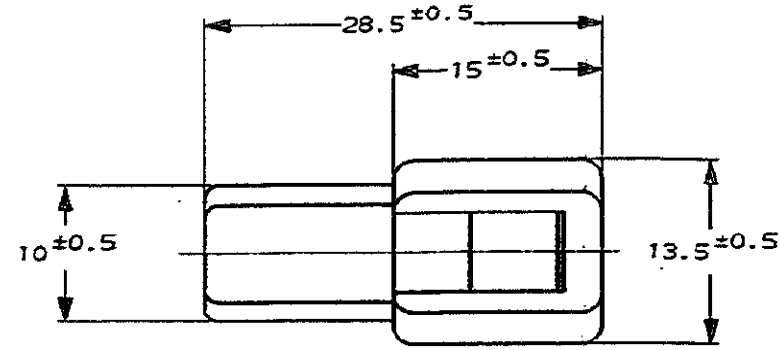
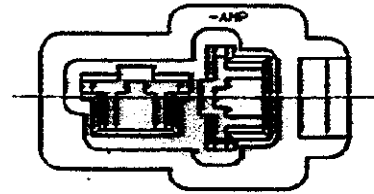

注.

- 1. 嵌合する相手ハウジングは型番172130
- 2. 使用端子は型番170340, 170341, 170349

NOTE.

- 1. THE MATING PLUG HOUSING, P/N 172130
- 2. APPLIED CONTACT, P/N 170340, 170341, 170349

△ OBSOLETE PARTS: OBSOLETE CIS STREAMLINING PER D.RENAUD/D.SINISI

	淡灰 (LIGHT GRAY)	6-172129-5
	自然色 (NATURAL) 94V-0	1-▲-1
	赤 (RED)	-9
△ OBSOLETE	橙 (ORANGE)	-8
OBSOLETE	YELLOW	7
	青 (BLUE)	-5
△ OBSOLETE	緑 (GREEN)	-4
OBSOLETE	茶 (BROWN)	-3
	黒 (BLACK)	▼-2
	自然色 (NATURAL)	172129-1
	色 (COLOR)	番号 (NUMBER)

**STE** TE Connectivity

C5	REVISED PER ECR-19-018127	AA	EW	10AUG20
C4	REVISED PER ECR-17-012979	BDA	TD	11SEP2017
C3	REVISED PER ECR-16-015261	RS	TD	28OCT16
C2	REVISED PER ECO-11-005030	RK	HMR	22MAR11
LTR	変更 (REVISION RECORD)	DR	CHK	DATE

材料 (MATERIAL)	仕上 (FINISH)	名称 (NAME)
6/6 ナイロン (6/6 NYLON)	色: 表参照 (COLOR: SEE TABLE)	"250"シリーズハウジングランスコネクタ2極キャップハウジング "250" SERIES HOUSING LANCE CONNECTOR 2P CAP HOUSING
DR. K. Yamada 9/10/23	DE. K. Yamada 9/10/23	一般公差 (GENERAL TOLERANCES)
CHK. T. Yamada 9/10/23	APR. T. Yamada 9/10/23	10%以下: ±0.2 30%以下: ±0.25 30%以上: ±0.3 角: ±3°
		LOG 番号 (No.)
		B J C-172129
		尺度 (SCALED)
		2-1
		REV. C5
		SHEET 1 OF 1

单击下面可查看定价，库存，交付和生命周期等信息

[>>TE Connectivity\(泰科\)](#)