

4

3

2

1

THIS DRAWING IS UNPUBLISHED. RELEASED FOR PUBLICATION 20  
 © COPYRIGHT 20 BY - ALL RIGHTS RESERVED.

REVISIONS				
P	LYR	DESCRIPTION	DATE	DWN APVD
A		FIRST VERSION	18OCT2018	G.F S.M
A1		ECR-19-005614 UPDATE LAYOUT DIMENSION	08APR2019	G.F S.M

NOTES :

MATERIALS AND FINISH:  
 - HOUSING: HIGH TEMPERATURE RESIN, NATURAL  
 - CONTACTS: COPPER ALLOY, FINISH: PRE-TIN OVER NICKEL UNDERPLATE

- MUST COMPLY WITH DIRECTIVE 2002/95/EC (ROHS)
- WIRE TYPES AND SIZES ACCEPTED  
 SOLID WIRE: 18AWG, 20AWG, 22AWG, 16AWG (ONLY ONE TIME INSERTING)  
 STRANDED WIRE(TIN-DIPPED): 18AWG; 20AWG; 22AWG  
 MAX INSULATION OD: 2.05mm MAX.  
 STRIP LENGTH: 8.0±0.5mm
- PACKAGED IN TAPE AND REEL

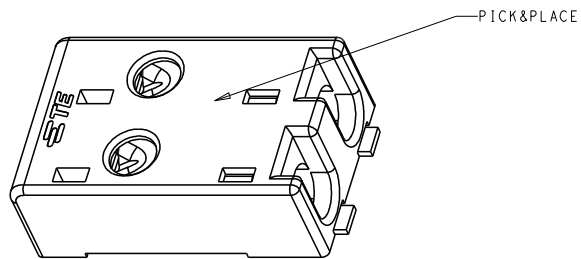
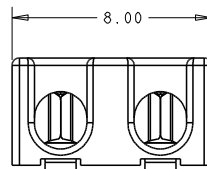
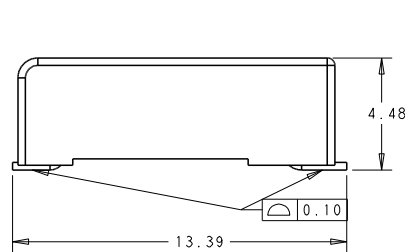
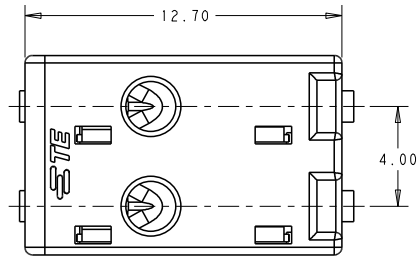

P/N: 2834385-2

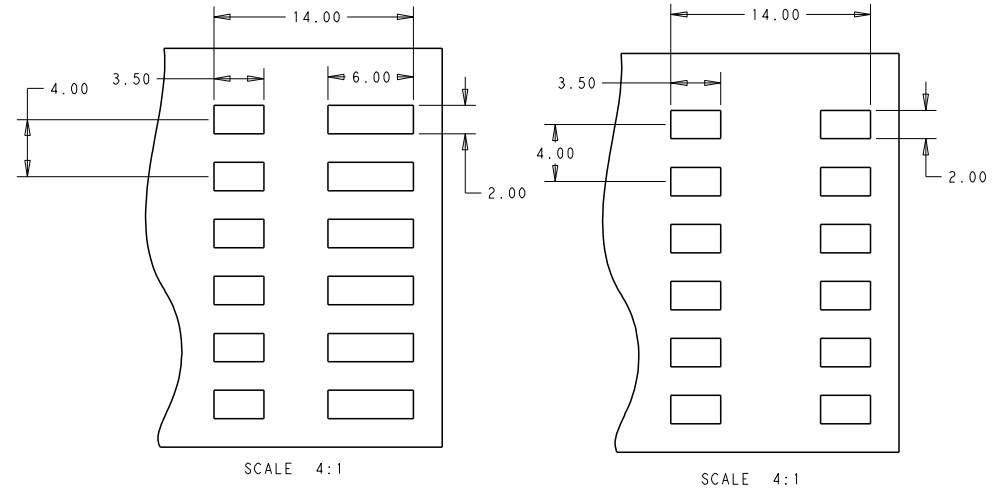

THIS DRAWING IS A CONTROLLED DOCUMENT.		DWN - GEORGE FU 18OCT2018	<b>STE</b> TE Connectivity
		CHK - GEORGE FU 18OCT2018	
		APVD - GEORGE FU 18OCT2018	NAME 2P CONNECTOR ASSEMBLY RELEASEABLE POKE-IN
DIMENSIONS: (mm)		PRODUCT SPEC SHELL MING 108-137055	SIZE CAGE CODE DRAWING NO A200779 ©=2834385
TOLERANCES UNLESS OTHERWISE SPECIFIED:		APPLICATION SPEC 114-137055	RESTRICTED TO
0 PLC ±-		WEIGHT -	SCALE 2:1 SHEET 1 OF 1 REV A1
1 PLC ±0.2		CUSTOMER DRAWING	
2 PLC ±0.13			
3 PLC ±-			
4 PLC ±-			
ANGLES FINISH ±-			
MATERIAL SEE NOTE			
FINISH SEE NOTE			

单击下面可查看定价，库存，交付和生命周期等信息

[>>TE Connectivity\(泰科\)](#)