

LOC		DIST		REVISIONS			
CM	00	REV	DATE	BY	CHK	APPV	
R1		REVISED PER ECR-12-011660	24JAN13	KH	TM		

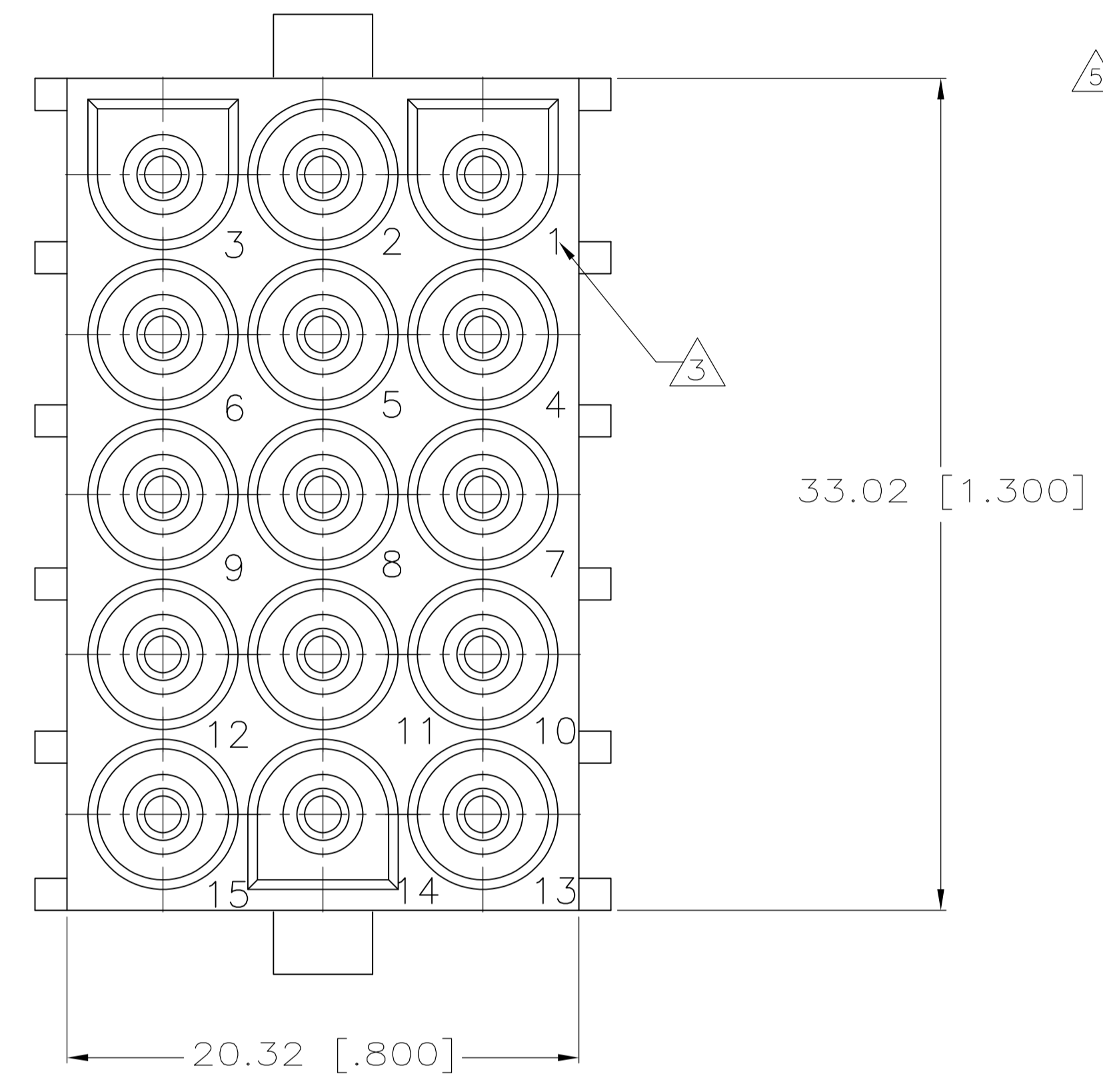

- 1 PARTS COMPLY TO AMP SOLDERABILITY SPECIFICATION 109-11-3.
- 2 CONTACT IS STAMPED FROM PRE-PLATED STOCK WHICH IS PLATED OVERALL WITH 0.00127 [.000050] NICKEL, THEN STRIPED WITH 0.00076 [.000030] GOLD IN CONTACT AREA INDICATED AND TIN-LEAD ON SOLDER TAIL END.
- 3 CIRCUIT IDENTIFICATION CHARACTERS ARE ADJACENT TO THE INDICATED CAVITIES, BUT LOCATION AND ORIENTATION MAY DIFFER FROM PRINT.
- 4 CONTACT IS PLATED OVERALL WITH 0.00127 [.000050] NICKEL, THEN 0.00076 [.000030] GOLD OVER CONTACT LENGTH INDICATED AND MATTE TIN ON SOLDER TAIL END.
- 5 SUPERSEDED BY 350765-5

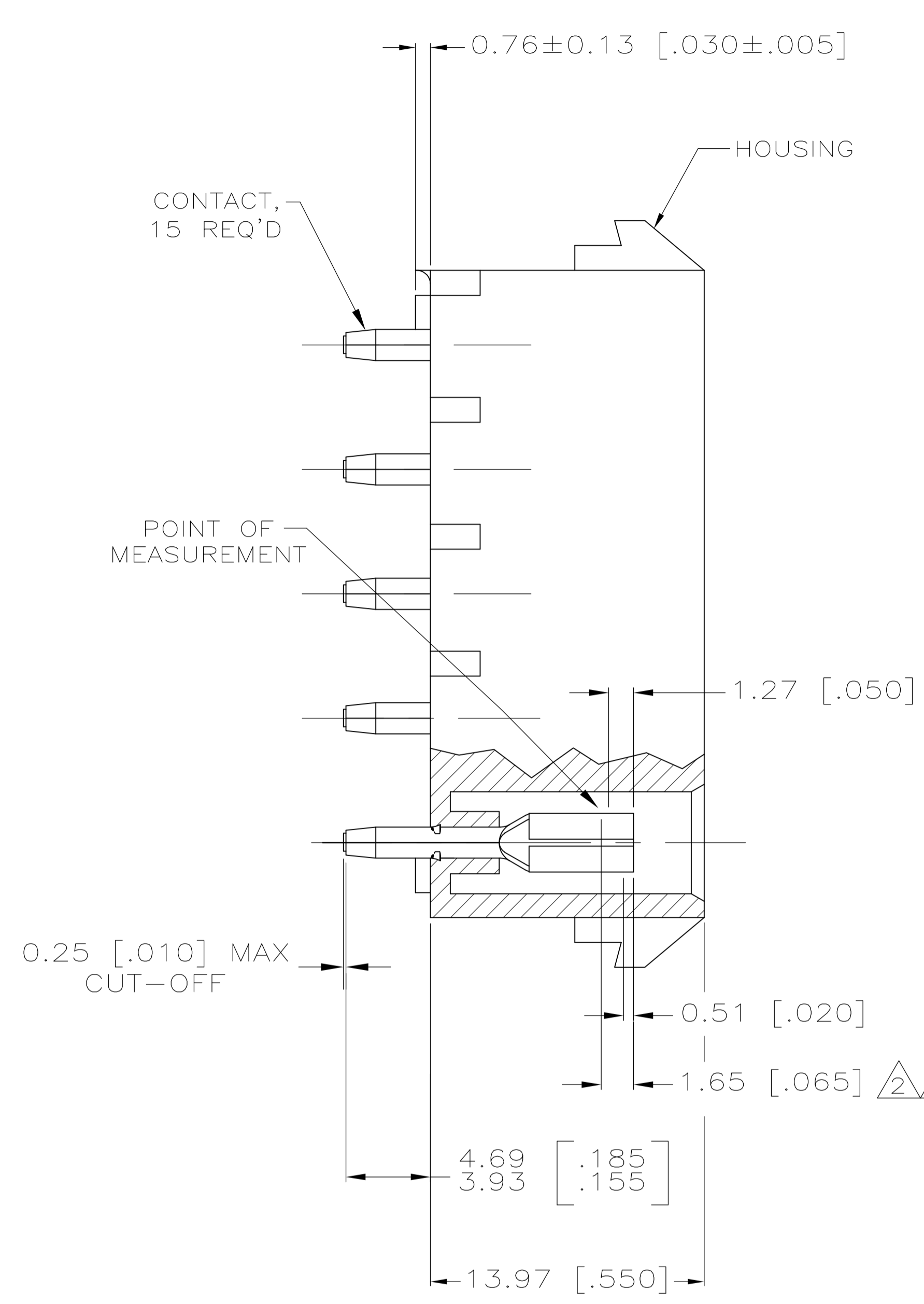
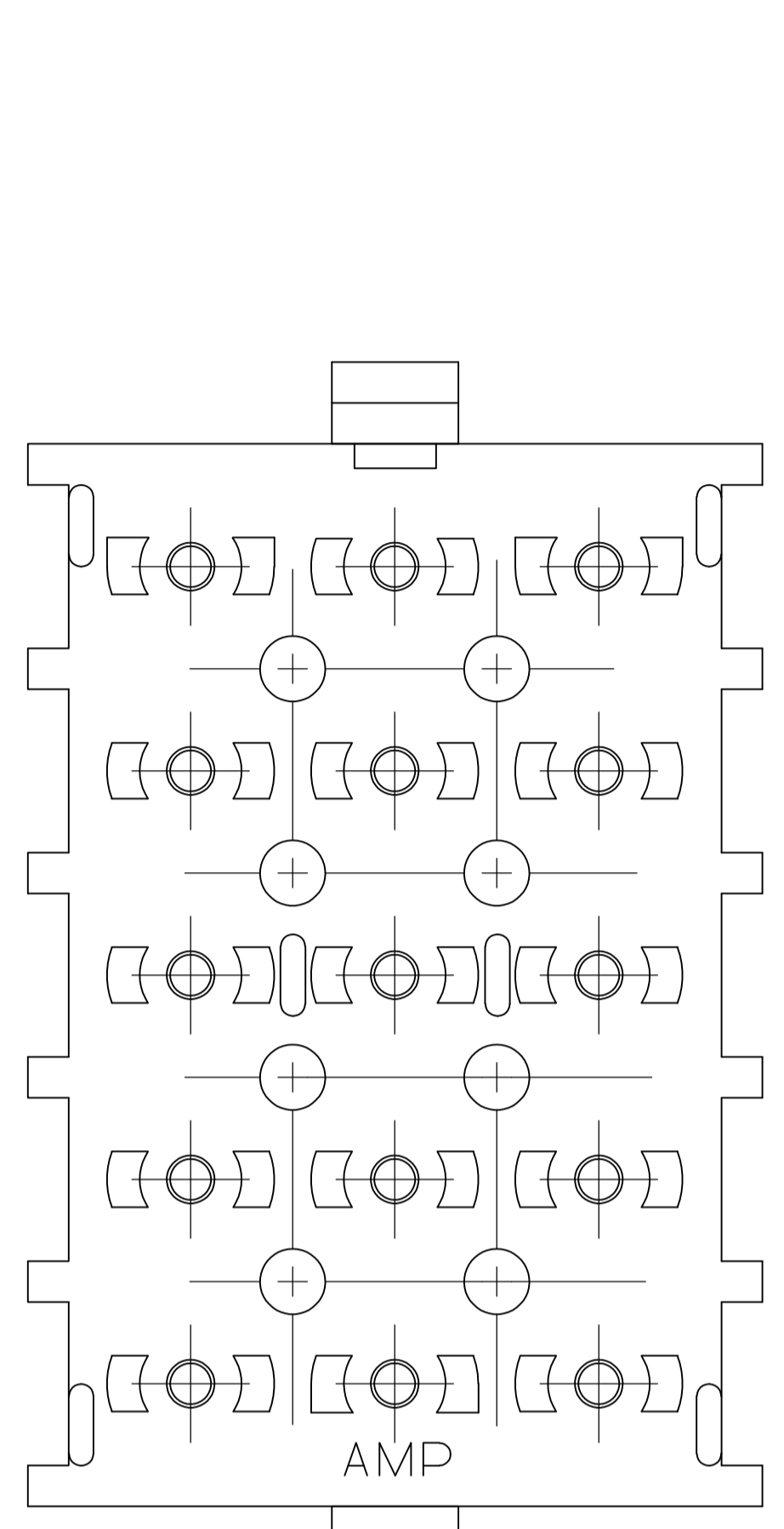
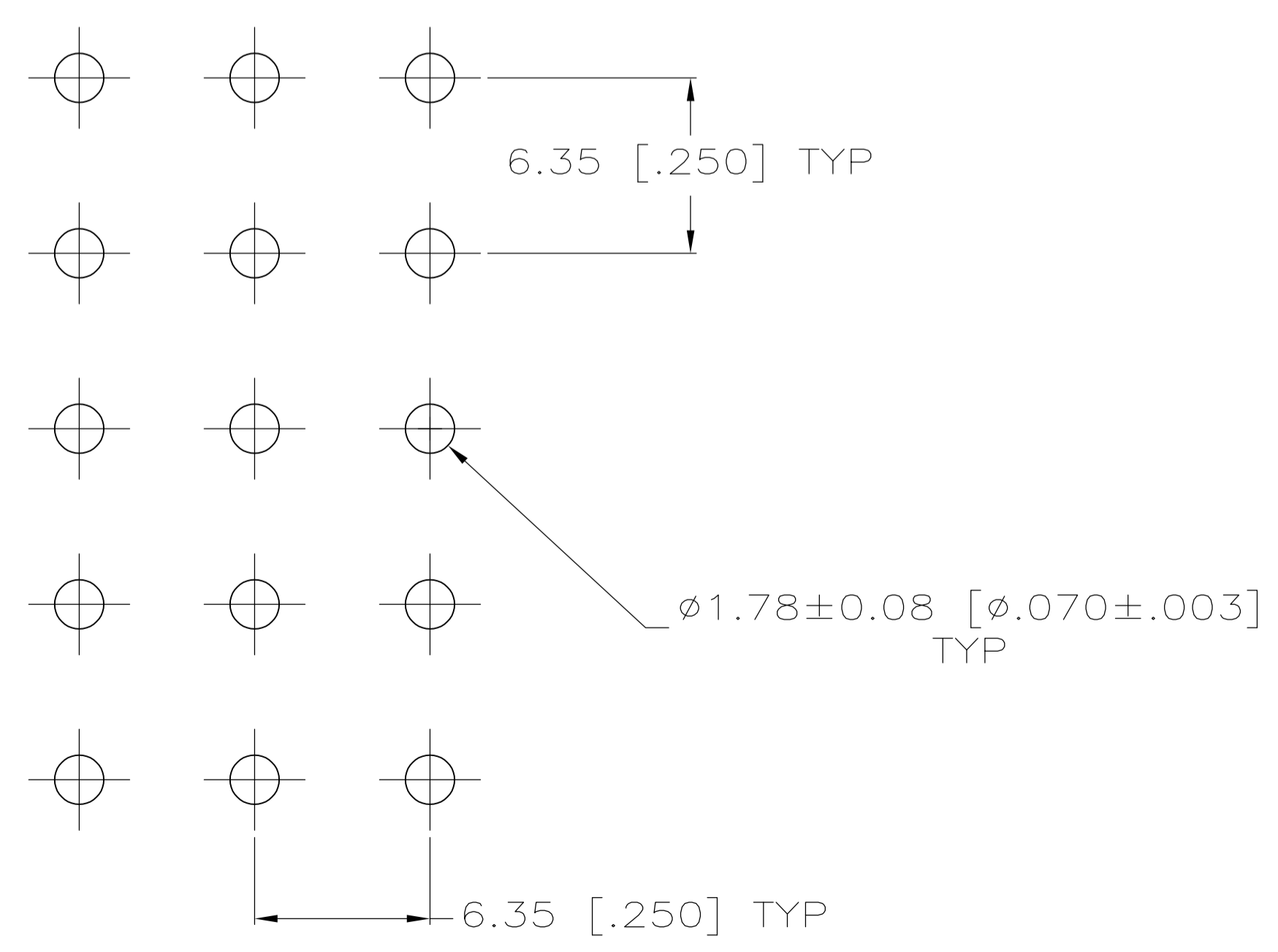

RECOMMENDED LAYOUT FOR 1.58 [.062] THICK PC BOARD

PH BRZ GOLD 2	NYLON, NATURAL	350765-5
PH BRZ TIN	NYLON, NATURAL	350765-4
PH BRZ GOLD 2	NYLON, NATURAL	350765-3
CONTACT	HOUSING	PART NO

DIMENSIONS:		TOLERANCES UNLESS OTHERWISE SPECIFIED:		APPROVED:		NAME:	
mm [INCHES]				CHK	DATE	APPROV	DATE
0. PL C	±	0. PL C	±	S. RIDGILL	11OCT2005		
1. PL C	±	1. PL C	±	S. RIDGILL	11OCT2005		
2. PL C	±	2. PL C	±				
3. PL C	±	3. PL C	±				
4. PL C	±	4. PL C	±				
ANGLES	±	ANGLES	±				

THIS DRAWING IS A CONTROLLED DOCUMENT.		DIN K. WHITAKER 11OCT2005		TE Connectivity	
MATERIAL SEE TABLE		FINISH SEE TABLE			
WEIGHT		SIZE		RESTRICTED TO	
CUSTOMER DRAWING		A1 00779 C=350765		15 CIRCUIT UNIVERSAL MATE-N-LOK (TM) P.C. BOARD SOCKET HEADER ASSEMBLY	
SCALE 5:1		SHEET 1 OF 1		REV R1	

单击下面可查看定价，库存，交付和生命周期等信息

[>>TE Connectivity\(泰科\)](#)