

NOTES:

1. PART NUMBER VARIABLE:

MTC50-YXX-XXX

015 = PIN INSERT
016 = SOCKET INSERT

1 = 1" INSERT
2 = 2" INSERT

A = 'A' INSERT
B = 'B' INSERT

2. THE APPLICABLE TYCO ELECTRONICS SPECIFICATION FOR THIS PART IS C6111. THIS PART IS QUALIFIED TO C6111.

3. MATERIAL:

- A. SEALING MODULE: SEE SCD CTA-024X TRANSPARENT BLUE HEAT SHRINKABLE, RADIATION CROSS-LINKED PVF
- B. WIRE AND INSERT SEALS: MODIFIED THERMOPLASTIC HOT MELT SEALANT.
- C. INSERT BODY: HIGH GRADE POLYARYLENE THERMOPLASTIC OR EQUIVALENT.
- D. PIN/SOCKET CONTACTS: COPPER ALLOY 172 PER QQ-C-533.
- E. SolderSleeve: SEE RAYCHEM SPECIFICATION CONTROL DRAWING D-141-0169.

4. FINISH:

- A. PIN/SOCKET INSERT: AS MOLDED
- B. PIN/SOCKET CONTACT: (ENGAGING END)
- (TERMINATION END)

5. #1 POSITION IS MARKED IN CONTRASTING COLOR.

6. DIELECTRIC WITHSTANDING VOLTAGE:

TEST CONDITION	TEST VOLTAGE VAC RMS AT 60 HZ.
SEA LEVEL	750
ALTITUDE 70,000 FT. (33.5 TORR) AMBIENT TEMP.	250
ALTITUDE 80,000 FT. (20.6 TORR) -50°C TEMP.	375

7. CURRENT RATING: 2.0 AMPS

8. USABLE WIRE SIZE:

ROUND WIRE: 24 AWG OR 26 AWG.

9. SEE TYCO ENGINEERING STANDARD ES-61408 REV C FOR TERMINATION METHOD.

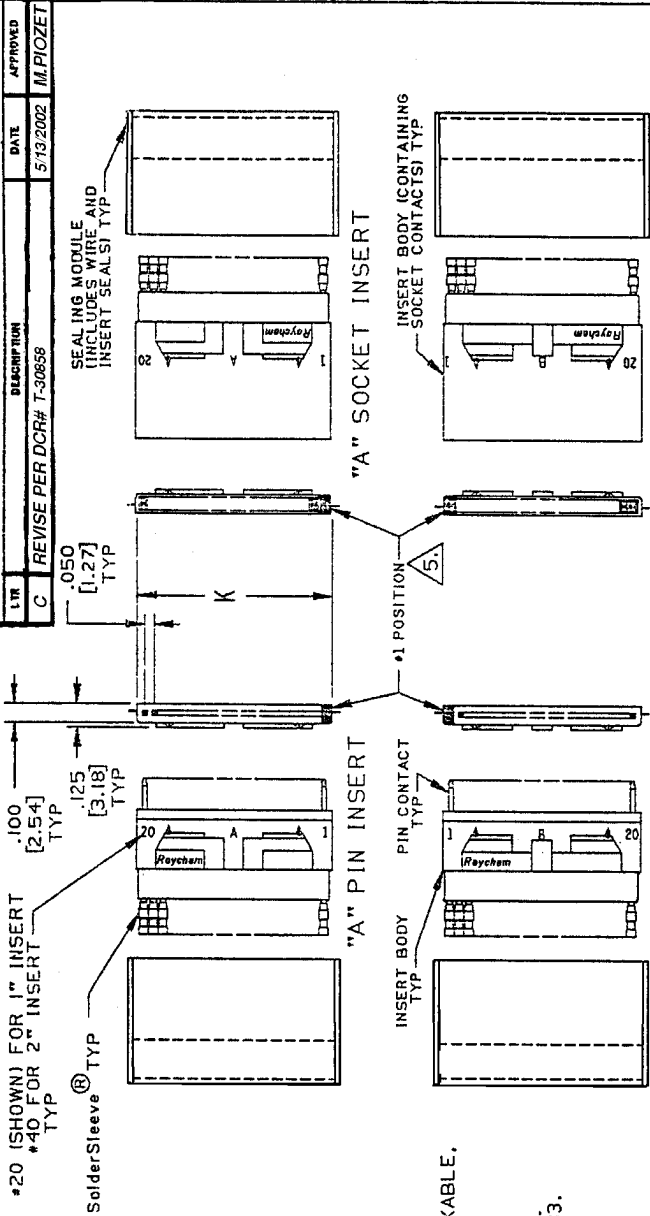

AS SUPPLIED

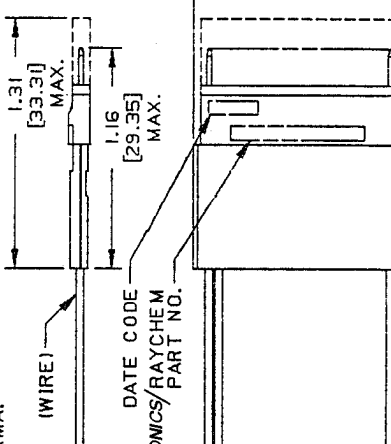

9. AFTER BOOT ASSY & TERMINATION

DESCRIPTION	1" INSERT	2" INSERT
K	1.035 [26.29]	2.035 [51.69]
L	1.140 [28.96]	2.140 [54.36]
WEIGHT (MAXIMUM)	.0074 LBS. [3.357gr.]	.0147 LBS. [6.6689gr.]

SPECIFICATION CONTROL DRAWING

UNLESS OTHERWISE SPECIFIED DIMENSIONS ARE IN INCHES. METRIC DIMENSIONS ARE IN BRACKETS.	DRAWN S. CLEGG	DATE 07-APR-88	TYCO ELECTRONICS
DECIMALS .XXX ±0.05 [0.13mm] .XX ±0.3 [0.08mm] ANGLES .X ± .9	CHECKED M. HIGBY	DATE 07-APR-88	RAYCHEM PRODUCTS 365 CONSTRUCTION DR. MENLO PARK, CA 94025
WEIGHT SEE TABULATION	APPROVED M. BLAIR	DATE 07-APR-88	TITLE INSERT, .050 PITCH, PASS TERM. 125°C OPERATING TEMPERATURE (FOR 24-26 AWG WIRE) MTC50 SERIES
THIRD ANGLE PROJECTION	APPROVED J. CAMERON	DATE 07-APR-88	SCALE DO NOT SCALE THIS DRAWING
	CAD FILE: T-30858.TIF		REV C
			SIZE C
			CODE IDENT. NO. MTC50-YXX-015/016
			DRG. NO. MTC50-YXX-015/016
			REV C

单击下面可查看定价，库存，交付和生命周期等信息

[>>TE Connectivity\(泰科\)](#)