

REVISIONS					
REV	DATE	DESCRIPTION	BY	CHK	APPV
P9	11NOV2020	OBSOLETE PN 5-178780-2 ECR-20-007046	PSJ	TM	

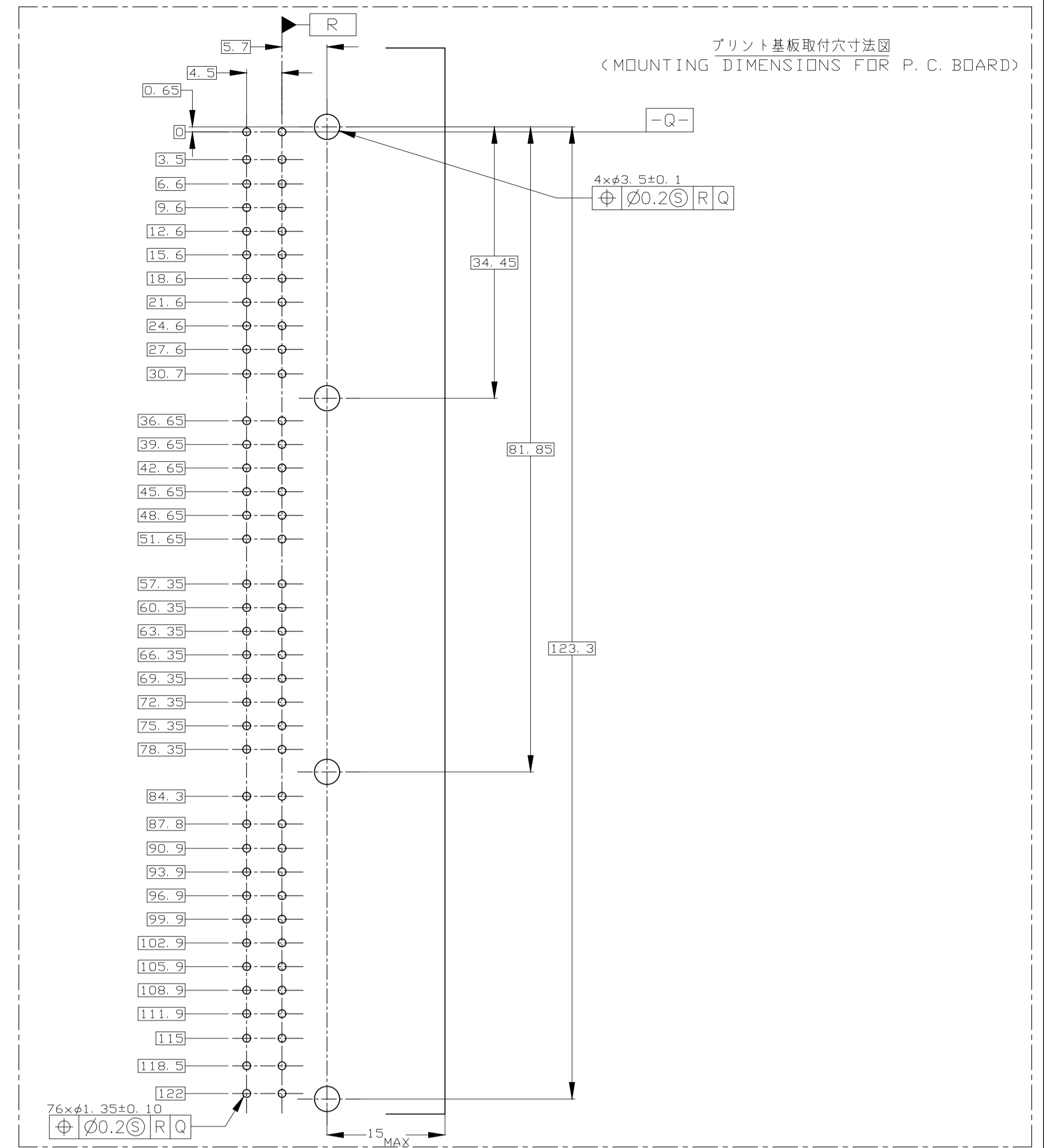

- △ X 面から2mmの範囲で測定
- 2. 嵌合相手ハウジング型: 174516, 174515, 174514, 174913
917992, 917989, 917981, 917975
- 3. 推奨取付ねじ: JIS B1115, B1122 タッピングねじ, なべ2種
呼び径3, 長さ6mm以下 (締付けトルク: 0.4N-cm以下)
- 4. 適用製品規格番号: 108-5280, 108-5342
- △ 回路番号: 右図参照のこと
- パワ回路 ① ~ ⑩
- シグナル回路 ⑪ ~ ⑯
- △ 適用製品規格のグラフィックス及びIDマークを
カマネットマークにて表示

- △ MUST BE KEPT BETWEEN X AND 2
- 2 THE MATING PLUG HSG. PART NUMBER; 174516, 174515, 174514, 174913
917992, 917989, 917981, 917975
- 3 RECOMMENDED MOUNTING SCREW; 3mmDIA, 6mmLENGTH MAX.)
PAN HEAD, CLASS 2 TAPPING SCREW SPECIFIED IN JIS
B1115, B1122
- < TIGHTENING TORQUE; 0.4N-cm MAX. >
- 4 APPLICABLE PRODUCT SPEC NO. 108-5280, 108-5342
- △ CIRCUIT NUMBER
- POWER CIRCUIT NO. ① ~ ⑩
- SIGNAL CIRCUIT NO. ⑪ ~ ⑯
- △ INDICATED PREFIX AND ID MARK OF PRODUCT P/N BY HOT MARK

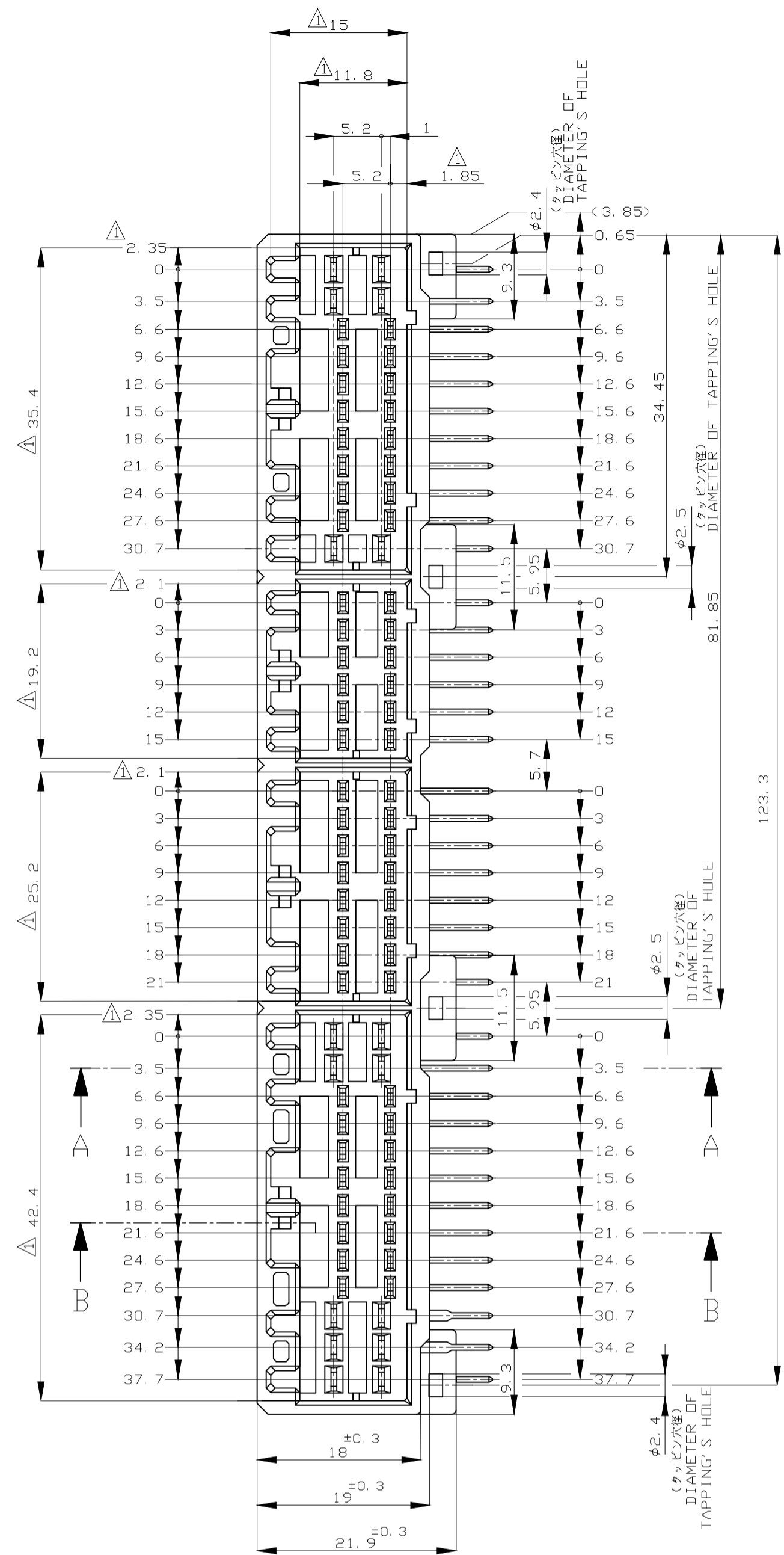
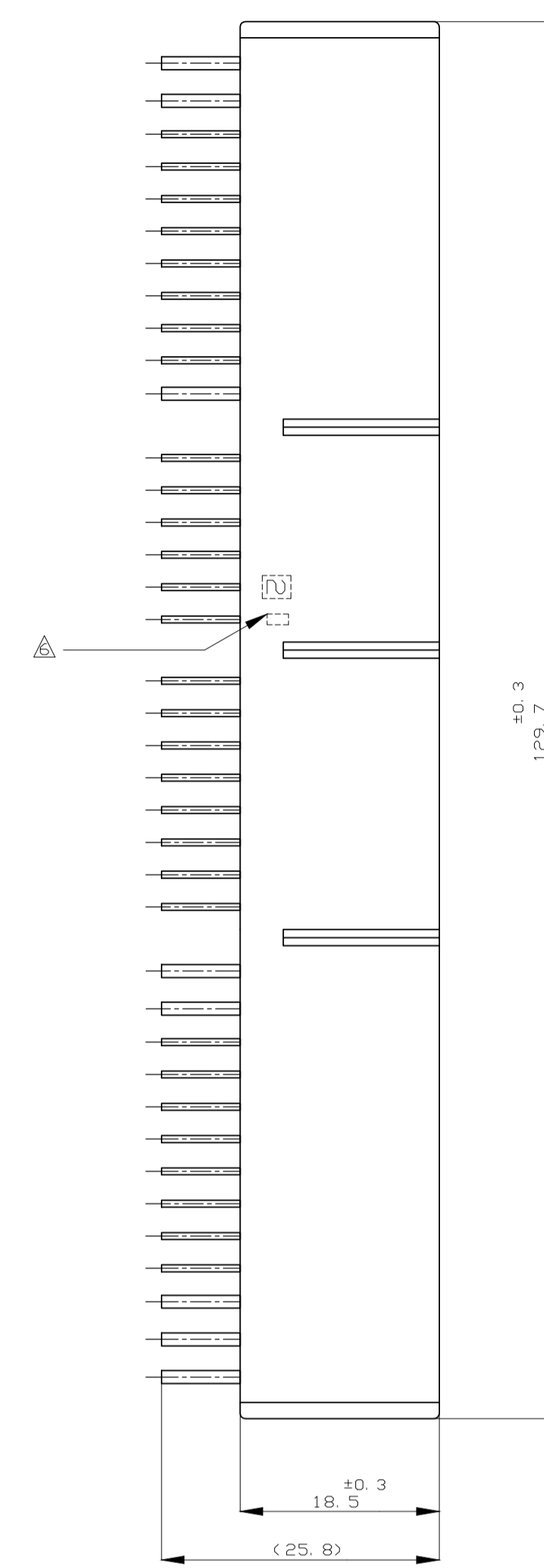
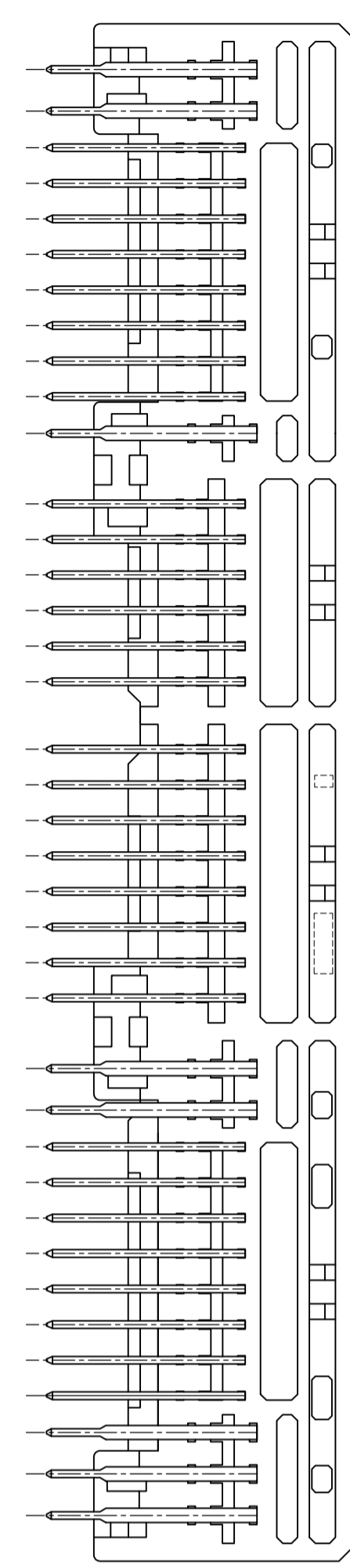
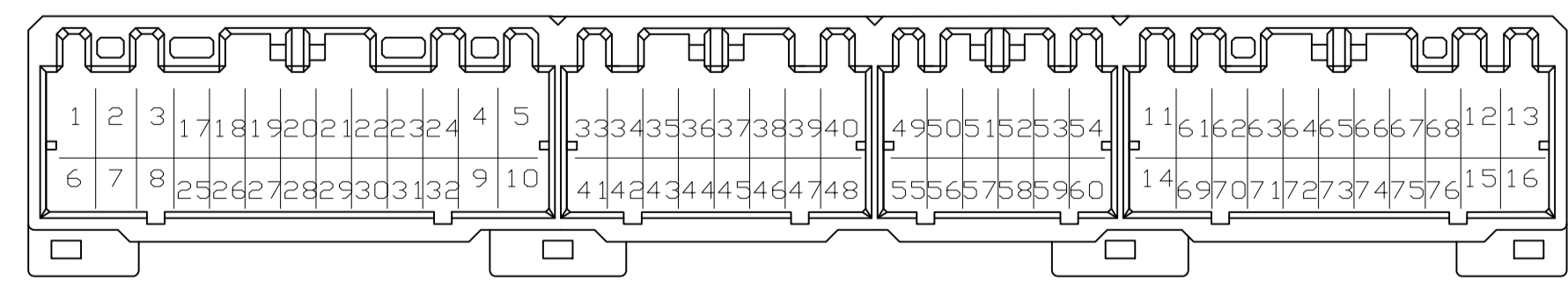
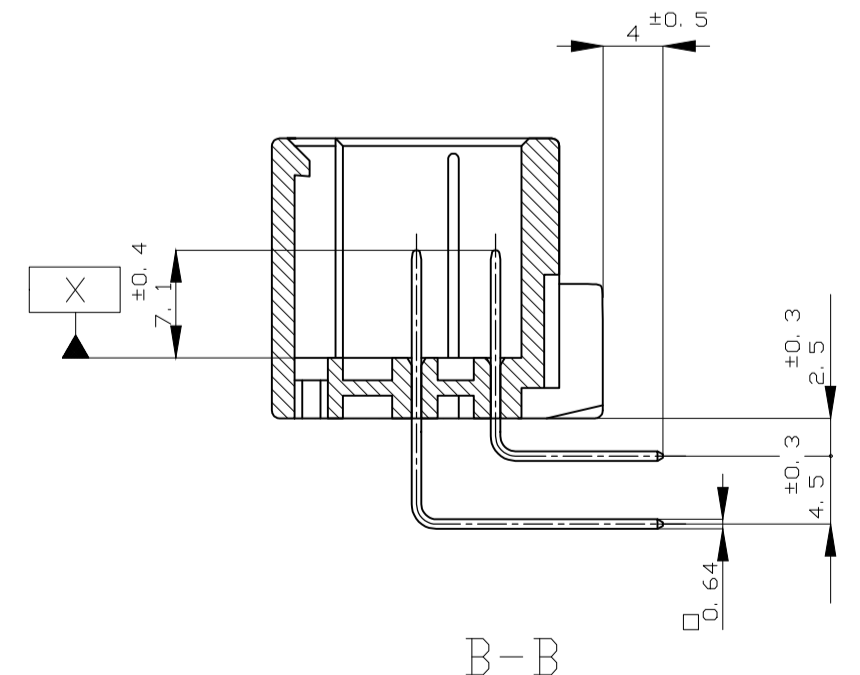
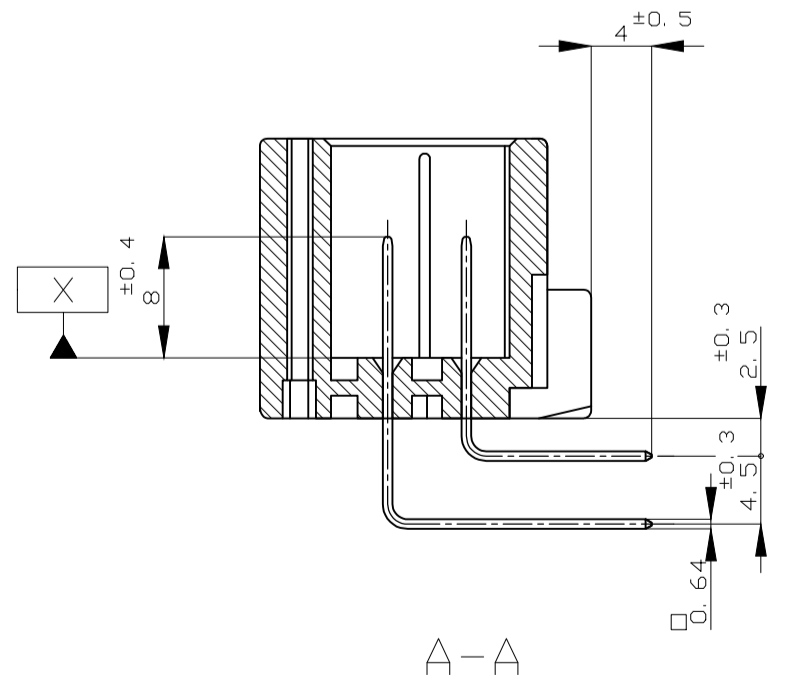

REV	DESCRIPTION	DATE	BY	CHK	APPV
56	SELECTIE-TIN (MATTE) SELECTIVE GOLD x 14 PRE-TIN x 62	-	-	-	-
55	SELECTIE-TIN (MATTE) SELECTIVE GOLD x 28 PRE-TIN x 48	-	-	-	-
55	SELECTIE-TIN (MATTE) SELECTIVE GOLD x 28 PRE-TIN x 48	-	-	-	-
54	SELECTIE-TIN (MATTE) SELECTIVE GOLD x 28 PRE-TIN x 48	-	-	-	-
54	SELECTIE-TIN (MATTE) SELECTIVE GOLD x 8 PRE-TIN x 68	-	-	-	-
53	SELECTIE-TIN (MATTE) SELECTIVE GOLD x 12 PRE-TIN x 64	-	-	-	-
53	SELECTIE-TIN (MATTE) SELECTIVE GOLD x 60 PRE-TIN x 16	-	-	-	-
52	SELECTIE-TIN (MATTE) SELECTIVE GOLD x 24 PRE-TIN x 52	9	-	-	-
52	SELECTIE-TIN (MATTE) SELECTIVE GOLD x 19 PRE-TIN x 57	-	-	-	-
△ 8	TIN-LEAD SELECTIVE GOLD x 7 PRE-TIN x 69	-	-	-	-
△ 7	TIN-LEAD SELECTIVE GOLD x 10 PRE-TIN x 66	-	-	-	-
△ 6	TIN-LEAD SELECTIVE GOLD x 14 PRE-TIN x 62	-	-	-	-
△ 5	TIN-LEAD SELECTIVE GOLD x 28 PRE-TIN x 48	-	-	-	-
△ 5	TIN-LEAD SELECTIVE GOLD x 28 PRE-TIN x 48	-	-	-	-
△ 5	TIN-LEAD SELECTIVE GOLD x 28 PRE-TIN x 48	-	-	-	-
△ 4	TIN-LEAD SELECTIVE GOLD x 28 PRE-TIN x 48	-	-	-	-
△ 4	TIN-LEAD SELECTIVE GOLD x 8 PRE-TIN x 69	-	-	-	-
△ 3	TIN-LEAD SELECTIVE GOLD x 60 PRE-TIN x 16	-	-	-	-
△ 2	TIN-LEAD SELECTIVE GOLD x 24 PRE-TIN x 52	9	-	-	-
△ 0	PRE-TIN x 76	-	-	-	-
△ 1	SELECTIE-TIN (MATTE) SELECTIVE-TIN (BRIGHT) x 76 PRE-TIN x 76	-	-	-	-
△ 0	PRE-TIN x 76	-	-	-	-

OBSOLETE

THIS DRAWING IS A CONTROLLED DOCUMENT.

GENERAL TOLERANCE: 0<< 10 ± 0.2, 10<< 30 ± 0.25, 30<< 100 ± 0.3, ANGLES ± 3°

MATERIAL: HOUSING: PBT, CONTACT: BRASS

FINISH: 仕上

SEE TABLE

WEIGHT: 23.8 g

SCALE: 2:1

SHEET: 1 of 1

REV: P9

APPROVED: M. KADOSAKI, T. SHINOHARA, K. BETSUJI

TE Connectivity

76POS CAP HOUSING ASSY
.040/.070 SERIES HYBRID I/O CONN. (NON FLANGE)

DRAWING NO: 00779, 178780

CUSTOMER DRAWING

单击下面可查看定价，库存，交付和生命周期等信息

[>>TE Connectivity\(泰科\)](#)