

DO NOT SCALE
DIMENSIONS IN mm

METRIC

THIRD ANGLE
PROJECTION

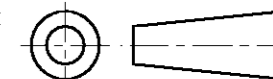

LTR.	REVISION RECORD	DR.	CHK.	DATE
C2	REVISED PER ECO-11-005140	RK	HMR	01APR11

NOTES

- 1. FOR USE ON MINIATURE APPLICATORS (LEFT-RIGHT FEED) AND STANDARD APPLICATORS (RIGHT-LEFT FEED).
- 2. REELED WITH PAPER AND PAPER COVER.
- 3. OBSOLETE PARTS: OBSOLETE CIS STREAMLINING PER D.RENAUD/D.SINISI

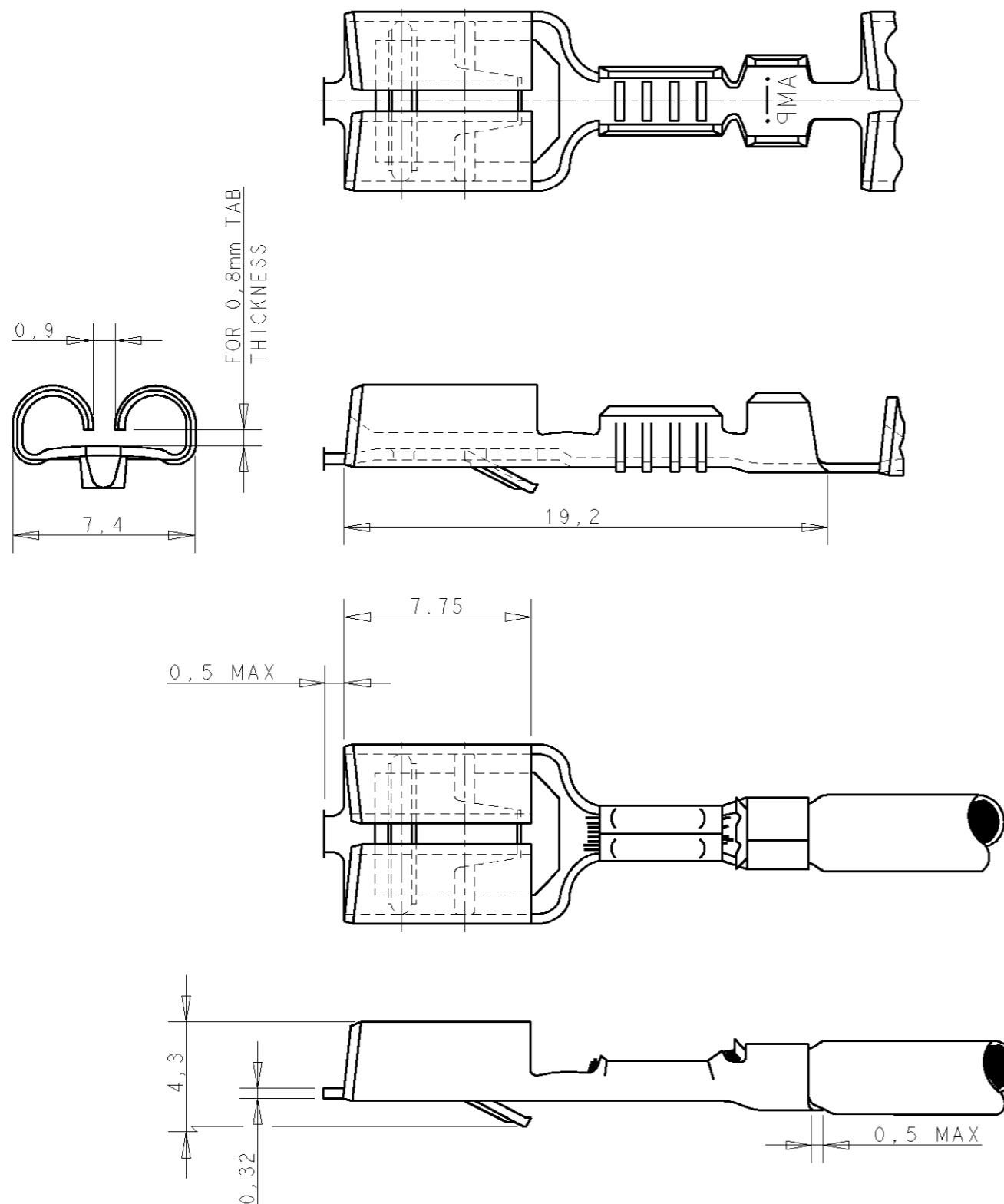

GENERAL TOLERANCES ±0.3

3	OBSOLETE	1	FINISH	MATERIAL	PARTNUMBER
		1	PRE-TINPLATED	PH. BRONZE	6-160928-8
		1	PRE-TINPLATED	BRASS	6-160928-7
		1	TINPLATED	PH. BRONZE	160928-4
		1	UNPLATED	PH. BRONZE	160928-3
		1	TINPLATED	BRASS	160928-2
		1	UNPLATED	BRASS	160928-1

3 OBSOLETE

CUSTOMER DRAWING

FOR REFERENCE ONLY
WILL NOT BE UPDATED

STE TE Connectivity

THIS DRAWING IS UNPUBLISHED | RELEASED FOR PUBLICATION jan , 1988

DR.	DATE	WIRE RANGE	NAME	REV. DATE
R. v. Lokven	26.01.88	0,5-1,0 mm ²	.250 SRS FASTIN-ON RECEPTACLE.	D M Y
CHK. A. B.	02.02.88	INSUL. RANGE 1,4-2,3 DIA		01 04 11
APP. L. v. Soest	03.02.88	SIZE A3	SHEET 1 OF 1	REV. LTR. C2
		DWG. No.	160928	

单击下面可查看定价，库存，交付和生命周期等信息

[>>TE Connectivity\(泰科\)](#)