

THIS DRAWING IS UNPUBLISHED. RELEASED FOR PUBLICATION  
 © COPYRIGHT BY TYCO ELECTRONICS CORPORATION. ALL RIGHTS RESERVED.

ELECTRICAL	MECHANICAL	ENVIRONMENTAL
NOMINAL IMPEDANCE (OHMS) $50 \pm 1$	Force to Engage (Lbs MAX) 15	TEMPERATURE RATING $-65^{\circ}$ TO $+165^{\circ}$ C
Frequency Range (GHz) DC to 40	Disengage (Lbs) 5.0 MIN	Vibration MIL-STD-202, Method 204, Condition D
Volt Rating (VRMS MAX) @ Sea Level 335	Center Contact Retention: N/A	Thermal Shock MIL-STD-202, Method 107, Condition B
VSWR 1.35 MAX @ 26.5 GHz	Cable Retention: Axial: 30 Lbs. Min. Rotational: 16 In. Oz.	Corrosion - MIL-STD-202, Method 101, Condition B
Insertion Loss $.012\sqrt{F}$ GHz (dB min)	Interface per MIL-STD-348A, Figure 326-1a	
Corona, 70,000 Ft (VRMS MIN) 190	DSCC Reference Part Number: 94008ZCG-1	
Dielectric Withstanding Voltage (VRMS MIN) @ Sea Level 500		
Contact Resistance (Milliohms MAX)		
Center Contact 6.0		
Outer Contact 2.0		
Cable to Housing 0.5		
RF High Potential @ Sea Level (VRMS MIN @ 5 MHz) 325		
I.R.(Megohms MIN) 5,000		

DESIGNED FOR USE WITH  $\phi$ .085 [2.16] SEMI-RIGID CABLE  
 CABLE ENTRY DIAMETER MINIMUM

HOUSING	.089 [2.26]
CONTACT	.021 [0.53]

LOC	DIST	REVISIONS			
P	LTR	DESCRIPTION	DATE	DWN	APVD
DF	X0	REV PER ECO-07-002315	19FEB07	PY	BM

COMPONENT	MATERIAL	FINISH
HOUSING CENTER CONTACT ANTI-ROCK RING	BERYLLIUM COPPER PER ASTM B 196, ALLOY C17300, CONDITION H	GOLD PLATE PER ASTM-B-488
DIELECTRIC	TFE FLUOROCARBON PER ASTM-D-1457	N/A

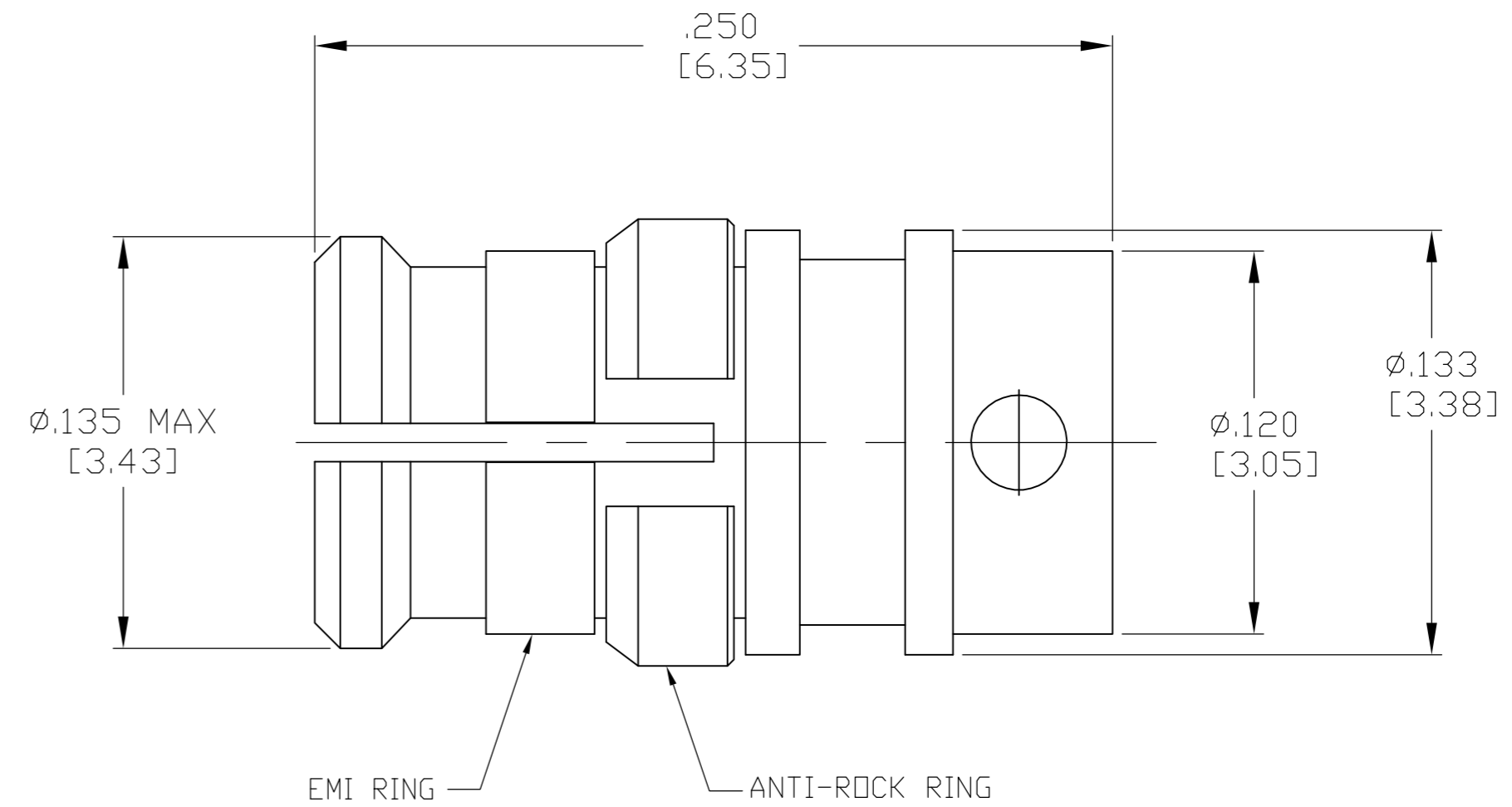

1056522-1  
 PART NUMBER

THIS DRAWING IS A CONTROLLED DOCUMENT.		DWN C.C.THOMAS 19-APR-05	<b>tyco</b> Tyco Electronics Corporation	
DIMENSIONS: INCHES		CHK R.GROSS 20-APR-05	Harrisburg, Pa 17105-3608	
TOLERANCES UNLESS OTHERWISE SPECIFIED:		APVD R.GROSS 20-APR-05	NAME OSMP STRAIGHT CABLE JACK DIRECT SOLDER ATTACHMENT	
0 PLC ± -		PRODUCT SPEC	SIZE A2	CAGE CODE 00779
1 PLC ± -		APPLICATION SPEC	DRAWING NO C=1056522	RESTRICTED TO -
2 PLC ± -		408-10114	SCALE 20:1	SHEET 1 OF 1
3 PLC ± .005 [0.13]		WEIGHT -	REV E	
4 PLC ± -		CUSTOMER DRAWING		
ANGLES ± -				
FINISH SEE TABLE				

单击下面可查看定价，库存，交付和生命周期等信息

[>>TE Connectivity\(泰科\)](#)