

REVISONS		DATE	BY	APPV
CM	0	22MAY2020	PC	SW

- 1 MATERIAL: CONNECTOR- NYLON UL94V-2 (RED).
CONTACTS- 0.30 [.012] THK COPPER ALLOY
(BRIGHT TIN-LEAD 0.00203 [.000080] MIN THK).
(MATTE TIN 0.00203 [.000080] MIN THK).
- 2 CONTACTS ACCEPT #22 AWG SOLID, FUSED STRANDED OR STRANDED (7 STRANDS) WIRE WITH 2.41 [.095] MAX INSULATION DIA.
- 3 BOW, IN ANY DIRECTION, NOT TO EXCEED 0.15 [.006] PER IN.
- 4 HOUSING FEATURES: FEED-THRU.
- 5 DIMENSIONS IN BRACKETS ARE IN INCHES.
- 6 OBSOLETE PARTS: OBSOLETE CIS STREAMLINING PER D.RENAUD/D.SINISI
- 7 OBSOLETE PARTS

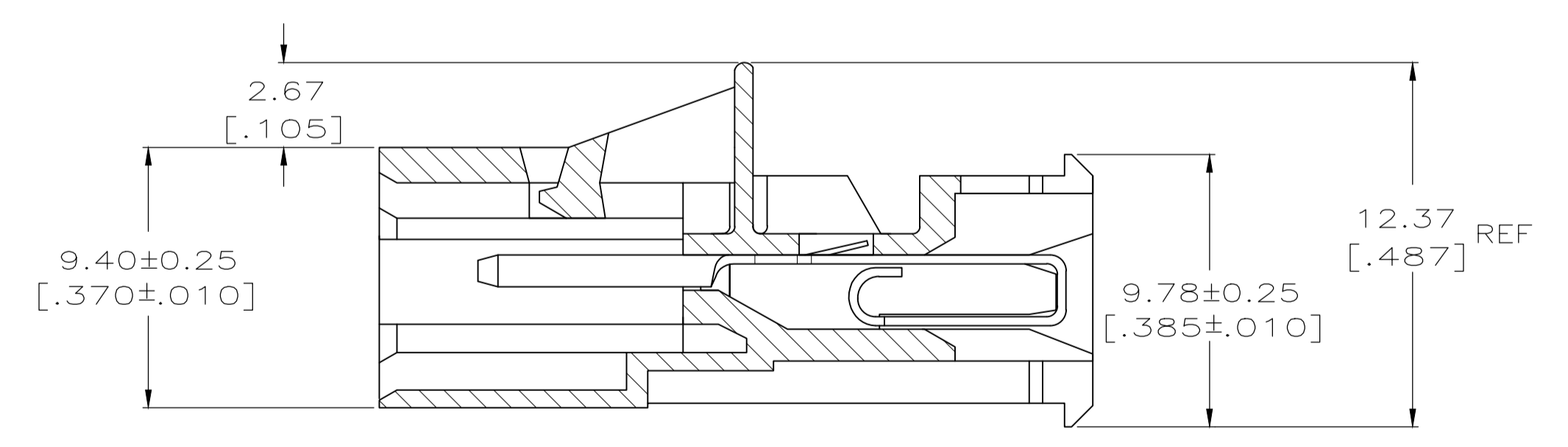
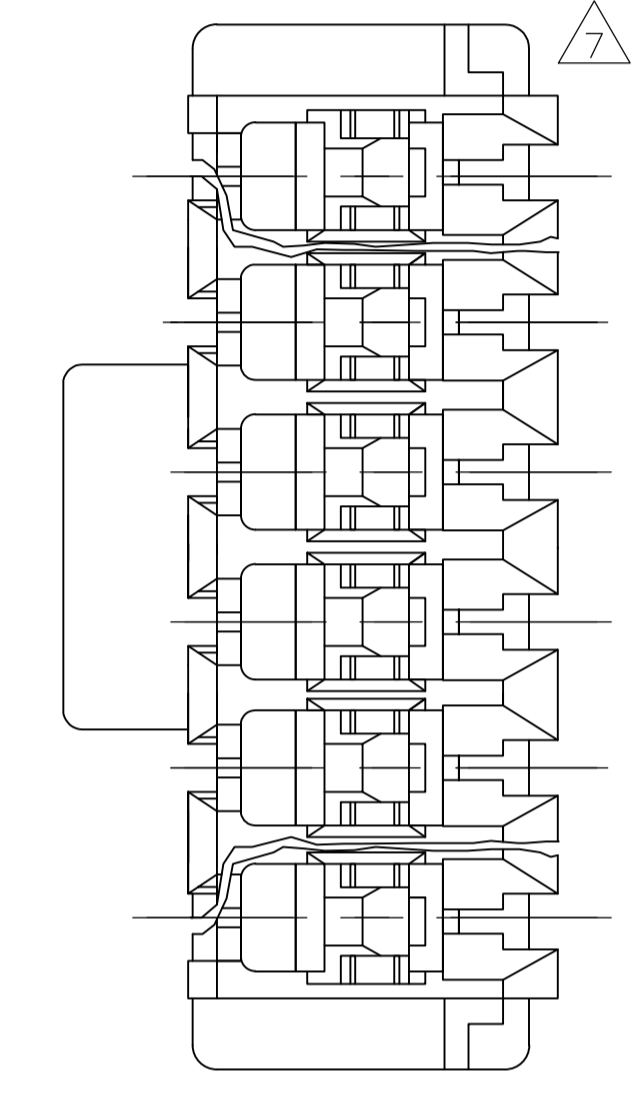
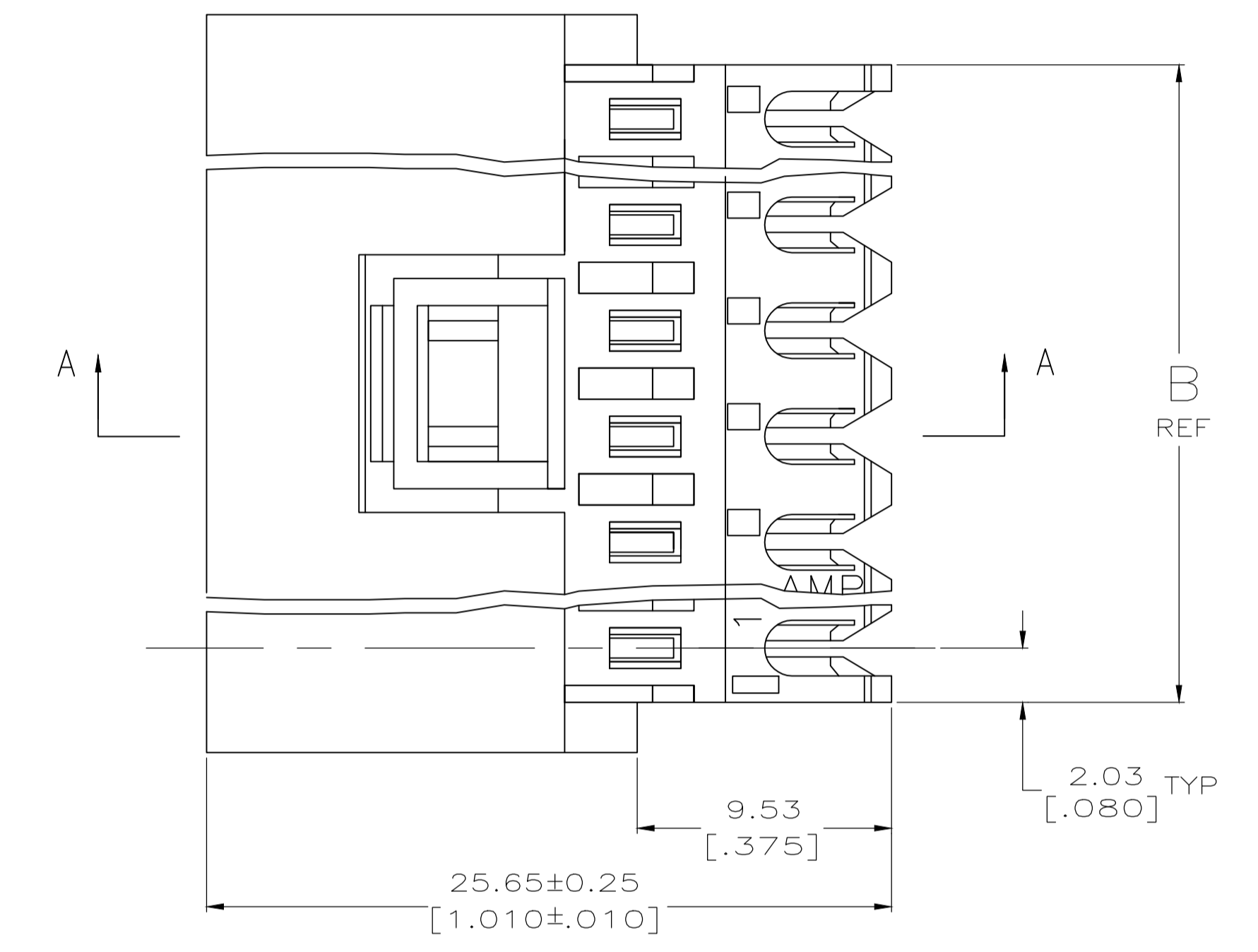
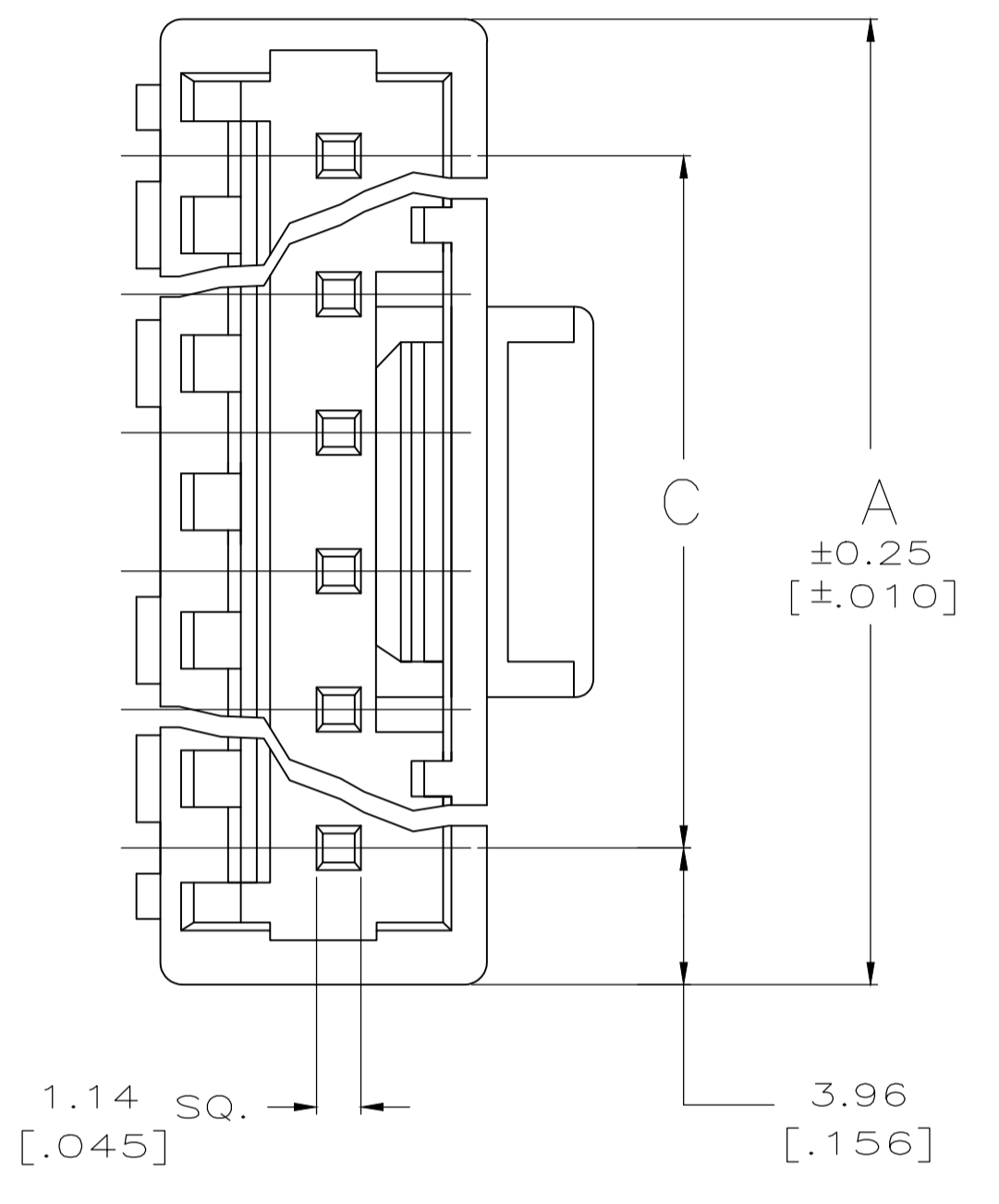

SECTION A-A

FINISH	C	B	A	NO. OF CIRCUITS	PART NO.
TIN	91.14 [3.588]	95.20 [3.748]	99.06 [3.900]	24	5-641524-4
	55.47 [2.184]	59.54 [2.344]	63.40 [2.496]	15	4-641524-5
	43.59 [1.716]	47.65 [1.876]	51.51 [2.028]	12	4-641524-2
	31.70 [1.248]	35.76 [1.408]	39.62 [1.560]	9	3-641524-9
	19.81 [.780]	23.88 [.940]	27.74 [1.092]	6	3-641524-6
	11.89 [.468]	15.95 [.628]	19.81 [.780]	4	3-641524-4
	7.92 [.312]	11.99 [.472]	15.85 [.624]	3	3-641524-3
	3.96 [.156]	8.03 [.316]	11.89 [.468]	2	3-641524-2
△SUPERSEDED	91.14 [3.588]	95.20 [3.748]	99.06 [3.900]	24	2-641524-4
△SUPERSEDED	55.47 [2.184]	59.54 [2.344]	63.40 [2.496]	15	1-641524-5
△SUPERSEDED	43.59 [1.716]	47.65 [1.876]	51.51 [2.028]	12	1-641524-2
△SUPERSEDED	31.70 [1.248]	35.76 [1.408]	39.62 [1.560]	9	641524-9
△SUPERSEDED	19.81 [.780]	23.88 [.940]	27.74 [1.092]	6	641524-6
△SUPERSEDED	11.89 [.468]	15.95 [.628]	19.81 [.780]	4	641524-4
△SUPERSEDED	7.92 [.312]	11.99 [.472]	15.85 [.624]	3	641524-3
△SUPERSEDED	3.96 [.156]	8.03 [.316]	11.89 [.468]	2	641524-2

THIS DRAWING IS A CONTROLLED DOCUMENT.

DIMENSIONS: mm [INCHES]

TOLERANCES UNLESS OTHERWISE SPECIFIED:

0 PLC	± -
1 PLC	± -
2 PLC	± 0.13 [.005]
3 PLC	± -
4 PLC	± -
ANGLES	± -

MATERIAL: SEE NOTE 1

FINISH: SEE NOTE 1

WEIGHT: A1

00779

641524

SCALE: 5:1

SHEET: 1 OF 1

REV: H

STE TE Connectivity

MTA-156 POSTED CONNECTOR ASSEMBLY, 22 AWG

单击下面可查看定价，库存，交付和生命周期等信息

[>>TE Connectivity\(泰科\)](#)