

## SURFACE MOUNT SCHOTTKY BARRIER RECTIFIER

### PINNING

PIN	DESCRIPTION
1	Cathode
2	Anode

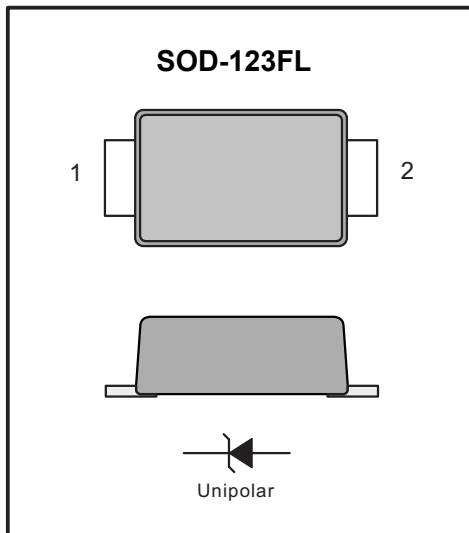

### Features

- ◆ The plastic package carries Underwriters Laboratory Flammability Classification 94V-0
- ◆ For surface mounted applications
- ◆ Metal silicon junction, majority carrier conduction
- ◆ Low power loss, high efficiency
- ◆ Built-in strain relief, ideal for automated placement
- ◆ High forward surge current capability
- ◆ High temperature soldering guaranteed: 250 °C/10 seconds at terminals

### Mechanical Data

- ◆ Case: JEDEC SOD-123FL molded plastic body
- ◆ Terminals: Solderable per MIL-STD-750, Method 2026 Polarity: Color band denotes cathode end
- ◆ Mounting Position: Any
- ◆ Weight: 0.0007 ounce, 0.02 grams

## Maximum Ratings And Electrical Characteristics

Ratings at 25°C ambient temperature unless otherwise specified.

Single phase half-wave 60Hz, resistive or inductive load, for capacitive load current derate by 20%.

Parameter	SYMBOLS	DSK32	DSK34	DSK35	DSK36	DSK38	DSK310	DSK315	DSK320	UNITS	
		K32	K34	K35	K36	K38	K310	K315	K320		
Maximum repetitive peak reverse voltage	$V_{RRM}$	20	40	50	60	80	100	150	200	V	
Maximum RMS voltage	$V_{RMS}$	14	28	35	42	56	70	105	140	V	
Maximum DC blocking voltage	$V_{DC}$	20	40	50	60	80	100	150	200	V	
Maximum average forward rectified current at TL (see fig. 1)	$I_{(AV)}$	3.0								A	
Peak forward surge current 8.3ms single half sine-wave superimposed on rated load (JEDEC Method)	$I_{FSM}$	80								A	
Maximum instantaneous forward voltage at 3.0A	$V_F$	0.52	0.70	0.70			0.85			V	
Maximum DC reverse current $T_A=25^\circ\text{C}$ at rated DC blocking voltage $T_A=125^\circ\text{C}$	$I_R$	20.0				10.0				mA	
Typical junction capacitance (NOTE 1)	$C_J$	250			160						pF
Typical thermal resistance (NOTE 2)	$R_{\theta JA}$	80.0								°C/W	
Operating junction temperature range	$T_J$	-55 to +125								°C	
Storage temperature range	$T_{STG}$	-55 to +150								°C	

Note: 1. Measured at 1MHz and applied reverse voltage of 4.0V D.C.

## Typical Characteristics

Fig.1 Forward Current Derating Curve

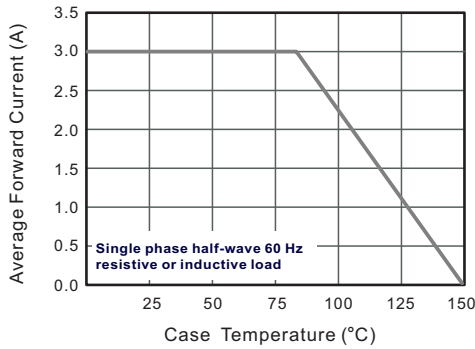

Fig.2 Typical Reverse Characteristics

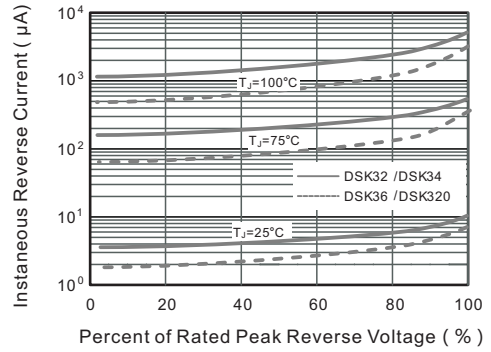

Fig.3 Typical Forward Characteristic

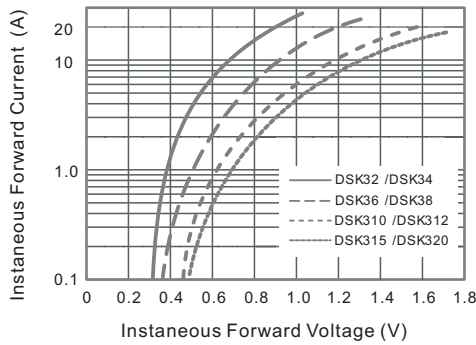

Fig.4 Typical Junction Capacitance

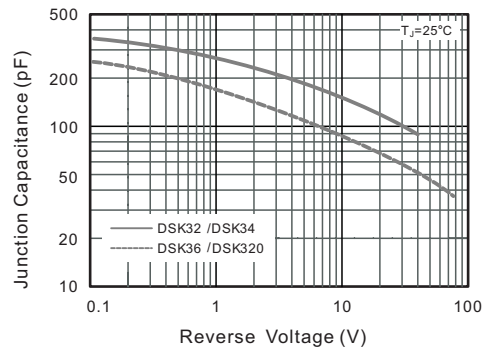

Fig.5 Maximum Non-Repetitive Peak Forward Surge Current

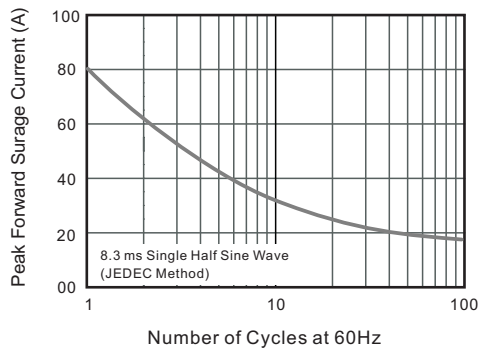
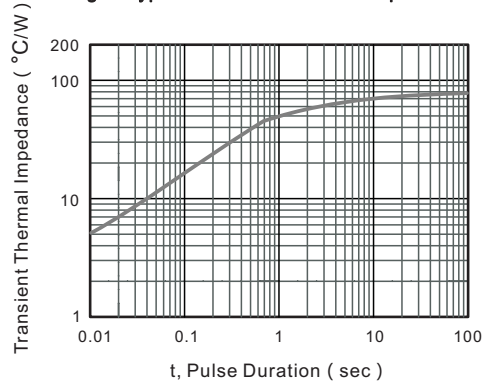

Fig.6- Typical Transient Thermal Impedance



## PACKAGE OUTLINE

Plastic surface mounted package; 2 leads

SOD-123FL

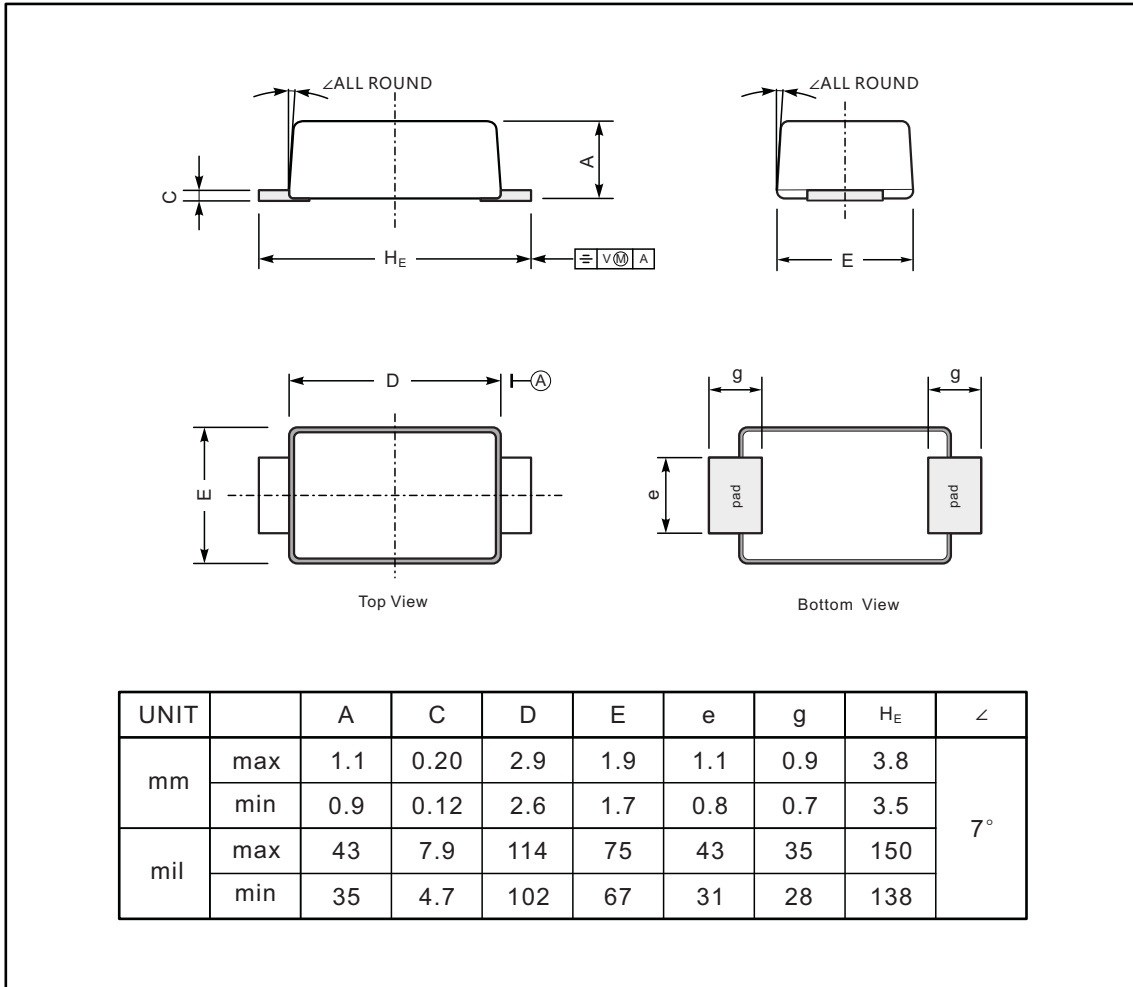

### The recommended mounting pad size

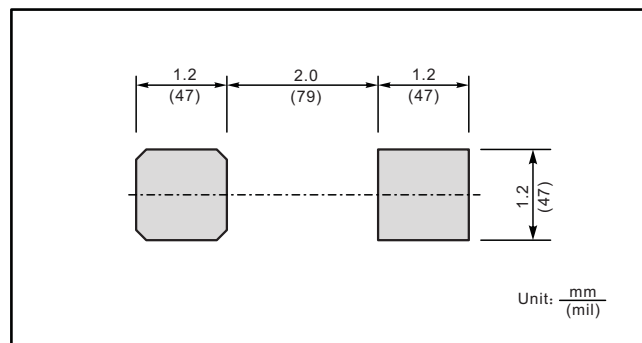

单击下面可查看定价，库存，交付和生命周期等信息

[>>TWGMC\(台湾迪嘉\)](#)