

Main technical performance

Voltage rating	DC 30V/0.5A
Contact resistance	≤0.03Ω
Insulation resistance	≥100MΩ
Withstanding voltage	AC500V(50Hz)/min
Insertion force	3-20N
Temperature range	-30-70℃
Life	5000次

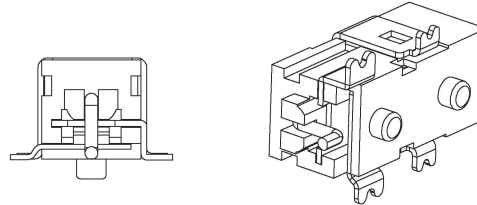

SCHEMATIC	
Model	DC-011C-SMT
Center Pin	Ø0.65 mm

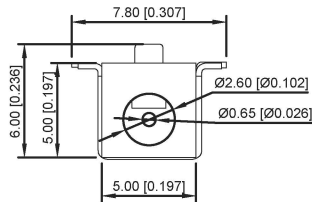
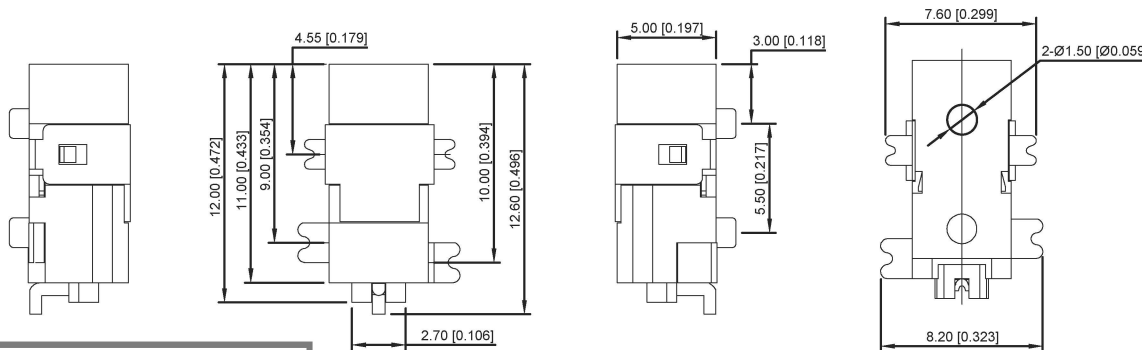

	MATERIAL	PLATING
center pin	Brass	tin
terminal 1	Brass	ni
terminal 2	Brass	tin
terminal 3	Brass	ag
terminal 4	Phosphor Bronze	ag
plastic	PPA	

广东星坤科技股份有限公司

生	日期
發	日期
ΔX	
MARK	
文件	工程章

REVISIONS	DATE	REVISED	APPROVED	UNSPECIFIED TOLERANCES
ANGULAR				±5°
L ≤ 4				±0.2
4 < L ≤ 16				±0.3
16 < L ≤ 63				±0.4
L > 63				±0.5

DSND	DATE	SCALE: N/A
DWN	DATE	VIEW:
CHKD	DATE	UNIT: mm/in
APPD	DATE	SIZE: A4

MODEL TYPE:	DC POWER JACK
PART NO.:	
DWG NO.:	DC-011C-SMT

KKB INDUSTRIAL PRECISION CO., LIMITED	WEIGHT	SHEET	REVISION
	1.0g	1/1	A0

单击下面可查看定价，库存，交付和生命周期等信息

[>>XKB Connectivity\(中国星坤\)](#)