

SCHEMATIC	
Model	DC-036A-2.5A
Center Pin	Ø2.0 mm
	Ø2.5 mm

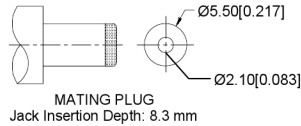
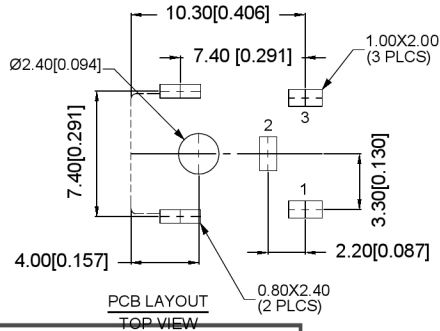

	MATERIAL	PLATING
axis support	Brass	tin
center pin	Brass	tin
plastic	Pbt	
terminal 1	Brass	tin
terminal 2	Phosphor Bronze	tin
terminal 3	Brass	tin

广东星坤科技股份有限公司

生	日期				
效					
Δ*					
MARK	DESCRIPTION	REVISIONS	DATE	REVISED	APPROVED
文件工程章					

www.xk-gg.com www.hellokcb.com www.hellokcb.cn

DSND		DATE		SCALE: N/A	MODEL TYPE: DC POWER JACK
DWN		DATE		VIEW:	PART NO.:
CHKD		DATE		UNIT: mm/in	DWG NO.: DC-036A-2.5A-2.0
APPD		DATE		SIZE: A4	WEIGHT SHEET REVISION 1.0g 1/1 A0
UNSPECIFIED TOLERANCES					YVP INDUSTRIAL PRECISION CO., LIMITED

单击下面可查看定价，库存，交付和生命周期等信息

[>>XKB Connectivity\(中国星坤\)](#)