

XKB

Specifications:

规格: XKB  
 Voltage rating:250V AC/DC  
 额定电压: 250V AC/DC  
 Current rating:2A AC/DC  
 额定电流: 2A AC/DC  
 Withstanding voltage:1000V AC/minute  
 耐受电压: 1000V AC/分钟  
 Temperature range:-25℃+85℃  
 温度范围: -25℃+85℃  
 Insulation resistance:≥500MΩ  
 绝缘电阻: ≥500MΩ  
 Contact resistance:≤20mΩ  
 接触电阻: ≤20mΩ XKB  
 After environmental testing:≤30兆欧  
 环境测试后: ≤30兆欧

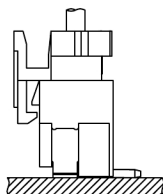
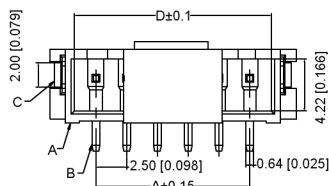
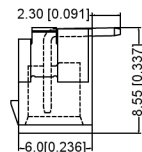
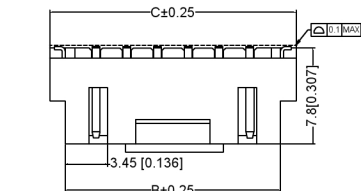

Assembly Layout

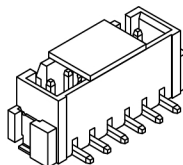
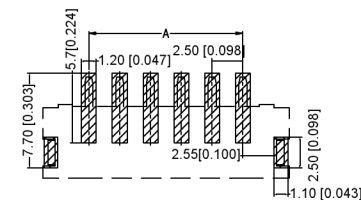

X8821 WV S-XX L-LP SN

- Series No.
- Category:W-WAFER
- Welding Board Angle: V-180°
- Welding Way:S-SMT
- Row No.Pin No.: XX-02P-16P;
- Plug the Pin&Special No:L-With Lock
- Material:LP-LCP UL 94V-0
- Plating Category: SN-Bright Tin Plating

Poles	Dimension mm				Poles	Dimension mm			
	A	B	C	D		A	B	C	D
2	2.50	7.50	10.00	6.00	10	22.50	27.50	30.00	26.00
3	5.00	10.00	12.50	8.50	11	25.00	30.00	32.50	28.50
4	7.50	12.50	15.00	11.00	12	27.50	32.50	35.00	31.00
5	10.00	15.00	17.50	13.50	13	30.00	35.50	37.50	33.50
6	12.50	17.50	20.00	16.00	14	32.50	37.50	40.00	36.00
7	15.00	20.00	22.50	18.50	15	35.00	40.00	42.50	38.50
8	17.50	22.50	25.00	21.00	16	37.50	42.50	45.00	41.00
9	20.00	25.00	27.50	23.50					

X8821WV-XXL-N0SN	LCP UL 94V-0	Phosphor Bronze	Tin-Plated	X8821H-L
PART NO	Material	Material(Pin And Solder Tabs)	Finish(Pin And Solder Tabs)	Mates With Xi(B Housing

XKB	DSND	DATE	SCALE: NA	MODEL TYPE: X8821WV-S-XXL-LPSN
ANGLAR ±5°	DWN	DATE	VIEW:	PART NO.:
L ≤ 4 ±0.2	CHKD	DATE	UNIT: mm/in	2.54 mm Crimp Style Connectors
4 < L ≤ 16 ±0.3	APPD	DATE	SIZE: A4	DWG NO.:
16 < L ≤ 63 ±0.4				
L > 63 ±0.5				
UNSPECIFIED TOLERANCES	INDUSTRIAL PRECISION CO., LIMITED			WEIGHT 1.0g
				SHEET 1/1
				REVISION A0

广东星坤科技股份有限公司

生 日期

文件工程章

REVISIONS  
www.heloxkb.com

单击下面可查看定价，库存，交付和生命周期等信息

[>>XKB Connectivity\(中国星坤\)](#)