

Recommended P.C.B Hole Layout  
Tolerance:±0.05  
XXB Connectivity

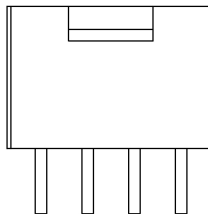
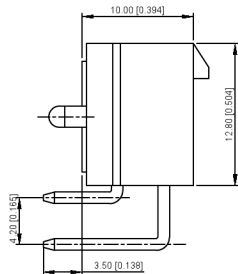
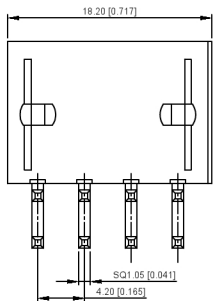

XXB Connectivity

Specifications:

- 规格:
- Voltage rating:600V AC/DC
- 额定电压: 600V AC/DC
- Current rating:9A AC/DC
- 额定电流: 9A AC/DC
- Withstanding voltage:1500V AC/minute
- 耐受电压: 1500V AC/分钟
- Temperature range:-25°C+85°C
- 温度范围: -25°C+85°C
- Insulation resistance:≥1000MΩ
- 绝缘电阻: ≥1000MΩ
- Contact resistance:≤10mΩ
- 接触电阻: ≤10mΩ
- After environmental testing:≤20mΩ
- 环境测试后: ≤20兆欧

X9357WR-2\*04EH-XXSX-XX

- 01 Series No
- 02 Category:W-wafer
- 03 Welding Board Angle:V-Straight 180°R-90°
- 04 Welding Way: Blank-DIP S-SMT W-Male and female conjoined
- 05 Row No.-Pin No
- 06 Plug the Pin&Special NO. EH-Positioning post with hole
- 07 Material:N2-PA66 94V-2 94V-2 94V-0
- 08 Plating Category:SW-Fog Tin plating SN-Enright tin plating
- 09 Color:Blank-Natural Color

XXB Connectivity

X9357WR-2*04EH-LPSN	LCP UL 94V-2	Brass	Tin-Plated	X9357H
X9357WR-2*04EH-N2SW	Nylon 66 UL 94V-2		Tin Plating Fog	
PART NO	Material	Material(Pin)	Finish(Pin)	Suitable X(B Terminal

广东星坤科技股份有限公司

生 日期

文件工程章

REVISIONS  
DATE REVISED APPROVED

UNSPECIFIED TOLERANCES

ANGULAR	±5°
L ≤ 4	±0.2
4 < L ≤ 16	±0.3
16 < L ≤ 63	±0.4
L > 63	±0.5

DSND	DATE	SCALE: N/A	MODEL TYPE: X9357WR-2*XXEH-N2SW
DWNN	DATE	VIEW: ①	PART NO.: 4.20mm Crimp Style Connector
CHKD	DATE	UNIT: mm/in	DWG NO.:
APPD	DATE	SIZE: A4	
VXP INDUSTRIAL PRECISION CO., LIMITED			WEIGHT 1.0g
			SHEET 1/1
			REVISION A0

单击下面可查看定价，库存，交付和生命周期等信息

[>>XKB Connectivity\(中国星坤\)](#)