

Specification.
 *Electrical Characteristics:
 Current Rating:1.5A.
 Withstanding Voltage:AC500V r.m.s.
 Insulation Resistance:1000Megohms
 Minimum at DC 500V
 Contact Resistance:100Miliohms Maximum.
 *Mechanical Characteristics:
 Mating Cyeles:5000 Insertions

PART NUMBER INFORMATION

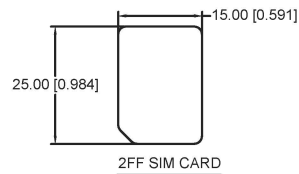

Connector terminal NO.	Pin NO.
Pin 1	VCC:PWR signal and GND
Pin 2	RST:Reset signal
Pin 3	CLK:Clocking signal
Pin 4	RESERVED
Pin 5	GND:PWR signal and GND
Pin 6	VCC:Porgramming Voltage
Pin 7	I/O:Serial date input/output
Pin 8	RESERVED

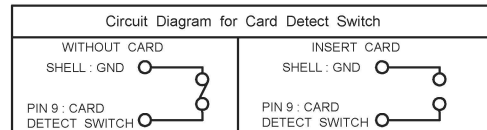
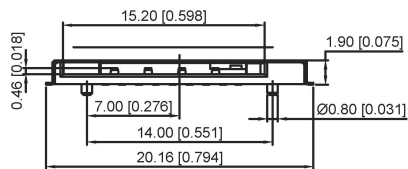

ITEM	PAPT NAMF	QTY	MATERIAL	FINISHING
③	Shell	1	SUS	
②	Terminal	9	COPPER ALLOY	
①	Housing	1	LCP UL 94V-0	BLACK

广东星坤科技股份有限公司

生效日期

MARK	DESCRIPTION	DATE	REVISED	APPROVED	REVISIONS
	文件工程章				

DSND	DATE	SCALE: N/A	MODEL TYPE:
DWN	DATE	VIEW:	SIM CARD CONN
CHKD	DATE	UNIT: mm/in	PART NO.:
APPD	DATE	SIZE: A4	DWG NO.:
			XKSIM-220
XKB INDUSTRIAL PRECISION CO.,LIMITED			WEIGHT SHEET REVISION
			1.0g 1/1 A0

单击下面可查看定价，库存，交付和生命周期等信息

[>>XKB Connectivity\(中国星坤\)](#)