

■ Switching Diodes

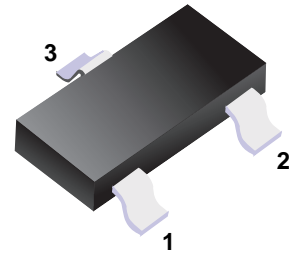

■ Simplified outline(SOT-23)

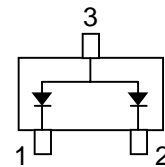

■ Features

- Fast Switching Speed
- Surface Mount Package Ideally Suited for Automatic Insertion
- For General Purpose Switching Applications
- High Conductance

■ Absolute Maximum Ratings Ta = 25°C

Parameter	Symbol	Rating	Unit
Non-Repetitive Peak Reverse Voltage	V <sub>RM</sub>	100	V
Peak Repetitive Reverse Voltage	V <sub>R(RM)</sub>		
Working Peak Reverse Voltage	V <sub>R(WM)</sub>	75	V
DC Blocking Voltage	V <sub>R</sub>		
RMS Reverse Voltage	V <sub>R(RMS)</sub>	53	V
Forward Continuous Current	I <sub>FM</sub>	300	mA
Non-Repetitive Peak Forward Surge Current @ t = 1.0 μs	I <sub>FSM</sub>	2.0	A
@ t = 1.0s		1.0	
Power Dissipation	P <sub>d</sub>	350	mW
Thermal Resistance Junction to Ambient Air	R <sub>θJA</sub>	357	°C/W
Operating and Storage Temperature Range	T, T <sub>STG</sub>	-65 to +150	°C

■ Electrical Characteristics Ta = 25°C

Parameter	Symbol	Testconditons	Min	Typ	Max	Unit
Forward Voltage	V <sub>F</sub>	I <sub>F</sub> = 1.0mA			0.715	V
		I <sub>F</sub> = 10mA			0.855	
		I <sub>F</sub> = 50mA			1.0	
		I <sub>F</sub> = 150mA			1.25	
Peak Reverse Current	I <sub>RM</sub>	V <sub>R</sub> = 75V			2.5	μA
		V <sub>R</sub> = 75V, T <sub>j</sub> = 150°C			50	μA
		V <sub>R</sub> = 25V, T <sub>j</sub> = 150°C			30	μA
		V <sub>R</sub> = 20V			25	nA
Junction Capacitance	C <sub>j</sub>	V <sub>R</sub> = 0, f = 1.0MHz			2	pF
Reverse Recovery Time	t <sub>rr</sub>	I <sub>F</sub> = I <sub>R</sub> = 10mA, I <sub>rr</sub> = 0.1 X I <sub>R</sub> , R <sub>L</sub> = 100 Ω			4	ns

■ Marking

Marking	A1
---------	----

**Package Outline**

**SOT-23**

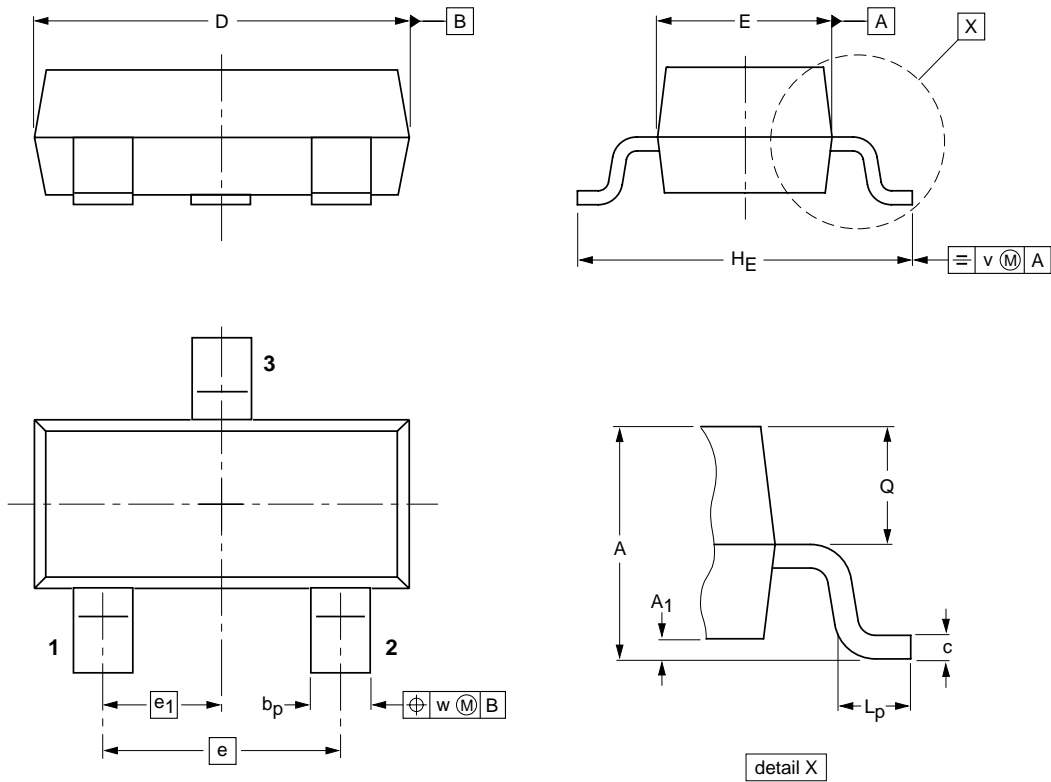

**DIMENSIONS (mm are the original dimensions)**

UNIT	A	A <sub>1</sub> max.	b <sub>p</sub>	c	D	E	e	e <sub>1</sub>	H <sub>E</sub>	L <sub>p</sub>	Q	v	w
mm	1.1 0.9	0.1	0.48 0.38	0.15 0.09	3.0 2.8	1.4 1.2	1.9	0.95	2.5 2.1	0.45 0.15	0.55 0.45	0.2	0.1

**Summary of Packing Options**

Package	Packing Description	Packing Quantity	Industry Standard
SOT-23	Tape/Reel, 7" reel	3000	EIA-481-1

单击下面可查看定价，库存，交付和生命周期等信息

[>>YFW\(佑风微\)](#)