

■ Schottky Diodes

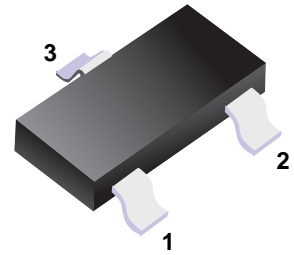

■ Simplified outline(SOT-23)

■ Features

- Low forward voltage
- Guard ring protected
- Small plastic SMD package.

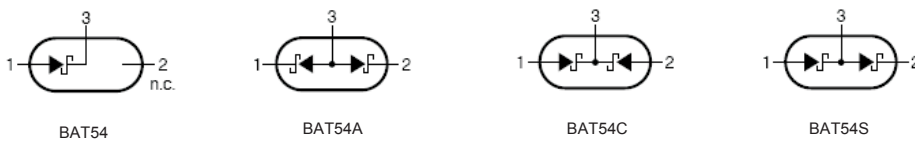

■ Absolute Maximum Ratings $T_a = 25^\circ\text{C}$

| Parameter | Symbol | Rating | Unit |
|---|-----------------|-------------|---------------------------|
| Maximum Repetitive Reverse Voltage | V_{RRM} | 30 | V |
| Average Rectified Forward Current | $I_{F(AV)}$ | 200 | mA |
| Non-repetitive Peak Forward Surge Current Pulse width = 1.0 second | I_{FSM} | 600 | mA |
| Power Dissipation | P_D | 200 | mW |
| Thermal Resistance, Junction to Ambient | $R_{\theta JA}$ | 430 | $^\circ\text{C}/\text{W}$ |
| Storage Temperature Range | T_{stg} | -55 to +150 | $^\circ\text{C}$ |
| Operating Junction Temperature | T_J | 150 | $^\circ\text{C}$ |

■ Electrical Characteristics $T_a = 25^\circ\text{C}$

| Parameter | Symbol | Testconditions | Min | Typ | Max | Unit |
|-----------------------|----------|---|-----|-----|-----|---------------|
| Breakdown Voltage | V_R | $I_R = 100 \mu\text{A}$ | 30 | | | V |
| Forward Voltage | V_F | $I_F = 0.1 \text{ mA}$ | | | 240 | mV |
| | | $I_F = 1 \text{ mA}$ | | | 320 | mV |
| | | $I_F = 10 \text{ mA}$ | | | 400 | mV |
| | | $I_F = 30 \text{ mA}$ | | | 500 | mV |
| | | $I_F = 100 \text{ mA}$ | | | 0.8 | V |
| Reverse Current | I_R | $V_R = 25 \text{ V}$ | | | 2 | μA |
| Total Capacitance | C_T | $V_R = 1\text{V}, f = 1.0 \text{ MHz}$ | | | 10 | pF |
| Reverse Recovery Time | t_{rr} | $I_F = I_R = 10 \text{ mA}, I_{RR} = 1.0 \text{ mA}, R_L = 100\Omega$ | | | 5 | ns |

■ Marking

| TYPE | BAT54 | BAT54A | BAT54C | BAT54S |
|---------|-------|------------|------------|------------|
| Marking | L4 | L42 or KL2 | L43 or KL3 | L44 or KL4 |

■ Typical Characteristics

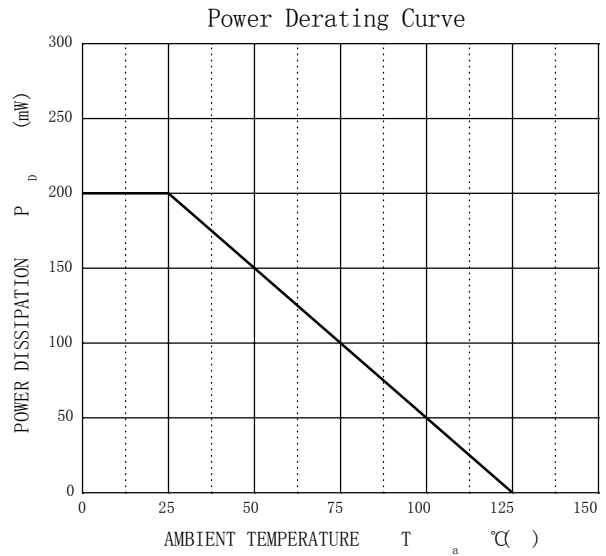
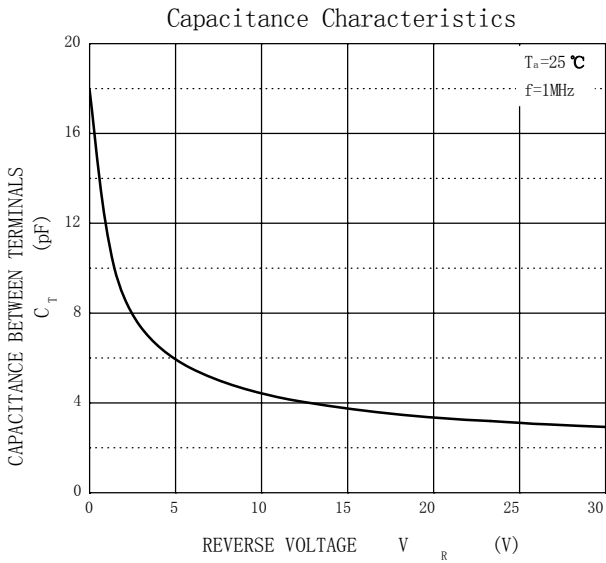
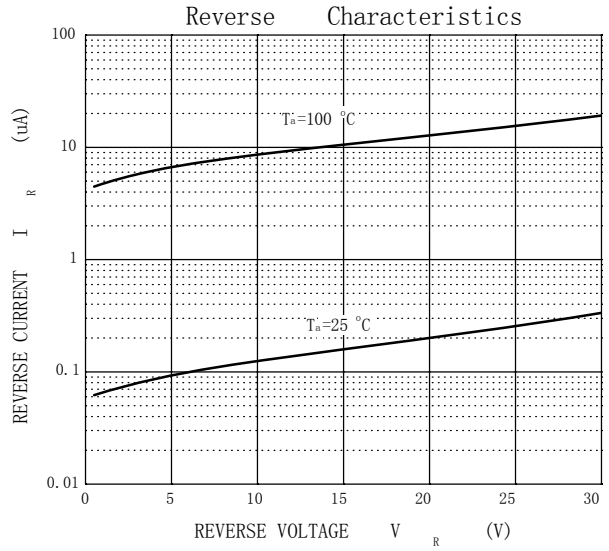
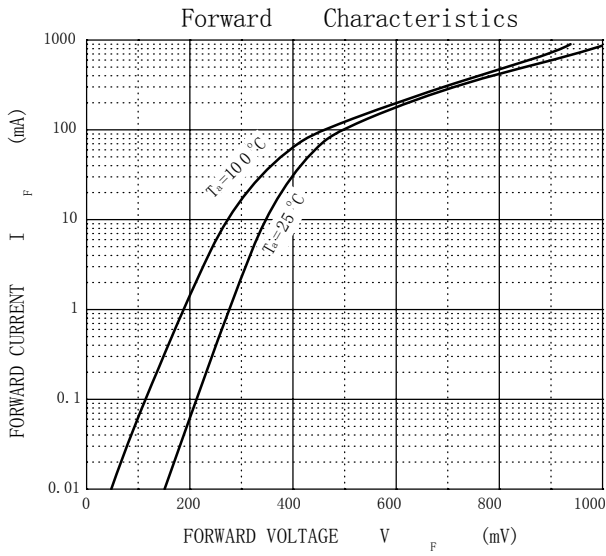

Package Outline

SOT-23

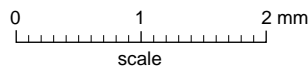
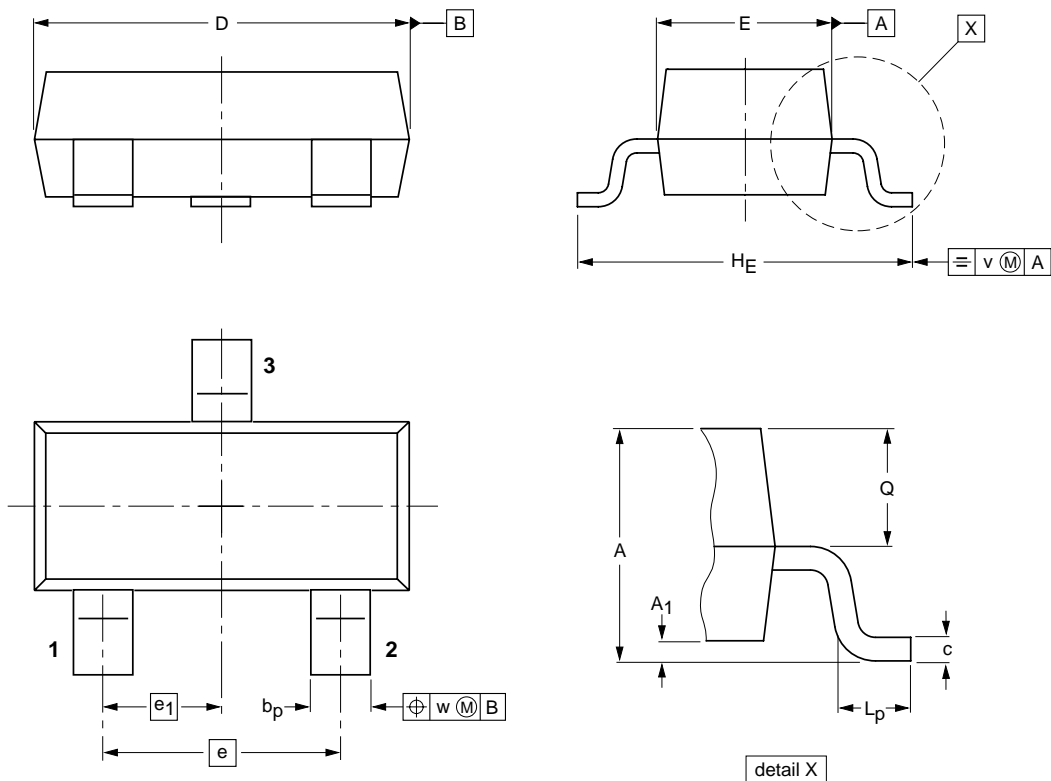

DIMENSIONS (mm are the original dimensions)

| UNIT | A | A ₁ max. | b _p | c | D | E | e | e ₁ | H _E | L _p | Q | v | w |
|------|------------|---------------------|----------------|--------------|------------|------------|-----|----------------|----------------|----------------|--------------|-----|-----|
| mm | 1.1 0.9 | 0.1 | 0.48 0.38 | 0.15 0.09 | 3.0 2.8 | 1.4 1.2 | 1.9 | 0.95 | 2.5 2.1 | 0.45 0.15 | 0.55 0.45 | 0.2 | 0.1 |

Summary of Packing Options

| Package | Packing Description | Packing Quantity | Industry Standard |
|---------|---------------------|------------------|-------------------|
| SOT-23 | Tape/Reel, 7" reel | 3000 | EIA-481-1 |

单击下面可查看定价，库存，交付和生命周期等信息

[>>YFW\(佑风微\)](#)