

**Schottky Diode**

**Features**

- ◆Fast Switching Device
- ◆Low Turn-on Voltage
- ◆PN Junction Guard Ring for Transient and ESD Protection

**Mechanical Data**

- ◆SOD-323 Small Outline Plastic Package
- ◆Polarity: Color band denotes cathode end
- ◆Mounting Position: Any

**MARKING: K73**

**Maximum Ratings & Thermal Characteristics**

(Ratings at 25°C ambient temperature unless otherwise specified.)

Parameters	Symbol	Value	Unit
Reverse Voltage	<b>V<sub>R</sub></b>	70	<b>V</b>
Peak Reverse Voltage	<b>V<sub>RRM</sub></b>	70	<b>V</b>
Power Dissipation	<b>P<sub>D</sub></b>	200	<b>mW</b>
Operating junction temperature	<b>T<sub>J</sub></b>	-55-+125	<b>°C</b>
Storage temperature range	<b>T<sub>STG</sub></b>	-65-+150	<b>°C</b>
Thermal Resistance from Junction to Ambient	<b>R<sub>θJA</sub></b>	625	<b>K/W</b>
Continuous Forward Current	<b>I<sub>F</sub></b>	70	<b>mA</b>
Non-repetitive Peak Forward Surge Current @tp=1us; TA=25°C	<b>I<sub>FSM</sub></b>	100	<b>mA</b>

**Pinning**

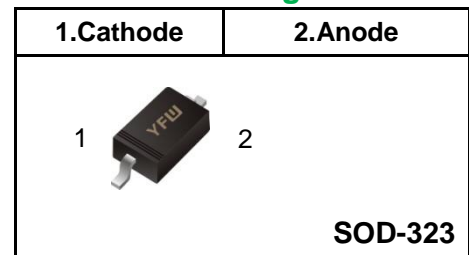

**Electrical Characteristics**

(Ratings at 25°C ambient temperature unless otherwise specified.)

Parameter	Test Condition	Symbols	Limits			Unit
			Min	Typ	Max	
Reverse Voltage(note 2)	I <sub>R</sub> =10uA	<b>V(BR)</b>	70	-	--	<b>V</b>
Reverse Leakage Current	V <sub>R</sub> =50V; tp<300us	<b>I<sub>R</sub></b>	-	-	30	<b>nA</b>
Forward Voltage	I <sub>F</sub> =1.0mA; tp<300us	<b>V<sub>F</sub></b>	-	-	0.41	<b>V</b>
	I <sub>F</sub> =15mA; tp<300us		-	-	1.00	
Reverse Recovery Time	I <sub>F</sub> =I <sub>R</sub> =10mA to I <sub>R</sub> =10mA RL=100Ω	<b>T<sub>RR</sub></b>	-	-	5	<b>uS</b>
Capacitance	V <sub>R</sub> =0V, f=1MHZ	<b>C<sub>T</sub></b>	-	-	2	<b>pF</b>

Notes:

1. Valid provided that electrodes are kept at ambient temperature
2. Test period<3000us

Typical Characteristics

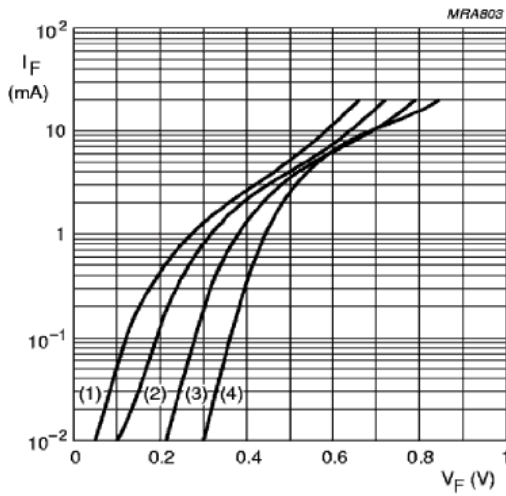

- (1)  $T_{amb} = 125\text{ }^{\circ}\text{C}$ .
- (2)  $T_{amb} = 85\text{ }^{\circ}\text{C}$ .
- (3)  $T_{amb} = 25\text{ }^{\circ}\text{C}$ .
- (4)  $T_{amb} = -40\text{ }^{\circ}\text{C}$ .

Forward current as a function of forward voltage; typical values.

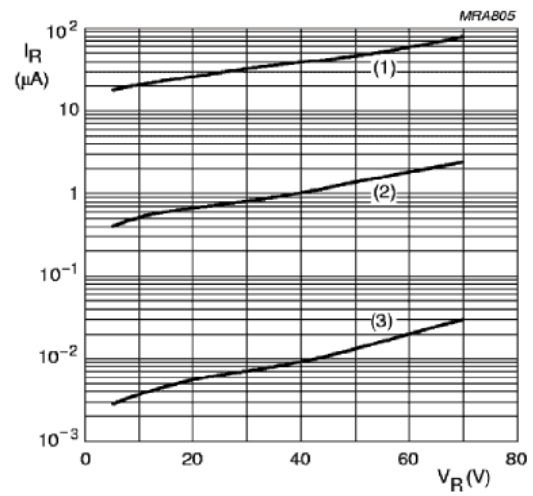

- (1)  $T_{amb} = 125\text{ }^{\circ}\text{C}$ .
- (2)  $T_{amb} = 85\text{ }^{\circ}\text{C}$ .
- (3)  $T_{amb} = 25\text{ }^{\circ}\text{C}$ .

Reverse current as a function of reverse voltage; typical values.

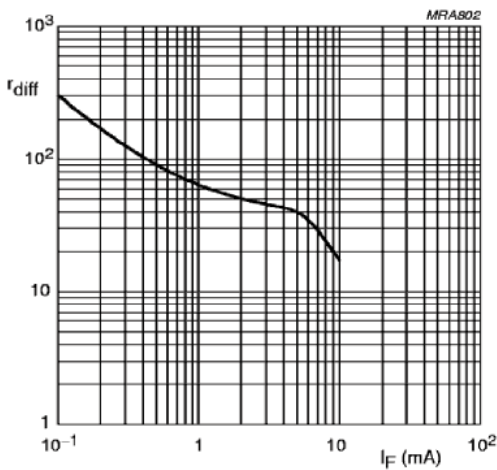

$f = 10\text{ kHz}$ .

Differential forward resistance as a function of forward current; typical values.

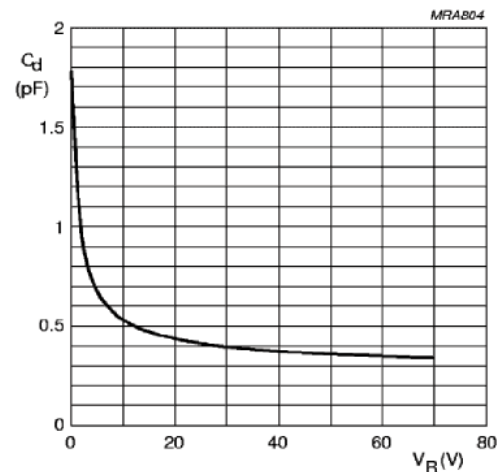

$f = 1\text{ MHz}$ ;  $T_{amb} = 25\text{ }^{\circ}\text{C}$ .

Diode capacitance as a function of reverse voltage; typical values.

Package Outline

SOD-323

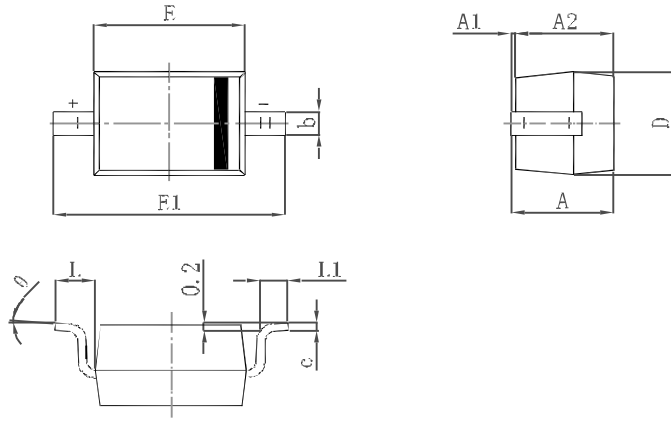

Symbol	Min.(mm)	Max.(mm)
A		1.000
A1	0.000	0.100
A2	0.800	0.900
b	0.250	0.350
c	0.080	0.150
D	1.200	1.400
E	1.600	1.800
E1	2.500	2.700
L	0.475REF	
L1	0.250	0.400
θ	0°	8°

Summary of Packing Options

Package	Packing Description	Packing Quantity	Industry Standard
SOD-323	Tape/Reel,7" reel	3000	EIA-481-1

单击下面可查看定价，库存，交付和生命周期等信息

[>>YFW\(佑风微\)](#)