



MUR1020F THRU MUR1060F

SUPER FAST RECTIFIERS

Reverse Voltage - 200 to 600 Volts Forward Current - 10.0 Amperes

FEATURES

- Low cost.
- Low leakage.
- Low forward voltage drop.
- High current capability.
- Easily cleaned with Alcohol, Isopropanol and Similar solvents.
- The plastic material carries U/L recognition 94V-0

MECHANICAL DATA

- Case: TO-220F-2L
- Molding Compound: UL Flammability Classification Rating 94V-0
- Terminals: Matte tin-plated leads; solderability-per MIL-STD-202, Method 208

TO-220F-2L

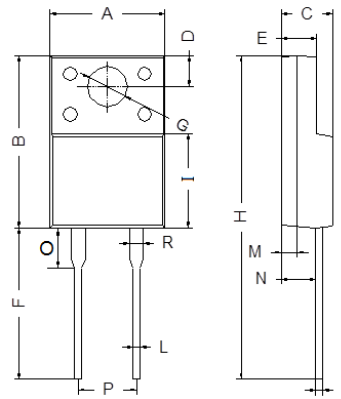

| TO-220F-2L | | |
|------------|-------|-------|
| Dim | Min | Max |
| A | 9.80 | 10.30 |
| B | 15.20 | 15.80 |
| C | 4.37 | 4.77 |
| D | 2.90 | 3.30 |
| E | 2.50 | 2.90 |
| F | 12.90 | 13.50 |
| G | 3.10 | 3.30 |
| H | 28.40 | 29.16 |
| I | 8.40 | 9.10 |
| J | 0.35 | 0.58 |
| L | 0.68 | 0.94 |
| M | 1.30 | 1.50 |
| N | 2.40 | 2.60 |
| O | 2.60 | 3.10 |
| P | 4.98 | 5.18 |
| R | 1.10 | 1.32 |

All Dimensions in mm

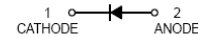

MAXIMUM RATING operating temperature range applies unless otherwise specified

| Symbol | Parameter | MUR1020F | MUR1040F | MUR1060F | Unit |
|----------------|---|-------------|-----------|----------|------------|
| V_{RRM} | Reverse Peak Voltage | 200 | 400 | 600 | V |
| V_{RMS} | RMS Voltage | 140 | 280 | 420 | V |
| V_{DC} | DC Blocking Voltage | 200 | 400 | 600 | V |
| $I_{F(AV)}$ | Average Forward Rectified Current @ $T_A=100^\circ C$ | 10.0 | | | A |
| I_{FSM} | Peak Forward Surge Current 8.3ms Single Half-sine-wave superimposed on Rsted Load | 100 | | | A |
| I_R | Reverse Current $V_R=V_{RRM}, T_A=25^\circ C$ $V_R=V_{RRM}, T_A=150^\circ C$ | 5.0 250 | 10 500 | | μA |
| V_F | Forward Voltage $I_F=10A$ | 0.98 | 1.30 | 1.50 | V |
| t_{rr} | Reverse Recovery Time $I_F=0.5A, I_R=1A, I_{rr}=0.25A$ | 25 | 50 | | ns |
| T_j, T_{stg} | Operating Junction and Storage Temperature Range | -55 to +150 | | | $^\circ C$ |



Ratings and Characteristics Curves (@ $T_A = 25^\circ\text{C}$ unless otherwise specified)

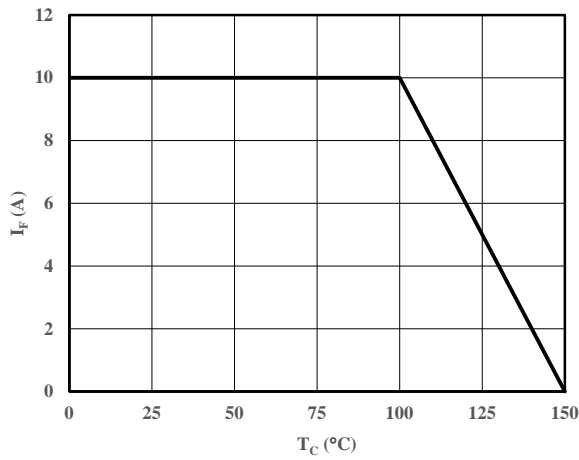

Fig 1 Current Derating Curve

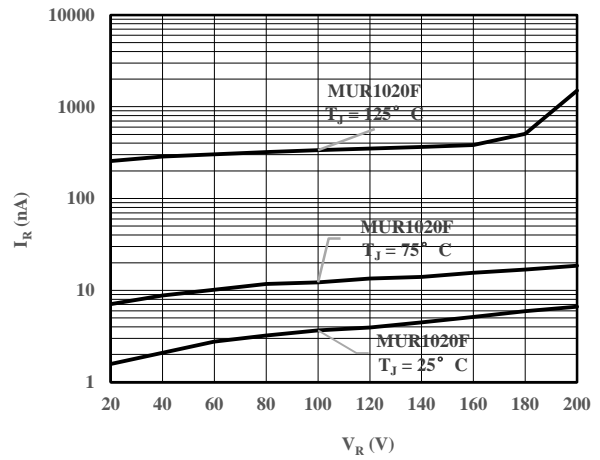

Fig 2 Typical Reverse Characteristic

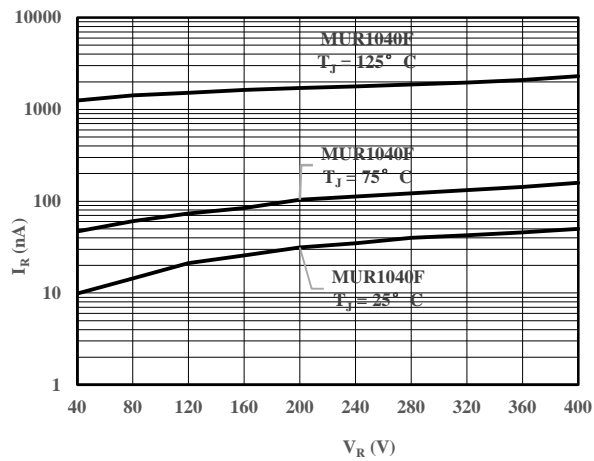

Fig 3 Typical Reverse Characteristic

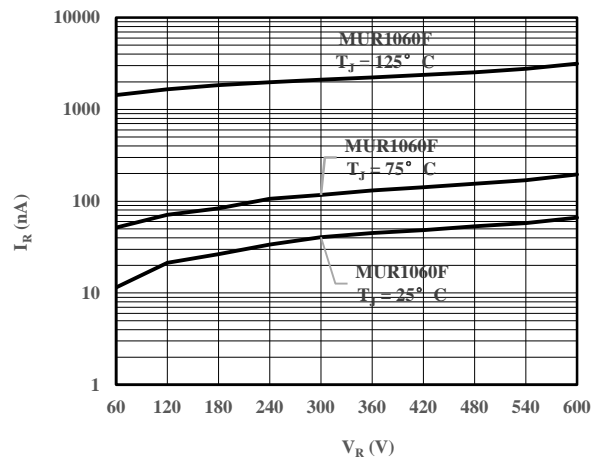

Fig 4 Typical Reverse Characteristic

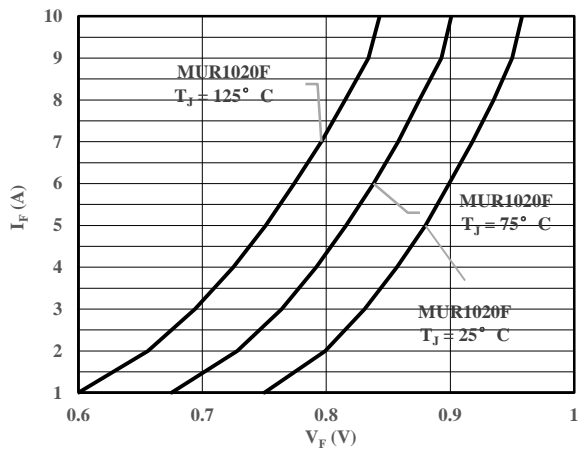

Fig 5 Typical Forward Characteristic

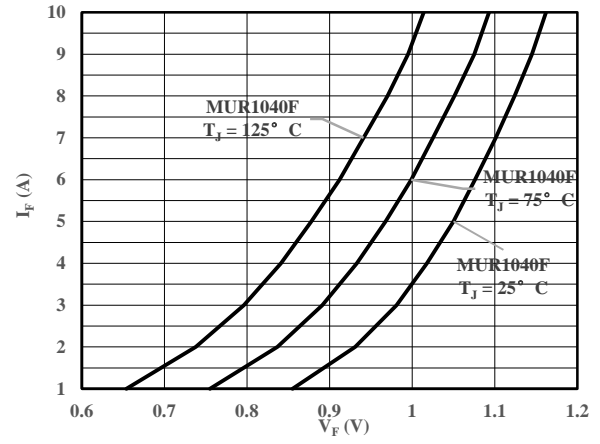

Fig 6 Typical Forward Characteristic

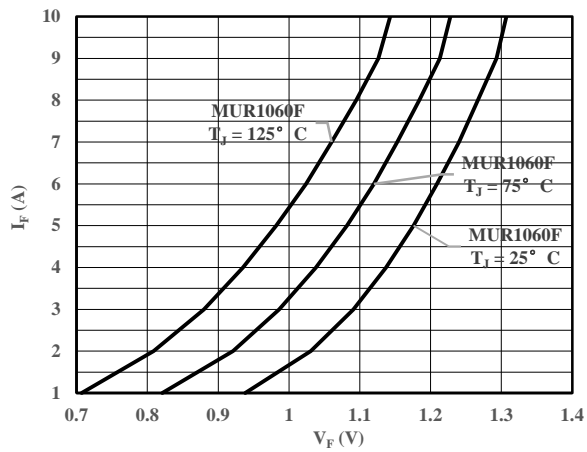

Fig 7 Typical Forward Characteristic

单击下面可查看定价，库存，交付和生命周期等信息

[>>ZG\(中鑫半导体\)](#)