

# LBAT60ET1G

## S-LBAT60ET1G

### Schottky Barrier Diode

#### 1. FEATURES

- We declare that the material of product compliance with RoHS requirements and Halogen Free.
- S- prefix for automotive and other applications requiring unique site and control change requirements; AEC-Q101 qualified and PPAP capable.
- High Current Rectifier Schottky Diode with Low VF Drop
- Low Voltage, Low Inductance
- For Power Supply
- For Detection and Step-up-Conversion

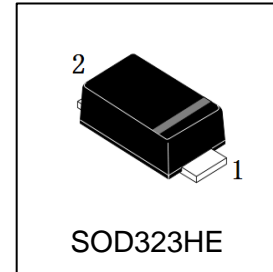

#### 2. DEVICE MARKING AND ORDERING INFORMATION

Device	Marking	Shipping
LBAT60ET1G	60	3000/Tape&Reel



#### 3. MAXIMUM RATINGS(Ta = 25°C)

Parameter	Symbol	Limits	Unit
DC Blocking Voltage	VR	10	V
Forward Current	IF	3	A
Non-repetitive Peak Forward Surge Current@t=8.3ms	IFSM	5	A
Power Dissipation	PD	350	mW
Thermal Resistance from Junction to Ambient	RθJA	286	°C/W
Junction Temperature	Tj	125	°C
Storage Temperature	Tstg	-55~+150	°C

#### 4. ELECTRICAL CHARACTERISTICS (Ta= 25°C)

Characteristic	Symbol	Min.	Typ.	Max.	Unit
Reverse voltage (IR =1mA)	VBR	10	-	-	V
Reverse current (VR =5V)	IR	-	-	15	μA
(VR =8V)		-	-	25	
Forward voltage (IF = 100mA)	VF	-	-	0.38	V
(IF = 500mA)		-	-	0.5	
(IF = 1000mA)		-	-	0.6	
Total capacitance (VR =5V,f=1MHz)	Ctot	-	30	-	pF

**5. ELECTRICAL CHARACTERISTICS CURVES**

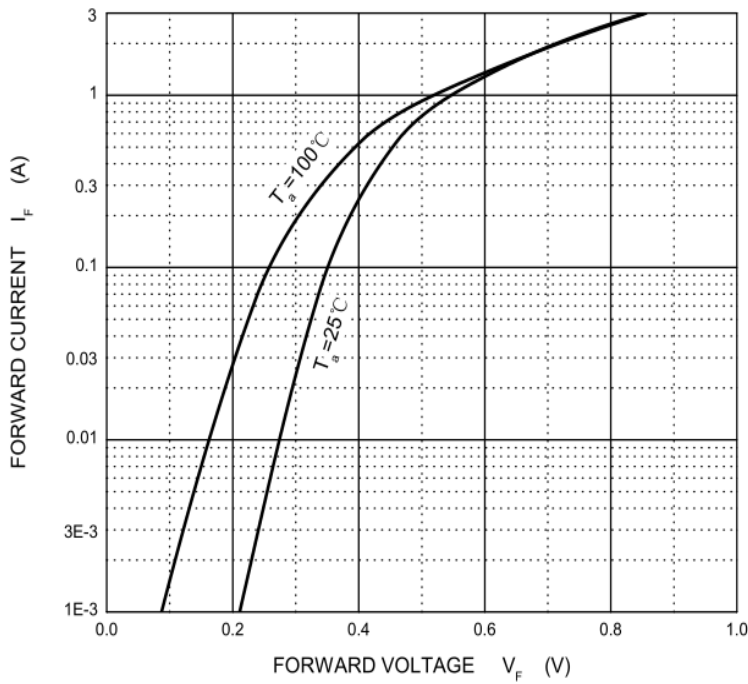

Forward Characteristics

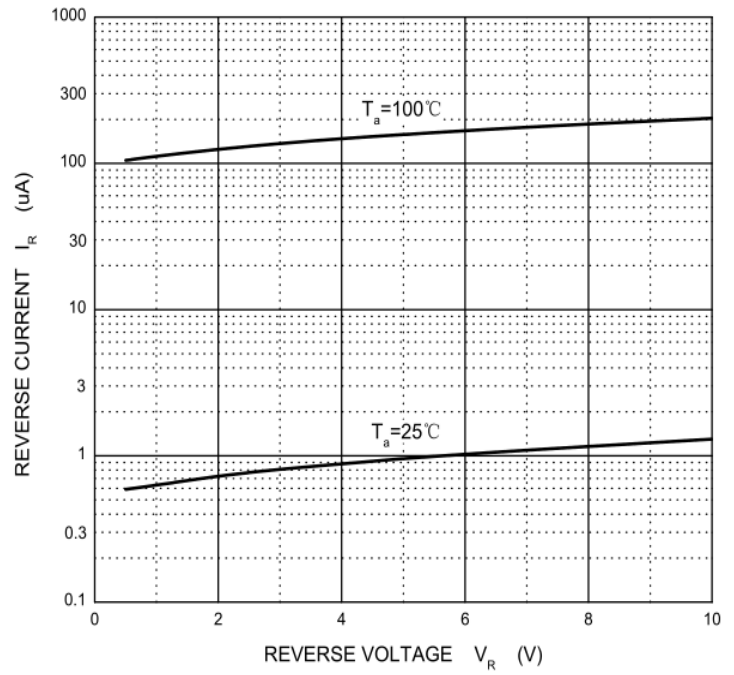

Reverse Characteristics

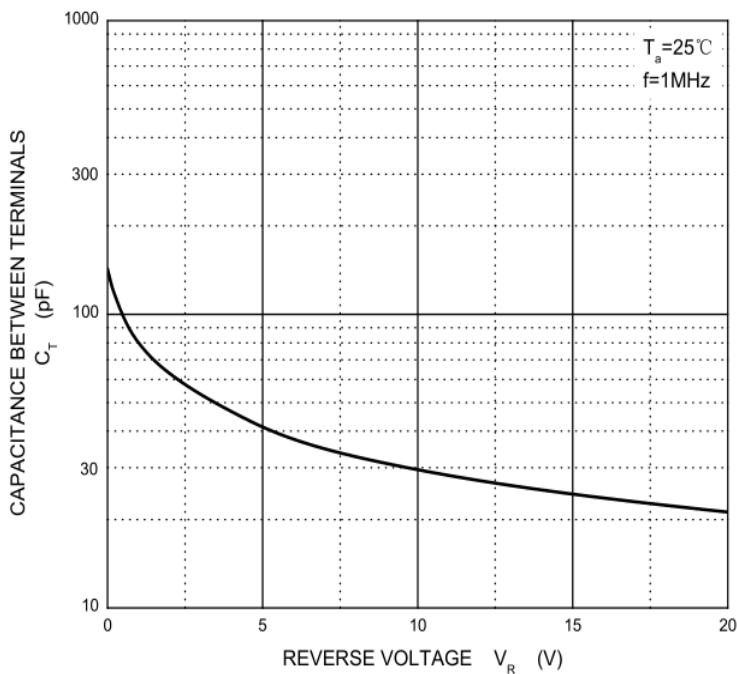

Capacitance Characteristics

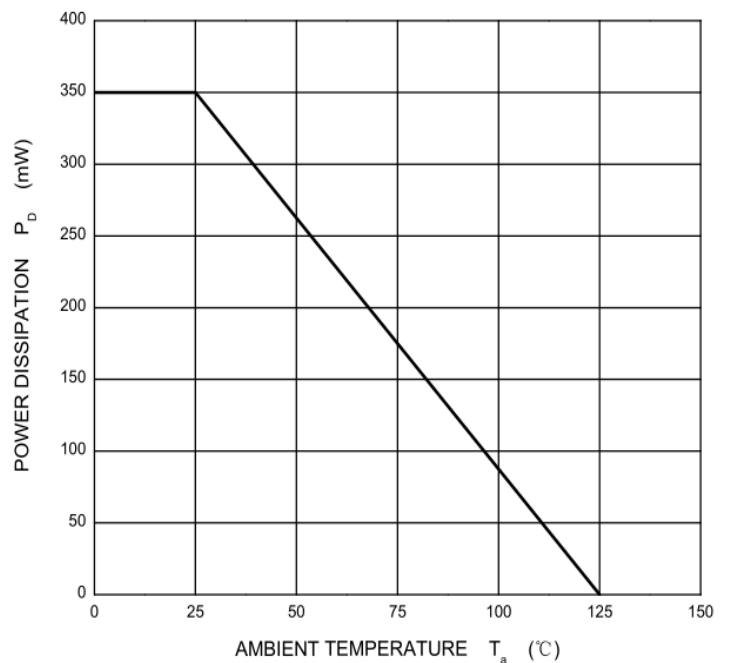

Power Derating Curve

**6.OUTLINE AND DIMENSIONS**

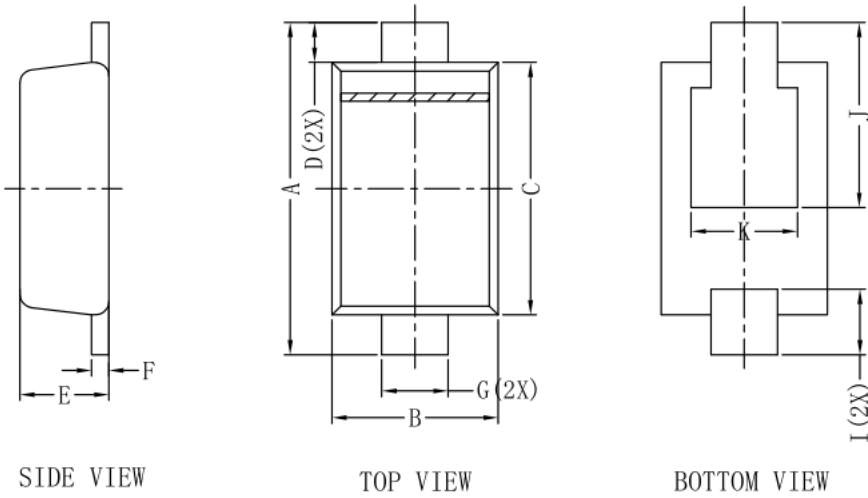

SOD323HE			
DIM	MIN	MAX	Typ.
A	2.30	2.70	2.55
B	1.20	1.35	1.25
C	1.75	1.95	1.90
D	-	-	0.30
E	0.55	0.75	0.67
F	0.10	0.20	0.15
G	0.45	0.65	0.50
I	0.40	0.70	0.50
J	1.15	1.55	1.40
K	-	-	0.80
All Dimensions in mm			

**GENERAL NOTES**

1. Top package surface finish  $Ra0.4 \pm 0.2\mu m$
2. Bottom package surface finish  $Ra0.7 \pm 0.2\mu m$

**7.SOLDERING FOOTPRINT**

**RECOMMENDED PAD**

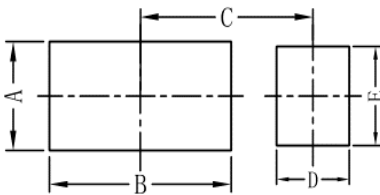

SOD323HE	
DIM	(mm)
A	1.1
B	2.0
C	1.9
D	0.8
E	1.1

**COMPATIBLE PAD**

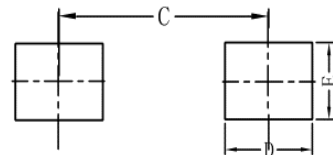

SOD323HE	
DIM	(mm)
D	1.0
E	0.8
C	2.4

单击下面可查看定价，库存，交付和生命周期等信息

[>>LRC\(乐山无线电\)](#)