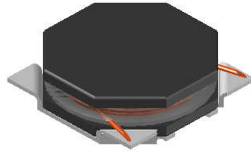

CMI-MDOP201610SH-SERIES

Picture

Features

- Small and Low profile inductor.
- It corresponds to High current.
- Simple and Shield structure.
- Available tape and reel for auto insertion.

Applications

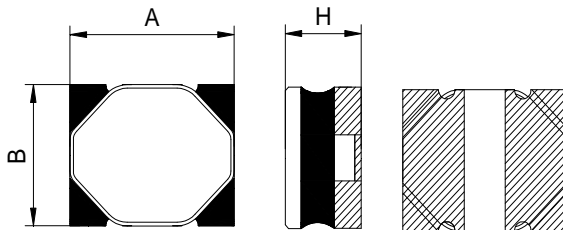
- For small DC/DC converter (cellular Phone, LCD/LED/OLED display, HDD, DSC etc).

Dimensions (Unit:mm)

SERIES	A(mm)	B(mm)	H(mm)Max
MDOP201610SH	2.0±0.2	1.6±0.2	1.0

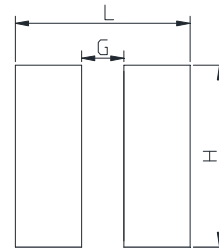
Recommended Land Pattern

L(mm)	G(mm)	H(mm)
2.2	0.4	1.8

Regulation of Part number

<u>CMI</u>	<u>MDOP</u>	<u>201610</u>	<u>S</u>	<u>H</u>	<u>R68</u>	<u>M</u>
①	②	③	④	⑤	⑥	⑦

- ① CoilMaster Inductor
- ② Series Code
- ③ Dimension (unit : mm) : 2.0×1.6×1.0
- ④ Core Material
- ⑤ Halogen Free & Lead Free
- ⑥ Typical Inductance Value : R68=0.68μH
- ⑦ Tolerance : M=±20%

Specifications

Part Number	Inductance (uH)	Tolerance (±)	DCR (mΩ)±20%	Idc1(A) ^{*1}	Idc2(A) ^{*2}	Test Frequency (Hz)
CMI-MDOP201610SH-R47M	0.47	20%	48	3.20	2.50	1M
CMI-MDOP201610SH-R68M	0.68	20%	56	2.60	2.30	1M
CMI-MDOP201610SH-1R0M	1.0	20%	63	2.50	2.10	1M
CMI-MDOP201610SH-2R2M	2.2	20%	137	1.60	1.40	1M

※1:DC current (I_{sat}) that will cause L_o to drop approximately 30%Max, at I_{sat}(A)

※2:DC current (I_{rms}) that will cause an approximate Δt of 40°C

* All specification are subject to change without notice.

www.coilmaster.com

单击下面可查看定价，库存，交付和生命周期等信息

[>>coilmaster\(卡尔马斯特\)](#)