

PART NUMBER	REV	FIRST USED	USED ON DESC.
567200-2	AMI	565435-5	K TERMINATOR
567200-3	AMI	354500-5	G TERMINATOR, 3/5K
567200-4	AMI	1338600-2	M-TERMINATOR
567200-5	AMI	1-471273-3	K-TERMINATOR

LOC	DIST	REV	DATE	BY	CHKD
A	66	AL	04MAY2009	MY	GB
		AM	02FEB2010	MY	GB
		AM1	11JAN2018	FZ	KZ

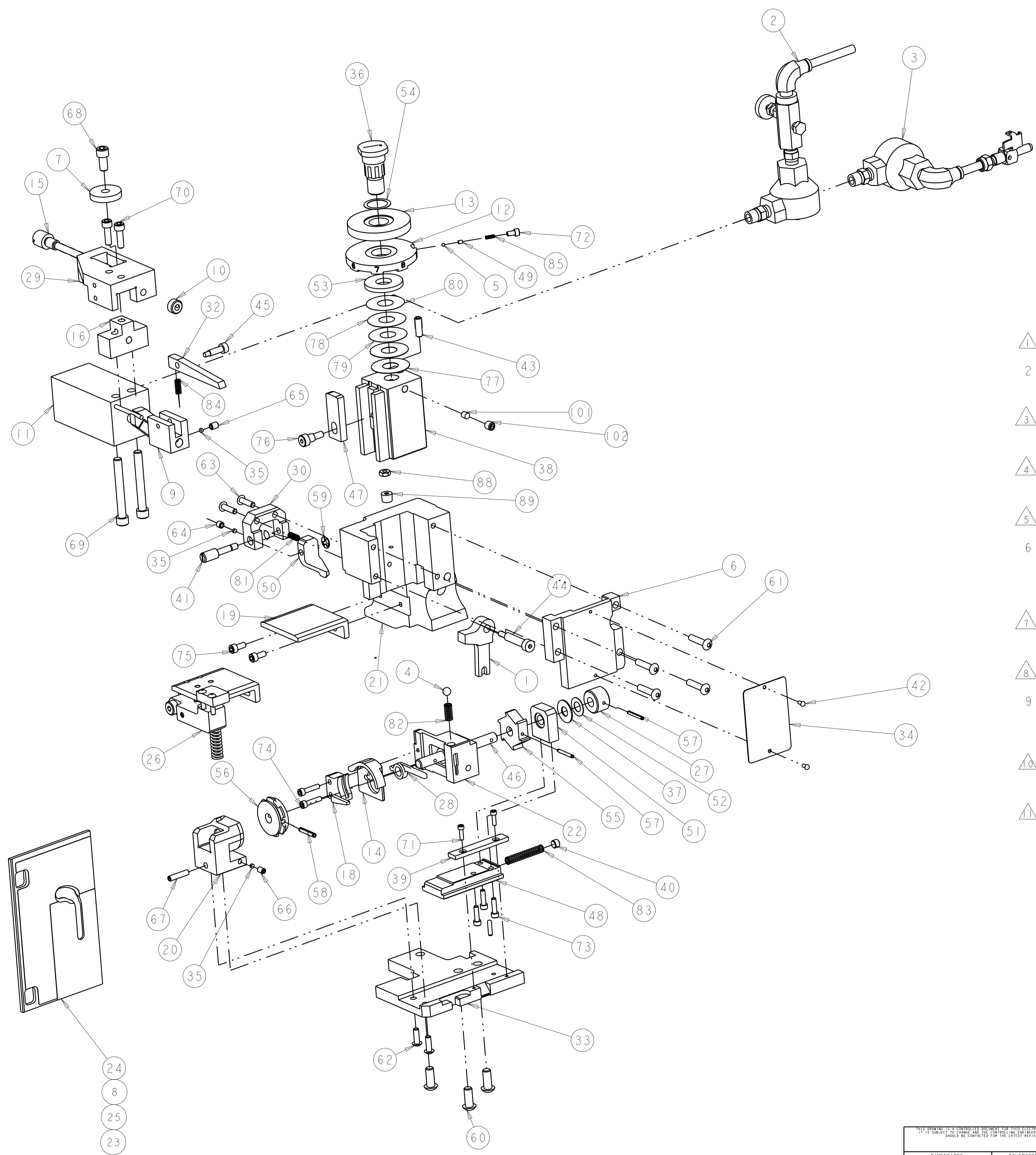

- △ LUBRICATE DAILY USING NO. 20 MACHINE OIL.
- 2. CONTACT THE TOOLING ASSISTANCE CENTER (800) 722-1111 FOR APPLICABLE DIE SETS.
- △ GREASE LIGHTLY (4 CORNERS OF APPLICATOR HOUSING).
- △ USE IN COMBINATION TO SET PROPER CRIMP HEIGHT.
- △ ITEM NOT SHOWN ON ASSEMBLY.
- 6. REFER TO THE TERMINATOR CUSTOMER MANUAL FOR INSTRUCTIONS ON HOW TO RECONFIGURE THE TERMINATOR BASE PLATE CLAMPS FOR TAPE FEED APPLICATORS.
- △ REMOVE ITEMS WHEN USING TERMINAL PART NUMBER 696405-2.
- △ APPLY ITEM 86 TO ITEM 43.
- 9. REFER TO INSTRUCTION SHEET AI-8082 (408-8082) FOR CONNECTING AIR FEED CYLINDER TO AIR FEED VALVE.
- △ GUARD MUST BE IN PLACE WHEN OPERATING APPLICATOR IN BENCH MACHINE.
- △ SEE ASSEMBLY DRAWING FOR COMPONENTS.

SCALE 11:20

DIMENSIONS: IN		TOLERANCES UNLESS OTHERWISE SPECIFIED: 0 PLC ± 1 PLC ± 2 PLC ± 3 PLC ± 4 PLC ± ANGLES ± FINISH		DWN: K. STAKEM 15FEB2007 CHK: T. ELBIN 15FEB2007 APVD: T. ELBIN 15FEB2007	NAME: Quick Change Appl, Side Feed PRODUCT SPEC: PIDG & PG 22-18, 16-14, 12-10 APPLICATION SPEC: 114-2157 WEIGHT: A100779C=567200	TE Connectivity Harrisburg, PA 17105-3608
MATERIAL:		FINISH:		SIZE: CAGE CODE DRAWING NO: RESTRICTED TO:	SCALE: 1:12 SHEET 1 OF 2 REV: AM1	CUSTOMER DRAWING

LOC	DIST	REVISIONS			
		P	LTN	DATE	OWN
A	66	-	SEE SHEET 1	-	-

APPLICATOR SET UPS

PRODUCT TYPE	DIE SET NO	DIE MARK
RING SPADES AND PIDG BUTT SPLICE PIDG PLASTI-GRIP	26-22 YELLOW	69877 YELLOW
	24-20 WHITE	69878 WHITE
	22-16 RED	59826-1*/69872 RED
	16-14 BLUE	59827-1*/69873 BLUE
	12-10 YELLOW	59828-1*/69874 YELLOW
FASTON PIDG	26-24 YELLOW	69877-2 YELLOW
	22-18 CLEAR	90248-2
	22-18 RED	59826-1* RED
	16-14 BLUE	59827-1* BLUE
	14-12 GREEN	90240-2
	12-10 YELLOW	59828-1* YELLOW
	26-22 YELLOW	69877
BUTT SPLICES PLASTI-GRIP	24-20 WHITE	69878 WHITE
	22-16 RED	69872 RED
	16-14 BLUE	69873 BLUE
	12-10 YELLOW	69874 YELLOW
	12-10 YELLOW	69897 BLACK/YELLOW
LARGE EXPANSION PLASTI-GRIP AND PIDG	22-18	68240-1
	16-14	68241-1
	12-10	68242-1
RING SPADES SOLISTRAND	22-18	68259-1
	16-14	68094
	12-10	68260-2
RING SPADES BUDGET	16-14 BLUE	59827-2 BLUE
.156 SERIES, SHUR PLUG, RECEPTACLE, FULLY INSULATED		

\* TETRI-CRIMP DIE CONFIGURATION

1	1	1	1	-	21007-2	SCR, SET, CUP POINT 1/4-20 X .250	102
1	1	1	1	-	690191-4	PLUG, NYLON	101
1	1	1	1	-	811242-3	BUMPER, HOLD DOWN	89
1	1	1	1	-	21018-5	NUT, HEX, REG 6-32	88
5	-	-	-	-	854061-4	PACKAGE, DOCUMENTATION	87
8	AR	AR	AR	AR	1-23419-5	SEALANT, LOCTITE #222	86
1	1	1	1	-	690170-1	SPRING, COMPRESSION	85
1	1	1	1	-	4-22279-4	SPRING, COMPRESSION	84
1	1	1	1	-	3-22280-7	SPRING, COMPRESSION	83
1	1	1	1	-	2-22280-7	SPRING, COMPRESSION	82
1	1	1	1	-	1-22279-6	SPRING, COMPRESSION	81
4	1	1	1	-	469367-4	SHIM	80
4	1	1	1	-	469367-3	SHIM	79
4	1	1	1	-	469367-2	SHIM	78
2	2	2	2	-	469367-1	SHIM	77
1	1	1	1	-	5-21004-7	SCR, SKT HD SHLDR 1/4 DIA X .250	76
2	2	2	2	-	2-21000-6	SCR, SKT HD CAP 8-32 X .375	75
2	2	2	2	-	2-21000-1	SCR, SKT HD CAP 6-32 X .625	74
3	3	3	3	-	2-21000-0	SCR, SKT HD CAP 6-32 X .500	73
1	1	1	1	-	1-21000-8	SCR, SKT HD CAP 6-32 X .250	72
2	2	2	2	-	1-21000-4	SCR, SKT HD CAP 4-40 X .375	71
2	2	2	2	-	3-21000-6	SCR, SKT HD CAP 10-32 X .625	70
2	2	2	2	-	1-21001-0	SCR, SKT HD CAP 1/4-20 X 2.000	69
1	1	1	1	-	21001-2	SCR, SKT HD CAP 1/4-20 X .500	68
1	1	1	1	-	4-21006-6	SCR, SET, CUP POINT 8-32 X .750	67
1	1	1	1	-	4-21006-0	SCR, SET, CUP POINT 8-32 X .250	66
1	1	1	1	-	5-21006-0	SCR, SET, CUP POINT 10-32 X .250	65
7	1	1	1	-	4-21006-9	SCR, SET, CUP POINT 10-32 X .188	64
7	2	2	2	-	2-21002-3	SCR, BTN SKT HD CAP 8-32 X .625	63
2	2	2	2	-	2-21002-2	SCR, BTN SKT HD CAP 8-32 X .500	62
4	4	4	4	-	3-21002-0	SCR, BTN SKT HD CAP 10-32 X .875	61
3	3	3	3	-	3-21002-4	SCR, BTN SKT HD CAP 1/4-20 X .625	60
7	1	1	1	-	1-21986-1	RING, RETAIN, EXTERN, 3/16 E-RING	59
1	1	1	1	-	5-21028-5	PIN, SLOTTED SPRING .125 X .750	58

2	2	2	2	-	4-21028-0	PIN, SLOTTED SPRING .094 X .750	57
1	1	1	1	-	459668-1	WHEEL, TAPE FEED	56
1	1	1	1	-	809702-1	WHEEL, INDEX	55
1	1	1	1	-	22480-5	WASHER, WAVE SPRING	54
1	1	1	1	-	690124-4	WASHER, RAM (.135)	53
1	1	1	1	-	1-24088-6	WASHER, CURVED	52
1	1	1	1	-	809698-1	SUPPORT, BEARING	51
7	1	1	1	-	809703-1	STRIPPER	50
1	1	1	1	-	690603-1	SPRING ASSIST AMP-O-MATOR APPLICATOR	49
1	1	1	1	-	820838-1	SLIDE, RETRACT	48
1	1	1	1	-	459662-2	SLIDE, INSULATION CRIMPER	47
1	1	1	1	-	809697-1	SHAFT, INDEX	46
1	1	1	1	-	5-21005-8	SCREW, SHLD, SOC HD SELF-LOCKING, PATCH TYPE	45
1	1	1	1	-	21005-5	SCREW, SHLD, SOC HD SELF-LOCKING, PATCH TYPE	44
1	1	1	1	-	21009-7	SCREW, SET, SOCKET HEAD, TYPE C CUP POINT, SELF-LOCKING	43
8	2	2	2	-	21017-2	SCREW, DRIVE	42
1	1	1	1	-	809704-1	SCREW, ADJ.	41
7	1	1	1	-	809700-1	RETAINER, SPRING	40
1	1	1	1	-	809696-1	RETAINER, SLIDE	39
1	1	1	1	-	812265-1	RAM	38
1	1	1	1	-	1-24001-1	RACE, THRUST BEARING	37
1	1	1	1	-	690212-1	POST, RAM	36
7	3	3	3	-	690191-3	PLUG, NYLON	35
1	1	1	1	-	461264-1	PLATE, IDENTIFICATION	34
1	1	1	1	-	809684-1	PLATE, BASE	33
1	1	1	1	-	809688-1	PAWL, INDEX	32
5	-	1	1	-	854061-1	PACKAGE, DOCUMENTATION	31
7	1	1	1	-	809686-1	MOUNT, STRIPPER	30
1	1	1	1	-	809689-1	MOUNT, CYLINDER (CAST COMPLETE)	29
1	1	1	1	-	809695-1	LIFTER, DRAG	28
1	1	1	1	-	809701-1	KNOB, INDEX	27
1	-	-	-	-	1213758-1	KIT, TERMINAL STRIPPER ASSEMBLY	26
-	1	-	-	-	904962-1	INSERT, GUARD (YELLOW)	25
-	-	1	-	-	679995-1	INSERT, GUARD	24
-	-	1	-	-	679994-1	INSERT, GUARD	23
1	1	1	1	-	820839-1	HOUSING, TAPE DRAG	22
1	1	1	1	-	809707-1	HOUSING	21
1	1	1	1	-	820841-1	HOLDER, LOWER TOOL	20
-	1	1	1	-	809690-1	GUIDE, TERMINAL	19
1	1	1	1	-	820840-1	GUIDE, TAPE	18
1	-	-	1	-	1-462992-5	GUARD, ASSY, SIDE FEED DUAL	17
1	1	1	1	-	376166	FEED ADJUSTMENT BLOCK	16
1	1	1	1	-	376169	FEED ADJUSTING SCREW, AIR FEED	15
1	1	1	1	-	809693-1	DRAG, TAPE	14
1	1	1	1	-	459663-5	DISC, WIRE CRIMP	13
1	1	1	1	-	690142-1	DISC, INSULATION	12
1	1	1	1	-	1490794-1	CYLINDER, AIR	11
1	1	1	1	-	22292-2	COLLAR, SHAFT	10
1	1	1	1	-	809687-1	CLEVIS, CYLINDER	9
-	1	-	-	-	904961-1	INSERT, GUARD (RED/BLUE)	8
1	1	1	1	-	376165	CLAMP WASHER	7
1	1	1	1	-	454220-7	CAP, RAM	6
1	1	1	1	-	23241-6	BALL, STEEL	5
1	1	1	1	-	23241-3	BALL, STEEL	4
-	1	1	-	-	692655-7	AIR FEED VALVE ASSEMBLY	3
1	-	-	1	-	692655-5	AIR FEED VALVE ASSEMBLY	2
1	1	1	1	-	820837-1	ACTUATOR, SLIDE, MACH.	1
-5	-4	-3	-2	U/M	PART NO	DESCRIPTION	ITEM NO

DIMENSIONS: IN		TOLERANCES UNLESS OTHERWISE SPECIFIED: 0 PLC ± 1 PLC ± 2 PLC ± 3 PLC ± 4 PLC ± ANGLES ± FINISH		DWG STAKEM 15FEB2007 CHK T. ELBIN 15FEB2007 APVD T. ELBIN 15FEB2007	TE Connectivity Harrisburg, PA 17105-3608
MATERIAL:		FINISH:		NAME: Quick Change Appl, Side Feed PIDG & PG 22-18, 16-14, 12-10 PRODUCT SPEC:	
APPLICATION SPEC:		SIZE: 114-2157 CAGE CODE: A100779 DRAWING NO: C=567200		RESTRICTED TO:	
CUSTOMER DRAWING		SCALE: 1:12		SHEET 2 OF 2	
CUSTOMER ACCESSIBLE PRODUCTION DRAWING					

单击下面可查看定价，库存，交付和生命周期等信息

[>>TE Connectivity\(泰科\)](#)