

SBP Series



Model	Rated voltage DC (V)	Rated current DC (A)	Impedance (at 100MHz) (Ω) min.	DC resistance (m Ω /line) max.	Operating temperature range ($^{\circ}$ C)
SBP-5001T	50	5.0	500	7	-25 to +70

- Withstanding voltage: 200V DC for one minute between lines
- Insulation resistance: More than 10M Ω (100V DC, between lines)

Shape and Dimensions

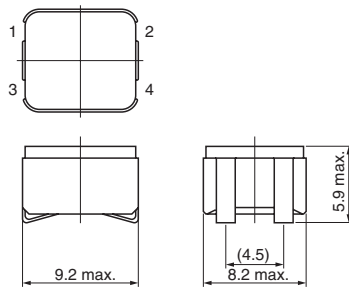

[mm]

Circuit Diagram

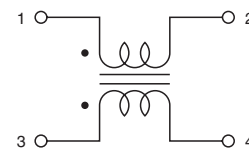

Recommended Land Pattern

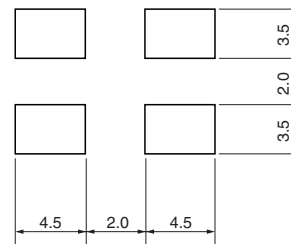

[mm]

Impedance vs. Frequency

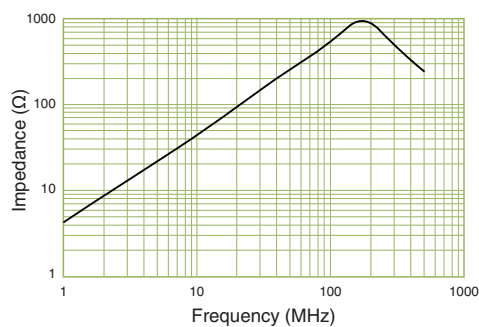

单击下面可查看定价，库存，交付和生命周期等信息

[>>KEMET\(基美\)](#)