

3.2x2.5mm for Automotive

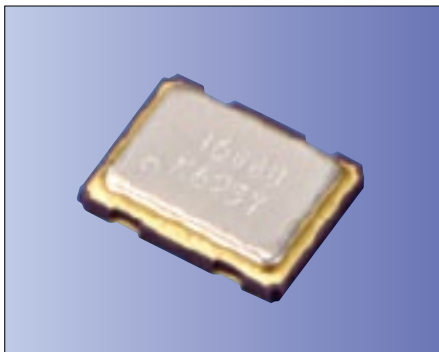

RoHS Compliant

**Features**

- Crystal unit for automotive electronics
- Improved solderability
- Improved mounting stability with 4 terminals
- Improved anti-noise performance with GND terminal
- Using ceramic package resulting in high reliability
- Small and low profile
- Improved rust prevention performance
- Reflow compatible
- Highly reliable solder junction (3000 heat cycles -40 to +125°C)
- AEC-Q200 qualified

**Applications**

- ECU • TPMS
- High-Speed Automotive Network (Flex Ray™ etc.)

**How to Order**

**CX3225SA 12000**

① ② ③ ④ ⑤ ⑥ ⑦

- ① Series
- ② Frequency
- ③ Load Capacitance
- ④ Frequency Stability
- ⑤ Operating Temp. Range
- ⑥ Frequency Temp. Stability
- ⑦ Individual Specification

<b>D0</b>	8 pF	Std.	<b>K</b>	±30×10 <sup>-6</sup>	—
<b>F0</b>	10 pF	—	<b>P</b>	±50×10 <sup>-6</sup>	Std.
			<b>Q</b>	±100×10 <sup>-6</sup>	—

Packaging (Tape & Reel 3000/ 1000 pcs./ reel)

**Specifications**

Item	Symbol	Specification	Units	Remarks
<b>Frequency Range</b>	f <sub>nom</sub>	8000 to 54000	kHz	
<b>Overtone Order</b>	OT	Fundamental	—	
<b>Load Capacitance</b>	CL	8	pF	
<b>Frequency Stability</b>	f <sub>tol</sub>	±50	×10 <sup>-6</sup>	25°C±3°C
<b>Motional Series Resistance</b>	R1	Table 1	ohm	
<b>Drive Level</b>	DL	Table 2	μW	
<b>Operating Temp. Range</b>	T <sub>use</sub>	-40 to +150	°C	
<b>Storage Temp. Range</b>	T <sub>stg</sub>	-40 to +150	°C	
<b>Frequency Temp. Characteristics</b>	f <sub>tem</sub>	±200	×10 <sup>-6</sup>	Freq. deviation from the value at 25°C

• Please contact us for other specifications.

**Typical Frequencies and Part Numbers**

Frequency (kHz)	Part Number
9843.750	CX3225SA09843D0PTWZ1
10000.000	CX3225SA10000D0PTWZ1
12000.000	CX3225SA12000D0PTWZ1
12800.000	CX3225SA12800D0PTWZ1
13560.000	CX3225SA13560D0PTWZ1
16000.000	CX3225SA16000D0PTWZ1
19200.000	CX3225SA19200D0PTWZ1
20000.000	CX3225SA20000D0PTWZ1
24000.000	CX3225SA24000D0PTWZ1
26000.000	CX3225SA26000D0PTWZ1
28636.360	CX3225SA28636D0PTWZ1
32000.000	CX3225SA32000D0PTWZ1
40000.000	CX3225SA40000D0PTWZ1

**Table1 Motional Series Resistance**

Frequency Range	Motional Series Resistance
8000 to 9799kHz	500Ω max.
9800 to 14999kHz	200Ω max.
15000 to 15999kHz	100Ω max.
16000 to 19999kHz	60Ω max.
20000 to 54000kHz	50Ω max.

**Table2 Level of Drive**

Frequency Range	Level of Drive
8000 to 54000kHz	10μW (200μW max.)

**Dimensions**

(Unit: mm)

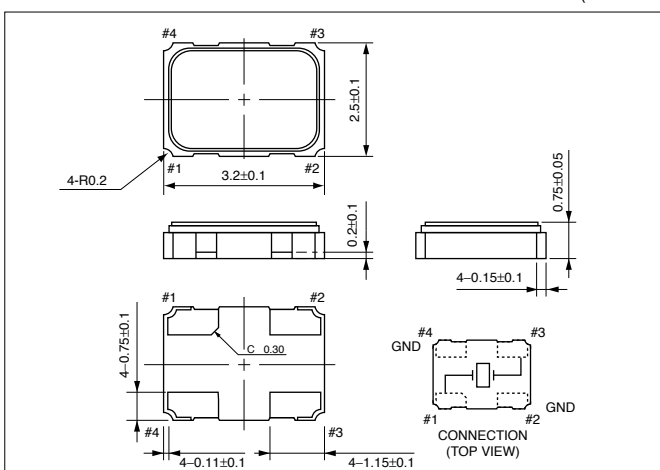

**Recommended Land Pattern**

(Unit: mm)

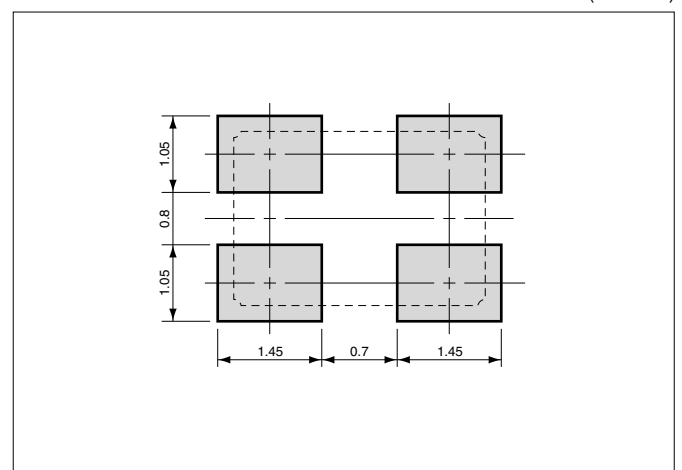

单击下面可查看定价，库存，交付和生命周期等信息

[>>Kyocera\(京瓷\)](#)