

RX Series

Features

- Endurance : 105°C 2000H
- Miniaturized, Extra Low Impedance (1 size smaller than FZ Series)
- Designed for reflow soldering
- Designed for surface mounting on high-density PCB
- RoHS 2.0 compliant
- 219 SVHC & REACH compliant



Marking color: Black

Specifications								
Category temp. range	-55°C to +105°C							
Capacitance tolerance	±20% (120 Hz / +20 °C)							
Leakage current	$I \leq 0.01 CV$ or $3 \mu A$ whichever is greater (after 2 minutes)							
Tan δ	Please see the attached characteristics list							
Characteristics at low temperature	Rated voltage (V)	6.3	10	16	25	35	50	Impedance ratio at 120 Hz
	Z (-25 °C) / Z (+20 °C)	4	3	2	2	2	2	
	Z (-55 °C) / Z (+20 °C)	8	5	4	3	3	3	
Endurance	After applying rated working voltage for 2000 hours at +105 °C ± 2 °C, and then being stabilized at +20 °C, capacitors shall meet the following limits.							
	Capacitance change	Within ±30% of the initial value						
	Dissipation factor (tan δ)	Less than 200% of the initial value						
	Leakage current	Within the initial limit						
Shelf life	After storage for 1000 h at +105 °C ± 2 °C with no voltage applied and then being stabilized at +20 °C, capacitors shall meet the limits specified in endurance.							
Resistance to soldering heat	After reflow soldering and then being stabilized at +20 °C, capacitors shall meet the following limits.							
	Capacitance change	Within ±10% of the initial value						
	Dissipation factor (tan δ)	Within the initial limit						
	Leakage current	Within the initial limit						
Frequency correction factor for ripple current	Frequency	50Hz	120Hz	1kHz	10kHz \leq			
	C \leq 470 μ F	0.5	0.65	0.85	1.0			
	C > 470 μ F	0.55	0.7	0.9	1.0			

Dimensions:

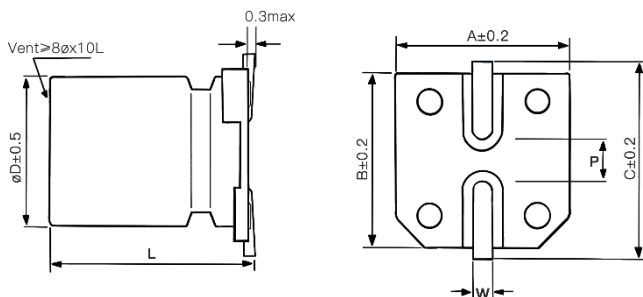

Dimensions							Unit: mm
ϕD	L	A	B	C	W	P ± 0.2	
4	5.7 ± 0.3	4.3	4.3	5.1	0.5~0.8	1.0	
5	5.7 ± 0.3	5.3	5.3	6.1	0.5~0.8	1.3	
6.3	5.7 ± 0.3	6.6	6.6	7.3	0.5~0.8	2.2	
6.3	7.7 ± 0.3	6.6	6.6	7.3	0.5~0.8	2.2	
8	6.5 ± 0.3	8.3	8.3	9.2	0.7~1.2	3.1	
8	10.5 ± 0.5	8.3	8.3	9.2	0.7~1.2	3.1	
10	10.5 ± 0.5	10.3	10.3	11.2	0.7~1.2	4.4	

Marking:

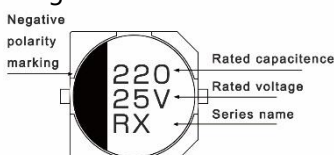

Part Number System:

RX series	25V	220 μ F	±20 %	6.3 ϕ x 7.7L
<u>RX</u>	<u>1E</u>	<u>221</u>	<u>M</u>	<u>0607</u>
Series name	Rated voltage	Capacitance	Capacitance tolerance	Case Size

Characteristics list

Rated voltage (V)	Capacitance (±20%) (μF)	Case size		Specification			Part Number④	Taping&Reel
		øD (mm)	L (mm)	Rated ripple current① (mA rms)	Imp.② (Ω)	tan δ③		MPQ (pcs/reel)
6.3	100	4	5.7	160	1.25	0.26	RX0J101M0406	2000
	220	5	5.7	240	0.76	0.26	RX0J221M0506	1000
	330	6.3	5.7	300	0.36	0.26	RX0J331M0606	1000
	470	6.3	7.7	600	0.26	0.26	RX0J471M0607	1000
	680	6.3	7.7	600	0.26	0.26	RX0J681M0607	1000
	1500	8	10.5	850	0.16	0.28	RX0J152M0810	500
	2200	10	10.5	1190	0.08	0.32	RX0J222M1010	500
10	68	4	5.7	160	1.25	0.19	RX1A680M0406	2000
	150	5	5.7	240	0.76	0.19	RX1A151M0506	1000
	220	6.3	5.7	300	0.36	0.19	RX1A221M0606	1000
	330	6.3	7.7	600	0.26	0.19	RX1A331M0607	1000
	470	6.3	7.7	600	0.26	0.19	RX1A471M0607	1000
	1000	8	10.5	850	0.16	0.21	RX1A102M0810	500
	1500	10	10.5	1190	0.08	0.21	RX1A152M1010	500
16	47	4	5.7	160	1.25	0.16	RX1C470M0406	2000
	68	5	5.7	240	0.76	0.16	RX1C680M0506	1000
	100	5	5.7	240	0.76	0.16	RX1C101M0506	1000
	150	6.3	5.7	300	0.36	0.16	RX1C151M0606	1000
	220	6.3	5.7	300	0.36	0.16	RX1C221M0606	1000
	330	6.3	7.7	600	0.26	0.16	RX1C331M0607	1000
	470	8	6.5	600	0.16	0.16	RX1C471M0806	1000
	680	8	10.5	850	0.16	0.16	RX1C681M0810	500
	820	8	10.5	850	0.16	0.16	RX1C821M0810	500
	1000	10	10.5	1190	0.08	0.18	RX1C102M1010	500
	1200	10	10.5	1190	0.08	0.18	RX1C122M1010	500

① Rated ripple current (100kHz / +105°C) ② Impedance (100kHz / +20°C) ③ tan δ (120Hz / +20°C)

④ For plastic reel packaging, the Part Number is appended with "PR" at the end.

※Please refer to the page of reflow conditions for reflow profile.

Characteristics list

Rated voltage (V)	Capacitance (±20%) (μF)	Case size		Specification			Part Number④	Taping&Reel
		øD (mm)	L (mm)	Rated ripple current① (mA rms)	Imp.② (Ω)	tan δ③		MPQ (pcs/reel)
25	22	4	5.7	160	1.25	0.14	RX1E220M0406	2000
	33	4	5.7	160	1.25	0.14	RX1E330M0406	2000
	47	5	5.7	240	0.76	0.14	RX1E470M0506	1000
	68	5	5.7	240	0.76	0.14	RX1E680M0506	1000
	100	6.3	5.7	300	0.36	0.14	RX1E101M0606	1000
	150	6.3	7.7	600	0.26	0.14	RX1E151M0607	1000
	220	6.3	7.7	600	0.26	0.14	RX1E221M0607	1000
	390	8	10.5	850	0.16	0.14	RX1E391M0810	500
	470	8	10.5	850	0.16	0.14	RX1E471M0810	500
	560	8	10.5	850	0.16	0.14	RX1E561M0810	500
	820	10	10.5	1190	0.08	0.14	RX1E821M1010	500
1000	10	10.5	1190	0.08	0.16	RX1E102M1010	500	
35	22	4	5.7	160	1.25	0.12	RX1V220M0406	2000
	33	5	5.7	240	0.76	0.12	RX1V330M0506	1000
	47	5	5.7	240	0.76	0.12	RX1V470M0506	1000
	68	6.3	5.7	300	0.36	0.12	RX1V680M0606	1000
	100	6.3	5.7	300	0.36	0.12	RX1V101M0606	1000
	150	6.3	7.7	600	0.26	0.12	RX1V151M0607	1000
	330	8	10.5	850	0.16	0.12	RX1V331M0810	500
	390	8	10.5	850	0.16	0.12	RX1V391M0810	500
	470	10	10.5	1190	0.08	0.12	RX1V471M1010	500
	560	10	10.5	1190	0.08	0.12	RX1V561M1010	500
	680	10	10.5	1190	0.08	0.12	RX1V681M1010	500
50	10	4	5.7	85	2.6	0.10	RX1H100M0406	2000
		5	5.7	165	1.18	0.10	RX1H100M0506	1000
	22	5	5.7	165	1.18	0.10	RX1H220M0506	1000
	47	6.3	5.7	195	0.74	0.10	RX1H470M0606	1000
	100	6.3	7.7	350	0.40	0.10	RX1H101M0607	1000
	220	8	10.5	670	0.24	0.10	RX1H221M0810	500
	330	10	10.5	900	0.18	0.10	RX1H331M1010	500

① Rated ripple current (100kHz / +105°C) ② Impedance (100kHz / +20°C) ③ tan δ (120Hz / +20°C)

④ For plastic reel packaging, the Part Number is appended with "PR" at the end.

※Please refer to the page of reflow conditions for reflow profile.

单击下面可查看定价，库存，交付和生命周期等信息

[>>NJS\(安远南佳盛\)](#)