

- NOTES:
- MATERIAL:
    - HOUSING: HALOGEN FREE PLASTIC,UL94V-0.
    - CONTACT: COPPER ALLOY
    - FITTING NAIL: COPPER ALLOY
  - FINISH:
    - CONTACT: PLS SEE ACES P/N LEGEND
    - FITTING NAIL: PLS SEE ACES P/N LEGEND
  - REFLOW SOLDER CAPABLE TO 260°C PER ACES SPEC.
  - SPEC. PLS. REFER TO PS-50238-XXXX-XXX
  - PACKAGE PLS SEE ACES P/N LEGEND
  - PART NUMBER

P/N LEGEND  
50238-XXX X X-XXX

NO OF CKT

PACKING

XXX	Boss	Color	PACKING
001	With Boss	Black	87216-XXXX-TRP
002	Without Boss	Black	87216-XXXX-TRP
003	With Boss	White	87216-XXXX-TRP
004	Without Boss	White	87216-XXXX-TRP
006	With Boss	Yellow	87216-XXXX-TRP
007	With Boss	Black	87216-XXXX-U-TRP
008	With Boss	Black	87216-XXXX-TRP
009	With Boss	Black	87216-XXXX-TRP
012	Without Boss	White	87216-XXXX-U-TRP
014	Without Boss	Black	87216-XXXX-U-TRP

- PLATING
- 1:GOLD FLASH
  - L:LEAD FREE (PURE TIN)
  - N:MATTE TIN
  - C:15u" GOLD ON CONTACT FOR LEAD FREE
  - 4:3u" GOLD ON CONTACT FOR LEAD FREE
  - T: CONTACT AREA:10u" GOLD PLATING SOLDER AREA: GOLD FLASH
  - D: CONTACT AREA:30u" GOLD PLATING SOLDER AREA: GOLD FLASH 50u" MIN. NICKEL OVERALL
  - 3: CONTACT AREA:1u" GOLD PLATING SOLDER AREA:1u" GOLD FLATING

CKT	Dim A	Dim B	Dim C	M/Size or Cover
8	3.0	6.3	4.4	W6T12
10	4.0	7.3	5.4	W7T12
12	5.0	8.3	6.4	W8T12
14	6.0	9.3	7.4	W6T12
16	7.0	10.3	8.4	50238-C
18	8.0	11.3	9.4	50238-C
20	9.0	12.3	10.4	50238-C
24	11.0	14.3	12.4	50238-C
28	13.0	16.3	14.4	50238-C
30	14.0	17.3	15.4	50238-C
34	16.0	19.3	17.4	50238-C
40	19.0	22.3	20.4	50238-C
50	24.0	27.3	25.4	50238-C
60	29.0	32.3	30.4	50238-C

<b>QUALITY SYMBOLS</b> MAJOR Ⓢ CRITICAL Ⓢ <b>GENERAL TOLERANCES (UNLESS SPECIFIED)</b> X ±0.5 X ±0.25 XX ±0.15 XXX ±0.1 ANGLES ±2°	DRAWN BY Huang,ShunSen DATE 21/05/18			
	CHECKED BY Lu, Jing Quan DATE 21/05/18		TITLE 1.0mm WTB D/R WAFER SMT S/T TYPE	
	APPROVED BY hseh, fu yu DATE 21/05/18	UNITS mm	SIZE A4	RFG NO. NA
	SCALE 4:1	SHEET NO. 1 OF 2	REV V	DWG NO. 50238-XXXX-XXX

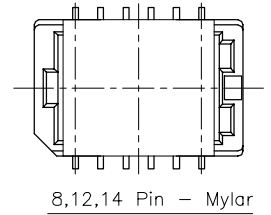
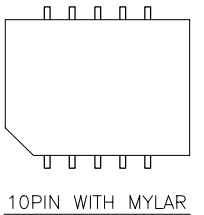
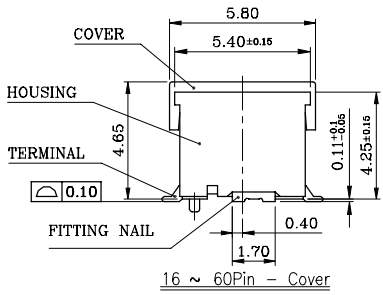
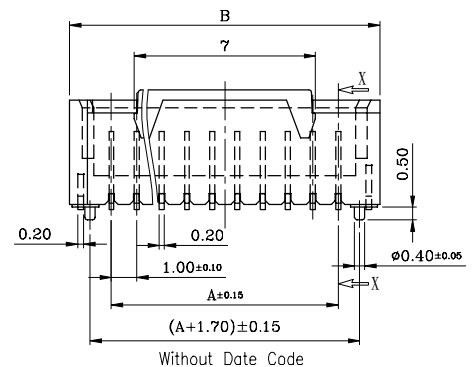
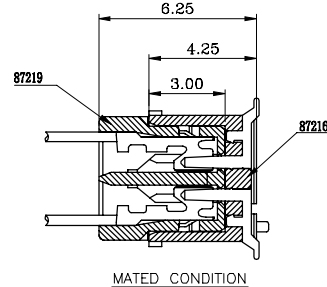
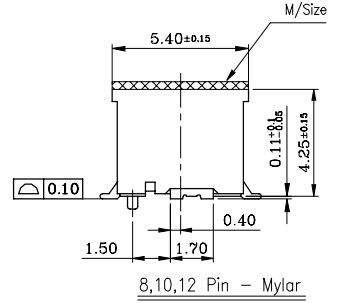
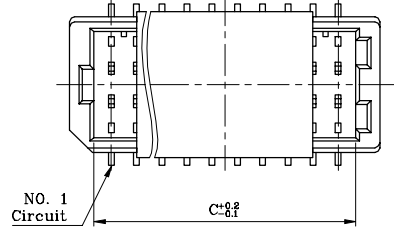
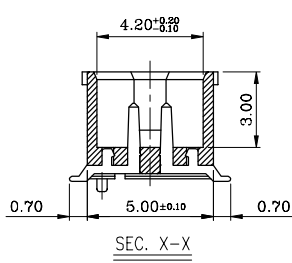
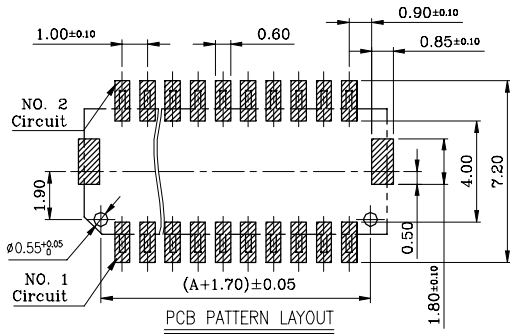

- NOTES:
- MATERIAL:
    - HOUSING: HALOGEN FREE PLASTIC, UL94V-0.
    - CONTACT: COPPER ALLOY
    - FITTING NAIL: COPPER ALLOY
  - FINISH:
    - CONTACT: PLS SEE ACES P/N LEGEND
    - FITTING NAIL: PLS SEE ACES P/N LEGEND
  - REFLOW SOLDER CAPABLE TO 260°C PER ACES SPEC.
  - SPEC. PLS. REFER TO PS-50238-xxxxx-xxx
  - PACKAGE PLS SEE ACES P/N LEGEND
  - PART NUMBER

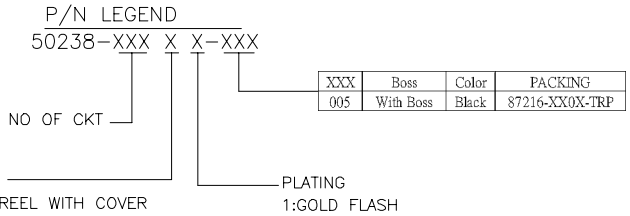

CKT	Dim A	Dim B	Dim C	M/Size or Cover
24	11.0	14.3	12.4	50238-C

<b>QUALITY SYMBOLS</b> MAJOR Ⓢ CRITICAL Ⓢ <b>GENERAL TOLERANCES (UNLESS SPECIFIED)</b> X. ±0.5 X ±0.25 .XX ±0.15 .XXX ±0.1 ANGLES ±2°	DRAWN BY	DATE		
	Huang,ShunSen	21/05/18		
	CHECKED BY	DATE	<b>TITLE</b> 1.0mm WTB D/R WAFER SMT S/T TYPE	
	Lu, Jing Quan	21/05/18		
APPROVED BY	DATE	UNITS	SIZE	RFQ NO.
hsieh, fu yu	21/05/18	mm	A4	NA
SCALE	SHEET NO.	REV	DWG NO.	
4:1	2 OF 2	V	50238-XXXXX-XXX	

单击下面可查看定价，库存，交付和生命周期等信息

[>>ACES\(宏致\)](#)