



**MMBT5401 Transistor(PNP)**

**Feature**

- Small Surface Mount Package

**Marking: 2L**

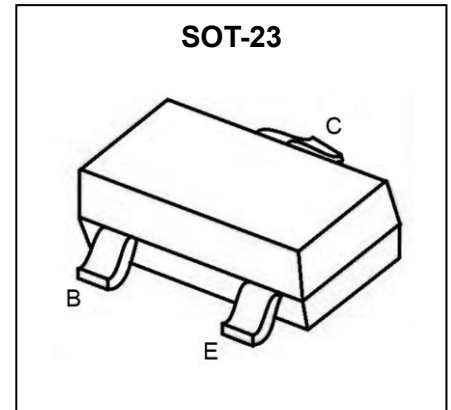

**MAXIMUM RATINGS (T<sub>a</sub>=25°C unless otherwise noted)**

Parameter	Symbol	Value	Unit
Collector-Base Voltage	V <sub>CB0</sub>	-160	V
Collector-Emitter Voltage	V <sub>CEO</sub>	-150	V
Emitter-Base Voltage	V <sub>EBO</sub>	-5	V
Collector Current -Continuous	I <sub>c</sub>	-0.6	A
Power Dissipation	P <sub>d</sub>	0.625	W
Junction Temperature	T <sub>J</sub>	150	°C
Storage Temperature	T <sub>STG</sub>	-55~ +150	°C

**ELECTRICAL CHARACTERISTICS(T<sub>a</sub>=25°C unless otherwise noted)**

Parameter	Symbol	Test Condition	Min	Max	Unit
Collector-base breakdown voltage	V <sub>(BR)CBO</sub>	I <sub>C</sub> =-100μA, I <sub>E</sub> =0	-160		V
Collector-emitter breakdown voltage	V <sub>(BR)CEO</sub>	I <sub>C</sub> =-100μA, I <sub>B</sub> =0	-150		V
Emitter-base breakdown voltage	V <sub>(BR)EBO</sub>	I <sub>E</sub> =-100μA, I <sub>C</sub> =0	-5		V
Collector cut-off current	I <sub>CBO</sub>	V <sub>CB</sub> =-140V, I <sub>E</sub> =0		-0.1	μA
Collector cut-off current	I <sub>CEO</sub>	V <sub>CE</sub> =-120V, I <sub>B</sub> =0		-0.1	μA
Emitter-base cut-off current	I <sub>EBO</sub>	V <sub>EB</sub> =-4V, I <sub>C</sub> =0		-0.1	μA
DC current gain	h <sub>FE</sub>	V <sub>CE</sub> =-5V, I <sub>C</sub> =-1mA	80		
		V <sub>CE</sub> =-5V, I <sub>C</sub> =-10mA	100	300	
		V <sub>CE</sub> =-5V, I <sub>C</sub> =-50mA	50		
Collector-emitter saturation voltage	V <sub>CE(sat)</sub>	I <sub>C</sub> =-10mA, I <sub>B</sub> =-1mA		-0.2	V
		I <sub>C</sub> =-50mA, I <sub>B</sub> =-5mA		-0.5	V
Base-emitter saturation voltage	V <sub>BE(sat)</sub>	I <sub>C</sub> =-10mA, I <sub>B</sub> =-1mA		-1	V
		I <sub>C</sub> =-50mA, I <sub>B</sub> =-5mA		-1	V
Transition frequency	f <sub>T</sub>	V <sub>CE</sub> = -5V, I <sub>C</sub> =-10mA, f =30MHZ	100		MHZ

**CLASSIFICATION OF h<sub>FE</sub>**

RANK	L	H
RANGE	100-200	200-300

**Typical Characteristics**

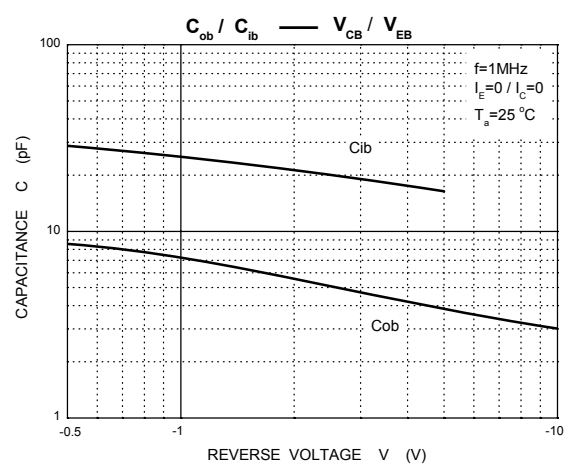
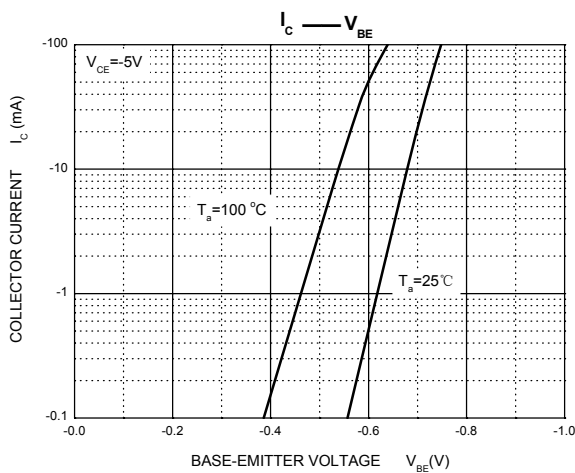
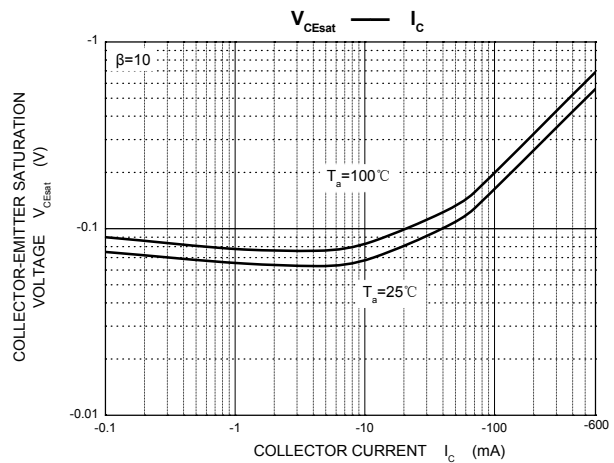
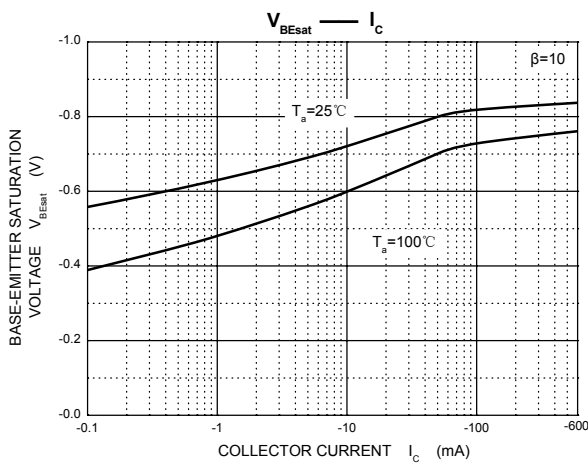
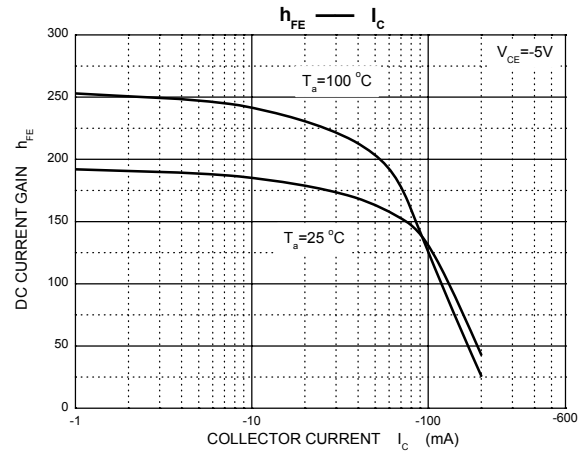
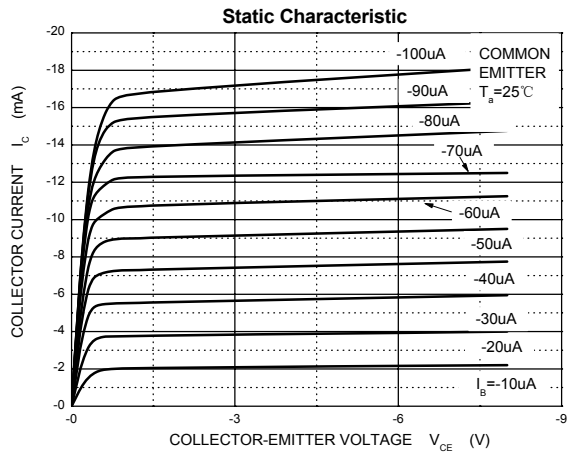

## SOT-23 Package Information

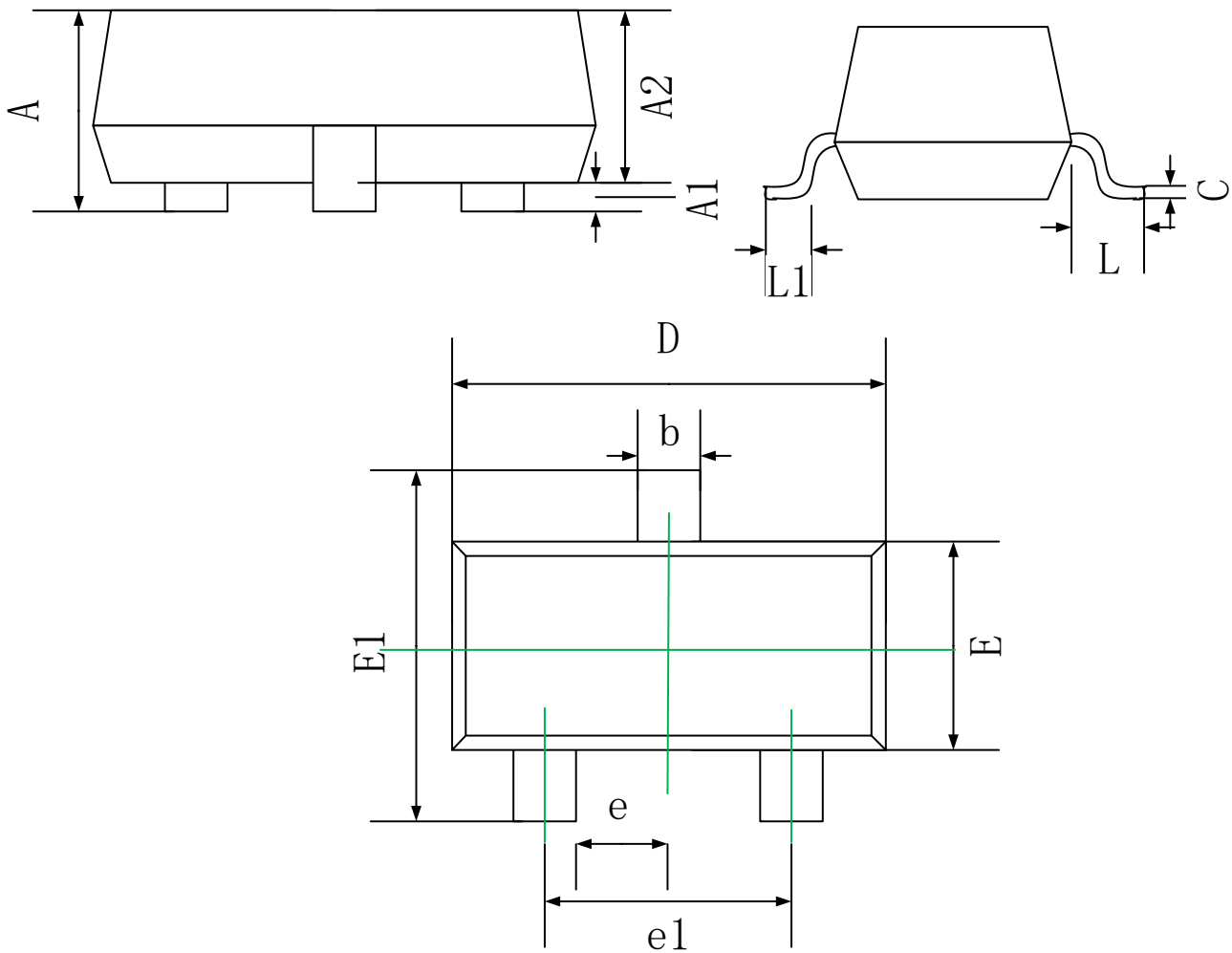

Symbol	Dimensions In Millimeters	
	Min.	Max.
A	0.90	1.40
A1	0.00	0.10
A2	0.90	1.30
b	0.30	0.50
c	0.08	0.19
D	2.70	3.10
E	1.20	1.65
E1	2.20	3.00
e	0.95 REF.	
e1	1.78	2.04
L	0.55 REF.	
L1	0.20	0.50

单击下面可查看定价，库存，交付和生命周期等信息

[>>GP\(格瑞宝\)](#)