

RECOMMENDED PCB LAYOUT  
GENERAL TOLERANCE ±0.05  
WITHOUT BOSS

RECOMMENDED PCB LAYOUT  
GENERAL TOLERANCE ±0.05  
WITH BOSS

NOTES:

- MATERIAL:
    - HOUSING: THERMOPLASTIC LCP, HIGH TEMP., UL94V-0; COLOR:BLACK.
    - CONTACT: PHOSPHOR BRONZE
    - FITTING NAIL: COPPER ALLOY
  - FINISH:
    - CONTACT:
      - 50~100u" NICKEL UNDERPLATING OVERALL.
      - 1: GOLD FLASH PLATING
      - C: 15u" GOLD ON CONTACT AREA
      - A: 3u" GOLD ON CONTACT AREA
      - B: 5u" GOLD ON CONTACT AREA
    - FITTING NAIL:
      - 50~100u" NICKEL UNDERPLATING OVERALL.
      - 1: GOLD FLASH PLATING
      - A: GOLD FLASH PLATING
      - B: GOLD FLASH PLATING
  - REFLOW SOLDER CAPABLE TO 260°C PER ACES SPEC.
  - SPEC. PLS. REFER TO PS-50007-xxxx-xxx
- △ NO PRINT CIRCUIT AREA OTHER THAN THE SAME CIRCUIT.

6. PART NUMBER

51049-XXX X X-XXX

No Of CKT

PACKING  
0: TAPE & REEL  
4: TAPE & REEL WITH MYLAR

PLATING  
1: GOLD FLASH  
C: 15u" GOLD ON CONTACT AREA  
A: 3u" GOLD ON CONTACT AREA  
B: 5u" GOLD ON CONTACT AREA

XXX	Housing Color	Halogen Free	Polarization	Package
001	Black	HF	with boss	88664-XXXXB-TRP
002	Black	HF	without boss	88664-XXXX-TRP
003	Black	HF	without boss	88664-XXXX-U-TRP
004	Black	HF	with boss	88664-XXXXB-U-TRP

CKT	Dim A	Dim B	Dim C	Dim D	MYLAR規格(橫組)
10	5.10	3.50	2.44	1.60	W2T12-88658
12	5.50	3.90	2.84	2.00	W2T12-88658
16	6.30	4.70	3.64	2.80	W3T12-88658
20	7.10	5.50	4.44	3.60	W3T12-88658
24	7.90	6.30	5.24	4.40	W3T12-88658
26	8.30	6.70	5.64	4.80	W3T12-88658
30	9.10	7.50	6.44	5.60	W5T12-88658
34	9.90	8.30	7.24	6.40	W5T12-88658
40	11.10	9.50	8.44	7.60	W5T12-88658
50	13.10	11.50	10.44	9.60	W5T12-88658
60	15.10	13.50	12.44	11.60	WAT12-88658
70	17.10	15.50	14.44	13.60	WAT12-88658
80	19.10	17.50	16.44	15.60	WPT12-88658
90	21.10	19.50	18.44	17.60	WPT12-88658
100	23.10	21.50	20.44	19.60	WPT12-88658
120	27.10	25.50	24.44	23.60	WPT12-88658

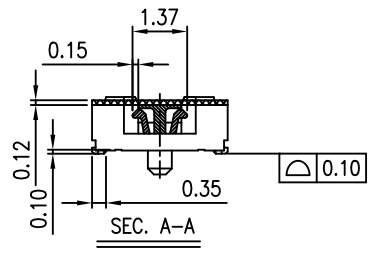

QUALITY SYMBOLS MAJOR Ⓢ CRITICAL Ⓢ	DRAWN BY Xu,zhonglin 21/03/11	DATE 21/03/11	
GENERAL TOLERANCES ( UNLESS SPECIFIED )	CHECKED BY Lu, jing quan 21/03/11	DATE 21/03/11	
X. ±0.5 .X ±0.25 .XX ±0.15 .XXX ±0.1 ANGLES ±2°	APPROVED BY hsieh,fu yu 21/03/11	DATE 21/03/11	TITLE 0.4mm BTB D/R RCPT SMT S/T TYPE
	UNITS mm	SIZE A4	RFQ NO. N/A
	SCALE 6 : 1	SHEET NO. 1 OF 1	REV 51049-XXXX-XXX

单击下面可查看定价，库存，交付和生命周期等信息

[>>ACES\(宏致\)](#)