

REVISIONS				
P	LTN	DESCRIPTION	DATE	OWN APVD
A		INITIAL RELEASE	28APR2020	Z.L I.Y

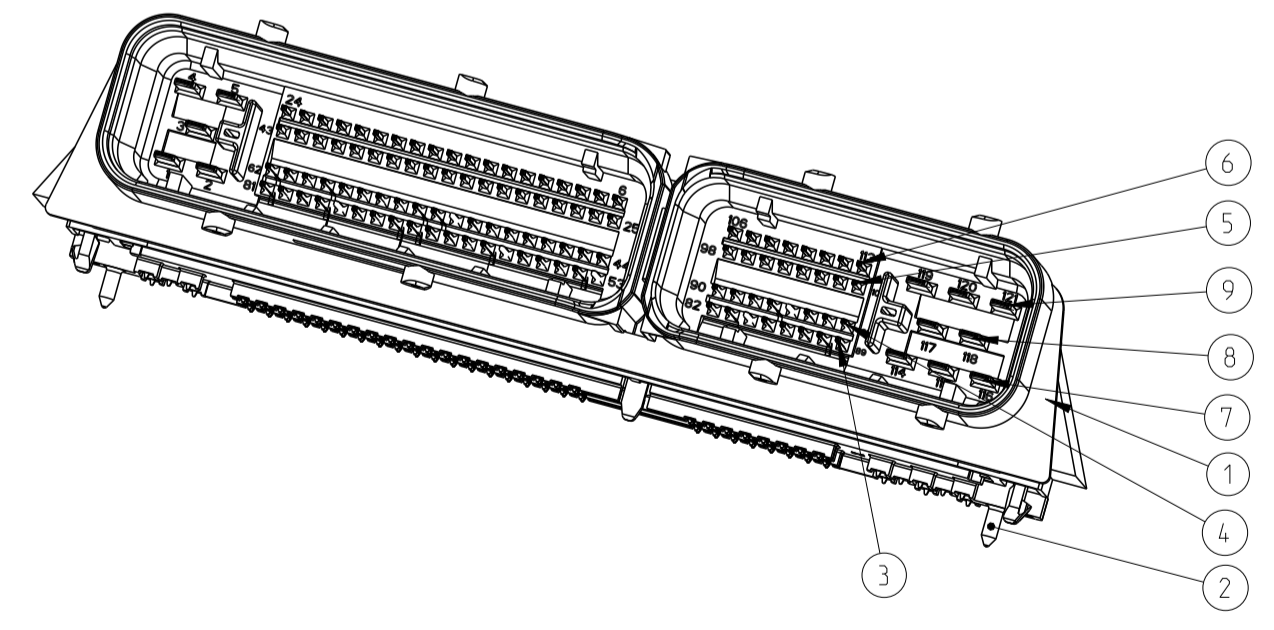
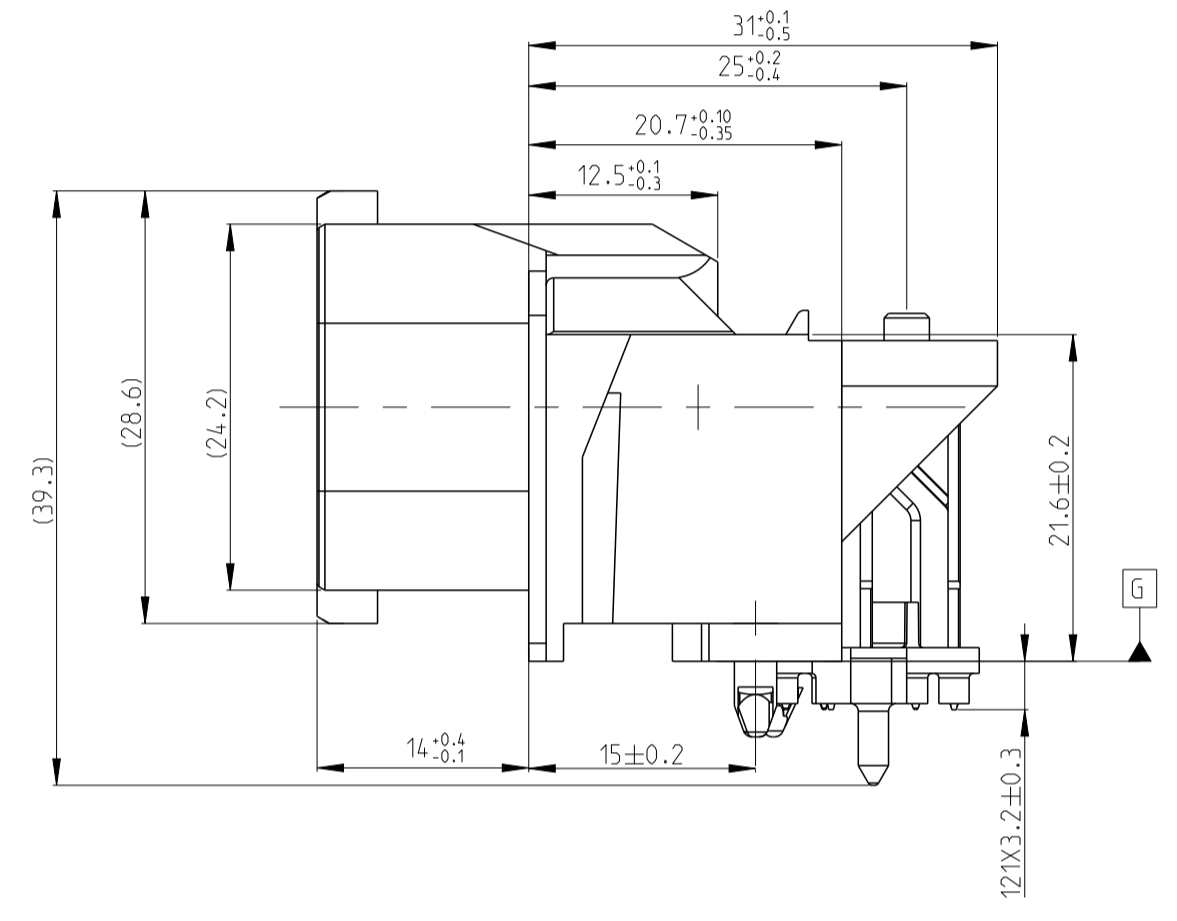
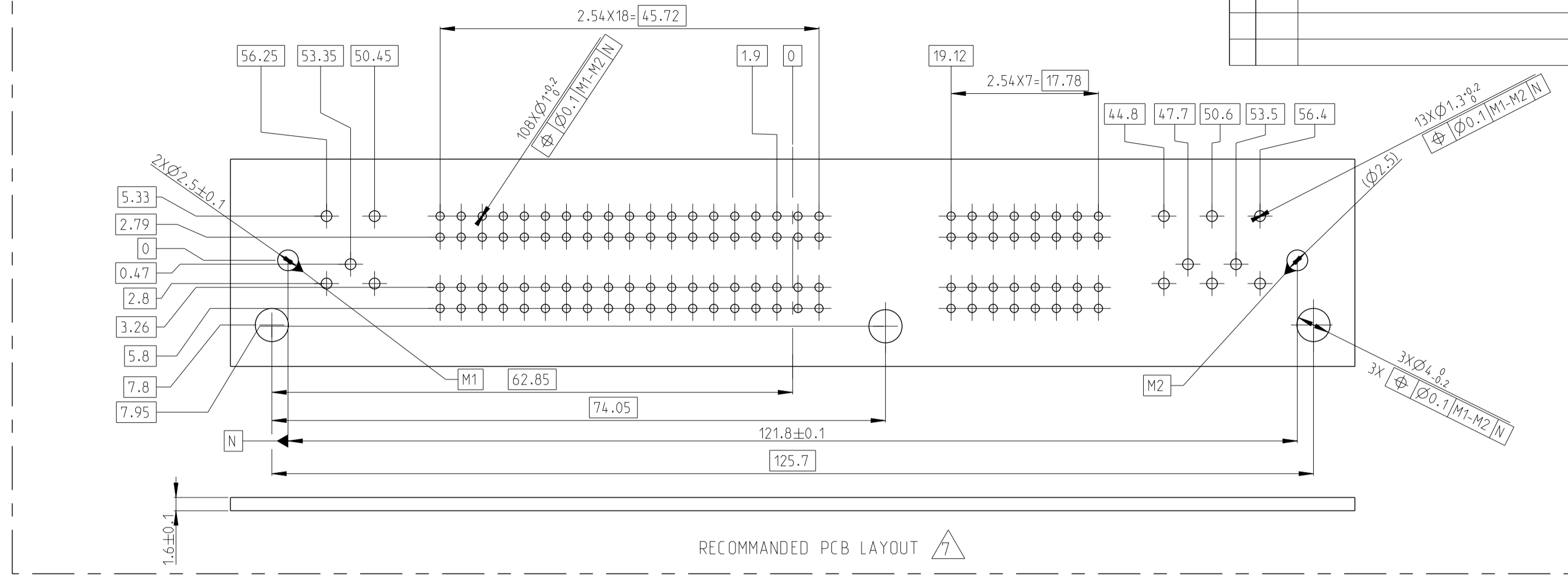
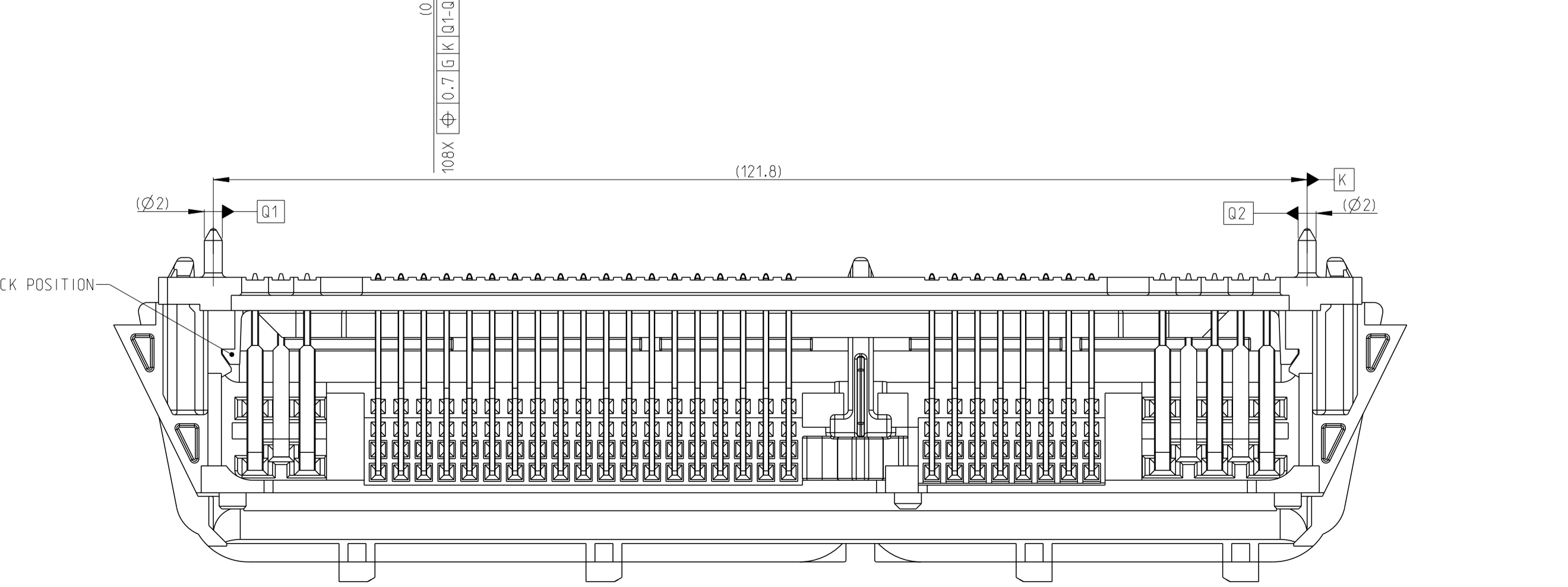
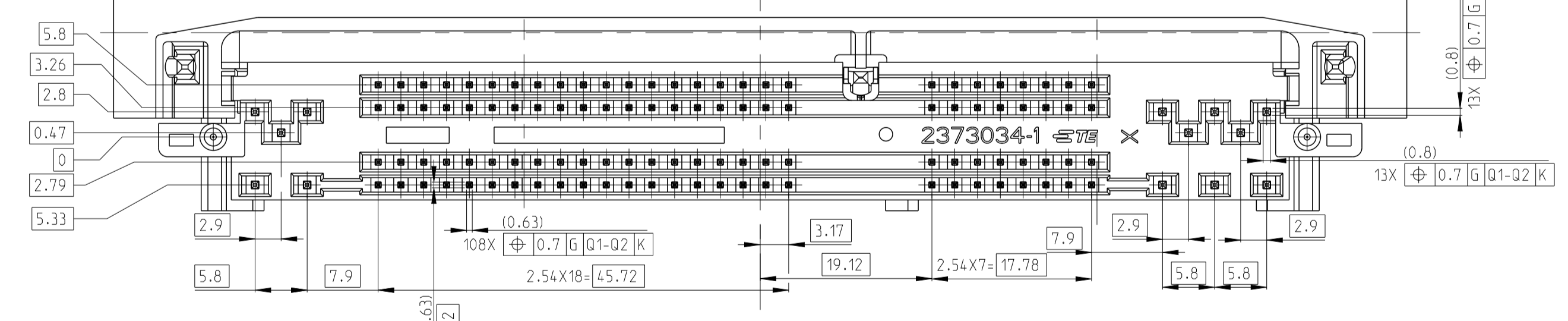
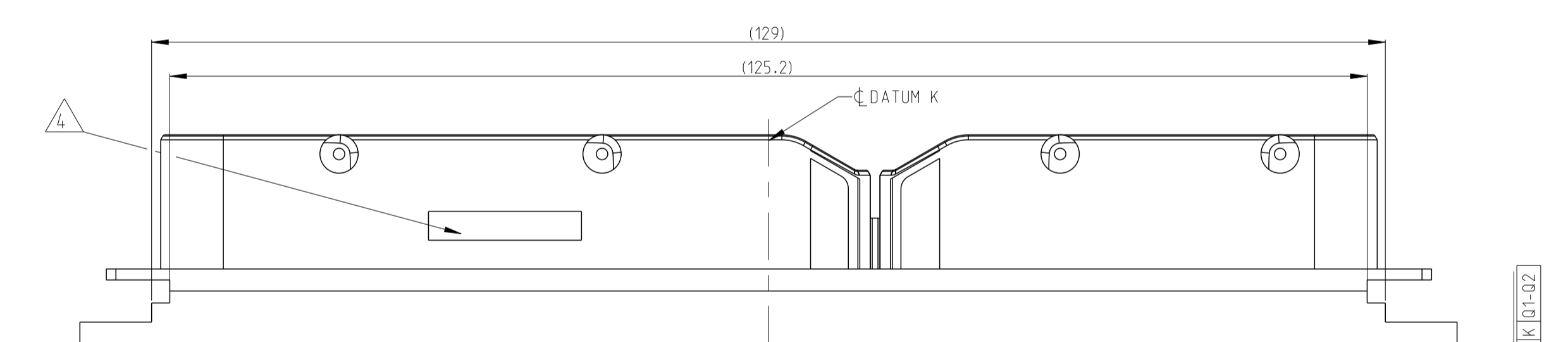
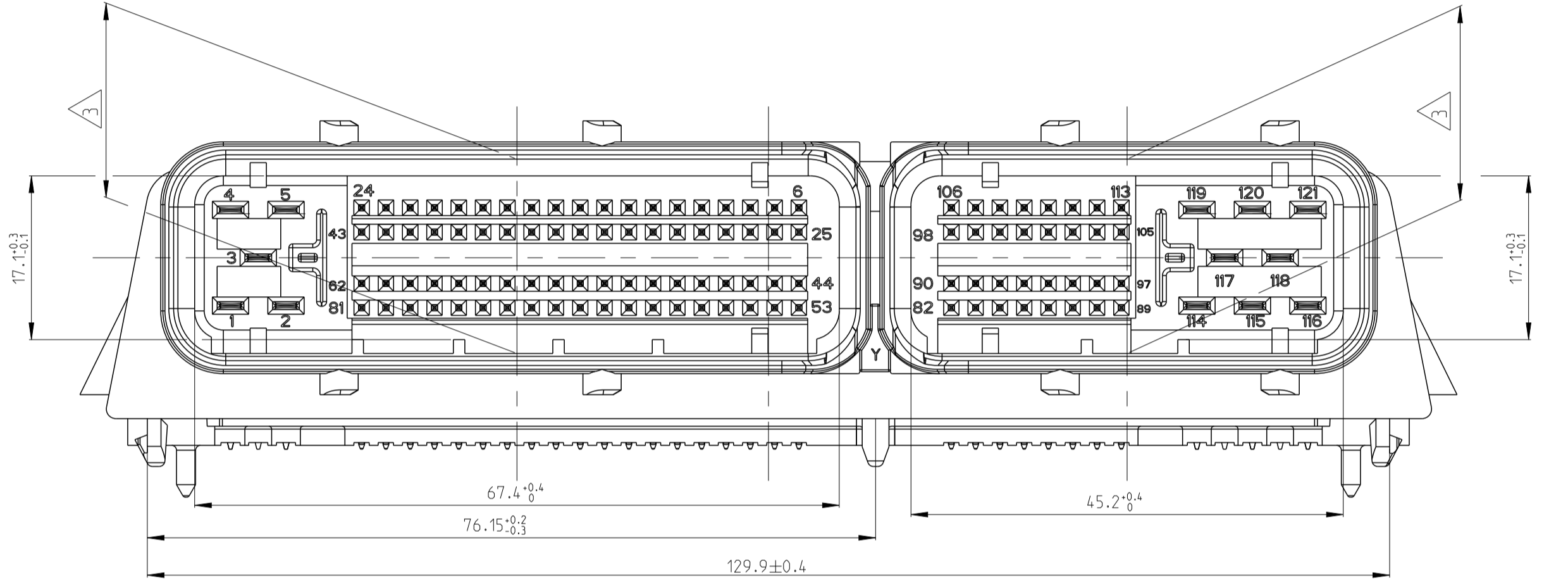
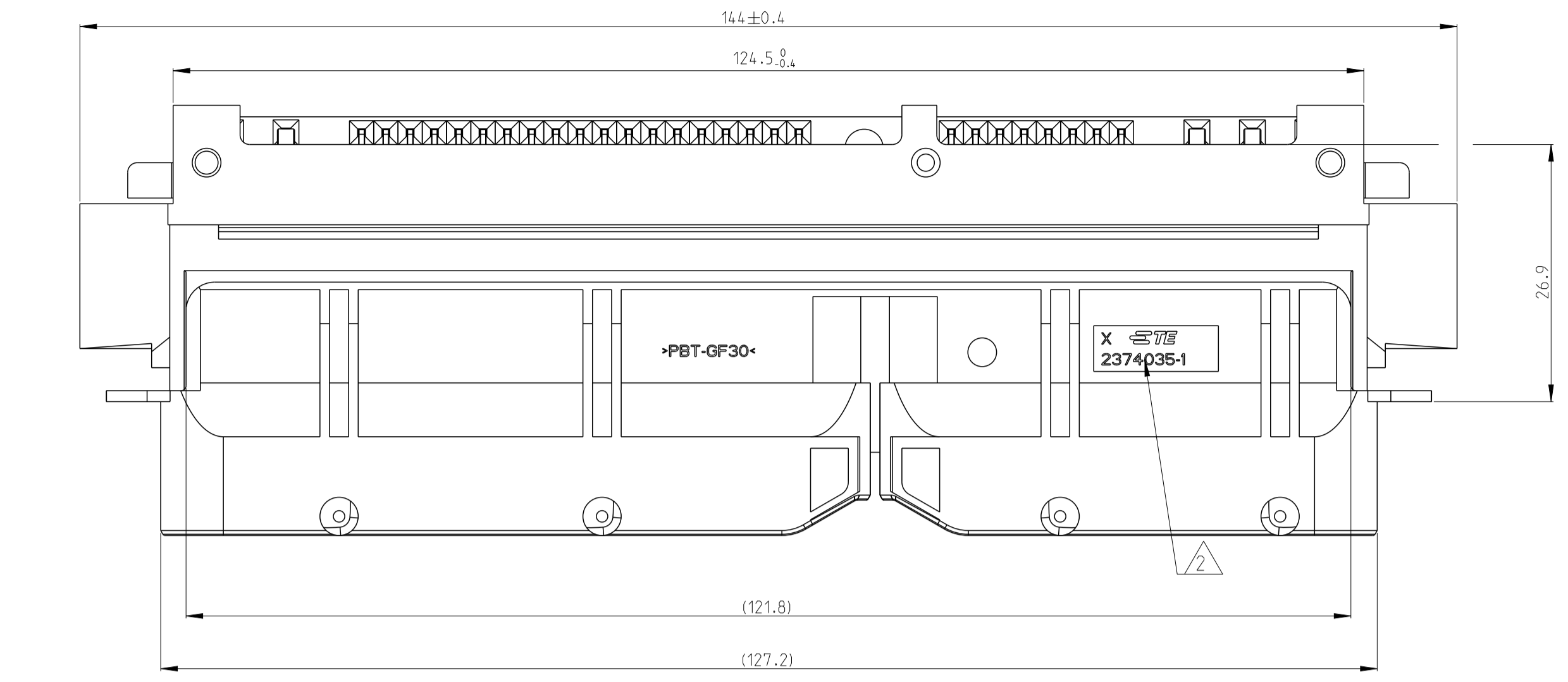

- 1 MATERIAL SEE TABLE LIST.
  - 2 TE ASSEMBLY PART NUMBER 2374035-1
  - 3 WARPAGE -0.2/-0.6 PERMITTED
  - 4 DATE OF PRODUCTION, LASER MARKING, THE CONTENT IS : YYYY-MM-DD/HH-MM-SS. FOR EXAMPLE 2020-12-12/08-35-12
  - 5 THE DELIVERY STATUS WITH PRE-LOCK POSITION FOR JOINTER
  - 6 RECOMMENDED TE RECEPTACLE HOUSING PART NUMBER
- | HEADER    | RECOMMENDED RECEPTACLE HOUSING |              |
|-----------|--------------------------------|--------------|
|           | 40WAY TE P/N                   | 81WAY TE P/N |
| 2374035-1 | 1473252-1                      | 1473244-1    |
- 7 RECOMMENDED PCB LAYOUT . PCB THICKNESS 1.6±0.1MM
  - 8. GENERAL TOLERANCE ACC. TO ISO 8015.ISO 2768-mH-E. DIN 16901-140 UNLESS OTHERWISE SPECIFIED.

2374035-1	5	TAB2.8X0.8_LONG	CuSn6	SN OVER NI	9
	3	TAB2.8X0.8_MIDDLE	CuSn6	SN OVER NI	8
	5	TAB2.8X0.8_SHORT	CuSn6	SN OVER NI	7
	27	0.63X0.63_LONGEST	CuSn6	SN OVER NI	6
	27	0.63X0.63_LONG	CuSn6	SN OVER NI	5
	27	0.63X0.63_SHORT	CuSn6	SN OVER NI	4
	1	JOINTER	PBT-GF30	BLACK	2
	-	HOUSING	PBT-GF30	BLACK	1
ASSEMBLY P/N	QTY'	DESCRIPTION	MATERIAL	COLOR/FINISH	ITEM

THIS DRAWING IS A CONTROLLED DOCUMENT.

OWN: Z.LI 28APR2020  
 CHK: W.WJU 28APR2020  
 APVD: I.Y.LIN 28APR2020

DIMENSIONS: mm  
 TOLERANCES UNLESS OTHERWISE SPECIFIED:  
 0 PLC ±0.1  
 1 PLC ±0.15  
 2 PLC ±0.2  
 3 PLC ±0.25  
 4 PLC ±0.3  
 ANGLES ±0.5  
 FINISH

NAME: ECU 121P HEADER  
 SIZE: A1 | 00779 | C=2374035  
 SCALE: 2:1 SHEET 1 OF 1 REV A

CUSTOMER DRAWING

单击下面可查看定价，库存，交付和生命周期等信息

[>>TE Connectivity\(泰科\)](#)